

DATE	
BY	
SURVEYED	
PLOTTED	
TEMPLATE	
AREAS	
CHECKED	
NO.	

DATE	
BY	
ORIGINAL SURVEY	
NOTE BOOK	
AREAS	
CHECKED	
NO.	

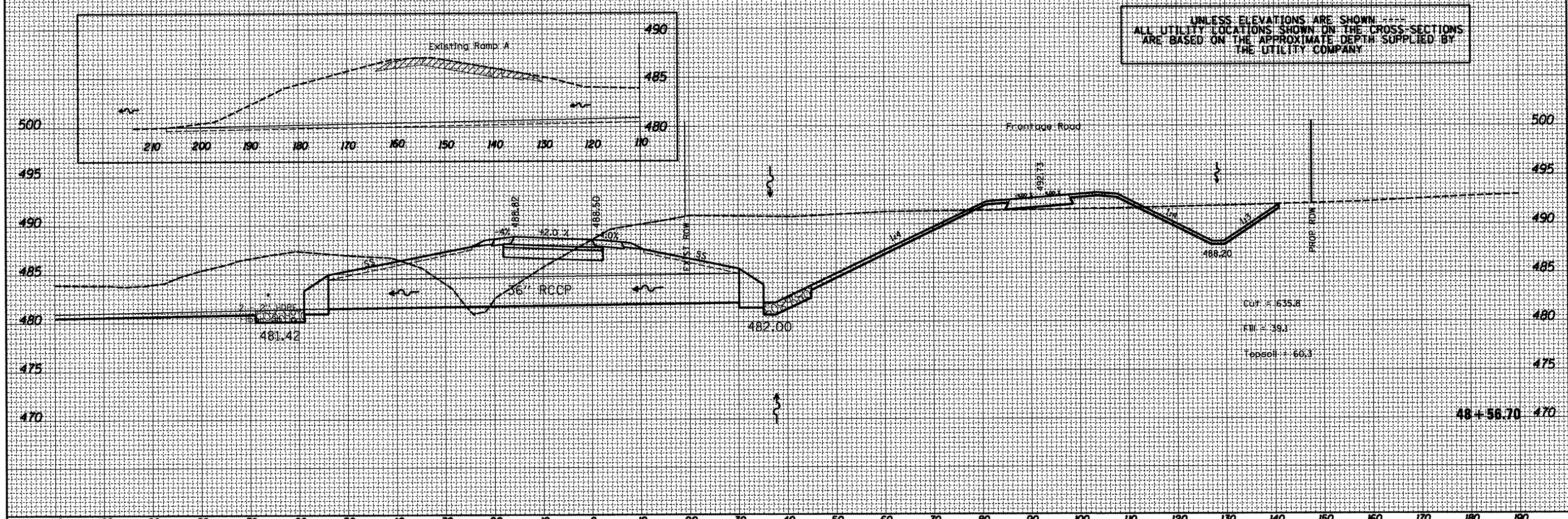
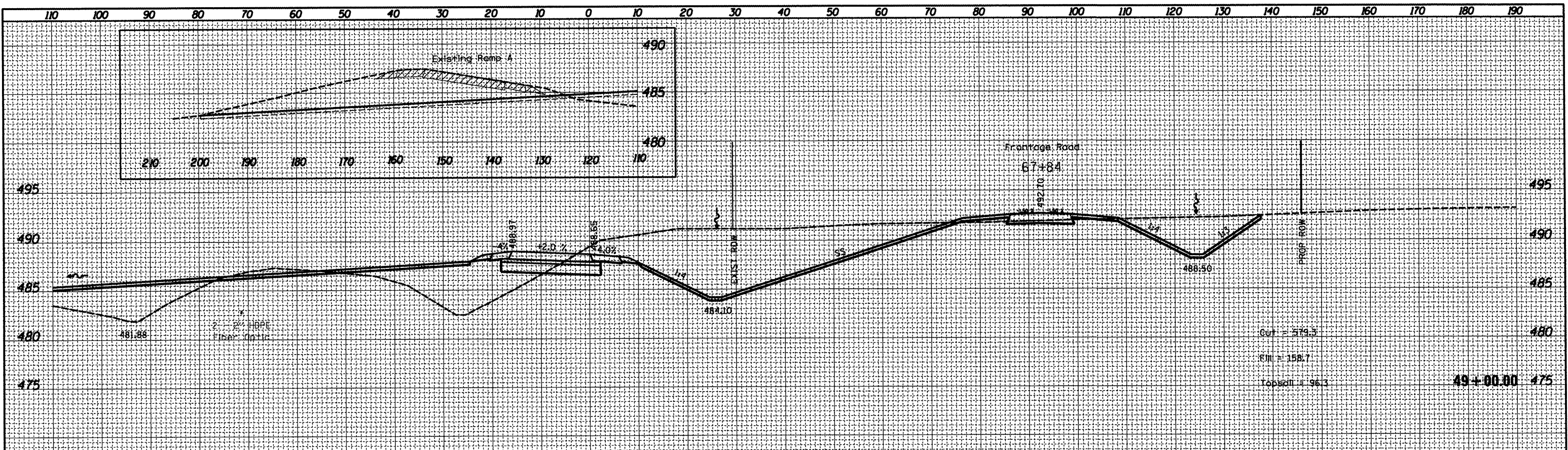

UNLESS ELEVATIONS ARE SHOWN, ALL UTILITY LOCATIONS SHOWN ON THE CROSS SECTIONS ARE BASED ON THE APPROXIMATE DEPTH SUPPLIED BY THE UTILITY COMPANY.

FILE NAME = x0468475-new-topo2d.dgn	USER NAME = eversal	DESIGNED -	REVISED -	STATE OF ILLINOIS DEPARTMENT OF TRANSPORTATION	PROPOSED CROSS SECTION RAMP D		I.A.P. RTE. 318 SECTION (72-6R) COUNTY PEORIA TOTAL SHEETS 117 SHEET NO. 75 CONTRACT NO. 68A30 ILLINOIS FED. AID PROJECT
	PLOT SCALE = 20.0000' / in.	DRAWN -	REVISED -		SCALE:	SHEET OF SHEETS	
	PLOT DATE = 3/15/2012	CHECKED -	REVISED -		STA. 48+56.70	TO STA. 49+00.00	
		DATE -	REVISED -				