

DATE	
BY	
FINAL SURVEY	SURVEYED
NOTE BOOK	PLOTTED
AREAS CHECKED	TEMPLATE
NO.	AREAS CHECKED

DATE	
BY	
ORIGINAL SURVEY	SURVEYED
NOTE BOOK	PLOTTED
AREAS CHECKED	TEMPLATE
NO.	AREAS CHECKED

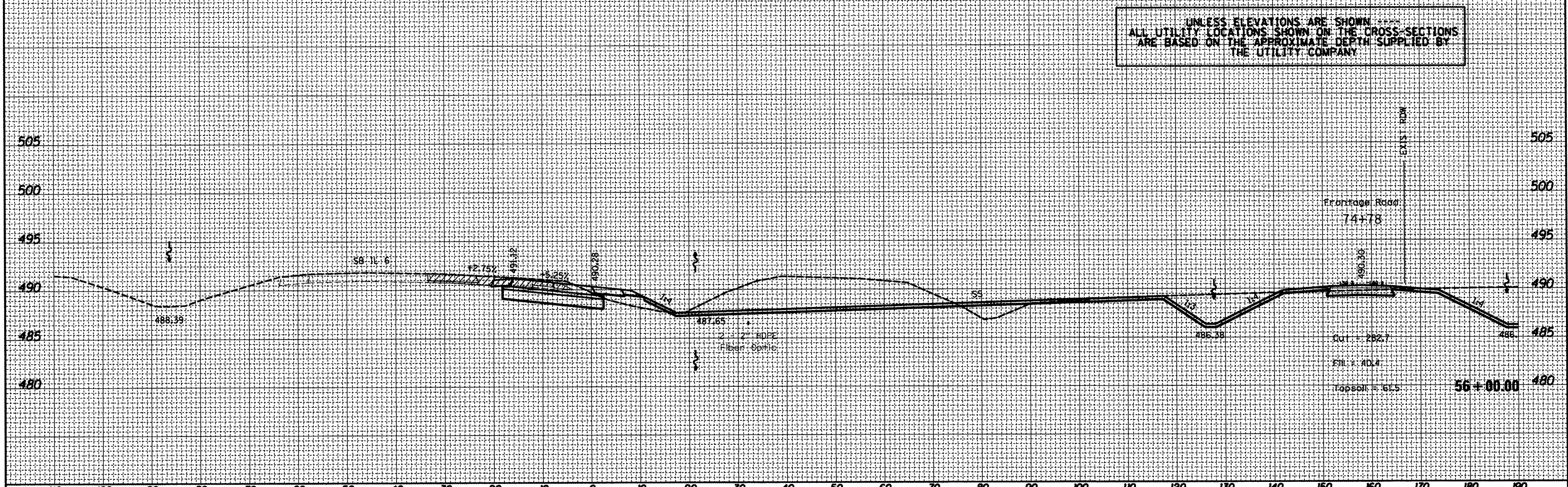
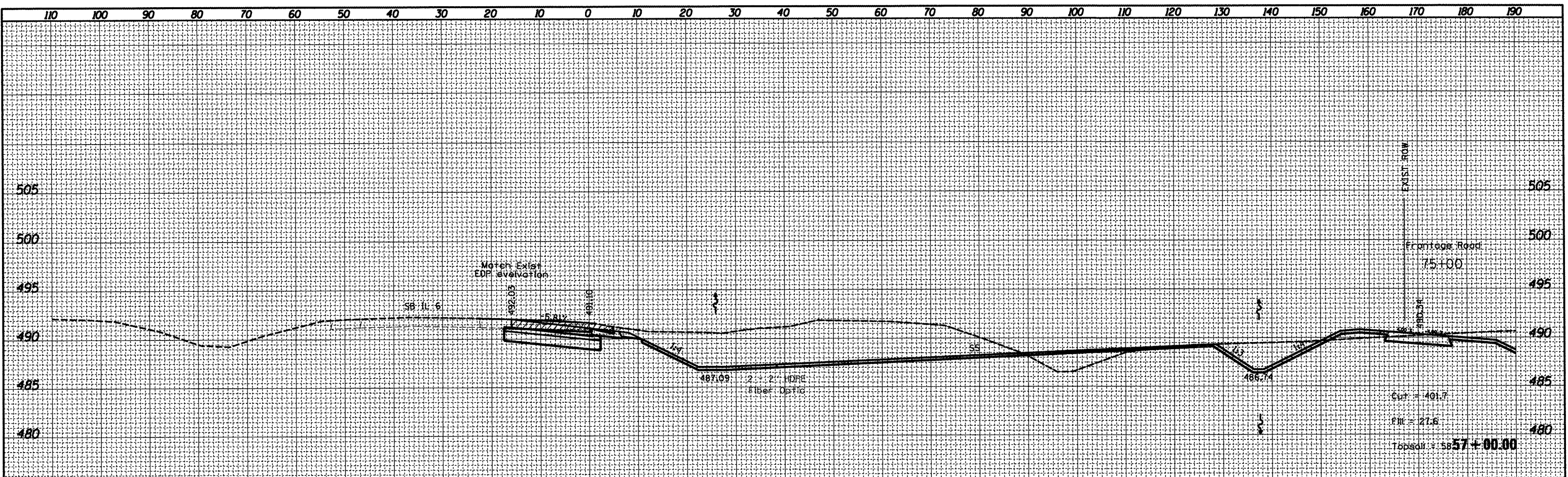

FILE NAME = x:\D468475-new-topo2d.dgn	USER NAME = eversal	DESIGNED - DRAWN - CHECKED - DATE -	REVISED - REVISED - REVISED - REVISED -	<b>STATE OF ILLINOIS DEPARTMENT OF TRANSPORTATION</b>	<b>PROPOSED CROSS SECTION RAMP D</b>			F.A.P. RTE. 318	SECTION (72-6)R	COUNTY PEORIA	TOTAL SHEETS 117	SHEET NO. 79
PLOT SCALE = 20.0000' / 1" /					SCALE:	SHEET	OF	SHEETS	STA. 56+00.00	TO STA. 57+00.00	ILLINOIS FED. AID PROJECT	
PLOT DATE = 3/15/2012										<b>CONTRACT NO. 68A30</b>		