

F.A. RTE.	SECTION	COUNTY	TOTAL SHEETS	SHEET NO.
75	84-12: 11-3		729	41
STA. N/A		TO STA. N/A		
FED. ROAD DIST. NO. 5 ILLINOIS FED. AID PROJECT				
• SANGAMON AND CHRISTIAN				

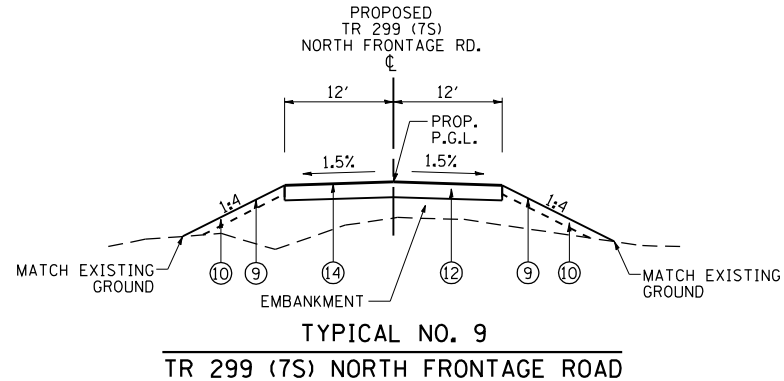

TYPICAL NO. 9
TR 299 (7S) NORTH FRONTAGE ROAD

- ### PROPOSED LEGEND
- (3) PROP. BITUMINOUS MATERIALS (PRIME COAT)
 - (5) PROP. HOT-MIX ASPHALT SHOULDERS, 8"
 - (6) PROP. AGGREGATE SHOULDERS, TYPE A
 - (7) PROP. AGGREGATE SHOULDERS, TYPE A, 8"
 - (9) PROP. SEEDING CLASS 2, WITH MULCH METHOD 2
 - (10) PROP. TOPSOIL PLACEMENT, 4"
 - (11) PROP. LANE STRIPING (SEE PAVEMENT MARKING PLAN)
 - (12) PROP. AGGREGATE BASE COURSE, TYPE A, 10"
 - (14) PROP. A-3 BITUMINOUS SURFACE TREATMENT
 - (15) PROP. HOT-MIX ASPHALT PAVEMENT (FULL-DEPTH), 9 1/2"
 - (16) PROP. REMOVAL AND DISPOSAL OF UNSUITABLE MATERIAL
 - (22) FOG TACK COAT AS REQUIRED PER ENGINEER (ART. 407.13)

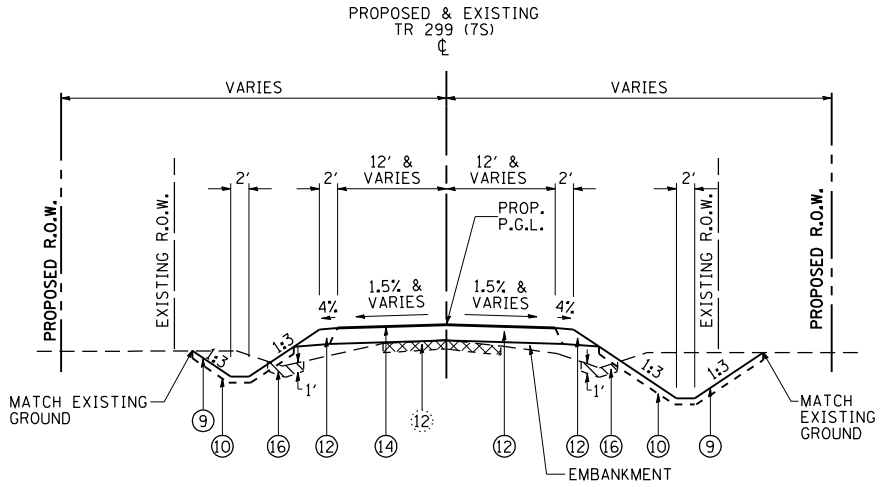

TYPICAL NO. 8
TR 299 (7S)/ELM STREET: STA. 906+37.53 (P.T.) TO STA. 907+67.03

- ### EXISTING LEGEND
- (12) EXISTING OIL AND CHIP/GRAVEL PAVEMENT (VARIES)
- NOTE 1: SHOULDER WIDTH AND MATERIAL TYPE CHANGES AT RADIUS RETURNS. SEE PLAN AND PROFILE SHEETS FOR DETAILS.
- NOTE 2: PAVEMENT WIDTH INCREASES AT RADIUS RETURNS. SEE PLAN AND PROFILE SHEETS FOR DETAILS.

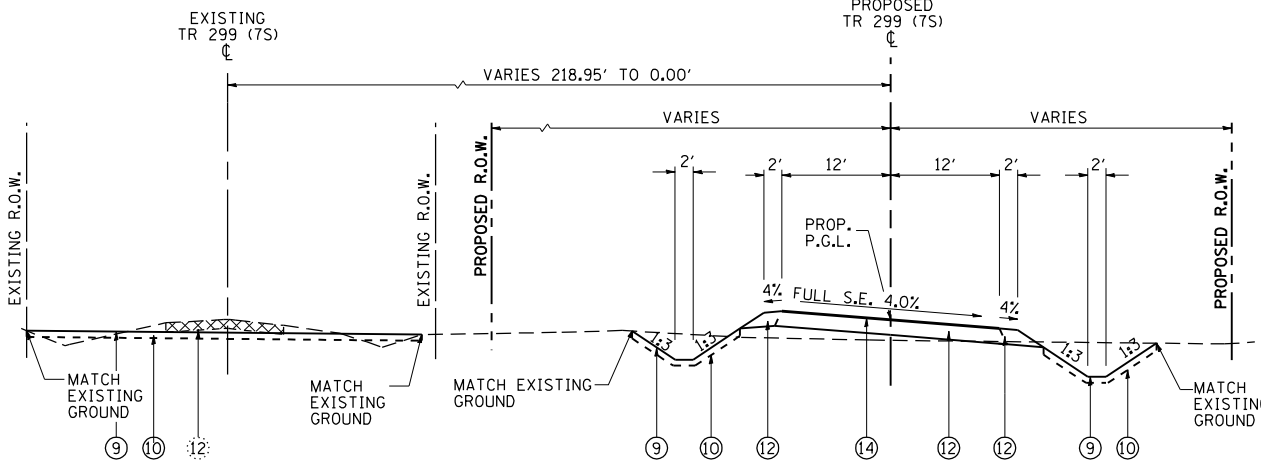

TYPICAL NO. 7
TR 299 (7S) / ELM STREET: STA. 904+28.57 TO STA. 906+37.53 (P.T.)
S.E. ATTAINMENT - STA. 906+04.20 TO STA. 907+41.70

REVISIONS	
NAME	DATE

ILLINOIS DEPARTMENT OF TRANSPORTATION

TYPICAL SECTIONS
TR 299 (7S) / ELM STREET

SCALE: NONE
DATE: 03/06/2012

DRAWN BY: B.J.D.
CHECKED BY: J.M.M.

Default L:\DOT\030601\Draw_sheets\0672829-sht-Typical_TR299_ELM_2.dgn 3/6/2012