

F.A.P. RTE.	SECTION	COUNTY	TOTAL SHEETS	SHEET NO.
75	84-12: 11-3		729	141
STA. 130+00		TO STA. 145+00		
FED. ROAD DIST. NO. 5 ILLINOIS FED. AID PROJECT				
• SANGAMON AND CHRISTIAN				

PLAN	SURVEYED	BY	DATE
	PLOTTED		
	CHECKED		
	BY		
	NO. OF WAY CHECKED		
	NO.		
	FILE NAME		

PROFILE	SURVEYED	BY	DATE
	PLOTTED		
	CHECKED		
	BY		
	NO. OF WAY CHECKED		
	NO.		
	STRUCTURE NOTATIONS CHKD		

PinProf5hts057
 L:\DOT\0306601\draw\sheet.s\672829-sht-PinProf5hts030.dgn
 3/16/2012

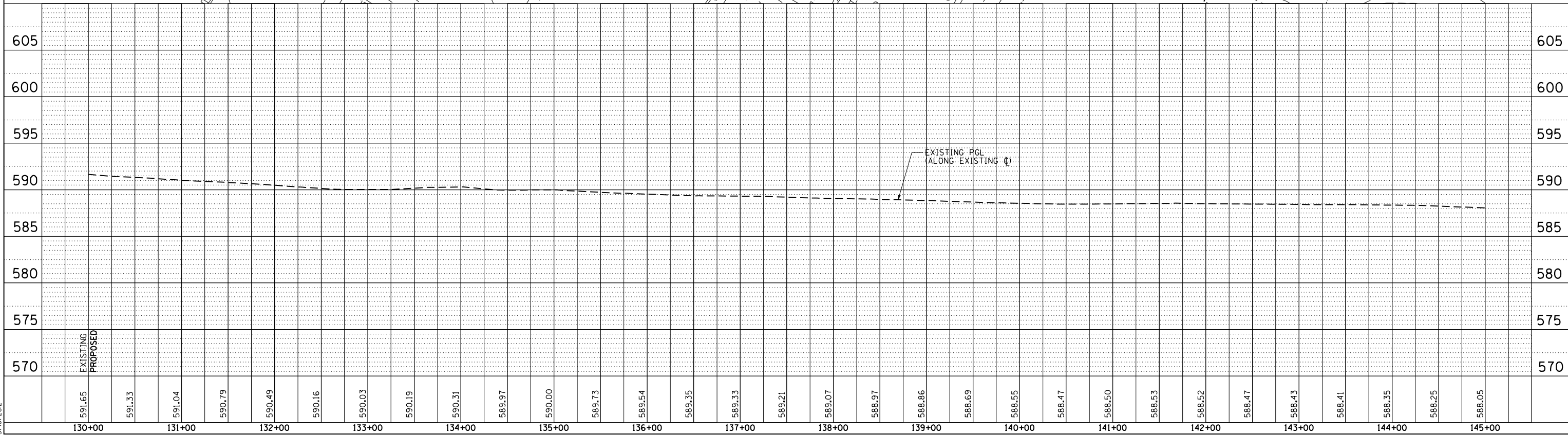
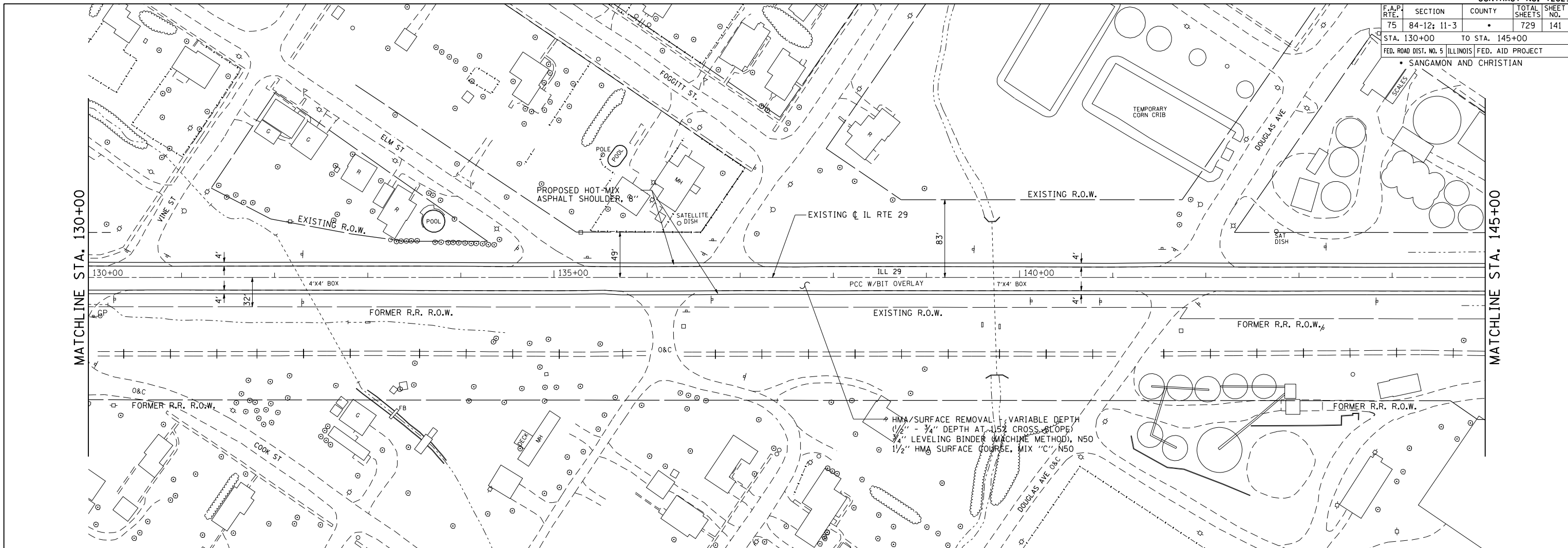

PLAN & PROFILE: EXISTING IL RTE 29 - STA. 130+00 TO STA. 145+00