

F.A.P. RTE.	SECTION	COUNTY	TOTAL SHEETS	SHEET NO.
75	84-12: 11-3		729	190
STA. 68+00		TO STA. 98+00		
FED. ROAD DIST. NO. 5 ILLINOIS FED. AID PROJECT				
SANGAMON AND CHRISTIAN				

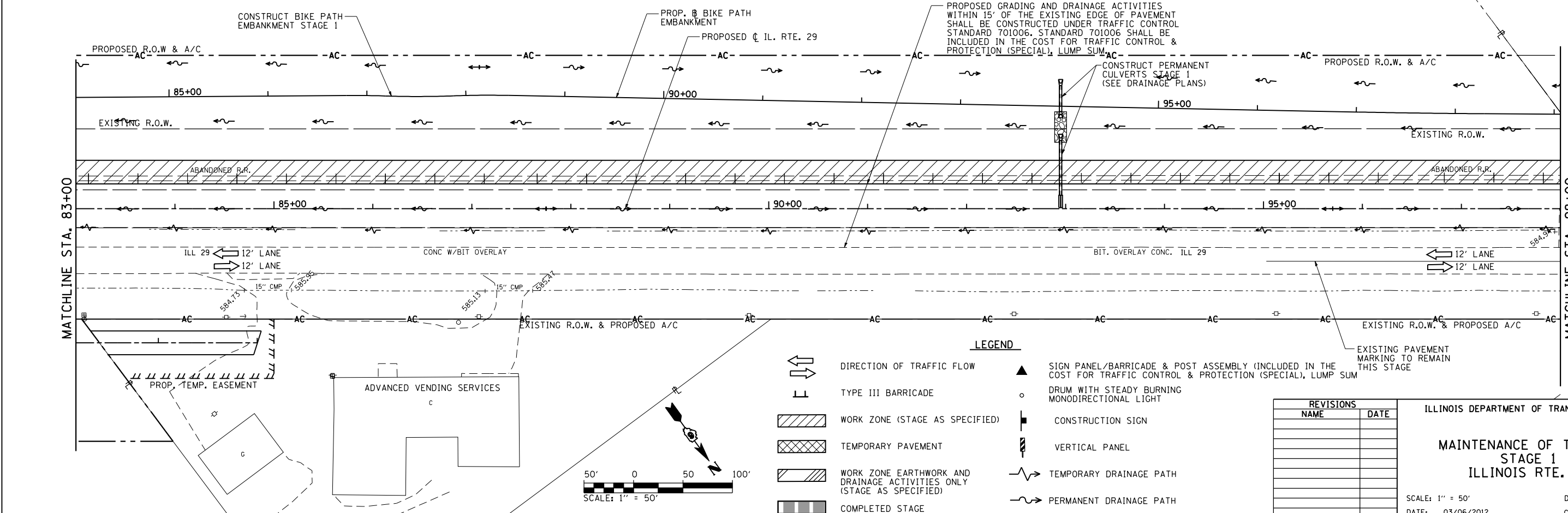
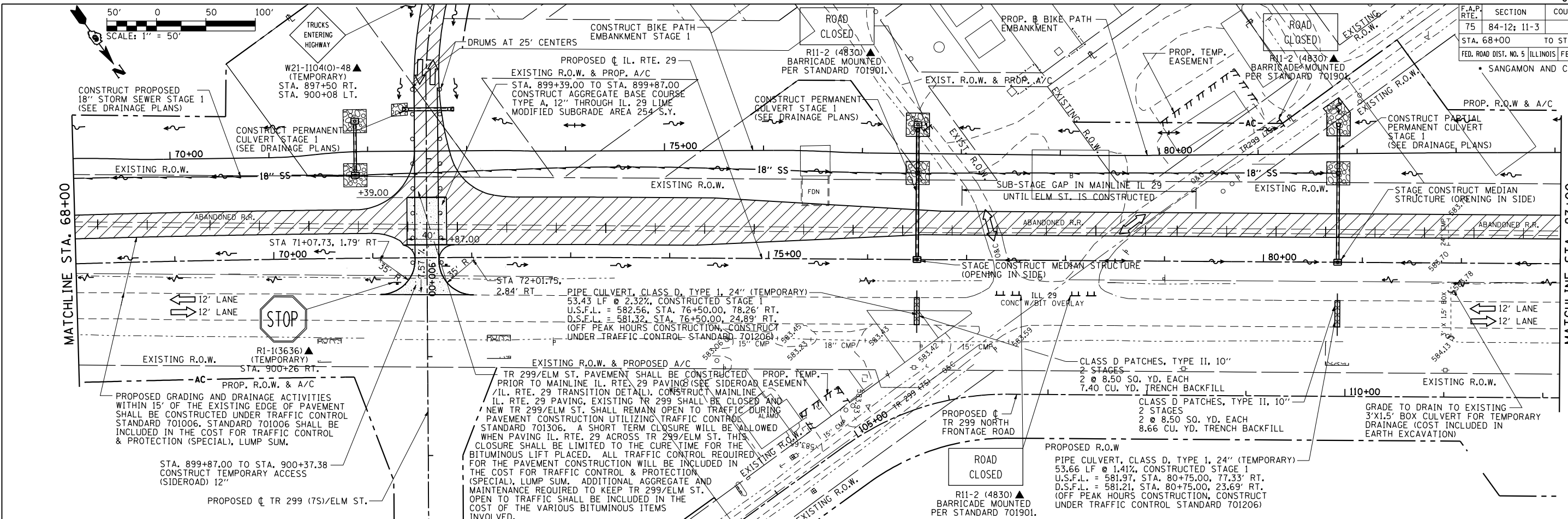

**LEGEND**

- DIRECTION OF TRAFFIC FLOW
- TYPE III BARRICADE
- WORK ZONE (STAGE AS SPECIFIED)
- TEMPORARY PAVEMENT
- WORK ZONE EARTHWORK AND DRAINAGE ACTIVITIES ONLY (STAGE AS SPECIFIED)
- COMPLETED STAGE
- SIGN PANEL/BARRICADE & POST ASSEMBLY (INCLUDED IN THE COST FOR TRAFFIC CONTROL & PROTECTION (SPECIAL), LUMP SUM)
- DRUM WITH STEADY BURNING MONODIRECTIONAL LIGHT
- CONSTRUCTION SIGN
- VERTICAL PANEL
- TEMPORARY DRAINAGE PATH
- PERMANENT DRAINAGE PATH

REVISIONS	
NAME	DATE

ILLINOIS DEPARTMENT OF TRANSPORTATION

**MAINTENANCE OF TRAFFIC STAGE 1**  
ILLINOIS RTE. 29

SCALE: 1" = 50'  
DATE: 03/06/2012

DRAWN BY: R.A.H.  
CHECKED BY: J.M.M.

Default: L:\N001\030601\Draw\Sheets\1672829-sht-MOT-ST1-01.dgn 4/23/2012