

F.A.P. RTE.	SECTION	COUNTY	TOTAL SHEETS	SHEET NO.
75	84-12; 11-3	•	729	213
STA. 1403+00		TO STA. 1433+00		
FED. ROAD DIST. NO. 5 ILLINOIS FED. AID PROJECT				
• SANGAMON AND CHRISTIAN				

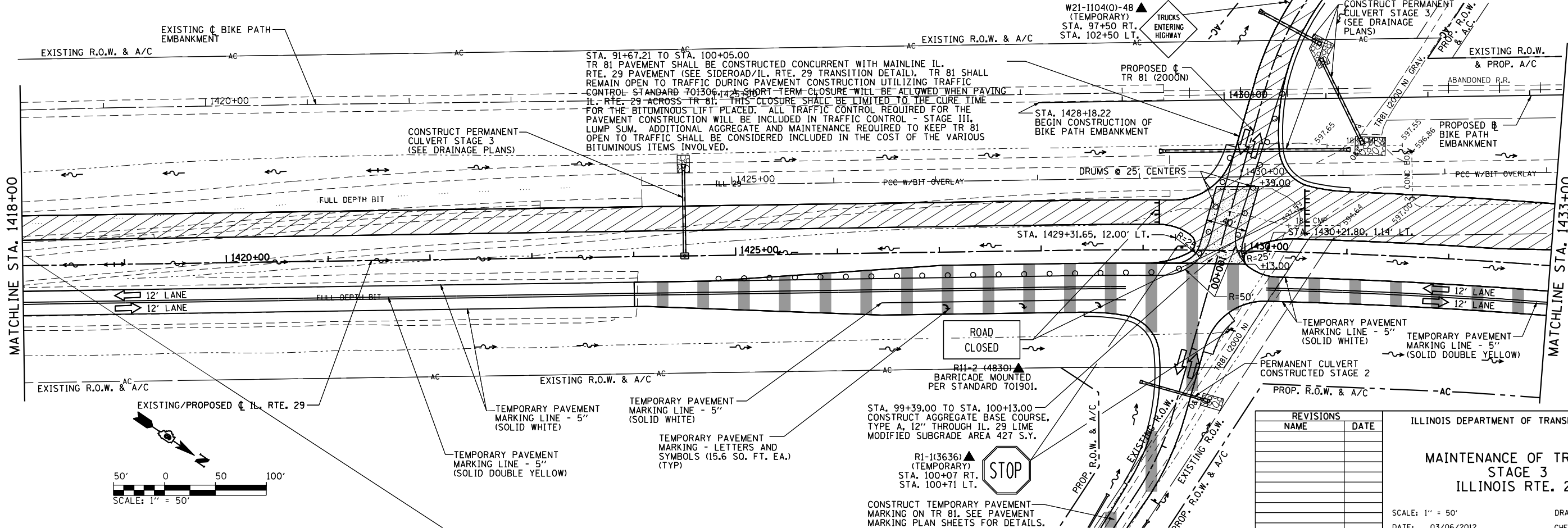
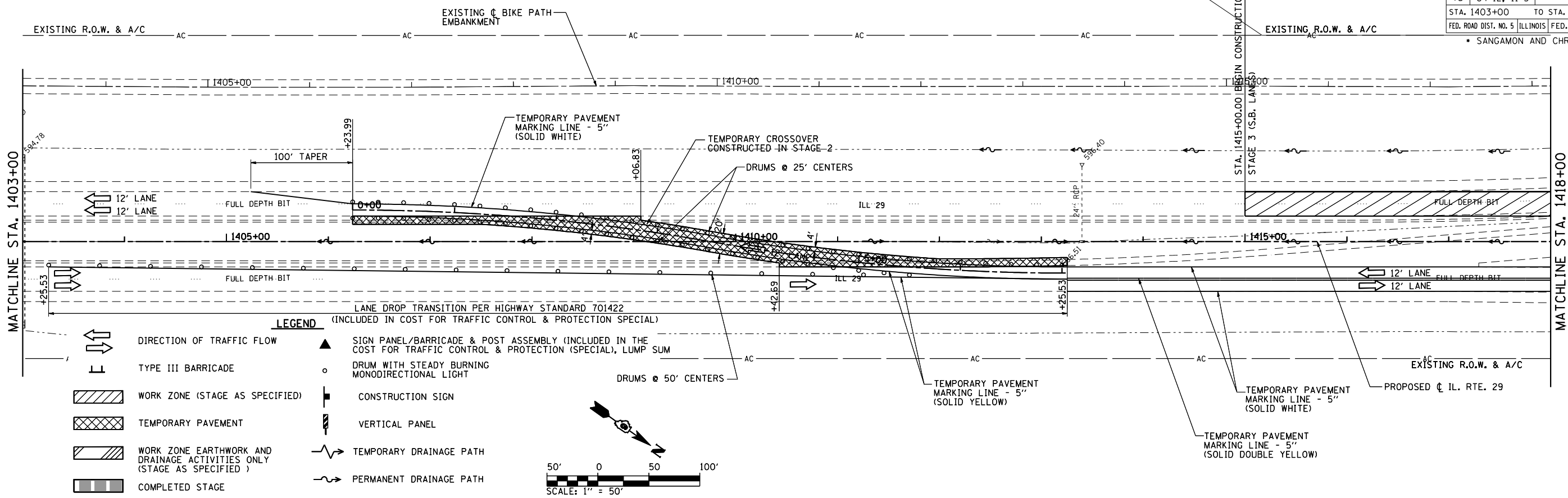

REVISIONS	
NAME	DATE

ILLINOIS DEPARTMENT OF TRANSPORTATION
**MAINTENANCE OF TRAFFIC
 STAGE 3
 ILLINOIS RTE. 29**
 SCALE: 1" = 50'
 DATE: 03/06/2012
 DRAWN BY: R.A.H.
 CHECKED BY: J.M.M.

Default \\dot\030660\draw\sheets\0672829-sht-MOT\STG3_003.dgn
 3/6/2012