

| F.A.P. RTE. | SECTION | COUNTY | TOTAL SHEETS | SHEET NO. |
|---|-------------|-----------------|--------------|-----------|
| 75 | 84-12; 11-3 | | 729 | 271 |
| STA. 1523+00 | | TO STA. 1538+00 | | |
| FED. ROAD DIST. NO. 5 (ILLINOIS) FED. AID PROJECT | | | | |
| • SANGAMON AND CHRISTIAN | | | | |

| | | | |
|------|----------|----|------|
| PLAN | SURVEYED | BY | DATE |
| | NOTED | | |
| | CHECKED | | |
| | BY | | |
| | NO. | | |

| | | | |
|---------|----------|----|------|
| PROFILE | SURVEYED | BY | DATE |
| | NOTED | | |
| | CHECKED | | |
| | BY | | |
| | NO. | | |

D:\cadd\pnc009
L:\D01\1306601\dr-aw\sheet\5\672829-sht1-DrainPnc001.dgn
3/16/2012

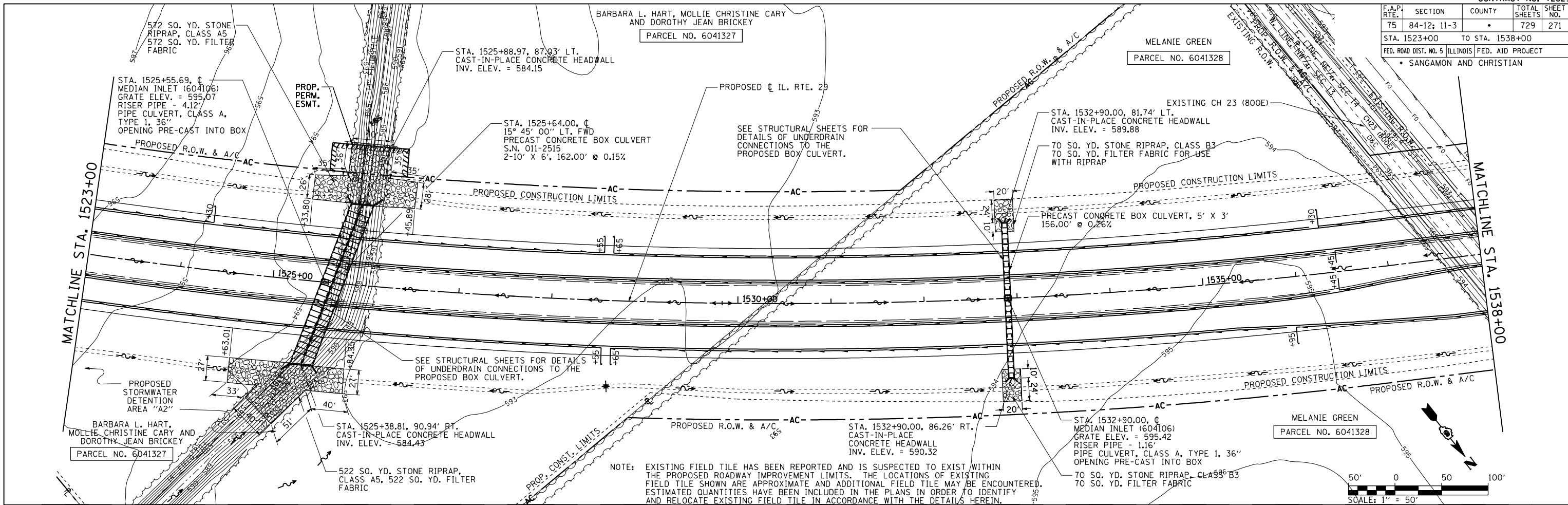

NOTE: EXISTING FIELD TILE HAS BEEN REPORTED AND IS SUSPECTED TO EXIST WITHIN THE PROPOSED ROADWAY IMPROVEMENT LIMITS. THE LOCATIONS OF EXISTING FIELD TILE SHOWN ARE APPROXIMATE AND ADDITIONAL FIELD TILE MAY BE ENCOUNTERED. ESTIMATED QUANTITIES HAVE BEEN INCLUDED IN THE PLANS IN ORDER TO IDENTIFY AND RELOCATE EXISTING FIELD TILE IN ACCORDANCE WITH THE DETAILS HEREIN.

