

| F.A.P. RTE.                                     | SECTION     | COUNTY | TOTAL SHEETS | SHEET NO. |
|---|-------------|--------|--------------|-----------|
| 75  | 84-12: 11-3 |        | 729          | 288       |
| STA. 113+00 TO STA. 128+00                      |             |        |              |           |
| FED. ROAD DIST. NO. 5 ILLINOIS FED. AID PROJECT |             |        |              |           |
| • SANGAMON AND CHRISTIAN                        |             |        |              |           |

|      |           |      |
|------|-----------|------|
| PLAN | SURVEYED  | DATE |
|      | PLotted   |      |
|      | Checked   |      |
|      | By        |      |
|      | File Name |      |

|         |           |      |
|---------|-----------|------|
| PROFILE | SURVEYED  | DATE |
|         | Plotted   |      |
|         | Checked   |      |
|         | By        |      |
|         | Structure |      |

Dr: d:\pnp\026  
L:\N01\3036601\dr-aw\sheet.s\672829-sht-DrainPnp001.dgn  
3/16/2012

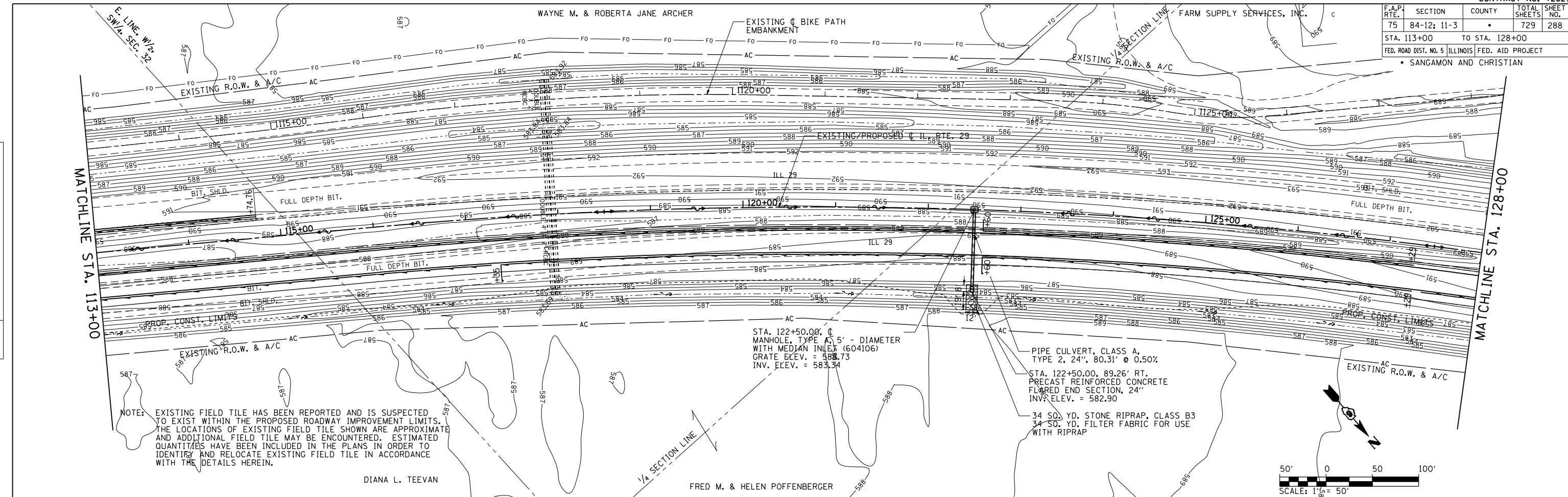

NOTE: EXISTING FIELD TILE HAS BEEN REPORTED AND IS SUSPECTED TO EXIST WITHIN THE PROPOSED ROADWAY IMPROVEMENT LIMITS. THE LOCATIONS OF EXISTING FIELD TILE SHOWN ARE APPROXIMATE AND ADDITIONAL FIELD TILE MAY BE ENCOUNTERED. ESTIMATED QUANTITIES HAVE BEEN INCLUDED IN THE PLANS IN ORDER TO IDENTIFY AND RELOCATE EXISTING FIELD TILE IN ACCORDANCE WITH THE DETAILS HEREIN.

PIPE CULVERT, CLASS A, TYPE 2, 24", 80.31' @ 0.50%  
STA. 122+50.00, 89.26' RT. PRECAST REINFORCED CONCRETE FLARED END SECTION, 24" INV. ELEV. = 582.90  
34 50. YD. STONE RIPRAP, CLASS B3  
34 50. YD. FILTER FABRIC FOR USE WITH RIPRAP

