

| F.A. RTE.                                       | SECTION     | COUNTY | TOTAL SHEETS | SHEET NO. |
|---|-------------|--------|--------------|-----------|
| 75  | 84-12; 11-3 | •      | 729          | 402       |
| STA. 580+00.00 TO STA. 122+00.00                |             |        |              |           |
| FED. ROAD DIST. NO. 5 ILLINOIS FED. AID PROJECT |             |        |              |           |
| • SANGAMON AND CHRISTIAN                        |             |        |              |           |

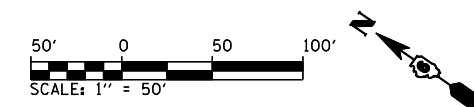

| REMOVAL LEGEND |   |
|----------------|---|
|                | ILLINOIS NATIVE PRARIE GRASS  |
|                | PAVEMENT REMOVAL  |
|                | PAVEMENT BREAKING IN ACCORDANCE WITH ARTICLE 205.03. COST INCLUDED IN EMBANKMENT. |
|                | TREE REMOVAL ACRES  |
| X              | TREE REMOVAL (UNITS)  |
|                | EXISTING OIL & CHIP PAVEMENT TO BE REMOVED. COST INCLUDED IN EARTH EXCAVATION     |
|                | GRAVEL DRIVEWAY REMOVAL. COST INCLUDED IN EARTH EXCAVATION.                       |
|                | PAVED SHOULDER REMOVAL  |
|                | HMA SURFACE REMOVAL   |

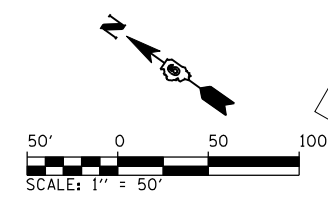
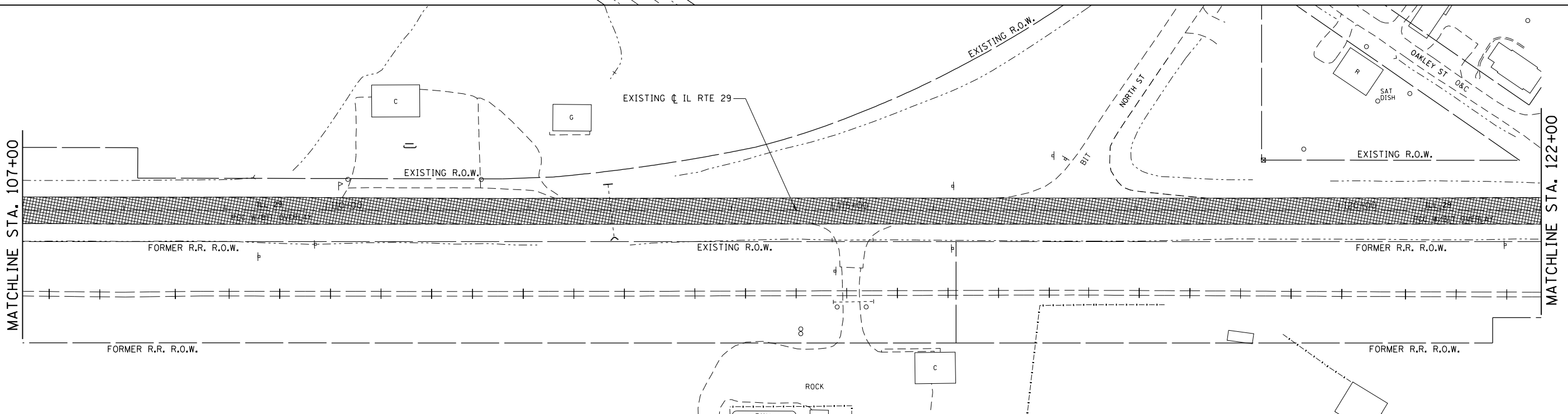
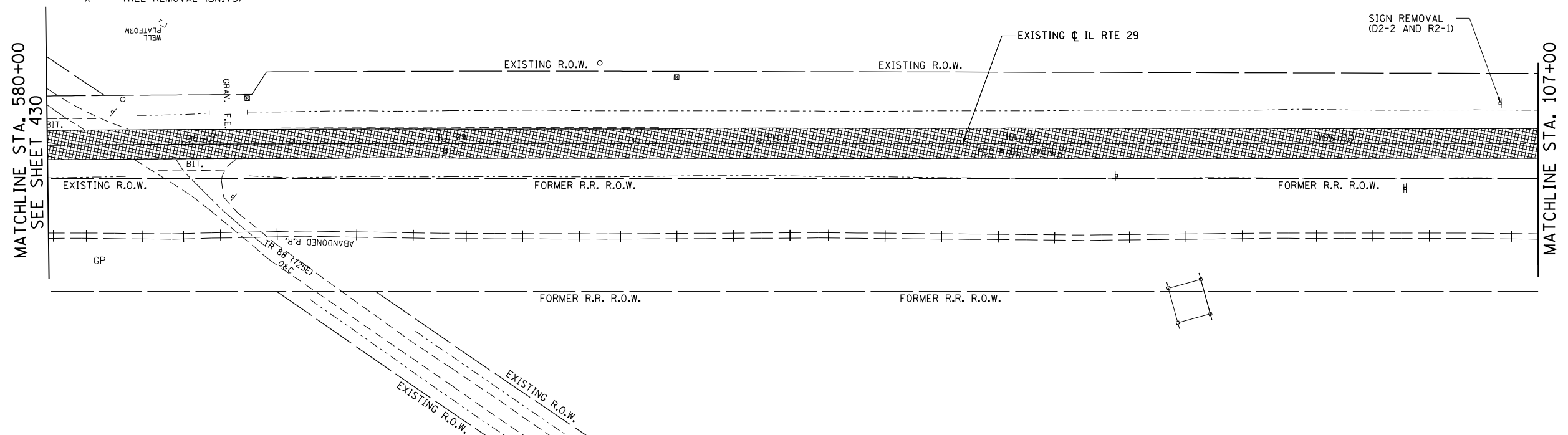

| REVISIONS |      |
|-----------|------|
| NAME      | DATE |
|           |      |
|           |      |
|           |      |
|           |      |
|           |      |
|           |      |
|           |      |

ILLINOIS DEPARTMENT OF TRANSPORTATION

**REMOVAL PLAN**  
EXISTING IL RTE. 29

SCALE: 1" = 50'  
DATE: 03/06/2012

DRAWN BY: B.M.B.  
CHECKED BY: J.M.M.

Default  
L:\DOT\0306601\Draw\Sheets\0306601\Draw\72829-sht-REM-029.dgn  
4/23/2012