

F.A. RTE.	SECTION	COUNTY	TOTAL SHEETS	SHEET NO.
75	84-12; 11-3		729	526
STA. 1457+00.00 TO STA. 1459+00.00				
FED. ROAD DIST. NO. 5 ILLINOIS FED. AID PROJECT				
SANGAMON AND CHRISTIAN				
110	120	130	140	

DATE	
BY	
NO.	
NO.	
NO.	
NO.	

DATE	
BY	
NO.	
NO.	
NO.	
NO.	

DATE = 2/15/2012
 FILE NAME = 0672829.DWG
 PLOT SCALE = 1" = 20'
 REFERENCE = SHEET #

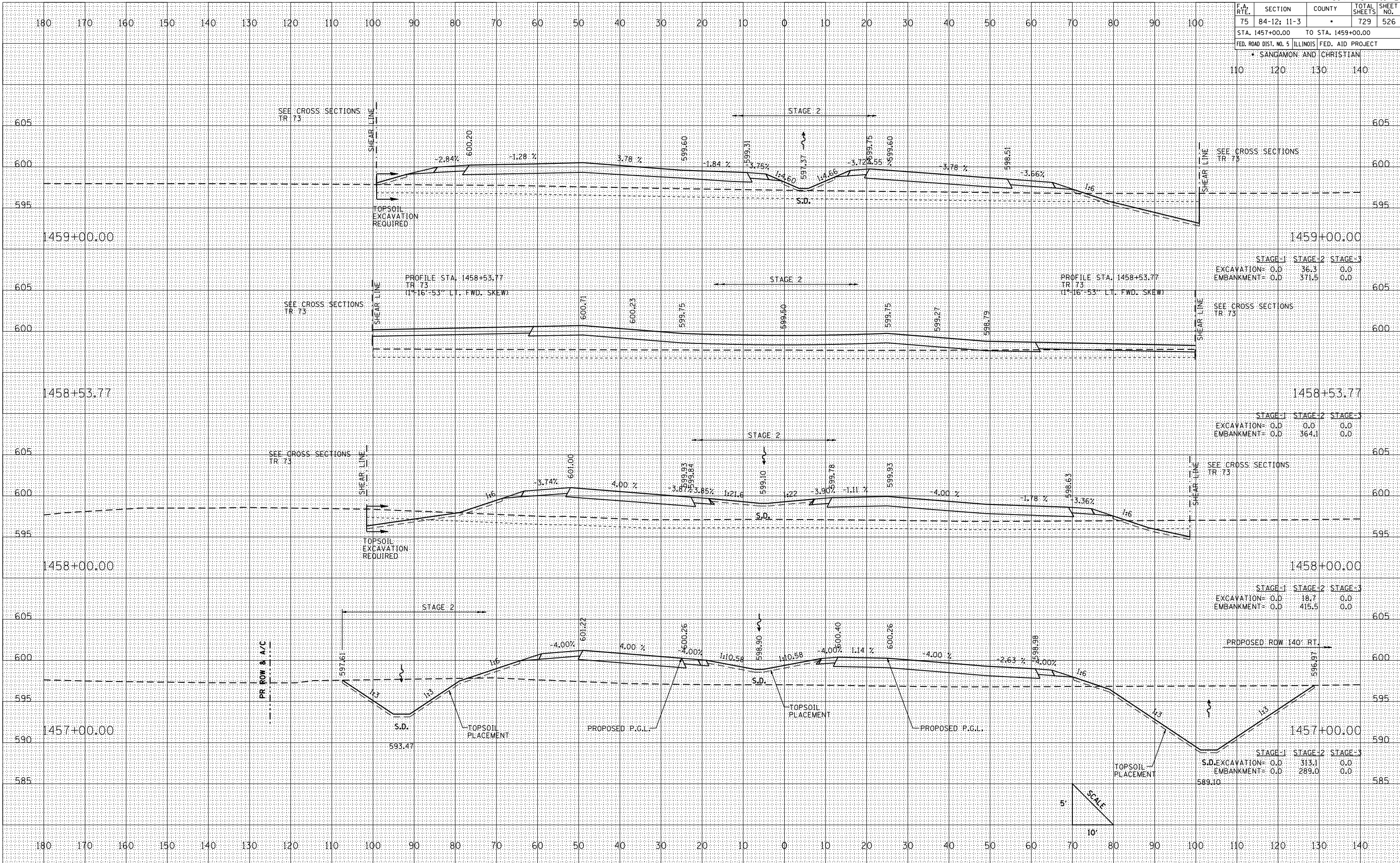

CROSS SECTIONS: IL RTE. 29 - STA. 1457+00 TO STA. 1459+00