

F.A. RTE.	SECTION	COUNTY	TOTAL SHEETS	SHEET NO.
75	84-12; 11-3		729	639
STA. 103+00.00		TO STA. 106+00.00		

FED. ROAD DIST. NO. 5 ILLINOIS FED. AID PROJECT

SANGAMON AND CHRISTIAN

EX ROW & A/C

BY:	DATE:

BY:	DATE:

ORIGINAL SURVEY
 SURVEYED
 PLOTTED
 REVISIONS
 AREAS CHECKED
 NO.

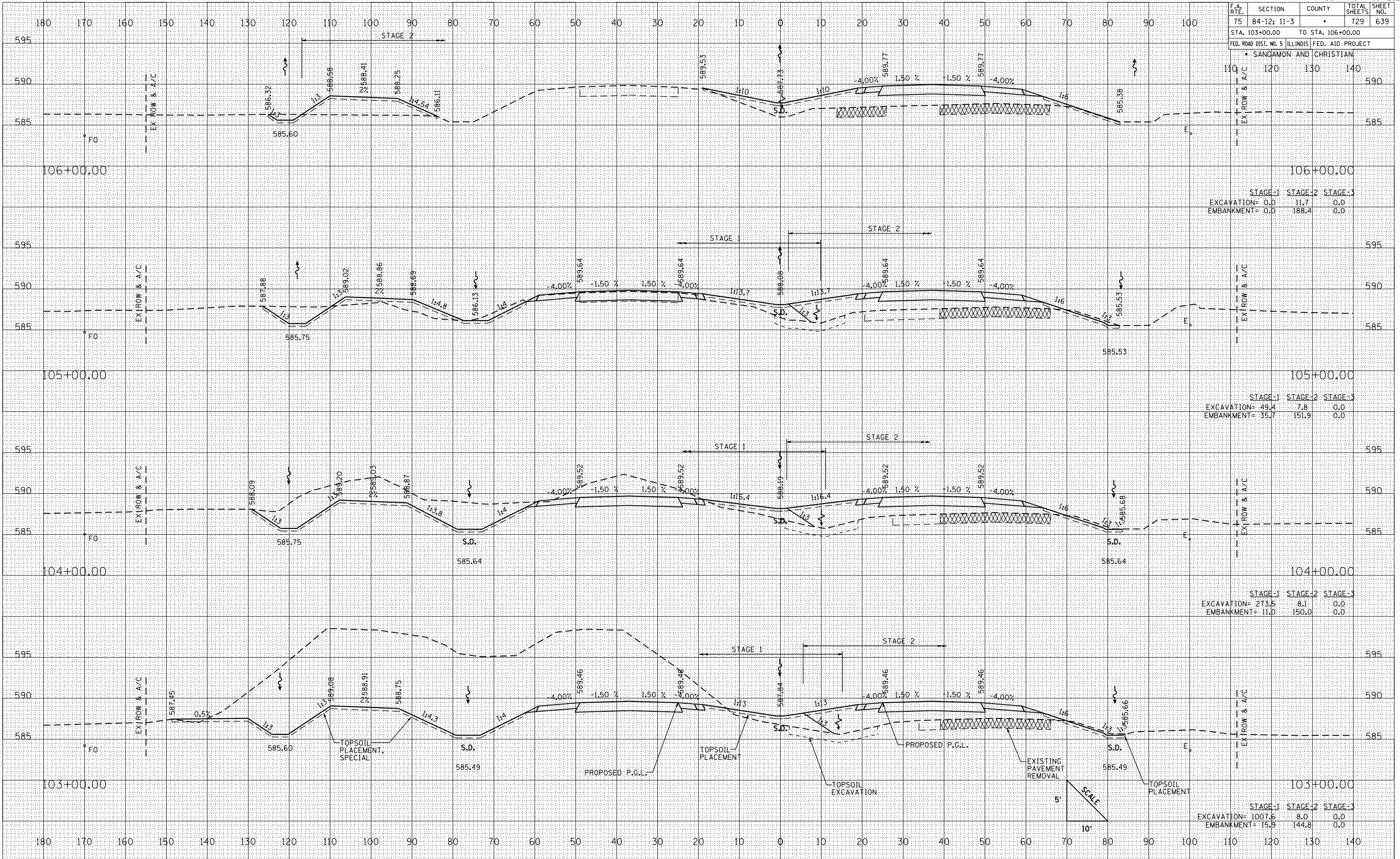

STAGE-1	STAGE-2	STAGE-3
EXCAVATION= 0.0	11.7	0.0
EMBANKMENT= 0.0	188.4	0.0

STAGE-1	STAGE-2	STAGE-3
EXCAVATION= 49.4	7.8	0.0
EMBANKMENT= 35.7	151.9	0.0

STAGE-1	STAGE-2	STAGE-3
EXCAVATION= 273.5	8.1	0.0
EMBANKMENT= 11.0	150.0	0.0

STAGE-1	STAGE-2	STAGE-3
EXCAVATION= 1007.6	8.0	0.0
EMBANKMENT= 15.9	144.8	0.0

CROSS SECTIONS: IL RTE. 29 - STA. 103+00 TO STA. 106+00