

HMA SHOULDERS SHALL BE PLACED MONOLITHICALLY WITH HMA SURFACE.

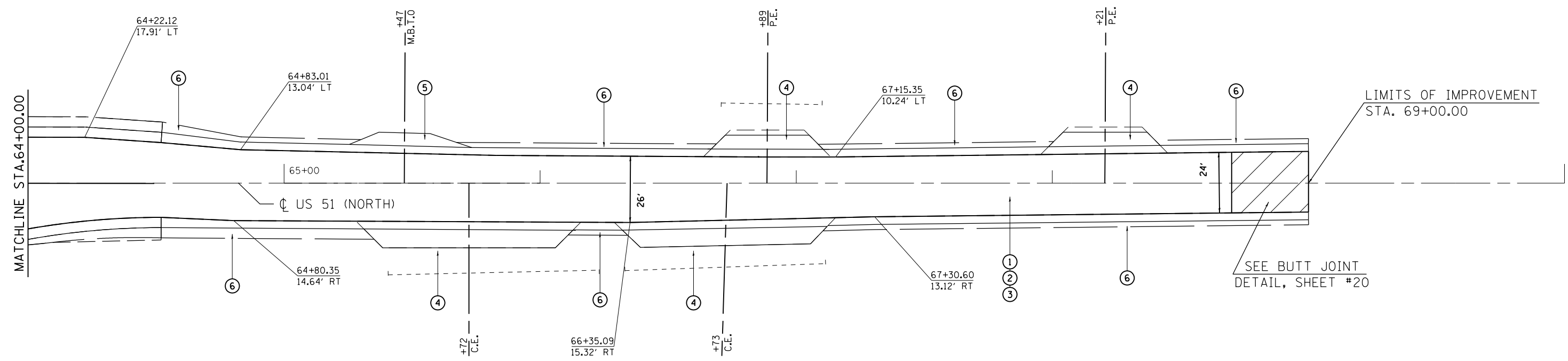

LEGEND	
①	PROPOSED HOT-MIX ASPHALT SURFACE REMOVAL - 3/4"
②	PROPOSED LEVELING BINDER (MACHINE METHOD) - 3/4"
③	PROPOSED HOT-MIX ASPHALT SURFACE COURSE, MIX "D", N70 - 1 1/2"
④	PROPOSED INCIDENTAL HMA SURFACING
⑤	PROPOSED MAILBOX TURNOUT
⑥	PROPOSED AGGREGATE SHOULDER, TYPE B

FILE NAME =	USER NAME = sparksgw	DESIGNED -	REVISED -
ei:\pwork\pwork\sparksgw\0300761\067238-sht-US51.pln.dgn		DRAWN -	REVISED -
	PLOT SCALE = 40.0000' / in.	CHECKED -	REVISED -
	PLOT DATE = Mar-28-2012 08:59:30AM	DATE -	REVISED -

**STATE OF ILLINOIS
DEPARTMENT OF TRANSPORTATION**

**US 51
PLAN SHEETS**

SCALE: 20 SHEET 1 OF 1 SHEETS STA. 64+00.00 TO STA. 69+00.00

F.A.P. RTE.	SECTION	COUNTY	TOTAL SHEETS	SHEET NO.
322	(14)RS-4 & (43)RS-7	CHRISTIAN	23	16
CONTRACT NO. 72F38			ILLINOIS FED. AID PROJECT	