

PROP. CURVE MOT101
 PI STA. = 1+90.54
 $\Delta = 89^\circ 41' 57''$ (LT)
 D = 57' 17' 45"
 R = 100.00'
 T = 99.48'
 L = 156.55'
 E = 41.05'
 e = ----
 T.R. = ----
 S.E. RUN = ----
 P.C. STA = 0+91.06
 P.T. STA = 2+47.62

PROP. CURVE MOT102
 PI STA. = 3+46.95
 $\Delta = 89^\circ 36' 50''$ (RT)
 D = 57' 17' 45"
 R = 100.00'
 T = 99.33'
 L = 156.41'
 E = 40.95'
 e = ----
 T.R. = ----
 S.E. RUN = ----
 P.C. STA = 2+47.62
 P.T. STA = 4+04.02

TEMPORARY PAVEMENT MARKING
 LINE 4" YELLOW (TYPICAL)
 TEMPORARY PAVEMENT MARKING
 LINE 12" YELLOW (TYPICAL)

TEMPORARY PAVEMENT MARKING
 LINE 12" WHITE (TYPICAL)
 TEMPORARY PAVEMENT MARKING
 LINE 4" WHITE (TYPICAL)

STA 1+40.00 TO STA 5+00.00
 360' SURFACE MOUNT LANE SEPARATOR
 ALONG C OF RUNAROUND

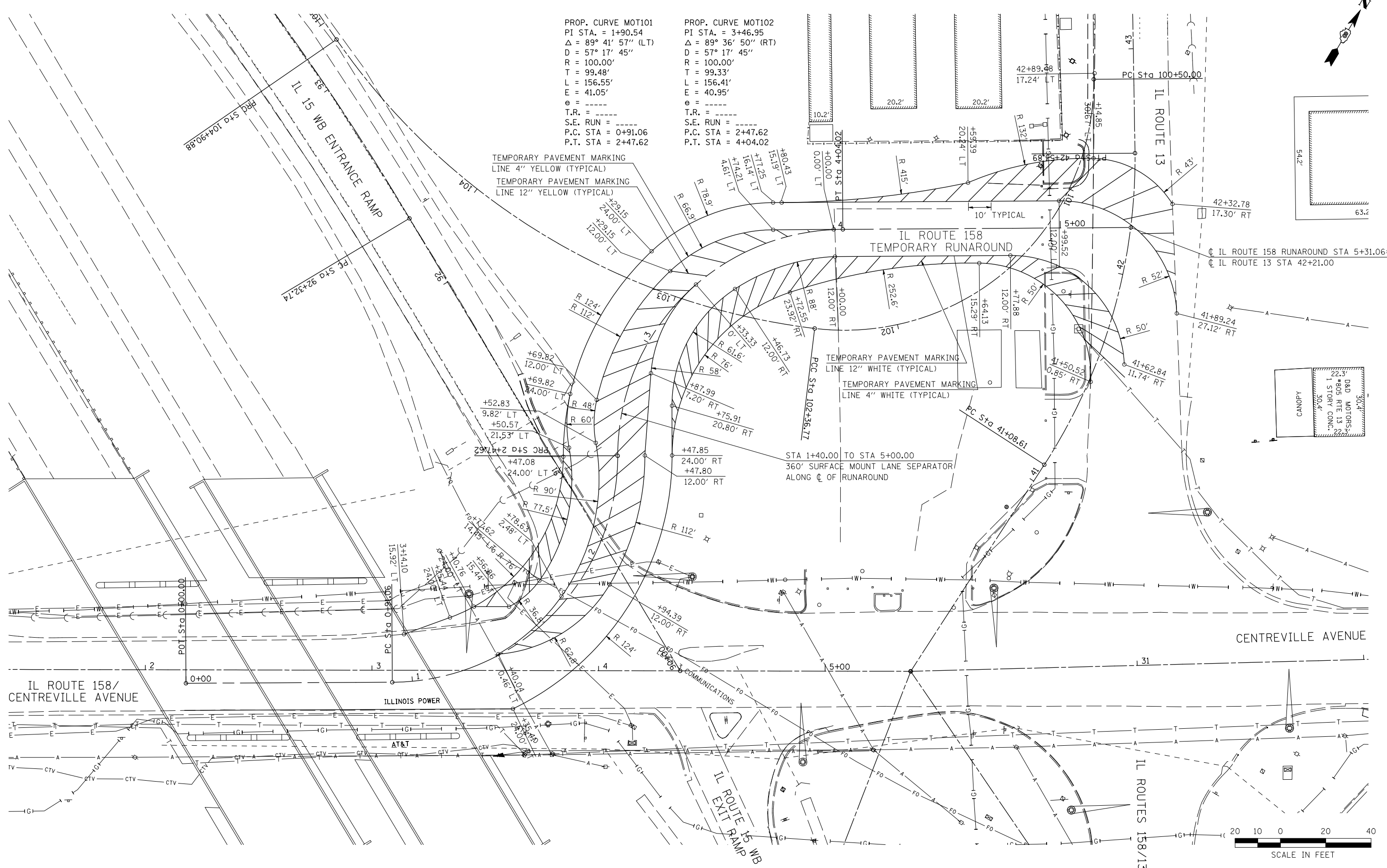

LAST SAVED = 3/20/2012
 PEN TABLE = V8-H4C1F143
 PLOT DRIVER = TR-18pdf-Block-Half.plt

FILE NAME =	USER NAME = beriechmann	DESIGNED -	REVISED -
1:\0906600\0906603\cad\plans\016-D876006-Sht-Plan-Runaround.dgn		DRAWN -	REVISED -
		CHECKED -	REVISED -
		DATE -	REVISED -
PLOT SCALE = 40.0000' / IN.			
PLOT DATE = 3/20/2012 4:10:37 PM			

STATE OF ILLINOIS
DEPARTMENT OF TRANSPORTATION



PLAN
 IL ROUTE 158 TEMPORARY RUNAROUND
 SCALE: 1" = 20'
 SHEET NO. 1 OF 1 SHEETS
 STA. 0+00.00 TO STA. 5+31.06

① F.A.P. RTE 809 / F.A.U. RTE 9251 / F.A.U. RTE 9269			
F.A. RTE.	SECTION	COUNTY	TOTAL SHEET NO.
①	135-N	ST. CLAIR	206 48
			CONTRACT NO. 76D06
ILLINOIS FED. AID PROJECT			