

STAGE C2 - DETOUR SIGNING

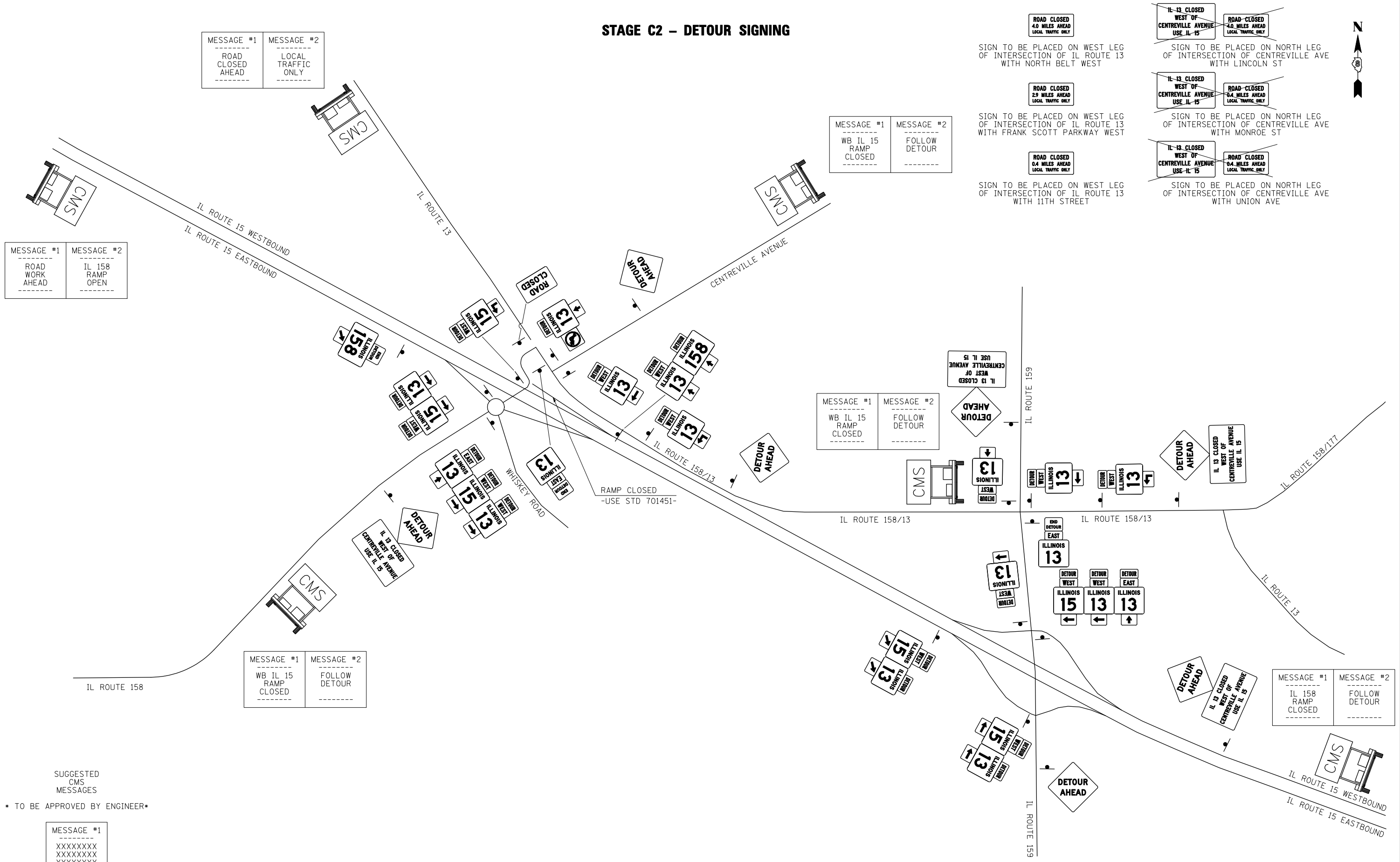

MESSAGE #1
ROAD CLOSED AHEAD

MESSAGE #2
LOCAL TRAFFIC ONLY

MESSAGE #1
ROAD WORK AHEAD

MESSAGE #2
IL 158 RAMP OPEN

MESSAGE #1
WB IL 15 RAMP CLOSED

MESSAGE #2
FOLLOW DETOUR

MESSAGE #1
WB IL 15 RAMP CLOSED

MESSAGE #2
FOLLOW DETOUR

MESSAGE #1
WB IL 15 RAMP CLOSED

MESSAGE #2
FOLLOW DETOUR

MESSAGE #1
IL 158 RAMP CLOSED

MESSAGE #2
FOLLOW DETOUR

SUGGESTED CMS MESSAGES

* TO BE APPROVED BY ENGINEER *

MESSAGE #1
XXXXXXXXXX
XXXXXXXXXX
XXXXXXXXXX

NOT TO SCALE

LAST SAVED = 2/20/2012
PEN TABLE = V8-HA-1C-143
PLOT DRIVER = TR-18pdf-Block-Half.plt

FILE NAME =	USER NAME = beriechmann	DESIGNED -	REVISED -
1:\0906600\0906603\cad\t\plans\031-D876006-Sht-Staging-DeTours.dgn		DRAWN -	REVISED -
PLOT SCALE = 100.0000' / IN.		CHECKED -	REVISED -
PLOT DATE = 3/20/2012 4:11:47 PM		DATE -	REVISED -

STATE OF ILLINOIS
DEPARTMENT OF TRANSPORTATION

HORNER &
SHIRIN, INC.
ENGINEERS

DETOUR ROUTE PLANS
STAGE C2 - DETOUR SIGNING

SCALE: NONE SHEET NO. 17 OF 23 SHEETS STA. TO STA.

① F.A.P. RTE 809 / F.A.U. RTE 9251 / F.A.U. RTE 9269			
F.A. RTE.	SECTION	COUNTY	TOTAL SHEETS
①	135-N	ST. CLAIR	206
			SHEET NO. 67
CONTRACT NO. 76D06			
ILLINOIS FED. AID PROJECT			