

**STATE OF ILLINOIS
DEPARTMENT OF TRANSPORTATION
DIVISION OF HIGHWAYS**

PLAT OF HIGHWAYS

**FAP ROUTE 809 (IL 158)
AT IL 15 & IL 13
SECTION 135-N
ST. CLAIR COUNTY
JOB NO. R-98-001-10**

SHEET INDEX		
SHEET NO.	STATION TO STATION	DESCRIPTION
1	N/A	COVER
2	N/A	LEGEND & GENERAL NOTES
3	53+00-50+00	PARCEL 80001011
4	53+00-51+00	PARCEL 80001012
5	0+00-5+00	PLAT OF HIGHWAY- EX ROW
6	30+00-34+00	PARCEL 80001015, 80001016
7	32+00-36+00	PLAT OF HIGHWAY- EX ROW
8	30+00-33+00	PARCEL 80001013
9	N/A	TOTAL HOLDINGS
10	N/A	REFERENCE TIES

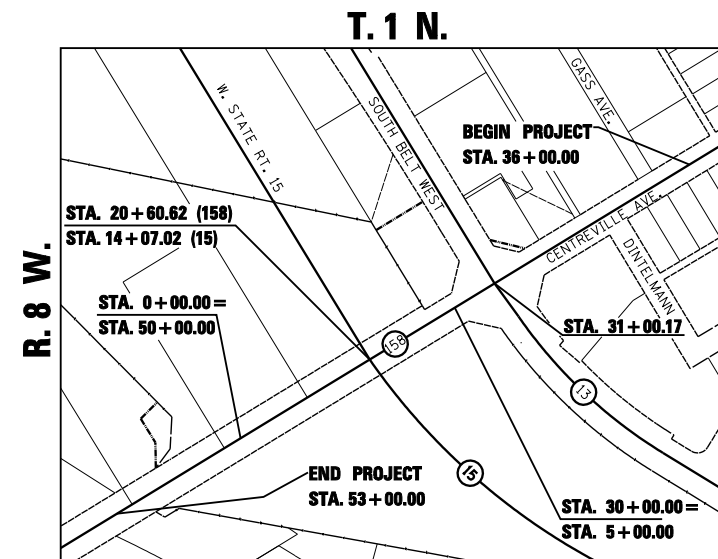

PROJECT LENGTH = 1,437.78 LIN. FT. = 0.2723 MILES

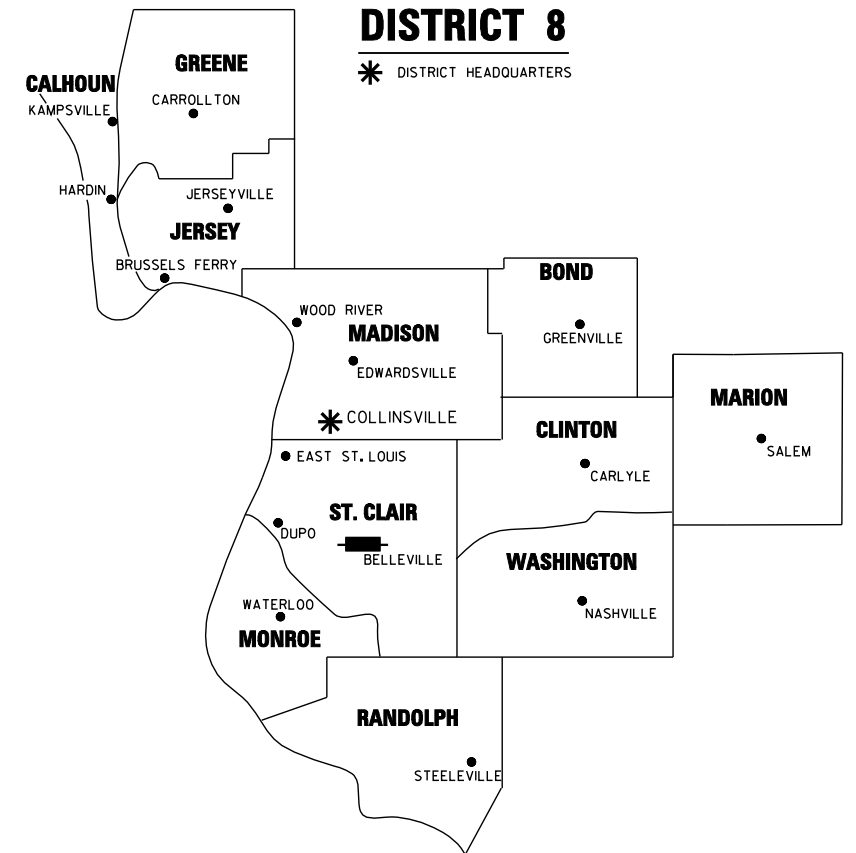

PREPARED BY:



Engineering
Architecture
Surveying

800 South Vandeventer Avenue
St. Louis, MO 63110
(314) 534-1030

ILLINOIS LICENCE NO: 184-000485
Expiration Date: April 30, 2013

RONNIE D. LOWE, PLS NO. 035-003363
LICENSE EXPIRATION DATE: 11/30/2012

SHEET 1 OF 10

ILLINOIS DEPARTMENT OF TRANSPORTATION DIVISION OF HIGHWAYS/REGION 5/DISTRICT 8 1102 EASTPORT PLAZA DRIVE COLLINSVILLE, ILLINOIS 62234-6198				
F.A. RTE.	SECTION	COUNTY	TOTAL SHEETS	SHEET NO.
809	135-N	ST. CLAIR	206	89
CONTRACT NO. 76D06				
FED. ROAD DIST. NO.		ILLINOIS FED. AID PROJECT		