

STATE OF MISSOURI )  
 ) SS  
 CITY OF ST. LOUIS )

I, RONNIE D. LOWE, AN ILLINOIS PROFESSIONAL LAND SURVEYOR, CERTIFY THAT I HAVE SURVEYED THE PLAT OF HIGHWAY SHOWN HEREON AND THAT THIS PROFESSIONAL SERVICE CONFORMS TO THE CURRENT ILLINOIS MINIMUM STANDARDS FOR A BOUNDARY SURVEY FOR THE PROPOSED PARCEL(S) TO BE ACQUIRED BY THE STATE OF ILLINOIS, DEPARTMENT OF TRANSPORTATION, SHOWN HEREON.

DATED \_\_\_\_\_

RONNIE D. LOWE, PLS NO. 035-003363  
 LICENSE EXPIRATION DATE: 11/30/2012



Engineering  
 Architecture  
 Surveying  
 800 South Vandeventer Avenue  
 St. Louis, MO 63110  
 (314) 534-1030  
 ILLINOIS LICENCE NO: 184-000485  
 Expiration Date: November 30, 2012

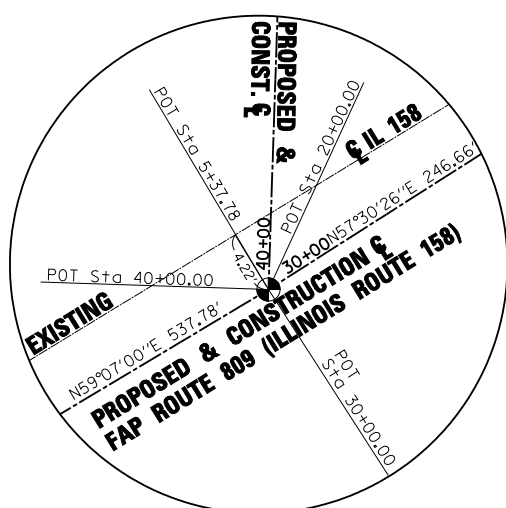

DETAIL C  
 NOT TO SCALE



DETAIL D  
 NOT TO SCALE



DETAIL B  
 NOT TO SCALE

ILLINOIS DEPARTMENT OF TRANSPORTATION  
**PLAT OF HIGHWAYS**  
 FAP ROUTE 809 (IL 158) AT  
 IL 15 & IL 13  
 SECTION 135-N  
 ST. CLAIR COUNTY  
 JOB NO. R-98-001-10  
 DETAILS & TOTAL HOLDINGS

SCALE: 1" = 100' SHEET 9 OF 10

ILLINOIS DEPARTMENT OF TRANSPORTATION DIVISION OF HIGHWAYS/REGION 5/DISTRICT 8 1102 EASTPORT PLAZA DRIVE COLLINSVILLE, ILLINOIS 62234-6198				
F.A. RTE.	SECTION	COUNTY	TOTAL SHEETS	SHEET NO.
809	135-N	ST. CLAIR	206	97
COMPLETION DATE OF FIELD WORK PERFORMED			CONTRACT NO. 76D06	
LAND SURVEY:		ROW STAKING:		
FED. ROAD DIST. NO.		ILLINOIS FED. AID PROJECT		