

* 5-#9 h₁₅ bars at 7" cts. (Back)

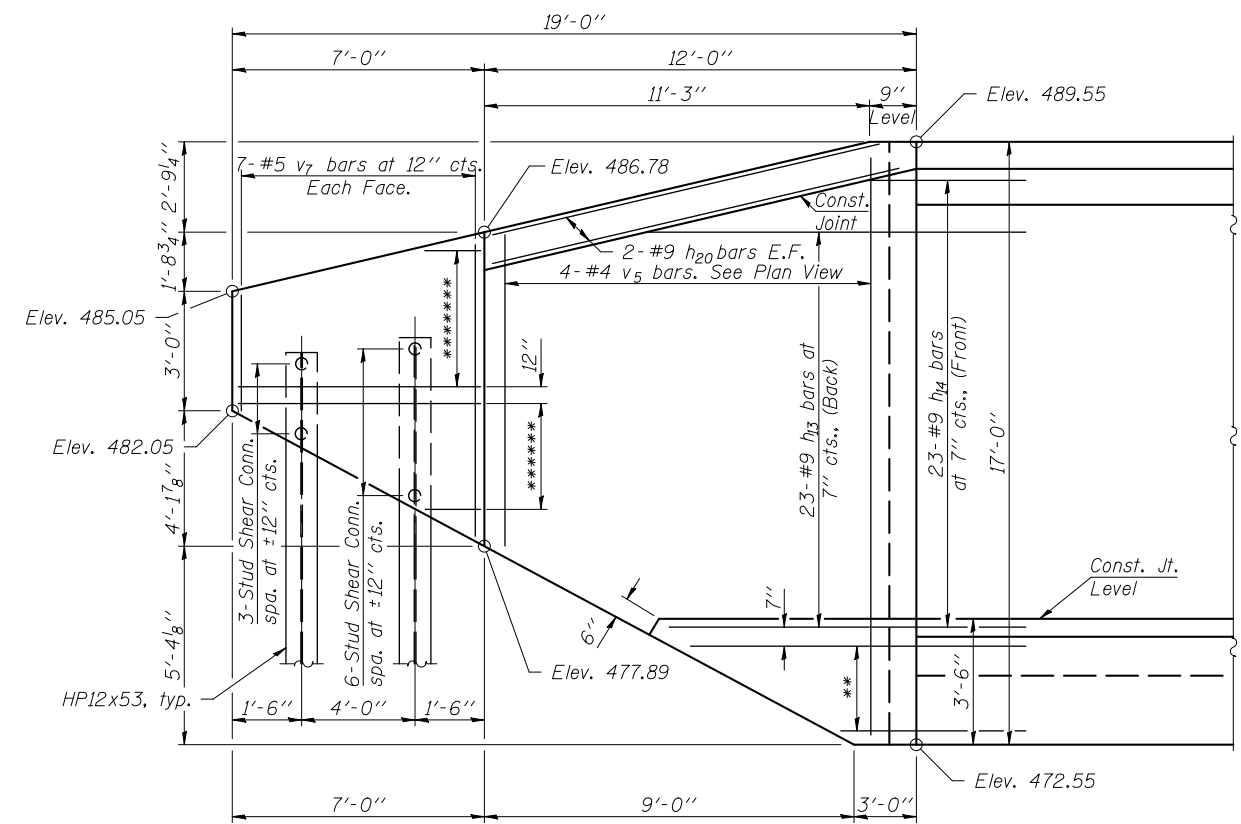
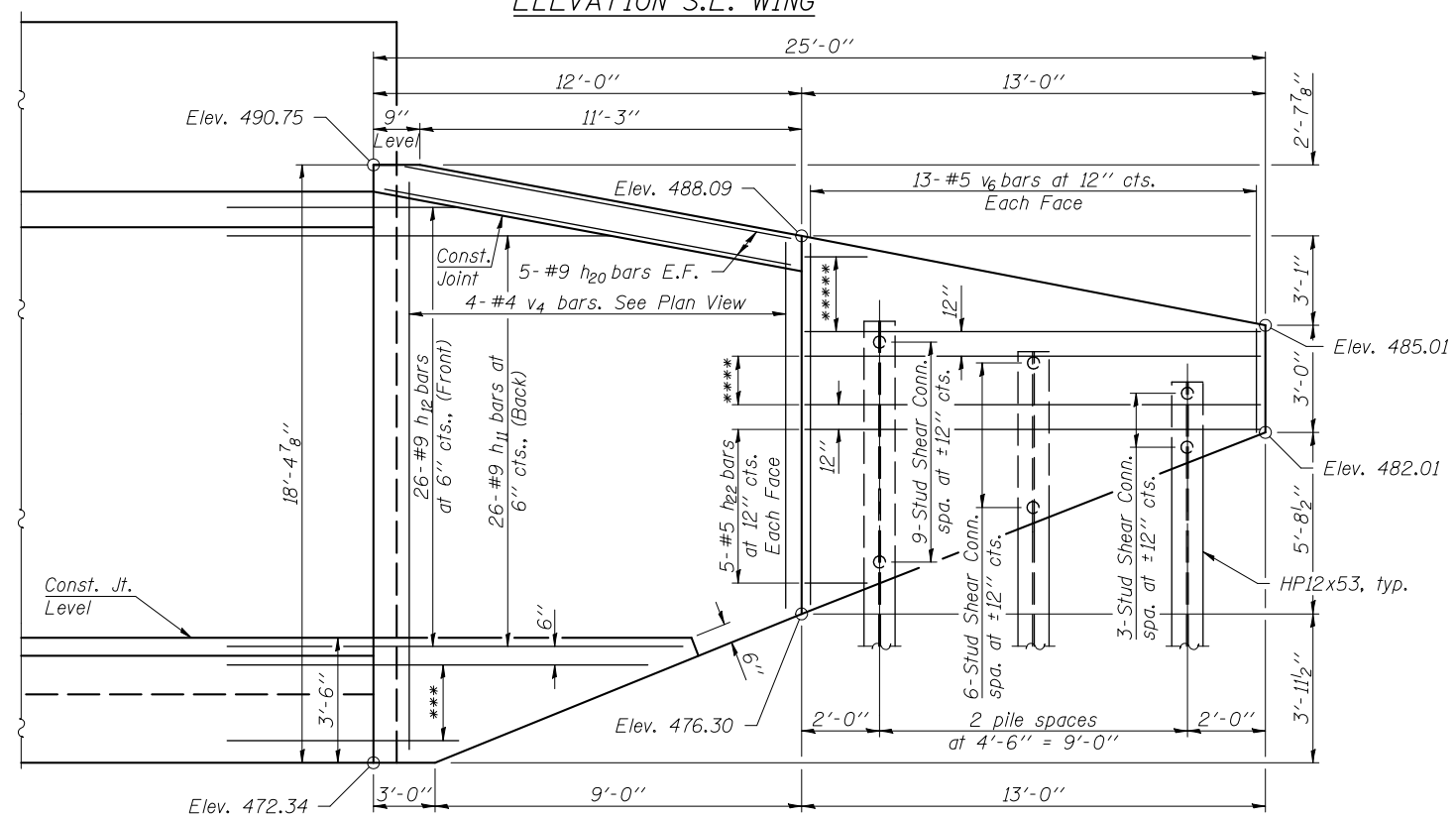

*** 6-#9 h₁₁ bars at 6" cts. (Back)
 ***** 2-#5 h₂₃ bars at 12" cts., Each Face
 ***** 3-#5 h₂₄ bars at 12" cts., Each Face

Note:
 Cut or bend ends of h₁₁, h₁₂, h₁₃, h₁₄, h₁₅, h₁₆, h₂₆, v₄, & v₅ bars in field as needed to fit wall.
 Railing not shown for clarity.
 For additional wingwall details, see sheets 13 & 14 of 20.
 For Bar Bending Diagrams and Bill of Material, see sheet 11 of 20.
 For Soldier Pile Wall details and Bills of Material, see sheets 13 & 14 of 20.

FILE NAME = \\0906600\0906603\Cad\SV_P\10922045-76D06.dgn	DESIGNED - K.A. Klues	REVISED -
USER NAME = kaklues	CHECKED - E.M. Lagemann	REVISED -
PLOT SCALE =	DRAWN - I. Krinitskiy	REVISED -
PLOT DATE = 5/1/2012	CHECKED - EML / KAK	REVISED -

DESIGNED - K.A. Klues	REVISED -
CHECKED - E.M. Lagemann	REVISED -
DRAWN - I. Krinitskiy	REVISED -
CHECKED - EML / KAK	REVISED -

**STATE OF ILLINOIS
 DEPARTMENT OF TRANSPORTATION**

**WINGWALL DETAILS I
 STRUCTURE NO. 082-2045**

F.A.P. RTE. 809	SECTION 135-N	COUNTY ST. CLAIR	TOTAL SHEETS 206	SHEET NO. 155
CONTRACT NO. 76D06			ILLINOIS FED. AID PROJECT	

SHEET NO. 12 OF 20 SHEETS