

DATE	
BY	
SURVEYED	
PLOTTED	
TEMPLATE	
AREAS	
CHECKED	
FINAL SURVEY	
NOTE BOOK	
NO.	

DATE	
BY	
SURVEYED	
PLOTTED	
TEMPLATE	
AREAS	
CHECKED	
ORIGINAL SURVEY	
NOTE BOOK	
NO.	

LAST SAVED = 3/20/2012
 PEN TABLE = 10-Half-103
 PLOT DRIVER = P:\P3D\FBlack-Half.plt

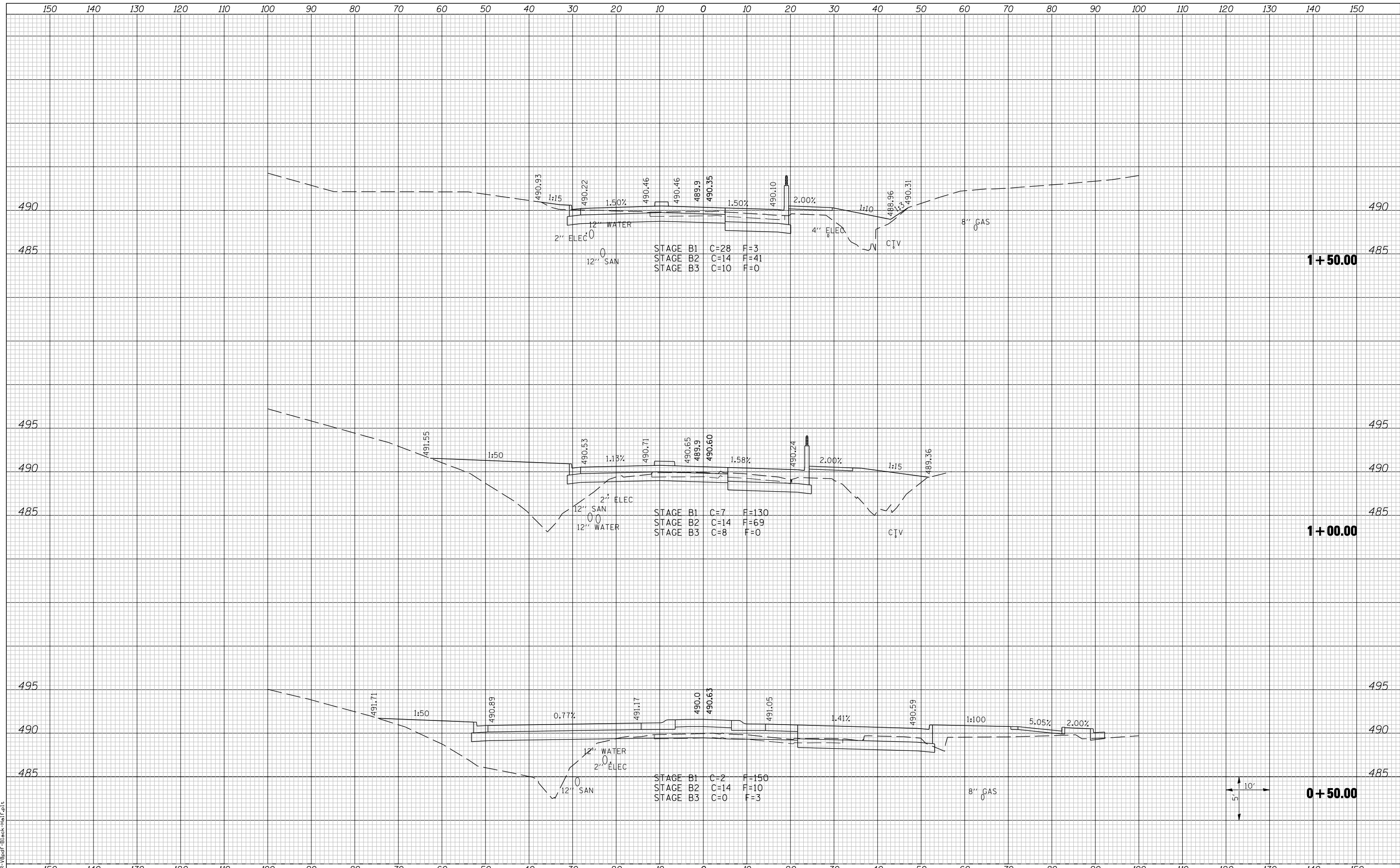

FILE NAME =	USER NAME = beriechmann	DESIGNED -	REVISED -	STATE OF ILLINOIS DEPARTMENT OF TRANSPORTATION		CROSS SECTIONS		F.A. RTE.	SECTION	COUNTY	TOTAL SHEETS	SHEET NO.
	h:\0906600\0906603\ced\t\plans\201-DB76006-Sh-XsSht-IL 158.dgn	DRAWN -	REVISED -			①	135-N	ST. CLAIR	206	170		
	PLOT SCALE = 20.0000 ' / IN.	CHECKED -	REVISED -			①	F.A.P. RTE 809 / F.A.U. RTE 9251	CONTRACT NO. 76D06				
	PLOT DATE = 3/20/2012 4:13:10 PM	DATE -	REVISED -			SCALE:	SHEET NO. 1 OF 4 SHEETS	STA. +50.00 TO STA. 1+50.00				