

150 140 130 120 110 100 90 80 70 60 50 40 30 20 10 0 10 20 30 40 50 60 70 80 90 100 110 120 130 140 150

DATE	
BY	
SURVEYED	
PLOTTED	
TEMPLATE	
AREAS	
CHECKED	
FINAL SURVEY	
NOTE BOOK	
NO.	

DATE	
BY	
SURVEYED	
PLOTTED	
TEMPLATE	
AREAS	
CHECKED	
ORIGINAL SURVEY	
NOTE BOOK	
NO.	

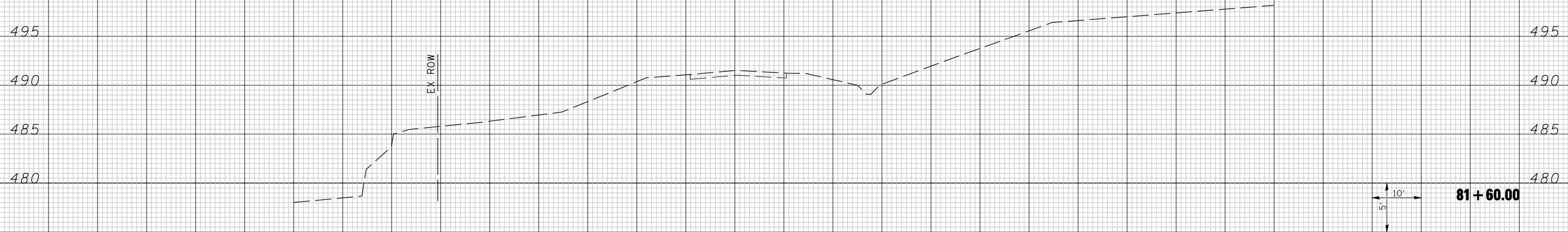

10'
5'
81+60.00

LAST SAVED = 3/20/2012
PEN TABLE = 10-Half-103
PLOT DRIVER = Tr-32pd-F-Black-Half.plt

150 140 130 120 110 100 90 80 70 60 50 40 30 20 10 0 10 20 30 40 50 60 70 80 90 100 110 120 130 140 150

FILE NAME =	USER NAME = beriechmann	DESIGNED -	REVISED -
\\0906600\0906603\ced\plans\205-0876D06-SH\XsSh-IL15EB-Exit.dgn		DRAWN -	REVISED -
		CHECKED -	REVISED -
		DATE -	REVISED -
PLOT SCALE = 20.0000 "/td> <td></td> <td></td> <td></td>			
PLOT DATE = 3/20/2012 4:13:19 PM			

**STATE OF ILLINOIS
DEPARTMENT OF TRANSPORTATION**



CROSS SECTIONS
EASTBOUND IL ROUTE 15 EXIT RAMP

SCALE: SHEET NO. 1 OF 2 SHEETS STA. 81+60.00 TO STA. 81+60.00

F.A. RTE.	SECTION	COUNTY	TOTAL SHEETS	SHEET NO.
①	135-N	ST. CLAIR	206	180
① F.A.P. RTE 809 / F.A.U. RTE 9251			CONTRACT NO. 76D06	
/ F.A.U. RTE 9269 ILLINOIS FED. AID PROJECT				