

- NOTES: 1. SEE TYPICAL SECTIONS, SCHEDULES, GENERAL NOTES, AND DETAILS FOR PAVEMENT PATCHING, HMA SURFACE REMOVAL, AND PAVING REQUIREMENTS.
2. EOP LINES DO NOT GO THROUGH INTERSECTING SIDE ROADS.

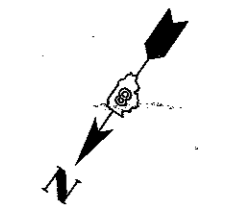

NOT TO SCALE

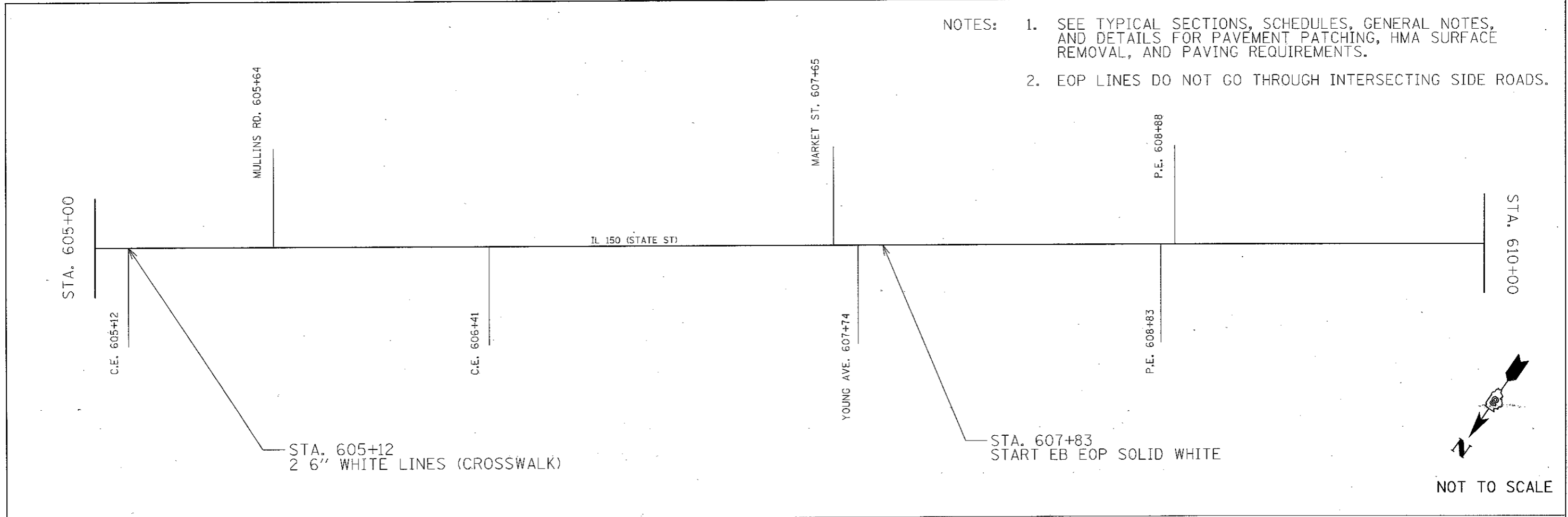
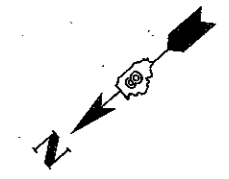
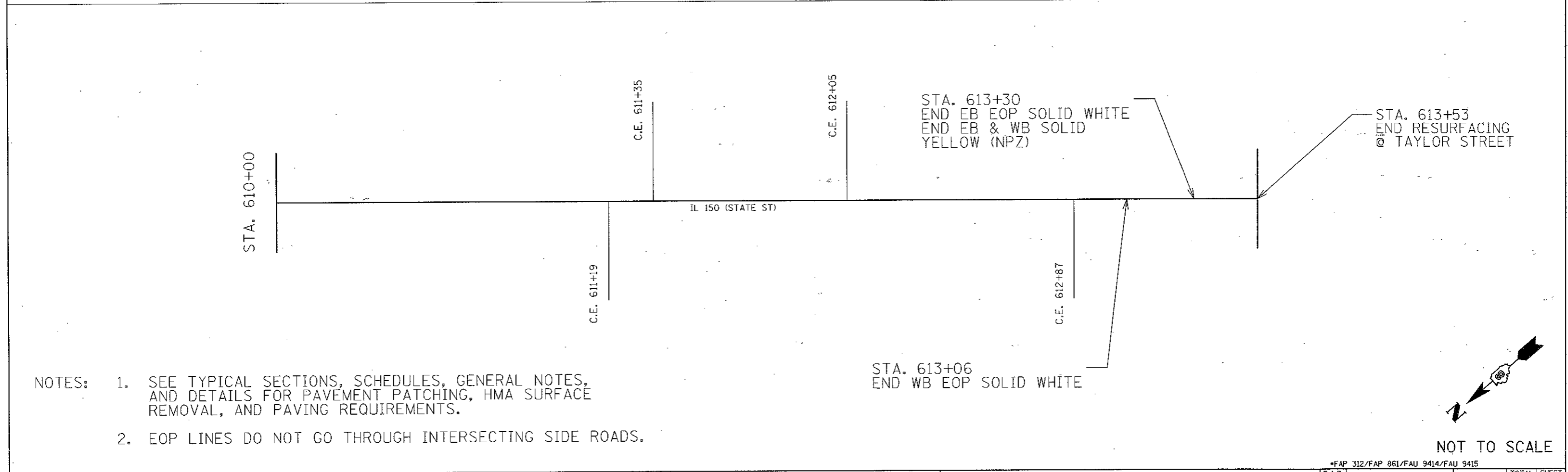

NOT TO SCALE

- NOTES: 1. SEE TYPICAL SECTIONS, SCHEDULES, GENERAL NOTES, AND DETAILS FOR PAVEMENT PATCHING, HMA SURFACE REMOVAL, AND PAVING REQUIREMENTS.
2. EOP LINES DO NOT GO THROUGH INTERSECTING SIDE ROADS.

FILE NAME = USER NAME = karlasol DESIGNED - DRAWN - CHECKED - DATE -				REVISIONS: REVISED - REVISED - REVISED - REVISED -				STATE OF ILLINOIS DEPARTMENT OF TRANSPORTATION				PLAN DIAGRAM				*FAP 312/FAP 861/FAU 9414/FAU 9415																			
PLOT SCALE = 100.0000' / in. PLOT DATE = 3/14/2012								SCALE: NONE SHEET NO. 11 OF 11 SHEETS STA. 605+00 TO STA. 613+53				<table border="1"> <thead> <tr> <th>F.A.P. RTE.</th> <th>SECTION</th> <th>COUNTY</th> <th>TOTAL SHEETS</th> <th>SHEET NO.</th> </tr> </thead> <tbody> <tr> <td>•</td> <td>119, 119-1RS-2, (75-1)RS-2</td> <td>RANDOLPH</td> <td>37</td> <td>25</td> </tr> <tr> <td colspan="3"></td> <td colspan="2">CONTRACT NO. 76E90</td> </tr> <tr> <td colspan="3">FED. ROAD DIST. NO.</td> <td colspan="2">ILLINOIS FED. AID PROJECT</td> </tr> </tbody> </table>				F.A.P. RTE.	SECTION	COUNTY	TOTAL SHEETS	SHEET NO.	•	119, 119-1RS-2, (75-1)RS-2	RANDOLPH	37	25				CONTRACT NO. 76E90		FED. ROAD DIST. NO.			ILLINOIS FED. AID PROJECT	
F.A.P. RTE.	SECTION	COUNTY	TOTAL SHEETS	SHEET NO.																															
•	119, 119-1RS-2, (75-1)RS-2	RANDOLPH	37	25																															
			CONTRACT NO. 76E90																																
FED. ROAD DIST. NO.			ILLINOIS FED. AID PROJECT																																