

NOTE: MEASUREMENTS ARE APPROXIMATE. WHITE STOP LINES AND CROSSWALK LINES SHALL BE PLACED IN THEIR PREVIOUS LOCATIONS

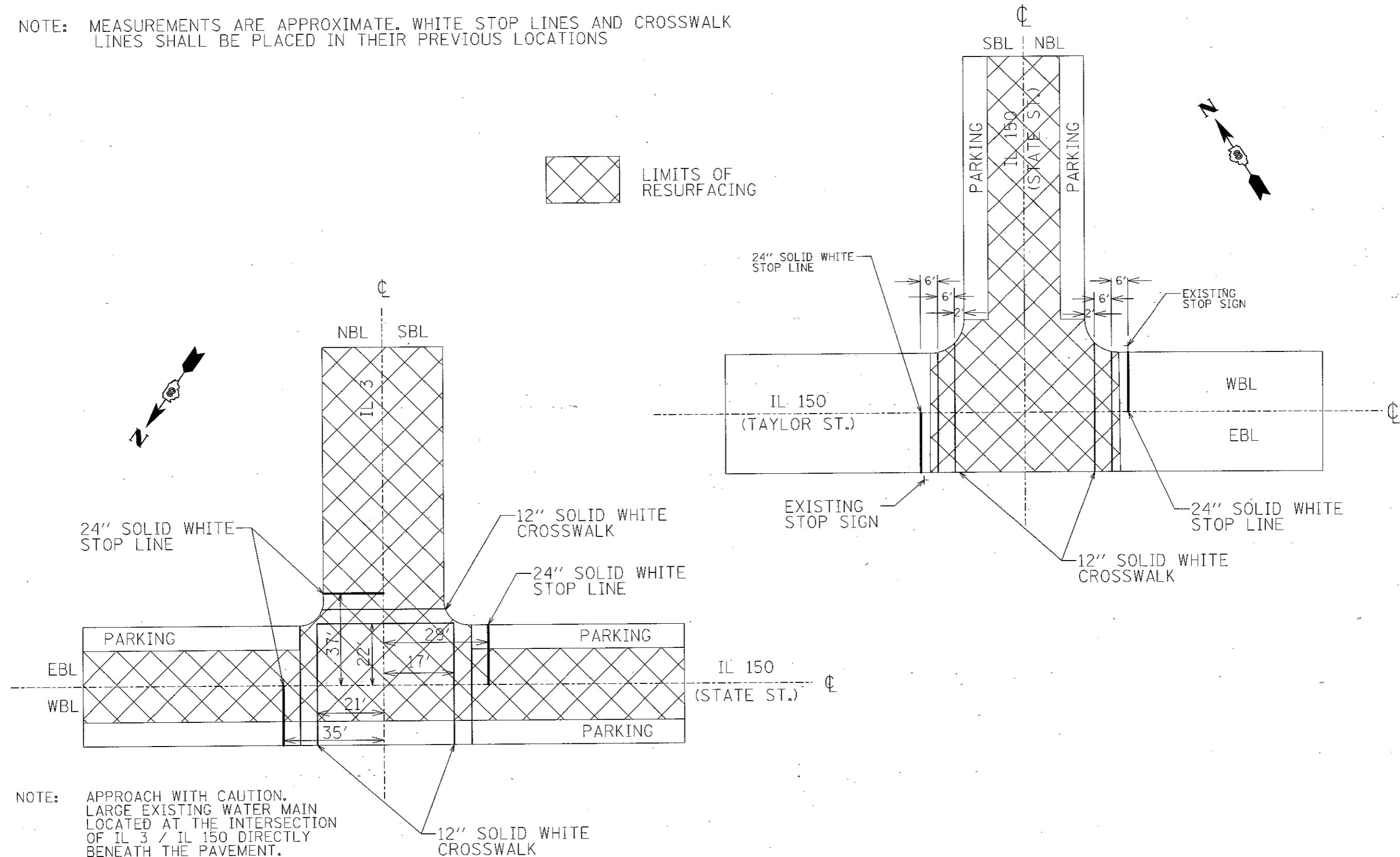

NOTE: APPROACH WITH CAUTION. LARGE EXISTING WATER MAIN LOCATED AT THE INTERSECTION OF IL 3 / IL 150 DIRECTLY BENEATH THE PAVEMENT.

NOT TO SCALE

*FAP 312/FAP 861/FAU 9414/FAU 9415

FILE NAME =	USER NAME = karlesal	DESIGNED -	REVISED -
of\p_work\p\dot\karlesal\1\0254790\0876e98-Design\Lincoln.dgn		DRAWN -	REVISED -
PLOT SCALE = 1/80.0000" / in.		CHECKED -	REVISED -
PLOT DATE = 3/14/2012		DATE -	REVISED -

STATE OF ILLINOIS
DEPARTMENT OF TRANSPORTATION

INTERSECTION DETAILS

SCALE: NONE SHEET NO. 2 OF 2 SHEETS STA. TO STA.

F.A. RTE.	SECTION	COUNTY	TOTAL SHEETS	SHEET NO.
•	(119, 119-1RS-2, 175-1RS-2)	RANDOLPH	37	27
FED. ROAD DIST. NO. ILLINOIS FED. AID PROJECT			CONTRACT NO. 76E90	