

STATE OF ILLINOIS
DEPARTMENT OF TRANSPORTATION

DIVISION OF HIGHWAYS

PROPOSED
HIGHWAY PLANS

FAU ROUTE 5849 (KENNEDY DRIVE)
SECTION 11-00151-00-RS
PROJECT M-5074(089)
CITY OF EAST MOLINE
ROCK ISLAND COUNTY

JOB NO. C-92-107-12

| | | | | |
|---------------------|----------------------------|-----------------------|--------------------|----------------|
| F.A.U. RTE. 5849 | SECTION 11-00-151-00-RS | COUNTY ROCK ISLAND | TOTAL SHEETS 1 | SHEET NO. 1 |
| | | ILLINOIS | CONTRACT NO. 85558 | |

75 +4 = 79

INDEX OF SHEETS

- 1 COVER SHEET & INDEX OF SHEETS
- 2-3 SUMMARY OF QUANTITIES, TYPICAL SECTIONS & GENERAL NOTES
- 4-12 SCHEDULE OF QUANTITIES
- 13-30 PLAN AND PROFILE SHEETS
- 31-53 TRAFFIC CONTROL
- 54 TRAFFIC SIGNAL DETAILS
- 55-59 INTERSECTION DETAILS
- 60-73 CROSS SECTIONS
- 74-75 DETAILS

IDOT STANDARDS

- 280001-06 TEMPORARY EROSION CONTROL SYSTEMS
- 424001-06 PERPENDICULAR CURB RAMPS FOR SIDEWALKS
- 424006 DIAGONAL CURB RAMPS FOR SIDEWALKS
- 424011 CORNER PARALLEL CURB RAMPS FOR SIDEWALKS
- 442101-07 CLASS B PATCHES
- 606001-04 CONCRETE CURB TYPE B AND COMBINATION CONC. C&G
- 701006-03 OFF-ROAD OPERATIONS, 2L, 2W, 15' TO 24" FROM PAVEMENT EDGE
- 701101-02 OFF-ROAD OPERATIONS, MULTILANE, 15' TO 24" FROM PAVEMENT EDGE
- 701301-04 LANE CLOSURE, 2L, 2W, SHORT TIME OPERATIONS
- 701311-03 LANE CLOSURE, 2L, 2W, MOVING OPERATIONS - DAY ONLY
- 701427 LANE CLOSURE, MULTI-LANE, INTERMITTENT OR MOVING OPERATIONS
- 701501-06 URBAN LANE CLOSURE 2L, 2W, UNDIVIDED
- 701502-04 URBAN LANE CLOSURE, 2L, 2W, WITH BI-DIRECTIONAL LEFT TURN
- 701606-08 URBAN LANE CLOSURE, 2L, 2W, WITH MOUNTABLE MEDIAN
- 701701-08 URBAN LANE CLOSURE, MULTI-LANE INTERSECTION
- 701801-05 SIDEWALK, CORNER OR CROSSWALK CLOSURE
- 701901-02 TRAFFIC CONTROL DEVICES
- 720001-01 SIGN PANEL MOUNTING DETAILS
- 720006-03 SIGN PANEL ERECTION DETAILS
- 720011-01 METAL POSTS FOR SIGNS, MARKERS & DELINEATORS
- 728001-01 TELESCOPING STEEL SIGN SUPPORT
- 729001-01 APPLICATION OF TYPES A & B METAL POSTS (FOR SIGNS & MARKERS)
- 780001-03 TYPICAL PAVEMENT MARKINGS



SECTION 11-00-151-00-RS
KENNEDY DRIVE
ENDS AT STA. 132+45.15

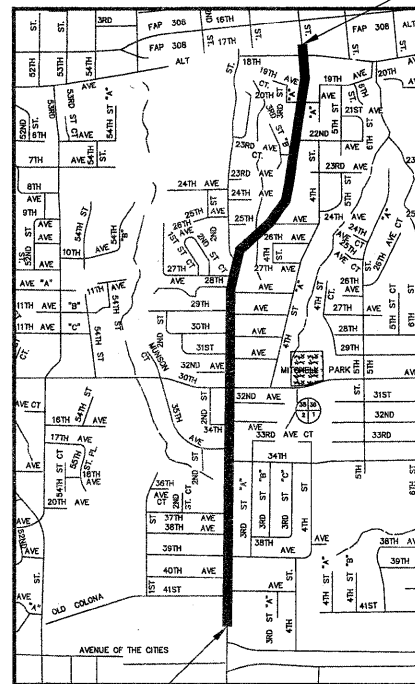

LOCATION MAP

SECTION 11-00-151-00-RS
KENNEDY DRIVE
BEGINS AT STA. 49+52.66

PLANS PREPARED FOR:

City of East Moline Engineering

PLANS PREPARED BY:

SHIVEHATTERY
ARCHITECTURE+ENGINEERING

1701 River Drive Suite 200 | Moline, Illinois 61265
309.764.7650 | fax: 309.764.8616 | shive-hattery.com
Iowa | Illinois | Missouri Illinois Firm Number: 184-000214

I HEREBY CERTIFY THAT THESE PLANS WERE PREPARED BY ME OR UNDER MY DIRECT PERSONAL SUPERVISION, AND THAT I AM A DULY REGISTERED PROFESSIONAL ENGINEER UNDER THE LAWS OF THE STATE OF ILLINOIS.

Patrick R. Lynch 4/23/12
PATRICK R. LYNCH, P.E. DATE
IL. REG. #062-057554 EXP. 11/30/13

AGENCY RESPONSIBLE FOR LETTING

Approved 04-23-12 (DATE)
Theresa [Signature]
Local Agency Position

Passed _____ (DATE) April 24, 2012
Patrick R. Lynch
(SIGNATURE)
District # Engineer of Local Roads & Streets

Releasing for Bid Based on Limited Review
(DATE) April 24, 2012
[Signature]
(SIGNATURE)
Deputy Director of Highways, Region # Engineer

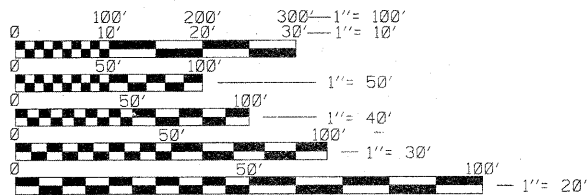

FULL SIZE PLANS HAVE BEEN PREPARED USING STANDARD ENGINEERING SCALES. REDUCED SIZED PLANS WILL NOT CONFORM TO STANDARD SCALES. IN MAKING MEASUREMENTS ON REDUCED PLANS, THE ABOVE SCALES MAY BE USED.

J.U.L.I.E.
JOINT UTILITY LOCATION INFORMATION FOR EXCAVATION

1-800-892-0123
OR 811

FUNCTIONAL CLASSIFICATION: ARTERIAL
2012 ADT: 8300 11% TRUCKS
DESIGN SPEED: 35 MPH
3R POLICY

GROSS LENGTH = 8292.49 FT. = 1.571 MILE
NET LENGTH = 8292.49 FT. = 1.571 MILE

CONTRACT NO. 85558

PRINTED BY THE AUTHORITY
OF THE STATE OF ILLINOIS