

SEQUENCE OF WORK

STAGE I

- * RELOCATE EXISTING LIGHT POLES AND WATERMAIN ALONG BOTH SIDES OF IL 113.
- * CLOSE WILL ROAD TO ALL TRAFFIC NORTH OF IL 113.
- * CUT CLAYPOOL DRAINAGE DITCH (DITCH EAST SIDE OF WILL ROAD AND EXTEND 9X3 BOX CULVERT NORTH AND SOUTH FROM IL 113)
- * CONSTRUCT 6' X 3' BOX CULVERT FROM NORTH END TO A POINT THAT ALLOWS FOR PLACEMENT OF THE INLET LEFT OF STA. 161+56.34. BLOCK END OF CULVERT AND BACKFILL.
- * CONSTRUCT STORM SEWERS ON THE NORTH SIDE OF IL 113, ON WILL ROAD, AND ON THE SOUTH SIDE OF IL 113 WEST OF WILL ROAD.
- * CONSTRUCT STORM SEWER ON THE SOUTH SIDE OF IL 113, EAST OF WILL ROAD, BUT PLUG INLETS AT STA. 164+30 AND STA.165+50 TO PREVENT WATER FROM FLOWING WEST TO OUTFALL AT STA. 161+56 +/-.

STAGE II

- * CLOSE WILL ROAD IN ACCORDANCE WITH THE TRAFFIC CONTROL PLAN SOUTH OF IL 113.
- * CONSTRUCT IL 113 PAVEMENT WIDENING ALONG THE SOUTH EDGE OF PAVEMENT TO TOP OF BASE COURSE AND PLACE VARIABLE THICKNESS LEVELING BINDER OVER IL 113. GAP CURB AND GUTTER 20' EACH SIDE OF INLETS TO BE CONSTRUCTED AT STA. 161+56.34. (NOTE - CONSTRUCTION OF CROSS ROAD CULVERT AT STA. 161+56.34 WILL BE DELAYED TO A FUTURE STAGE.)
- * CONSTRUCT WILL ROAD IMPROVEMENTS SOUTH OF IL 113.

STAGE III

- * CONSTRUCT IL 113 PAVEMENT WIDENING ALONG THE NORTH EDGE OF PAVEMENT TO TOP OF HMA BASE COURSE.
- * CONSTRUCT WILL ROAD IMPROVEMENTS NORTH OF IL 113
- * SAW CUT PAVEMENT FOR CONSTRUCTION OF 6' X 3' BOX CULVERT.
- * ERECT STAGE IIIA TRAFFIC CONTROL IN ACCORDANCE WITH DETAILS IN THE PLANS.
- * CONSTRUCT 6' X 3' BOX CULVERT TO FIRST JOINT SOUTH OF CENTERLINE OF IL 113, PLUG SOUTH END OF BOX CULVERT, PLACE TEMPORARY SOIL RETENTION SYSTEM, AND BACKFILL TO TOP OF PAVEMENT. THIS WORK SHALL BE CONTINUOUS UNTIL COMPLETED.
- * ERECT STAGE IIIB TRAFFIC CONTROL IN ACCORDANCE WITH DETAILS IN THE PLANS AND CONSTRUCT REMAINDER OF 6' X 3' BOX CULVERT AND BACKFILL TO TOP OF PAVEMENT. THIS WORK SHALL BE CONTINUOUS UNTIL COMPLETED.
- * CONSTRUCT PAVEMENT PATCH, AND CURB AND GUTTER OVER BOX CULVERT.

STAGE IV

- * PLACE LEVELING BINDER AND SURFACE COURSE, AND ALL OTHER WORK TO COMPLETE THE PROJECT.

COST OF TEMPORARY SOIL RETENTION SYSTEM SHALL BE CONSIDERED INCLUDED IN THE COST FOR PRECAST CONCRETE BOX CULVERT.

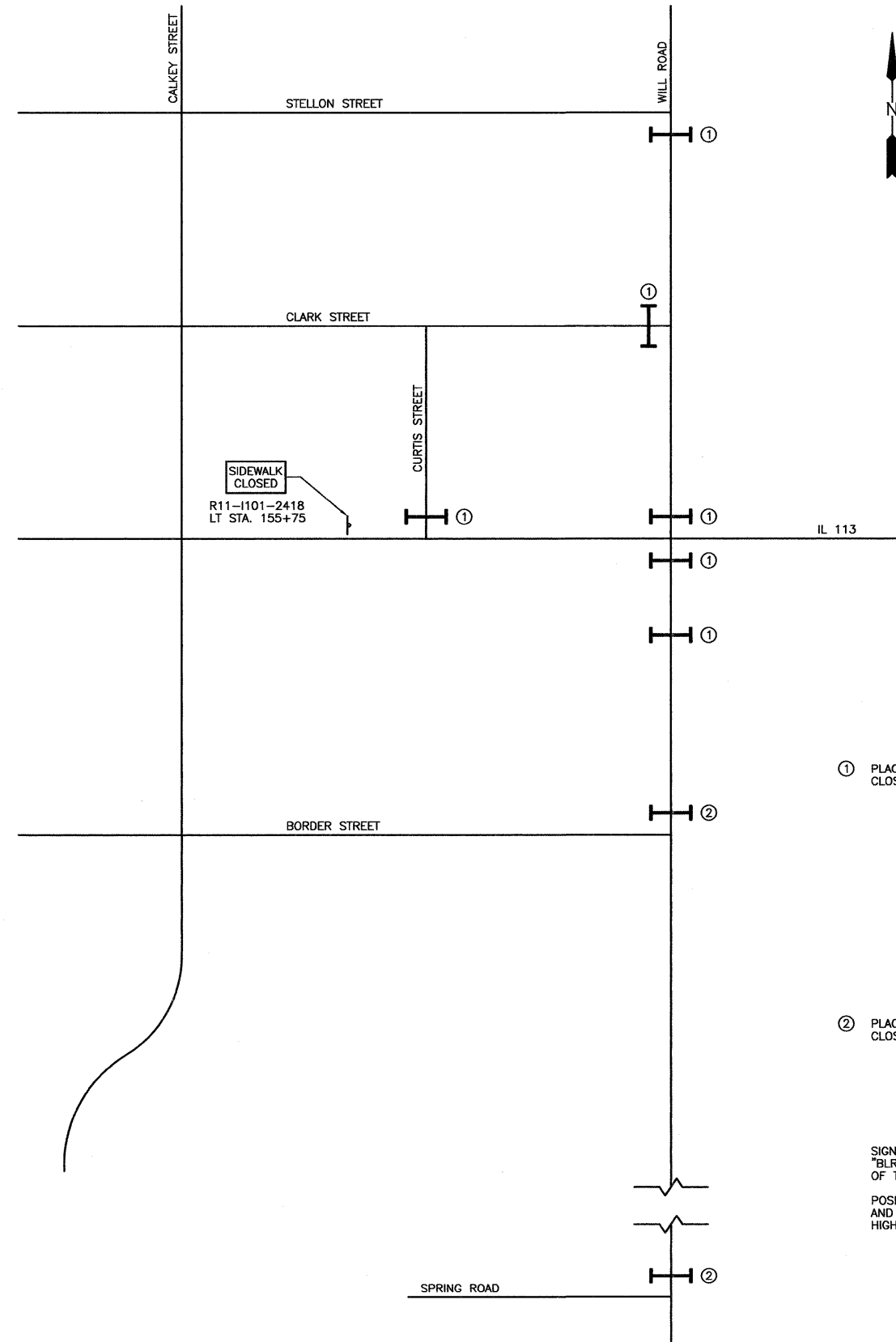

- ① PLACE TYPE III BARRICADES WITH ROAD CLOSED SIGNS:
- ON SOUTH LEG OF WILL ROAD/ STELLON STREET INTERSECTION
 - ON WEST LEG OF WILL ROAD/ CLARK STREET INTERSECTION
 - ON NORTH LEG OF IL 113/ CURTIS STREET INTERSECTION
 - NORTH & SOUTH LEGS OF IL 113/ WILL ROAD INTERSECTION
 - AT STA. 98+25 ON WILL ROAD
- ② PLACE TYPE III BARRICADES WITH ROAD CLOSED TO THRU TRAFFIC SIGNS:
- ON WILL ROAD JUST NORTH OF SPRING ROAD
 - ON WILL ROAD JUST NORTH OF BORDER STREET

SIGNING IN ACCORDANCE WITH HIGHWAY STANDARD "BLR 21 OR BLR 22 SHALL BE PLACED AHEAD OF TYPE III BARRICADES

POSITIONS OF TYPE III BARRICADE AT BORDER STREET AND SPRING ROAD SHALL BE IN ACCORDANCE WITH HIGHWAY STANDARD 701901

**SIDE STREET
TRAFFIC CONTROL PLAN**

CHAMLIN & ASSOCIATES, INC. © 2010

| | | | | |
|-----------------|-----------|----|------|-------------|
| DRAWN BY: NV | REVISIONS | | | |
| CHECKED BY: JKC | LEVEL | BY | DATE | DESCRIPTION |
| DATE: 02/12 | | | | |

PERU MORRIS
 ILLINOIS

FAS 301/FAU 383
SECTION 11-00007-00-WR
VILLAGE OF DIAMOND
GRUNDY AND WILL COUNTIES

STAGE CONSTRUCTION AND TRAFFIC CONTROL PLANS

| | | |
|-------------------------------|----------------------|----------|
| CONSTRUCTION PLANS | CONTRACT NO. 87520 | |
| | CURRENT AS OF: 02/12 | SHEET 28 |
| | SCALE: AS NOTED | OF 96 |
| FILE NO.: 66022.01 Y- | | OF 96 |