

| F.A. RTE. | SECTION | COUNTY | TOTAL SHEETS | SHEET NO. |
|-----------|----------------|----------|--------------|-----------|
| 358 | B6-00075-02-A5 | WOODFORD | 53 | 18 |

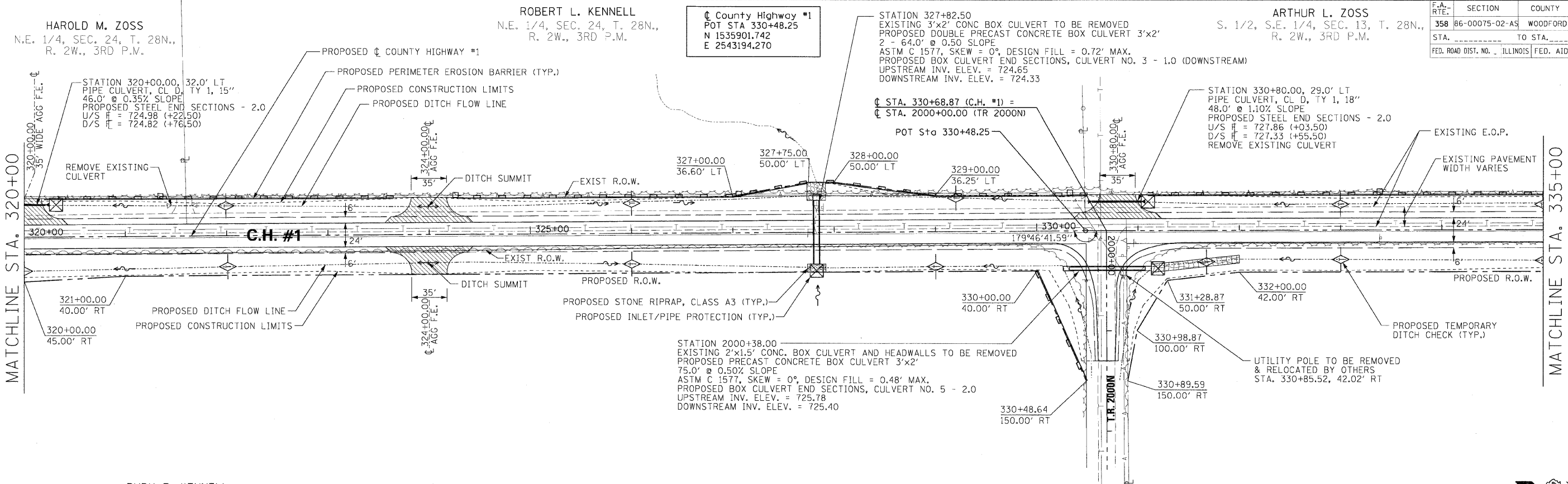

ROBERT L. KENNELL
 N.E. 1/4, SEC. 24, T. 28N., R. 2W., 3RD P.M.
 COUNTY Highway #1
 POT STA 330+48.25
 N 1535901.742
 E 2543194.270

ARTHUR L. ZOSS
 S. 1/2, S.E. 1/4, SEC. 13, T. 28N., R. 2W., 3RD P.M.

RUBY F. KENNELL
 N.W. 1/4, SEC. 19, T. 28N., R. 1W., 3RD P.M.

LOT "C", PLAT BOOK 29, PAGE 24
 S.W. 1/4, SEC. 18, T. 28N., R. 1W., 3RD P.M.

PROPOSED PROFILE ELEVATIONS ARE
 FOR TOP OF FINISHED HOT-MIX ASPHALT SURFACE

H. SCALE: 1" = 50'
 V. SCALE: 1" = 5'

| | |
|------|----|
| DATE | BY |
| | |
| | |
| | |

| | |
|------|----|
| DATE | BY |
| | |
| | |
| | |

PLOT DATE: 8/24/2016
 FILE NAME: 89579-18-1.dwg
 PLOT SCALE: 1" = 50'
 USER NAME: RUSSELL

