

F.A. RTE.	SECTION	COUNTY	TOTAL SHEETS	SHEET NO.
358	86-00075-02-AS	WOODFORD	53	20
STA. _____ TO STA. _____		FED. ROAD DIST. NO. ILLINOIS FED. AID PROJECT		

LLOYD M. DAMERELL
N. 1/2, S.E. 1/4, SEC. 13, T. 28N., R. 2W., 3RD P.M.

County Highway #1
POT STA 357+26.17
N 1538578.896
E 2543130.320

LLOYD M. DAMERELL
S.E. 1/4, N.E. 1/4, SEC. 13, T. 28N., R. 2W., 3RD P.M.

DATE	
BY	
PLANNED	
DESIGNED	
CHECKED	
DATE	

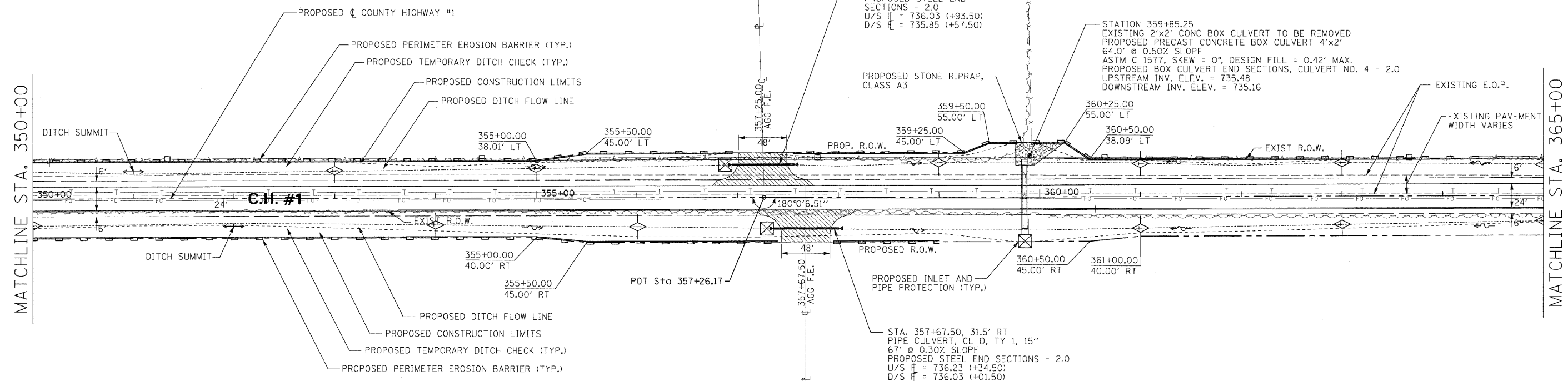

ELISABETH P. FUNK, TRUST
S.W. 1/4, SEC. 18, T. 28N., R. 1W., 3RD P.M.

PROPOSED PROFILE ELEVATIONS ARE
FOR TOP OF FINISHED HOT-MIX ASPHALT SURFACE

ELMER DAMERELL, ESTATE
W. 1/2 & S.E. 1/2 N.W. 1/4, SEC. 18, T. 28N., R. 1W.

H. SCALE: 1" = 50'
V. SCALE: 1" = 5'

DATE	
BY	
PLANNED	
DESIGNED	
CHECKED	
DATE	

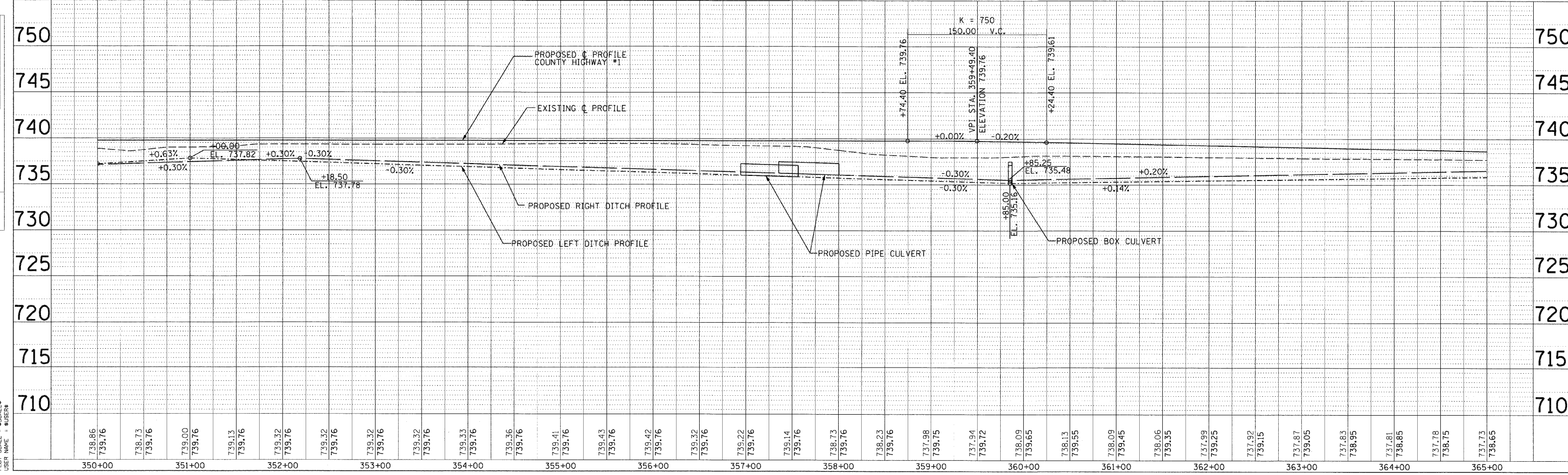

PLOT DATE: 8/20/2018
FILE NAME: 86-00075-02-AS
PLOT SCALE: 1" = 50'
USER NAME: SDUSERS