

DATE	
BY	
SURVEYED	
PLOTTED	
TEMPLATE	
AREAS	
CHECKED	
NO.	

DATE	
BY	
ORIGINAL SURVEY	
TEMPLATE	
AREAS	
CHECKED	
NO.	

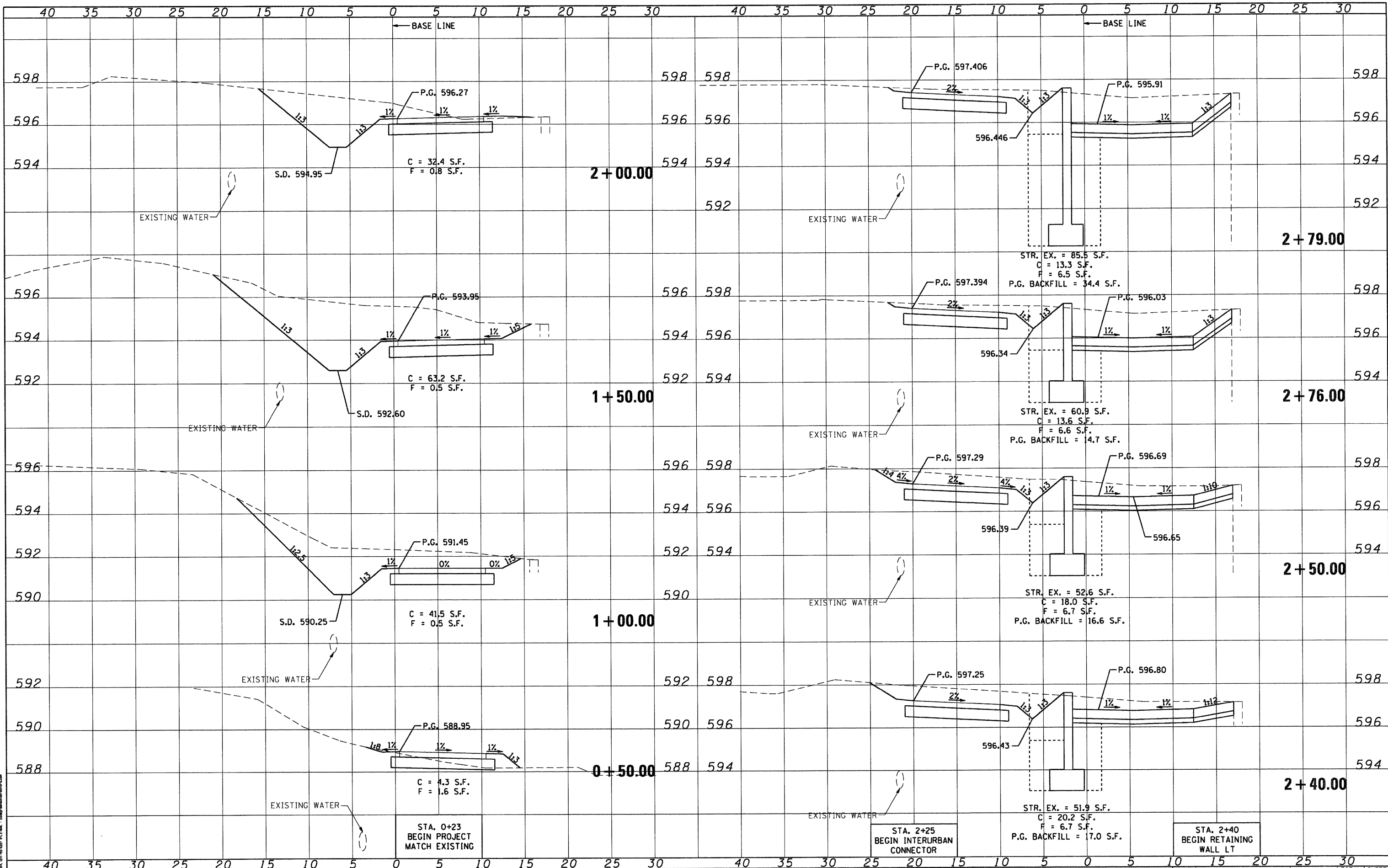
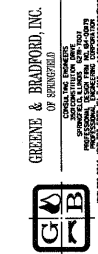

FILE NAME = J:\10001.22\CADD\CADD Sheets\shtr\ssht.dgn	USER NAME = amandah	DESIGNED - WCB	REVISED -	PLUMMER BLVD MULTI-USE TRAIL VILLAGE OF CHATHAM	CROSS SECTIONS		F.A. RTE.	SECTION	COUNTY	TOTAL SHEETS	SHEET NO.
PLOT SCALE = 10.0000' / 1" =	CHECKED - GSK	DRAWN - AJH	REVISED -		SCALE: 5 FT/1IN	SHEET NO. 1 OF 6 SHEETS	STA. 0+50.00	TO STA. 2+50.00	SANGAMON	29	24
PLOT DATE = 4/9/2012	DATE - 04/02/2012	REVISOR -	REVISED -						CONTRACT NO. 93579		
G&B PROJECT: 10001.22	PLOT DRIVER = PLOTTER								ILLINOIS FED. AID PROJECT TE-0006 (109)		