

MICHAEL L. & ANGELA D. WICKE
 SW/4, SE/4, SEC 34, T. 3 N., R. 7 E., 3RD P.M.

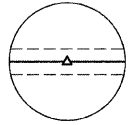

P.O.T. STA. 14+00.55
 (TO BE SET BY COUNTY)
 N. 20,022.929
 E. 20,604.832

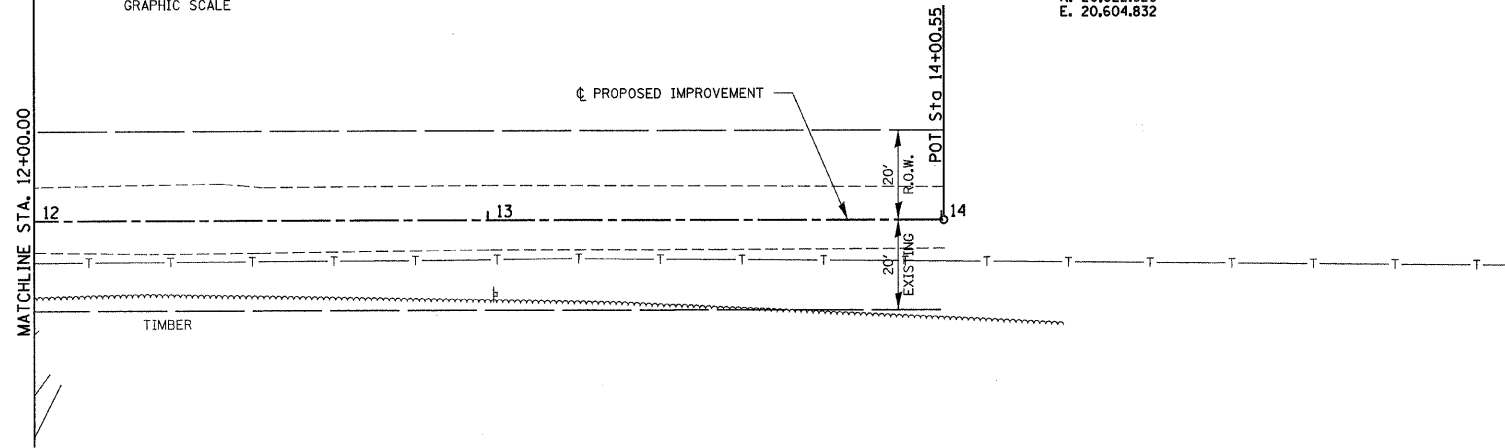
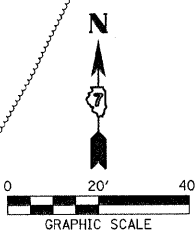

DATE	BY	REVIEWED	CHECKED
		PLOTTED	ALIGNED
		NOTE BOOK	FILE NAME
		NO.	

DOLAN BAYLER
 NW/4, NE/4, SEC 3, T. 2 N., R. 7 E., 3RD P.M.

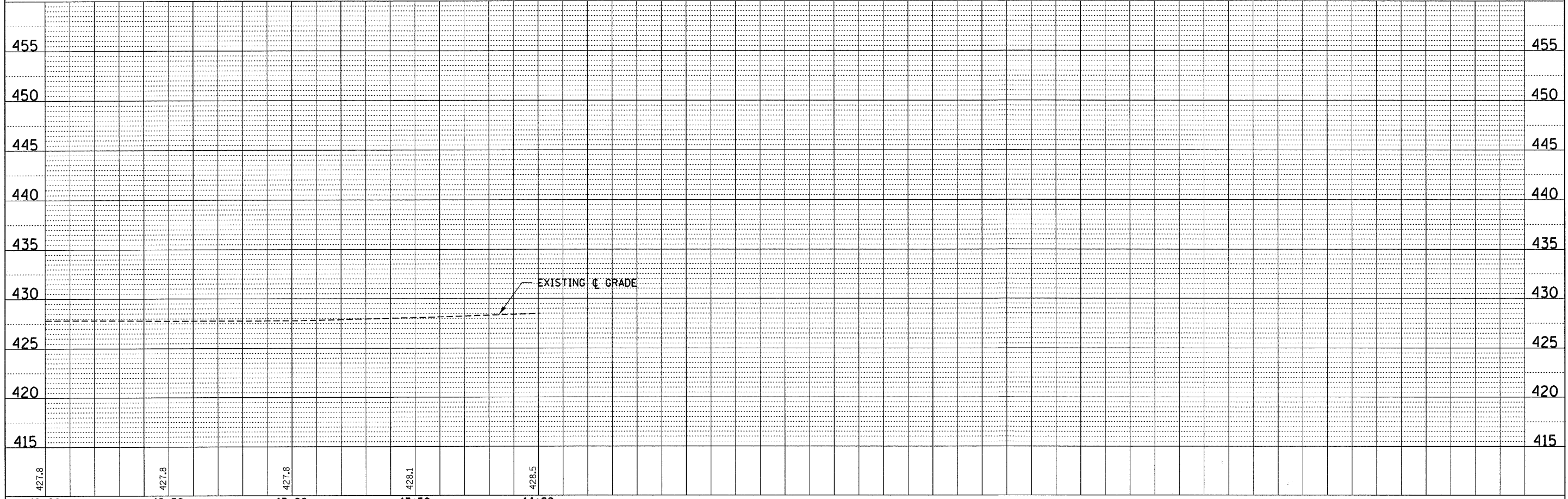

DATE	BY	REVIEWED	CHECKED
		PLOTTED	GRADES
		NOTE BOOK	NOTATIONS
		NO.	CHKD

12+00	12+50	13+00	13+50	14+00
427.8	427.8	427.8	428.1	428.5
FILE NAME = 110175-sh-t-pp2.dgn	USER NAME =	DESIGNED - J.W.F.	REVISED -	
HAMPTON, LENZINI AND RENWICK, INC.		DRAWN - D.T.M.	REVISED -	
1400 STEVENSON DRIVE, SUITE 201		CHECKED - S.W.M.	REVISED -	
SPRINGFIELD, ILLINOIS 62703		DATE - 03/05/12	REVISED -	
ILLINOIS PROFESSIONAL DESIGN FIRM				
LB / PE / SE CORP. 184-002859				

STATE OF ILLINOIS
 CLAY COUNTY HIGHWAY DEPARTMENT

PLAN & PROFILE KNEFF CEMETERY LANE		
SCALE: H20V5	SHEET NO. 2 OF 3 SHEETS	STA. 12+00.00 TO STA. 14+00.55

T.R.	SECTION	COUNTY	TOTAL SHEETS	SHEET NO.
355	07-11130-00-BR	CLAY	29	5
STANFORD ROAD DISTRICT			CONTRACT NO. 95667	
[ILLINOIS] FED. AID PROJECT BR05-0025(070)				