

| | |
|---------------|--|
| DATE | |
| BY | |
| FINAL SURVEY | |
| SURVEYED | |
| FROM | |
| NOTE BOOK | |
| AREAS CHECKED | |
| NO. | |

| | |
|-----------------|--|
| DATE | |
| BY | |
| ORIGINAL SURVEY | |
| SURVEYED | |
| FROM | |
| NOTE BOOK | |
| AREAS CHECKED | |
| NO. | |

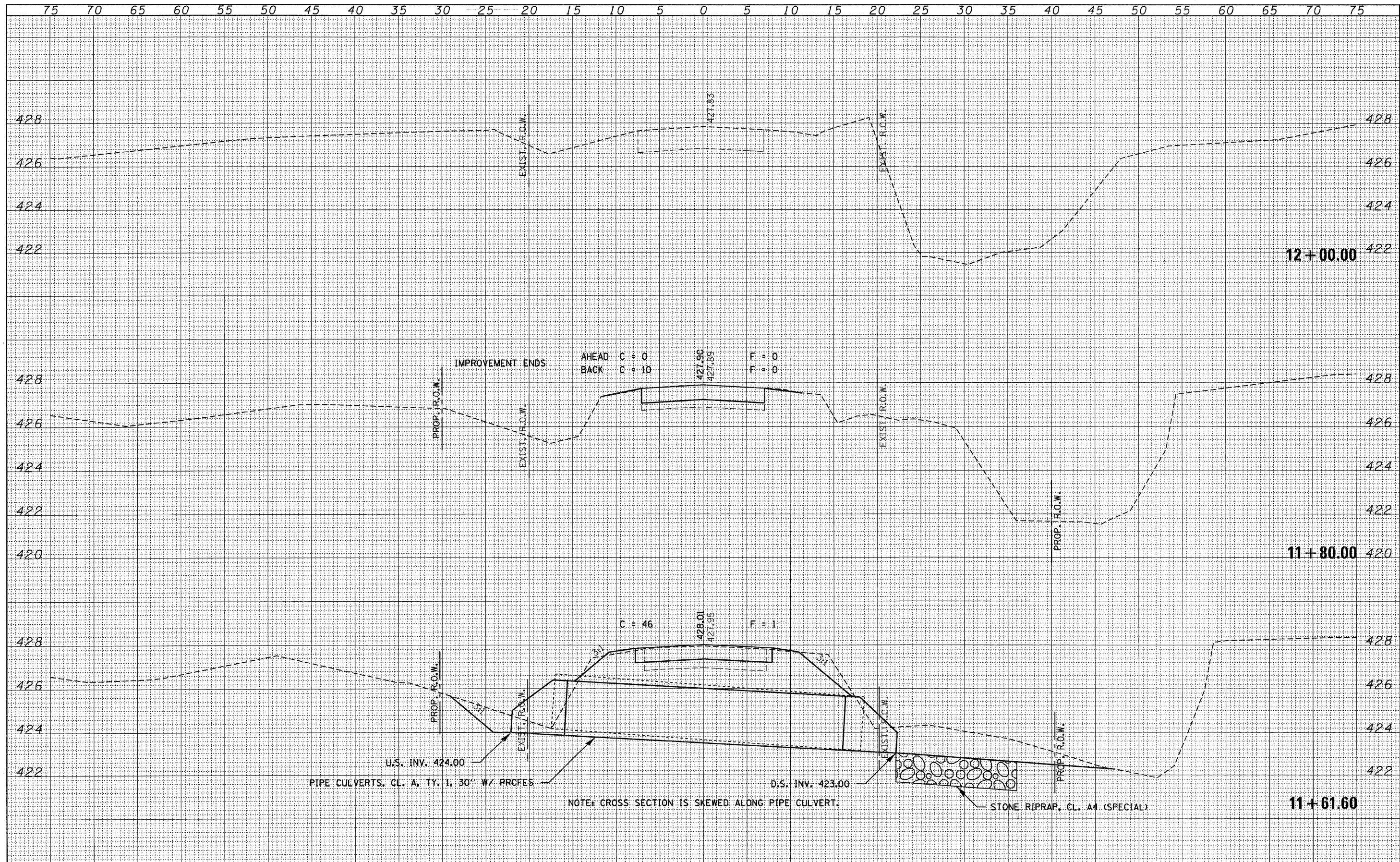

| | | | | | | | | | | | |
|--|----------------------|-------------------|-----------|--|---|---------------------|--------------------------------|--|--------|--------------|-----------|
| FILE NAME = 110175-sh1-axs.dgn | USER NAME = | DESIGNED - J.W.F. | REVISED - | <p align="center">STATE OF ILLINOIS CLAY COUNTY HIGHWAY DEPARTMENT</p> | STATION CROSS SECTIONS KNEFF CEMETERY LANE | | T.R. | SECTION | COUNTY | TOTAL SHEETS | SHEET NO. |
| HAMPTON, LENZINI AND RENWICK, INC. | | DRAWN - D.T.M. | REVISED - | | 355 | 07-11130-00-BR | CLAY | 29 | 16 | | |
| 3008 STEVENSON DRIVE, SUITE 201 SPRINGFIELD, ILLINOIS 62733 | | CHECKED - S.W.M. | REVISED - | | STANFORD ROAD DISTRICT | | CONTRACT NO. 95667 | | | | |
| ILLINOIS PROFESSIONAL DESIGN FIRM LS / PE / SE CORP. 184-000859 | PLOT SCALE = | DATE - 03/05/12 | REVISED - | | SCALE: H5+V2 | SHEET NO. OF SHEETS | STA. 11+61.60 TO STA. 12+00.00 | ILLINOIS FED. AID PROJECT BROS-0025(070) | | | |
| | PLOT DATE = 3/7/2012 | | | | | | | | | | |