

P.I. = 17+69.79  
 N = 957221.92  
 E = 1082551.36  
 DELTA = 27°50'30" RT.  
 D = 190°59'09"  
 R = 30.00'  
 T = 7.44'  
 L = 14.58'  
 E = 0.91'  
 O  
 C=11

P.I. = 18+69.19  
 N = 957243.95  
 E = 1082645.77  
 DELTA = 30°00'00" RT.  
 D = 114°35'30"  
 R = 50.00'  
 T = 13.40'  
 L = 26.18'  
 E = 1.76'  
 O  
 C=13

P.I. = 18+31.18  
 N = 957223.35  
 E = 1082613.04  
 DELTA = 30°51'03" LT.  
 D = 114°35'30"  
 R = 50.00'  
 T = 13.80'  
 L = 26.92'  
 E = 1.87'  
 O  
 C=12

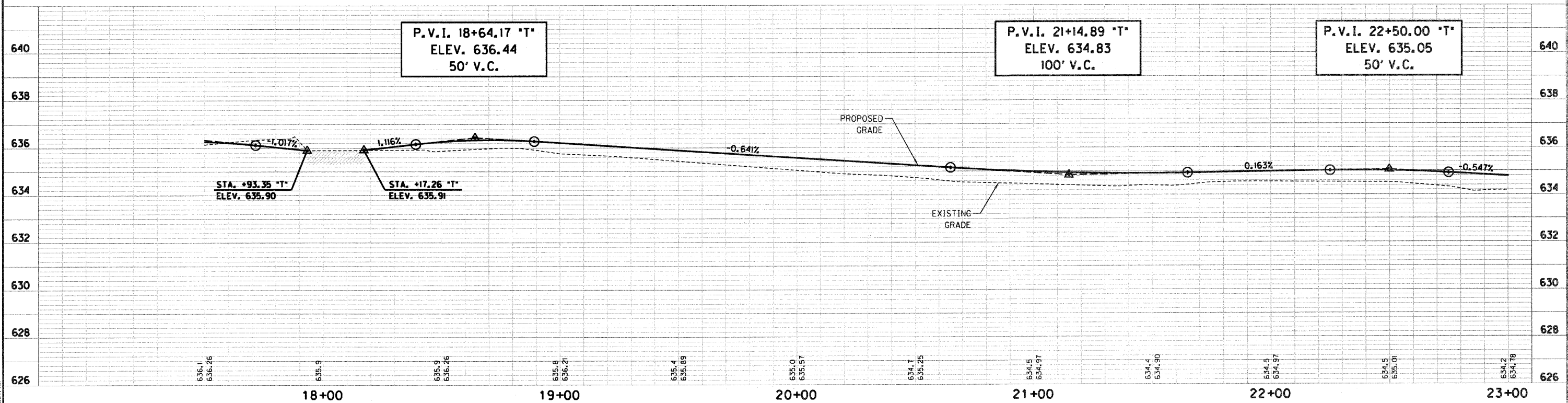
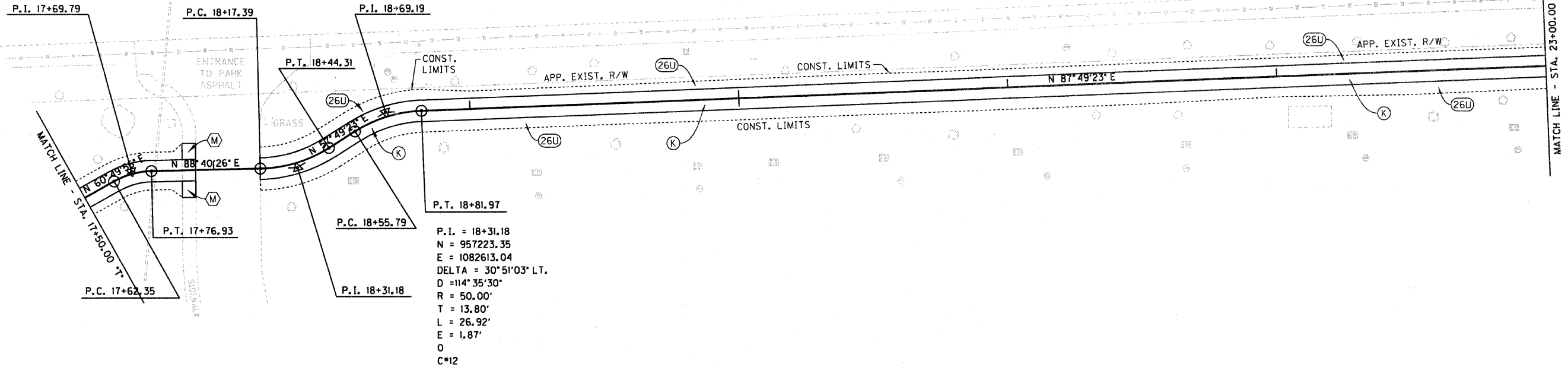

C:\Dave\Noble\2007-213-S\_Casey\_SRTS\Design\Cadd\Plan\1750-2300T.dgn  
 4/19/2012 12:38:38 PM  
 REVISION 2.0  
 PDF-PLT  
 INDDT-1B1

|   |  |   |   |
|---|--|---|---|
| ⊠ | CURB RAMP, TYPE #                                  | Ⓚ | FULL DEPTH PAVEMENT                       |
| ⓐ | PORTLAND CEMENT CONCRETE DRIVEWAY PAVEMENT, 6 INCH | Ⓜ | SEEDING, CLASS IB                         |
| ⓑ | PORTLAND CEMENT CONCRETE SIDEWALK 4 INCH           | Ⓛ | THERMOPLASTIC PAVEMENT MARKING - LINE 24' |

RECOMMENDED FOR APPROVAL: *E. M. Jant* DESIGN ENGINEER 4/19/12 DATE  
 DESIGNED: DWN DRAWN: DWN  
 CHECKED: JAK CHECKED: RSH

**ILLINOIS**  
**DEPARTMENT OF TRANSPORTATION**  
**PLAN & PROFILE SHEET**  
**STA. 17+50.00 TO 23+00.00 "T"**

|                              |                               |
|------------------------------|-------------------------------|
| HORIZONTAL SCALE<br>1" = 20' | BRIDGE FILE                   |
| VERTICAL SCALE<br>1" = 2'    | SECTION NO.<br>10-00030-00-SW |
| SURVEY BOOK                  | SHEETS<br>10 of 33            |
| CONTRACT<br>95676            | PROJECT<br>2007-213           |