

DATE	
BY	
SURVEYED	
PLOTTED	
TEMPLATE	
NOTE BOOK	
AREAS CHECKED	
NO.	

DATE	
BY	
SURVEYED	
PLOTTED	
TEMPLATE	
NOTE BOOK	
AREAS CHECKED	
NO.	

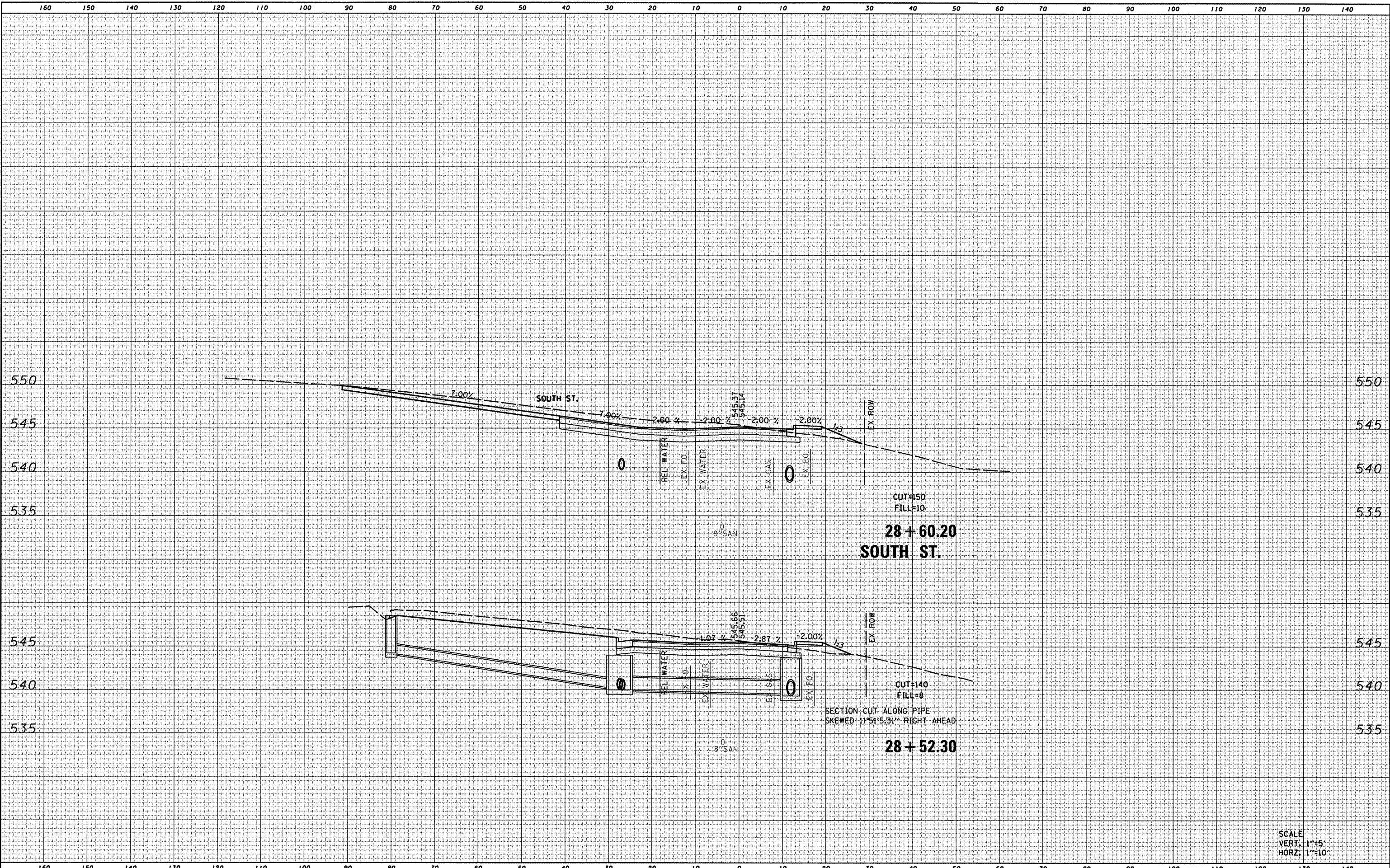

SCALE
VERT. 1"=5'
HORZ. 1"=10'

FILE NAME = 0828010-shr-xssht.cln.dgn	USER NAME = randy	DESIGNED -	REVISED -	STATE OF ILLINOIS DEPARTMENT OF TRANSPORTATION	CROSS SECTIONS				F.A.U. RTE. 9025	SECTION 09-00091-00-PV	COUNTY MADISON	TOTAL SHEETS 35	SHEET NO. 31
	PLOT TIME = 2:14:07 PM	DRAWN -	REVISED -		SCALE:	SHEET NO. 12 OF 16 SHEETS	STA. 28+52.30	TO STA. 28+60.20	S CLINTON ST RECONSTR - PH 1 CONTRACT NO. 97483				
	PLOT SCALE = 20,0000' / IN.	CHECKED -	REVISED -		[ILLINOIS] FED. AID PROJECT								
	PLOT DATE = 4/9/2012	DATE -	REVISED -										