

THIS TRAFFIC CONTROL PLAN SHALL BE USED IN CONJUNCTION WITH STANDARD BLR-21.

PLAN	SURVEYED	CHECKED	DATE
NOTE BOOK NO.	ALIGNED	BY	
	RT. OF WAY		
	CADD FILE NAME		

PROFILE	SURVEYED	CHECKED	DATE
NOTE BOOK NO.	PROPOSED	BY	
	S.M. NOTED		
	STRUCTURE NOTATIONS CHRD		

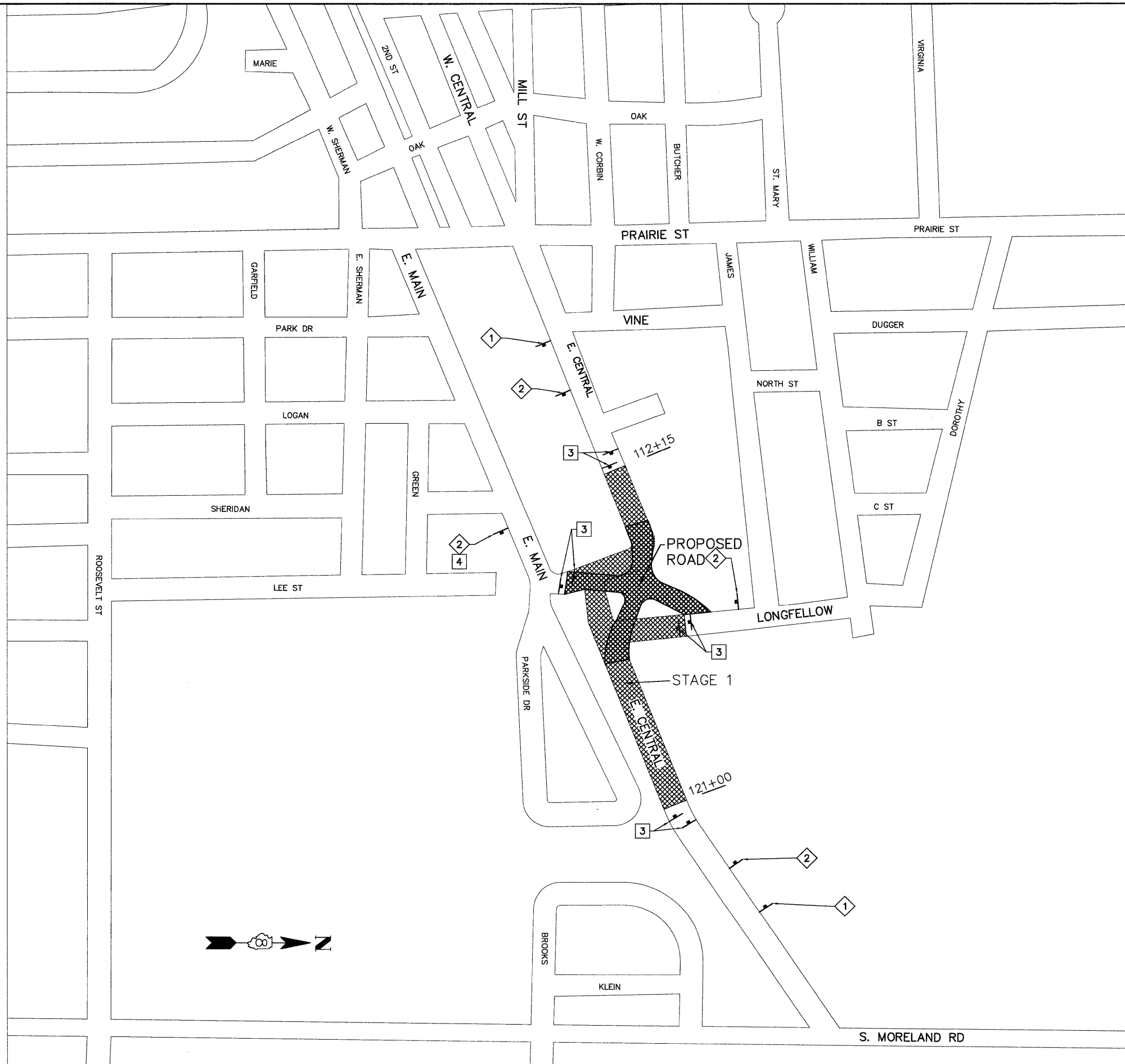

LEGEND

- 1 ROAD CLOSED AHEAD
W20-3(0)-48
- 2 ROAD CONSTRUCTION AHEAD
W20-1(0)-48
- 3 TYPE III BARRICADES WITH ROAD
CLOSED SIGN (R-11-2-4830)
- 4 24"x24"
(LEFT ARROW)
- 5 24"x24"
(RIGHT ARROW)
- 6 W16-8(0)-1808
(ALL 4" LETTERS)

E. CENTRAL ST.

08026-sht-StagingR01.dwg

USER NAME = Robert Watson

DESIGNED - M.J.R.

REVISED -

PLOT SCALE =

DRAWN - R.A.W.

REVISED -

PLOT DATE = 3/21/2012

CHECKED - E.R.O.

REVISED -

DATE - 3/21/12

REVISED -

STATE OF ILLINOIS
DEPARTMENT OF TRANSPORTATION

SUGGESTED STAGES OF CONSTRUCTION AND TRAFFIC
CONTROL - STAGE 1

SCALE: 1"=200' SHEET NO. 25 OF 62 SHEETS STA. 112+15 TO STA. 121+00

F.A.U. RTE.	SECTION	COUNTY	TOTAL SHEETS	SHEET NO.
8959	08-00026-00-WR	MADISON	62	25
CONTRACT NO. 97493				
BETHALTO ILLINOIS FED. AID PROJECT				