

STRUCT NUMBER	STATION	OFFSET	RIM ELEV.	INVERT ELEV.	STRUCTURE TYPE
413	114+72.85	13.00' LT	526.67	521.67	INLET T-B, FLAT SLAB TOP, TYPE 3V FRAME & GRATE
414	114+31.89	13.00' LT	527.49	521.80	INLET T-B, FLAT SLAB TOP, TYPE 3V FRAME & GRATE
415	114+31.89	13.00' RT	527.49	521.89	INLET T-B, FLAT SLAB TOP, TYPE 3V FRAME & GRATE

NOTE: STATION, OFFSET AND RIM ELEVATIONS ARE TO THE EDGE OF PAVEMENT UNLESS NOTED. *INDICATES MEASUREMENTS AT CENTER OF STRUCTURE, **INDICATES MEASUREMENTS AT END OF FLARED END SECTION.

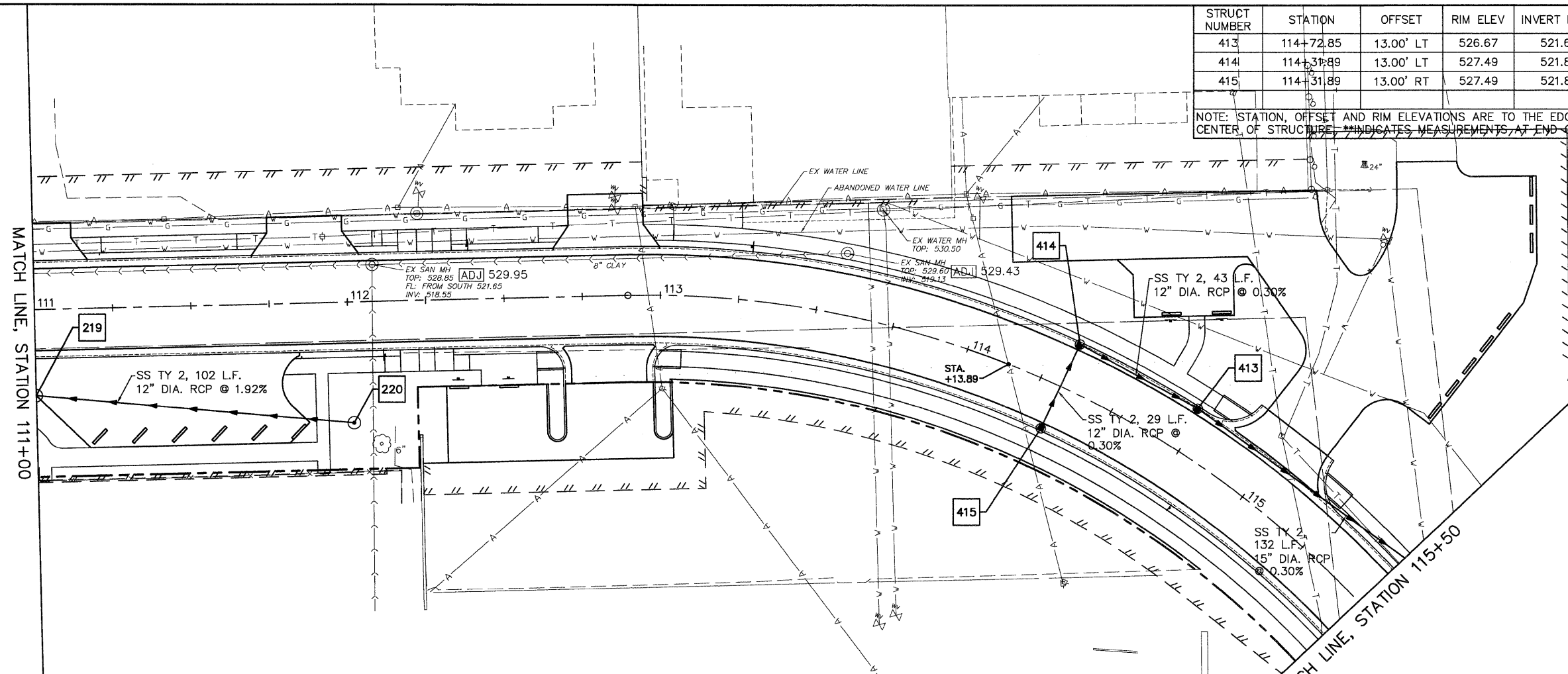

STRUCT NUMBER	STATION	OFFSET	RIM ELEV.	INVERT ELEV.	STRUCTURE TYPE
220*	112+01.27	38.58' RT	528.70	524.70	INLET T-B, TYPE B GRATE

NOTE: STATION, OFFSET AND RIM ELEVATIONS ARE TO THE EDGE OF PAVEMENT UNLESS NOTED. *INDICATES MEASUREMENTS AT CENTER OF STRUCTURE, **INDICATES MEASUREMENTS AT END OF FLARED END SECTION.

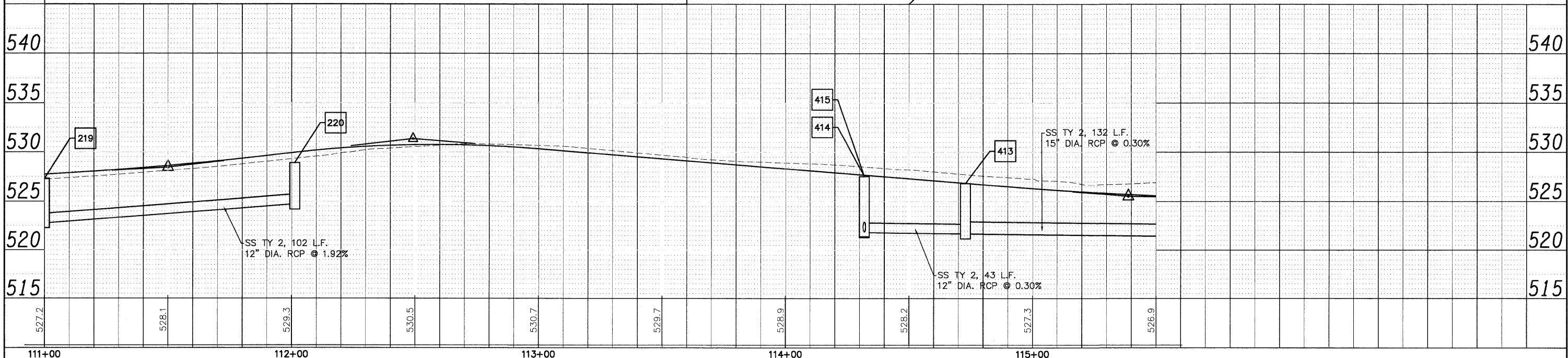
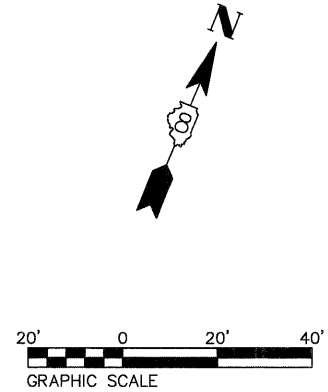

DATE: _____
 BY: _____
 SURVEYED _____
 ALIGNED _____
 CHECKED _____
 RT. OF WAY CHECKED _____
 NOTE BOOK NO. _____
 DDD FILE NAME _____

DATE: _____
 BY: _____
 SURVEYED _____
 GRADES CHECKED _____
 S.M. NOTED _____
 STRUCTURE NOTATIONS CHKD _____
 NOTE BOOK NO. _____