

DATE: _____
 BY: _____
 SURVEYED _____
 ALIGNED _____
 RT. OF WAY CHECKED _____
 NOTE BOOK NO. _____
 PLOTTED FILE NAME _____

DATE: _____
 BY: _____
 SURVEYED _____
 GRADES CHECKED _____
 B.M. NOTED _____
 STRUCTURE NOTATIONS CHKD _____
 NOTE BOOK NO. _____
 PLOTTED FILE NAME _____

POINT	LOCATION	STATION	OFFSET
B1	E. CENTRAL ST.	109+70.28	13' LT
B2	NORTH ST.	800+22.41	14.81' LT
B3	NORTH ST.	800+32.63	12.00' LT
B4	E. CENTRAL ST.	110+02.05	13.00' LT
B5	NORTH ST.	800+22.58	0.00'
B6	NORTH ST.	800+33.37	0.00'
B7	E. CENTRAL ST.	110+34.29	13.00' LT
B8	NORTH ST.	800+22.78	15.00' RT
B9	NORTH ST.	800+33.37	12.00' RT

POINT	LOCATION	STATION	OFFSET
C1	E. CENTRAL ST.	109+50.00	50.50' RT
C2	E. CENTRAL ST.	109+88.70	44.50' RT
C3	E. CENTRAL ST.	109+95.06	38.14' RT
C4	E. CENTRAL ST.	109+89.17	28.00' RT
C5	E. CENTRAL ST.	109+89.17	15.58' RT
C6	E. CENTRAL ST.	109+98.00	25.00' RT
C7	E. CENTRAL ST.	109+98.94	34.50' RT
C8	E. CENTRAL ST.	110+05.00	31.00' RT
C9	E. CENTRAL ST.	110+22.44	39.50' RT
C10	E. CENTRAL ST.	110+11.52	43.50' RT
C11	E. CENTRAL ST.	110+12.55	46.31' RT
C13	E. CENTRAL ST.	110+35.03	50.50' RT
C14	E. CENTRAL ST.	110+13.46	30.00' RT

POINT	LOCATION	STATION	OFFSET
D1	E. CENTRAL ST.	110+83+42	15.58' RT
D2	E. CENTRAL ST.	110+83.42	28.00' RT
D3	E. CENTRAL ST.	110+83.42	44.50' RT
D4	E. CENTRAL ST.	110+85.95	44.50' RT
D5	E. CENTRAL ST.	110+92.31	38.14' RT
D6	E. CENTRAL ST.	110+86.42	28.00' RT
D7	E. CENTRAL ST.	111+00.50	31.23' RT
D8	E. CENTRAL ST.	110+95.50	25.00' RT
D9	E. CENTRAL ST.	111+00.00	27.43' RT
D10	E. CENTRAL ST.	111+17.07	44.50' RT
D11	E. CENTRAL ST.	111+29.45	44.50' RT
D12	E. CENTRAL ST.	111+29.45	15.58' RT
D13	E. CENTRAL ST.	111+08.07	39.50' RT
D14	E. CENTRAL ST.	111+29.45	27.58' RT
D15	E. CENTRAL ST.	111+88.66	25.58' RT
D16	E. CENTRAL ST.	111+80.71	44.50' RT
D17	E. CENTRAL ST.	111+87.07	38.14' RT
D18	E. CENTRAL ST.	111+78.86	27.58' RT
D19	E. CENTRAL ST.	111+84.30	16.58' RT
D20	E. CENTRAL ST.	111+89.27	22.58' RT
D21	E. CENTRAL ST.	111+93.27	22.58' RT

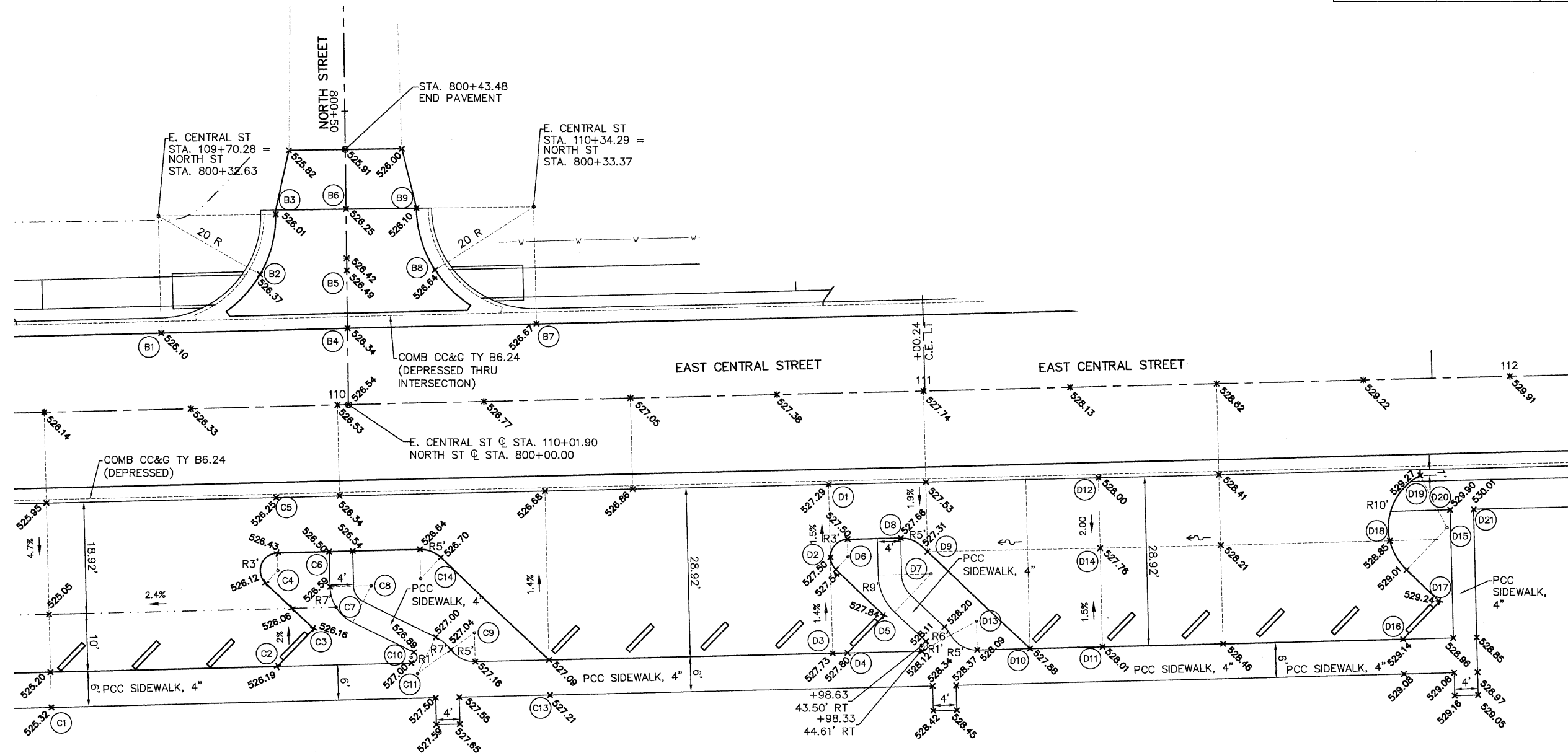

INTERSECTION DETAIL
NORTH STREET WITH EAST CENTRAL STREET & STREET PARKING
 SCALE: 1"=10'

08026-sht-Int Det.dwg

USER NAME = Robert Watson
 DESIGNED - M.J.R.
 DRAWN - R.A.W.
 CHECKED - E.R.O.
 DATE - 3/21/12

REVISED -
 REVISED -
 REVISED -
 REVISED -

STATE OF ILLINOIS
DEPARTMENT OF TRANSPORTATION

INTERSECTION DETAILS
 SCALE: 1"=10' SHEET NO. 41 OF 62 SHEETS STA. TO STA.

F.A.U. RTE. 8959	SECTION 08-00026-00-WR	COUNTY MADISON	TOTAL SHEETS 62	SHEET NO. 41
CONTRACT NO. 97493				
BETHALTO ILLINOIS FED. AID PROJECT				