

DATE	
BY	
PLANNED	
DESIGNED	
CHECKED	
DATE	
BY	
PLANNED	
DESIGNED	
CHECKED	
DATE	
BY	

DATE	
BY	
PLANNED	
DESIGNED	
CHECKED	
DATE	
BY	
PLANNED	
DESIGNED	
CHECKED	
DATE	
BY	

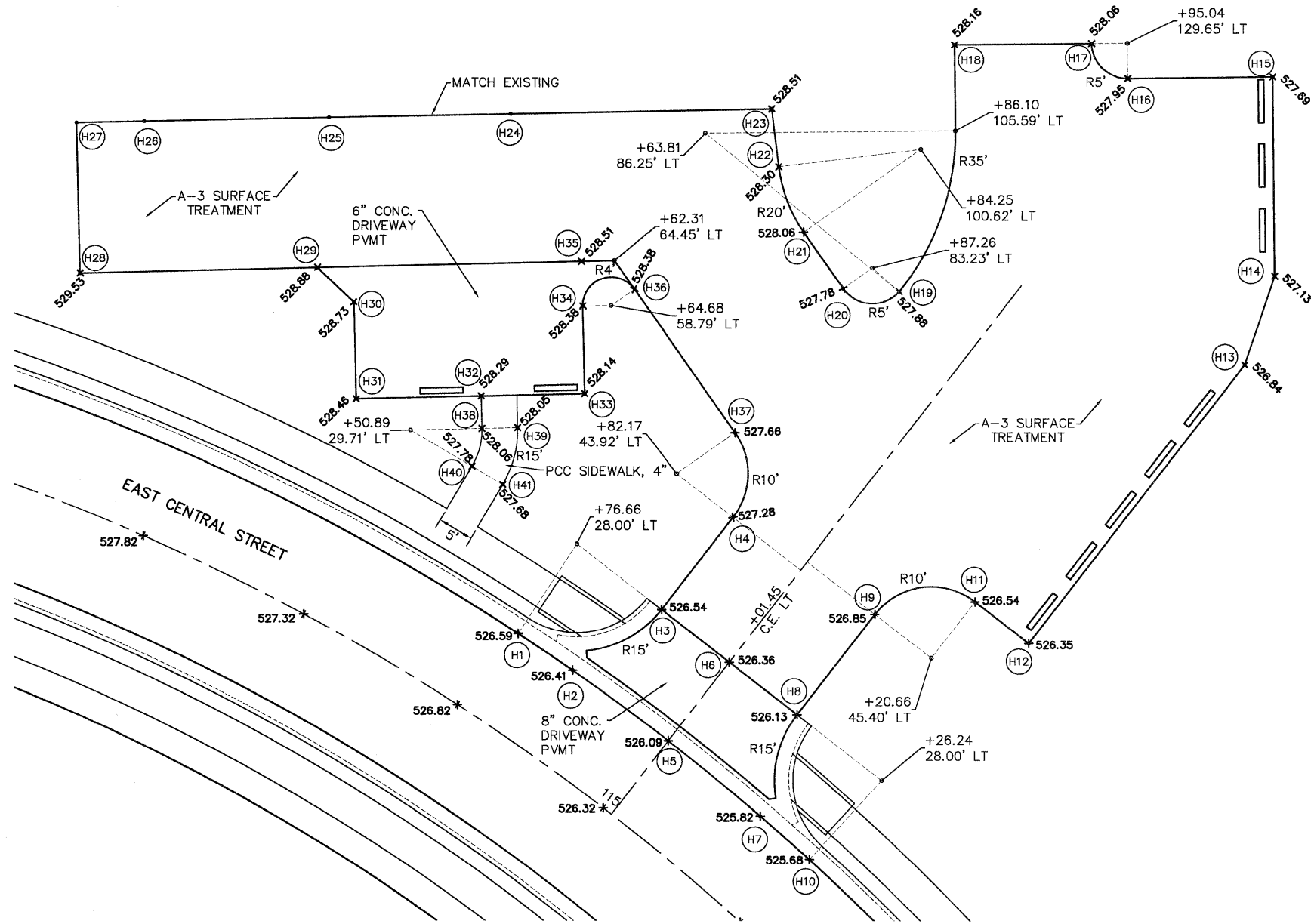

POINT	LOCATION	STATION	OFFSET
H1	E. CENTRAL ST.	114+76.66	13.00' LT
H2	E. CENTRAL ST.	114+85.48	13.00' LT
H3	E. CENTRAL ST.	114+90.42	27.13' LT
H4	E. CENTRAL ST.	114+90.93	43.44' LT
H5	E. CENTRAL ST.	115+01.45	13.00' LT
H6	E. CENTRAL ST.	115+01.45	26.92' LT
H7	E. CENTRAL ST.	115+17.43	13.00' LT
H8	E. CENTRAL ST.	115+12.49	27.13' LT
H9	E. CENTRAL ST.	115+11.94	44.92' LT
H10	E. CENTRAL ST.	115+26.24	13.00' LT
H11	E. CENTRAL ST.	115+20.13	55.38' LT
H12	E. CENTRAL ST.	115+28.16	56.08' LT
H13	E. CENTRAL ST.	115+24.99	105.24' LT
H14	E. CENTRAL ST.	115+21.20	117.32' LT
H15	E. CENTRAL ST.	115+08.31	138.36' LT
H16	E. CENTRAL ST.	114+97.16	125.68' LT
H17	E. CENTRAL ST.	114+92.21	126.65' LT
H18	E. CENTRAL ST.	114+80.99	115.45' LT
H19	E. CENTRAL ST.	114+91.18	82.72' LT
H20	E. CENTRAL ST.	114+85.91	78.53' LT
H21	E. CENTRAL ST.	114+78.75	81.93' LT
H22	E. CENTRAL ST.	114+72.59	87.63' LT
H23	E. CENTRAL ST.	114+68.58	94.01' LT
H24	E. CENTRAL ST.	114+43.84	75.39' LT
H25	E. CENTRAL ST.	114+25.28	64.01' LT
H26	E. CENTRAL ST.	114+05.28	53.90' LT
H27	E. CENTRAL ST.	113+97.66	50.57' LT
H28	E. CENTRAL ST.	114+04.19	30.97' LT
H29	E. CENTRAL ST.	114+31.35	44.22' LT
H30	E. CENTRAL ST.	114+37.24	42.01' LT
H31	E. CENTRAL ST.	114+42.88	30.06' LT
H32	E. CENTRAL ST.	114+56.58	38.70' LT
H33	E. CENTRAL ST.	114+67.41	46.36' LT
H34	E. CENTRAL ST.	114+61.82	56.67' LT
H35	E. CENTRAL ST.	114+59.05	62.03' LT
H36	E. CENTRAL ST.	114+66.03	62.45' LT
H37	E. CENTRAL ST.	114+85.19	59.39' LT
H38	E. CENTRAL ST.	114+58.69	34.79' LT
H39	E. CENTRAL ST.	114+62.51	37.41' LT
H40	E. CENTRAL ST.	114+60.01	29.49' LT
H41	E. CENTRAL ST.	114+64.58	29.49' LT

PARKING GRADING DETAIL
BOYS CLUB
 SCALE: 1"=10'

08026-sht-Int Det.dwg

USER NAME = Robert Watson	DESIGNED - M.J.R.	REVISED -
	DRAWN - R.A.W.	REVISED -
PLOT SCALE =	CHECKED - E.R.O.	REVISED -
PLOT DATE = 3/21/2012	DATE - 3/21/12	REVISED -

STATE OF ILLINOIS
DEPARTMENT OF TRANSPORTATION

INTERSECTION DETAILS	
SCALE: 1"=10'	SHEET NO. 42 OF 62 SHEETS STA. TO STA.

F.A.U. RTE.	SECTION	COUNTY	TOTAL SHEETS	SHEET NO.
8959	08-00026-00-WR	MADISON	62	42
CONTRACT NO. 97493				
BETHALTO ILLINOIS FED. AID PROJECT				