

NOTES

1. ALL PROPOSED 10' CLASS E FENCE ON THIS SHEET REQUIRES TOPRAIL.
2. COORDINATE FENCE TO BE CLEAR OF ELECTRIC UTILITY POLES. MAINTAIN MINIMUM SEPARATION BETWEEN FENCE AND UTILITY POLES OF 12".
3. THE SERVING ELECTRIC UTILITY COMPANY CONTACT IS:

AMEREN ILLINOIS
 ATTN: TAMMIE PARSONS
 2460 N. JASPER STREET
 MC K30
 DECATUR, ILLINOIS 62526
 OFFICE: 217-424-7042
 MOBILE: 217-412-6455
 FAX: 217-612-2130
 EMAIL: TPARSONS@AMEREN.COM

THE LOCATION, SIZE, AND TYPE OF MATERIAL OF EXISTING UNDERGROUND AND/OR ABOVEGROUND UTILITIES INDICATED ON THE PLANS ARE NOT REPRESENTED AS BEING ACCURATE, SUFFICIENT OR COMPLETE. NEITHER THE OWNER NOR THE ENGINEER ASSUMES ANY RESPONSIBILITY WHATSOEVER IN RESPECT TO THE ACCURACY, COMPLETENESS, OR SUFFICIENCY OF THE INFORMATION. THERE IS NO GUARANTEE, EITHER EXPRESSED OR IMPLIED, THAT THE LOCATIONS, SIZE AND TYPE OF MATERIAL OF EXISTING UNDERGROUND UTILITIES INDICATED ARE REPRESENTATIVE OF THOSE TO BE ENCOUNTERED IN THE CONSTRUCTION. IT SHALL BE THE CONTRACTOR'S RESPONSIBILITY TO DETERMINE THE ACTUAL LOCATION OF ALL SUCH FACILITIES, INCLUDING SERVICE CONNECTIONS TO UNDERGROUND UTILITIES. PRIOR TO CONSTRUCTION, THE CONTRACTOR SHALL NOTIFY THE UTILITY COMPANIES OF HIS OPERATIONAL PLANS AND SHALL OBTAIN FROM THE RESPECTIVE UTILITY COMPANIES DETAILED INFORMATION AND ASSISTANCE RELATIVE TO THE LOCATION OF THEIR FACILITIES AND THE WORKING SCHEDULE OF THE COMPANIES FOR REMOVAL OR ADJUSTMENT WHERE REQUIRED. IN THE EVENT AN UNEXPECTED UTILITY INTERFERENCE IS ENCOUNTERED DURING CONSTRUCTION, THE CONTRACTOR SHALL IMMEDIATELY NOTIFY THE UTILITY COMPANY OF JURISDICTION. THE OWNER'S REPRESENTATIVE AND/OR THE RESIDENT ENGINEER SHALL ALSO BE IMMEDIATELY NOTIFIED. ANY DAMAGE TO SUCH MAINS AND SERVICES SHALL BE RESTORED TO SERVICE AT ONCE AND PAID FOR BY THE CONTRACTOR AT NO ADDITIONAL COST TO THE CONTRACT.

ALL UTILITY CABLES AND LINES SHALL BE LOCATED BY THE RESPECTIVE UTILITY. CONTACT JULIE (JOINT UTILITY LOCATION INFORMATION FOR EXCAVATORS) FOR UTILITY INFORMATION, PHONE: 1-800-892-0123. CONTACT THE FAA (FEDERAL AVIATION ADMINISTRATION) FOR ASSISTANCE IN LOCATING FAA CABLES AND UTILITIES. LOCATION OF FAA POWER, CONTROL, AND COMMUNICATION CABLES SHALL BE COORDINATED WITH AND/OR LOCATED BY THE FAA. ALSO CONTACT AIRPORT DIRECTOR/MANAGER AND AIRPORT PERSONNEL FOR ASSISTANCE IN LOCATING UNDERGROUND AIRPORT CABLES AND/OR UTILITIES. ALSO COORDINATE WORK WITH ALL ABOVEGROUND UTILITIES.

LEGEND

- x— PROPOSED CLASS E FENCE 10'
- x— EXISTING FENCE (TO REMAIN)
- — EXISTING FENCE ALIGNMENT
- ▭ EXISTING PAVEMENT
- ▭ EXISTING BUILDINGS
- E— EXISTING ELECTRICAL CABLES
- SS— EXISTING STORM SEWER
- SAN— EXISTING SANITARY SEWER
- W— EXISTING WATER LINE
- T— EXISTING TELEPHONE LINE
- G— EXISTING GAS LINE
- OHE— EXISTING OVERHEAD ELECTRIC
- FO— EXISTING FIBER OPTIC
- C— EXISTING COMMUNICATION/CONTROL CABLE
- ...— EXISTING DRAINAGE DITCH
- ⊙ EXISTING POWER POLE
- ⊗ EXISTING LIGHT POLE
- ⊠ EXISTING ELECTRICAL HANDHOLE/MANHOLE
- ⊞ EXISTING TRANSFORMER

NOTE: EXISTING GATE POSTS FOR 12' ELECTRIC SLIDE GATE & 5' WALKGATE ARE INSTALLED IN THE PAVEMENT

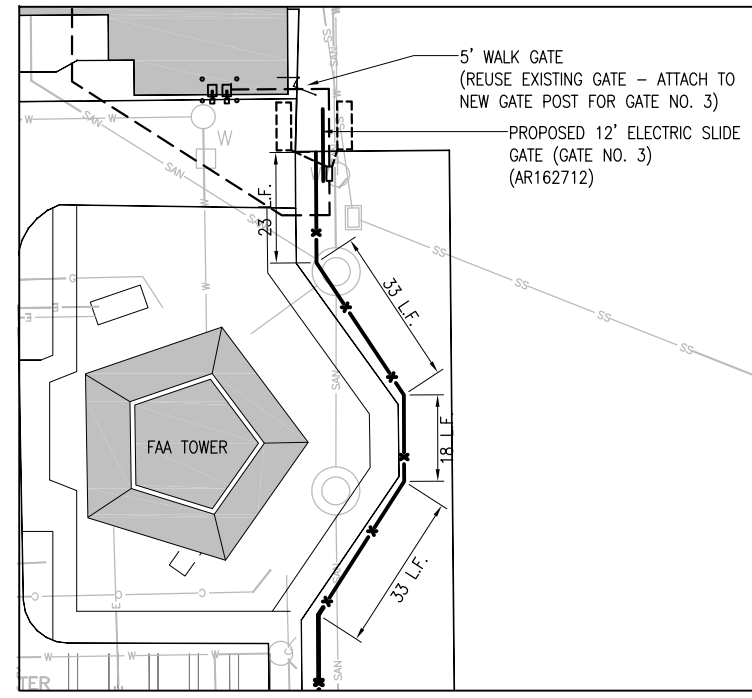
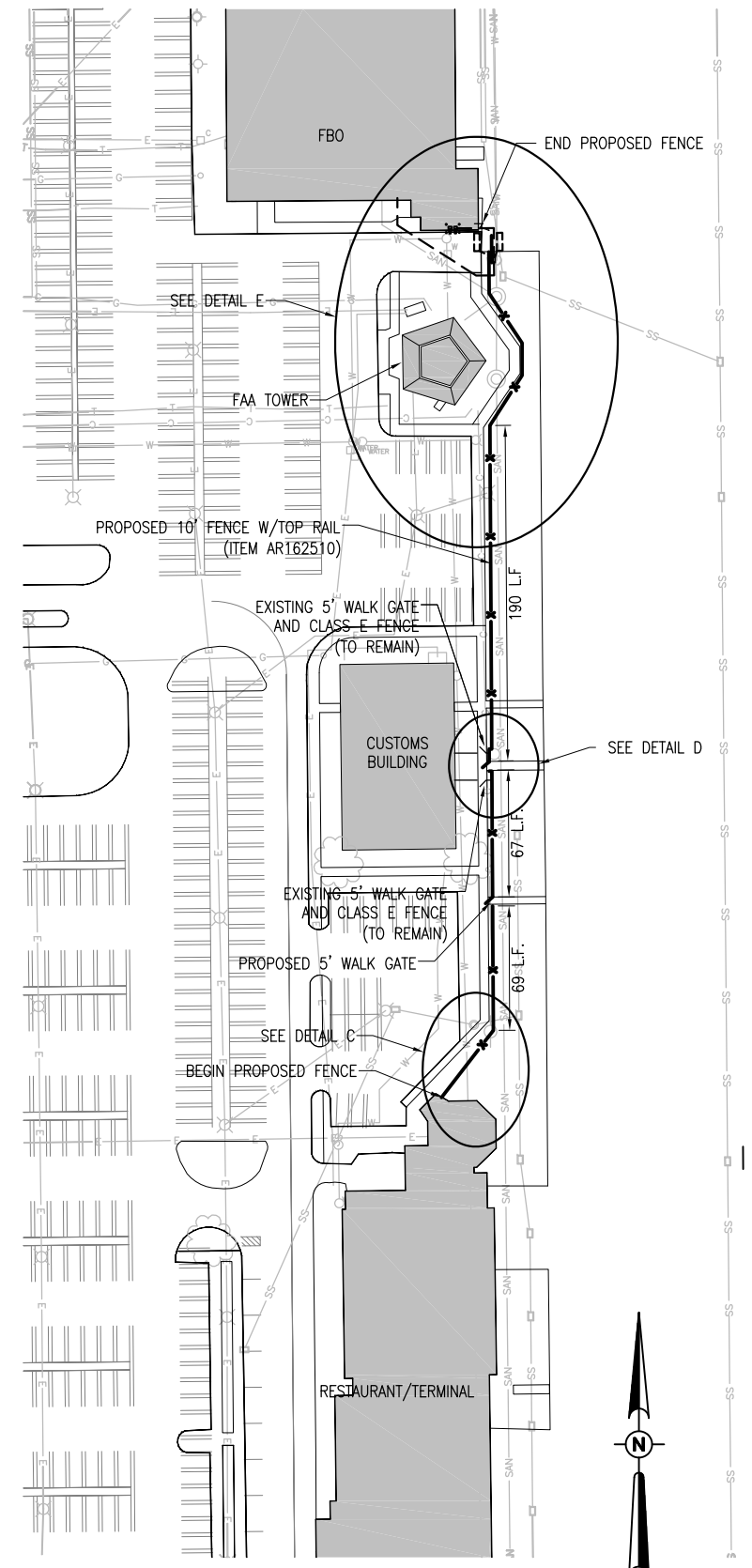

DETAIL "E"
 HALF SCALE 1" = 40'
 FULL SCALE 1" = 20'

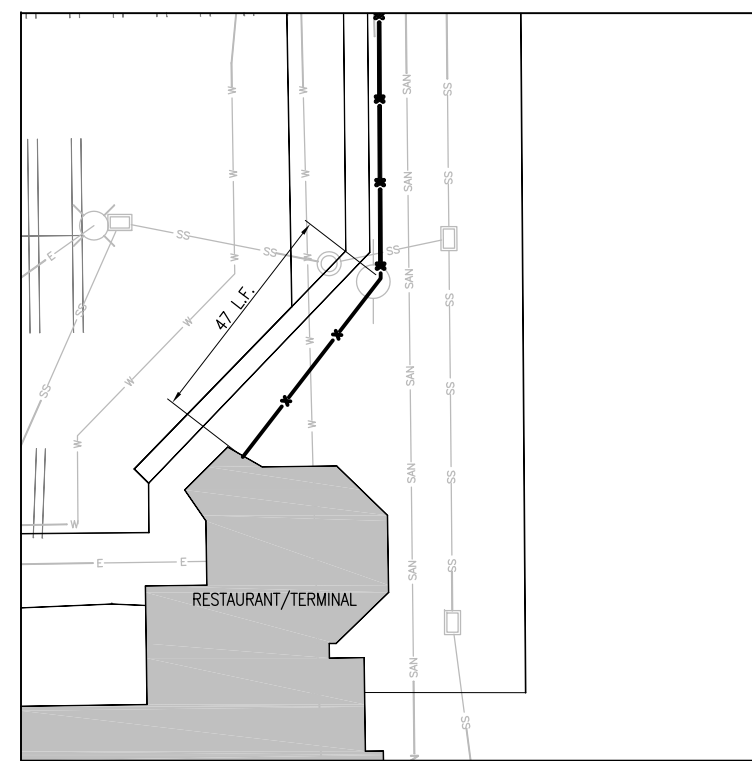

DETAIL "C"
 HALF SCALE 1" = 40'
 FULL SCALE 1" = 20'

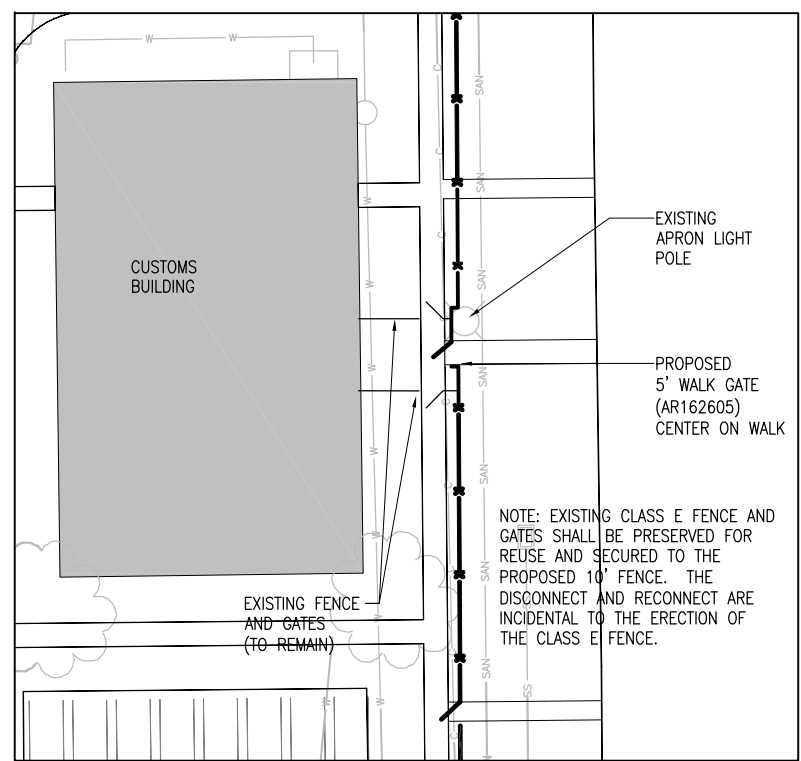

DETAIL "D"
 HALF SCALE 1" = 40'
 FULL SCALE 1" = 20'

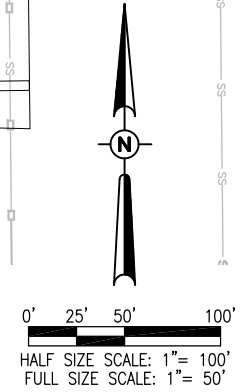

MAY 08, 2012 12:11 PM HARR01115
 p:\s\spi-svr306\hanson.dom\hanson_projects\Documents\11A0083D\CAD_Airport\Sheet\C-172-FEN

REVISION	DATE

HANSON
 DECATUR AIRPORT
 DECATUR, ILLINOIS
 I.L. PROJ.: DEC-4167
 A.I.P. PROJ.: 3-17-0033-B4

Hanson Proj. No. 11A0083D	
Filename C-172-FEN.DWG	
Scale 1" = 50'	
Date 05/08/2012	
LAYOUT KDM 02/02/12	
DRAWN KDM 02/02/12	
REVIEWED KNL/RAW 04/19/12	

HANSON
 © Copyright Hanson Professional Services Inc. 2012
 Hanson Professional Services Inc.
 1525 South Sixth Street
 Springfield, Illinois 62703-2886
 Ph: (217) 788-2450 Fax: (217) 788-2503
 www.hanson-inc.com
 Offices Nationwide

REPLACE PERIMETER FENCE
 PROPOSED FENCING PLAN SHEET 2