



Illinois Department of Transportation

2300 South Dirksen Parkway / Springfield, Illinois / 62764

June 8, 2018

SUBJECT: FAI Route 90 (I-90)
Project CMAQ-NHPP-NWQA(467)
Section (1517 & 1415)R-2
Cook County
Contract No. 60Y39
Item No. 4, June 15, 2018 Letting
Addendum A

NOTICE TO PROSPECTIVE BIDDERS:

Attached is an addendum to the plans or proposal. This addendum involves revised and/or added material.

1. Revised the Schedule of Prices
2. Revised page vi of the Table of Contents to the Special Provisions
3. Revised pages 592-594 of the Special Provisions
4. Revised sheets 1, 3, 27, 32, 40, 41, 53, 56, 71, 73-78, 102-104, 119, 119a, 119b, 121-130, 136, 142, 149, 155, 159, 161, 169, 175, 207, 209-214, 234, 235, 246, 248-250, 253, 258, 266-268, 459, 461, 462, 467-470, 473, 479-481, 485, 491, 517-519, 523, 529-532, 535, 536, 651 and 652 of the Plans
5. Added sheets 119C-119J to the Plans
6. Added the PSI Report to the Additional information section of the website

Prime contractors must utilize the enclosed material when preparing their bid and must include any changes to the Schedule of Prices in their bid.

Very truly yours,

Jack A. Elston, P.E.
Bureau Chief, Design and Environment

A handwritten signature in black ink, appearing to read 'Ted B. Walschleger P.E.'.

By: Ted B. Walschleger, P. E.
Engineer of Project Management

cc: Anthony Quigley, Region 1, District 1; Tim Kell; D. Carl Puzey

MS/ck

RECLAIMED ASPHALT SHINGLES (RAS) (ILLINOIS TOLLWAY) 510

COARSE AGGREGATE FOR PORTLAND CEMENT CONCRETE PAVEMENT MIXTURES
 (ILLINOIS TOLLWAY)..... 520

PERFORMANCE RELATED SPECIAL PROVISION FOR TERNARY CONCRETE MIX
 DESIGNS FOR COMPOSITE PAVEMENTS (ILLINOIS TOLLWAY) 521

TRAFFIC BARRIER TERMINAL, TYPE T6B (ILLINOIS TOLLWAY RECURRING)..... 527

SURFACE SMOOTHNESS TESTING FOR PAVEMENT (ILLINOIS TOLLWAY) 530

PERFORMANCE RELATED SPECIAL PROVISION FOR TERNARY CONCRETE MIX
 DESIGNS FOR PORTLAND CEMENT CONCRETE PAVEMENTS (ILLINOIS TOLLWAY).... 533

TRAFFIC BARRIER TERMINAL, TYPE T1-A (SPECIAL) (ILLINOIS TOLLWAY)..... 541

AGGREGATE SUBBASE, SPECIAL (ILLINOIS TOLLWAY)..... 544

OVERHEAD SIGN STRUCTURE - BRIDGE MOUNTED (SPECIAL) 547

CCTV CAMERA STRUCTURE, 80 FT. M.H..... 548

DETECTABLE WARNINGS (SPECIAL) IN CITY OF CHICAGO (D-1) 554

GROOVING FOR RECESSED PAVEMENT MARKING (ILLINOIS TOLLWAY) 555

MULTI-POLYMER PAVEMENT MARKINGS (ILLINOIS TOLLWAY)..... 557

PIPE UNDERDRAINS (ILLINOIS TOLLWAY) 573

PIPE UNDERDRAINS FOR STRUCTURES 576

STRUCTURAL REPAIR OF CONCRETE 577

STRUCTURAL ASSESSMENT REPORTS FOR CONTRACTOR’S MEANS AND METHODS
 588

WEEP HOLE DRAINS FOR ABUTMENTS, WINGWALLS, RETAINING WALLS AND
 CULVERTS..... 591

CONCRETE CURB, TYPE B (SPECIAL) 592

BITUMINOUS MATERIALS COST ADJUSTMENTS (BDE)..... 595

BUTT JOINTS (BDE) 596

COMPENSABLE DELAY COSTS (BDE)..... 597

CONCRETE END SECTIONS FOR PIPE CULVERTS (BDE) 603

CONSTRUCTION AIR QUALITY – DIESEL RETROFIT (BDE) 605

CONTRAST PREFORMED PLASTIC PAVEMENT MARKING (BDE) 607

DISADVANTAGED BUSINESS ENTERPRISE PARTICIPATION (BDE) 608

EQUIPMENT PARKING AND STORAGE (BDE) 621

FUEL COST ADJUSTMENT (BDE) 622

CONCRETE CURB, TYPE B (SPECIAL)

Description: This work shall consist of constructing a 6" wide concrete curb in accordance with the applicable portions of Sections 606 to serve as a buffer for paving purposes adjacent to proposed retaining walls and/or as directed by the Engineer.

Materials and Equipment: Materials and equipment utilized shall be in accordance with Articles 606.02 and 606.03 respectively of the Standard Specifications.

Construction Requirements: Construction shall conform to the details shown in the Plans and must meet all applicable portions of section 606 of the Standard Specifications. The depth of concrete curb shall extend to match the depth of the adjacent Hot Mix Asphalt Shoulder

Method of Measurement: This work will be measured for payment, complete in place and accepted, in units of feet along the face of the proposed retaining wall.

Basis of Payment: This work will be paid for at the contract unit price per foot, for CONCRETE CURB, TYPE B (SPECIAL).

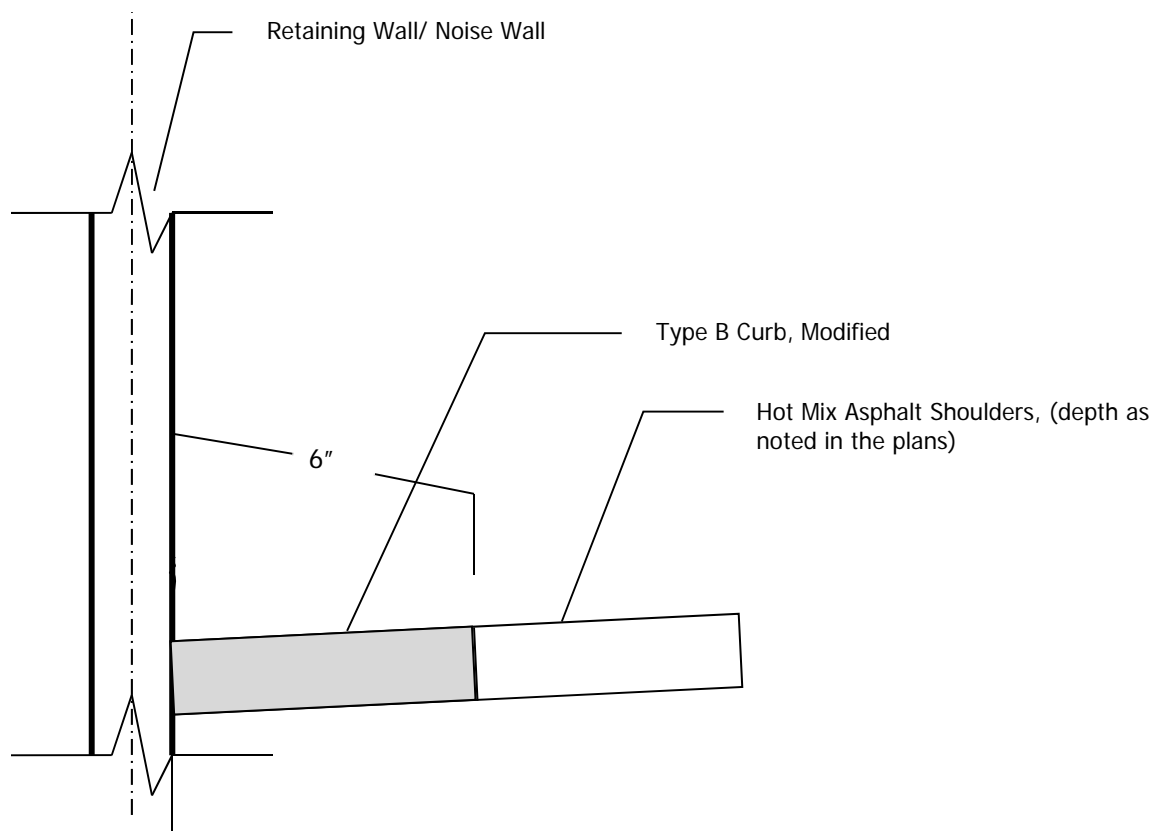

Revised 6-8-18

This page intentionally left blank.

Revised 6-8-18

This page intentionally left blank.

Revised 6-8-18