

URBAN

URBAN

SUMMARY OF QUANTITIES			TOTAL QUANTITIES	80% FED 20% STATE 0005	CONSTRUCTION TYPE CODE				
CODE NO	ITEM	UNIT							
20200100	EARTH EXCAVATION	CU YD	258	258					
21101615	TOPSOIL FURNISH AND PLACE, 4"	SO YD	267	267					
25000400	NITROGEN FERTILIZER NUTRIENT	POUND	4	4					
25000500	PHOSPHORUS FERTILIZER NUTRIENT	POUND	4	4					
25000600	POTASSIUM FERTILIZER NUTRIENT	POUND	4	4					
25200110	SODDING, SALT TOLERANT	SO YD	267	267					
25200200	SUPPLEMENTAL WATERING	UNIT	2.7	2.7					
40600290	BITUMINOUS MATERIALS (TACK COAT)	POUND	100,812	100,812					
40600400	MIXTURE FOR CRACKS, JOINTS, AND FLANGEWAYS	TON	249	249					
40600827	POLYMERIZED LEVELING BINDER (MACHINE METHOD), IL-4.75, N50	TON	4783	4783					
40600982	HOT-MIX ASPHALT SURFACE REMOVAL - BUTT JOINT	SO YD	2414	2414					
42001300	PROTECTIVE COAT	SO YD	6547	6547					
42400200	PORTLAND CEMENT CONCRETE SIDEWALK 5 INCH	SO FT	47200	47200					
42400800	DETECTABLE WARNINGS	SO FT	2137	2137					

SUMMARY OF QUANTITIES			TOTAL QUANTITIES	80% FED 20% STATE 0005	CONSTRUCTION TYPE CODE				
CODE NO	ITEM	UNIT							
44000159	HOT-MIX ASPHALT SURFACE REMOVAL, 2 1/2"	SO YD	115945	115945					
44000600	SIDEWALK REMOVAL	SO FT	47200	47200					
44201789	CLASS D PATCHES, TYPE II, 12 INCH	SO YD	396	396					
44201794	CLASS D PATCHES, TYPE III, 12 INCH	SO YD	161	161					
44201796	CLASS D PATCHES, TYPE IV, 12 INCH	SO YD	721	721					
60255410	CATCH BASINS TO BE CLEANED	EACH	6	6					
60266600	VALVE BOXES TO BE ADJUSTED	EACH	8	8					
60300105	FRAMES AND GRATES TO BE ADJUSTED	EACH	14	14					
* 66900200	NON-SPECIAL WASTE DISPOSAL	CU YD	258	258					
* 66900450	SPECIAL WASTE PLANS AND REPORTS	L SUM	1	1					
* 66900530	SOIL DISPOSAL ANALYSIS	EACH	5	5					
67000400	ENGINEER'S FIELD OFFICE, TYPE A	CAL MO	6	6					
67100100	MOBILIZATION	L SUM	1	1					
70102625	TRAFFIC CONTROL AND PROTECTION, STANDARD 701606	L SUM	1	1					

1

14

M

100% STATE
 SPECIALTY ITEM

FILE NAME =	USER NAME = Btlgrants	DESIGNED -	REVISED -
pl:\VLD\BIBID\INT\EG\Illinois\gov\PH\DOT\Documents\SDC\Gf\trns\Q\trier\N\proj\ch\0032\B\CAD\Draw\Draw\0032\B\0032.dwg		CHECKED -	REVISED -
PLOT SCALE = 1000000' / 1"		DATE -	REVISED -
PLOT DATE = 3/23/2018			

STATE OF ILLINOIS
DEPARTMENT OF TRANSPORTATION

SUMMARY OF QUANTITIES
CERMAK RD. - IL 43 (HARLEM AVE.) TO IL 50 (CICERO AVE.)

F.A.I. R.T.E.	SECTION	COUNTY	TOTAL SHEETS	SHEET NO.
1453	(78-1&78-3)RS-2	COOK	54	3
CONTRACT NO. 62F74				
FED. ROAD DIST. NO. 1 ILLINOIS FED. AID PROJECT				

URBAN

URBAN

SUMMARY OF QUANTITIES			CONSTRUCTION TYPE CODE	
CODE NO	ITEM	UNIT	TOTAL QUANTITIES	80% FED 20% STATE 0005
70102630	TRAFFIC CONTROL AND PROTECTION, STANDARD 701601	L SUM	1	1
70102635	TRAFFIC CONTROL AND PROTECTION, STANDARD 701701	L SUM	1	1
70102640	TRAFFIC CONTROL AND PROTECTION, STANDARD 701801	L SUM	1	1
70300100	SHORT TERM PAVEMENT MARKING	FOOT	47228	47228
70300150	SHORT TERM PAVEMENT MARKING REMOVAL	SO FT	7879	7879
70300210	TEMPORARY PAVEMENT MARKING LETTERS AND SYMBOLS	SO FT	2520	2520
70300220	TEMPORARY PAVEMENT MARKING - LINE 4"	FOOT	78,920	78,920
70300240	TEMPORARY PAVEMENT MARKING - LINE 6"	FOOT	11056	11056
70300250	TEMPORARY PAVEMENT MARKING - LINE 8"	FOOT	805	805
70300260	TEMPORARY PAVEMENT MARKING - LINE 12"	FOOT	177	177
70300280	TEMPORARY PAVEMENT MARKING - LINE 24"	FOOT	6836	6836
70300520	PAVEMENT MARKING TAPE, TYPE III 4"	FOOT	11807	11807
* 78000100	THERMOPLASTIC PAVEMENT MARKING - LETTERS AND SYMBOLS	SO FT	2520	2520

SUMMARY OF QUANTITIES			CONSTRUCTION TYPE CODE	
CODE NO	ITEM	UNIT	TOTAL QUANTITIES	80% FED 20% STATE 0005
* 78000200	THERMOPLASTIC PAVEMENT MARKING - LINE 4"	FOOT	78,920	78,920
* 78000400	THERMOPLASTIC PAVEMENT MARKING - LINE 6"	FOOT	11056	11056
* 78000500	THERMOPLASTIC PAVEMENT MARKING - LINE 8"	FOOT	805	805
* 78000600	THERMOPLASTIC PAVEMENT MARKING - LINE 12"	FOOT	177	177
* 78000650	THERMOPLASTIC PAVEMENT MARKING - LINE 24"	FOOT	6836	6836
* 78100100	RAISED REFLECTIVE PAVEMENT MARKER	EACH	790	790
78300200	RAISED REFLECTIVE PAVEMENT MARKER REMOVAL	EACH	790	790
* 88600600	DETECTOR LOOP REPLACEMENT	FOOT	7459	7459
* 89502376	REBUILD EXISTING HANDHOLE	EACH	60	60
X0320050	CONSTRUCTION LAYOUT (SPECIAL)	L SUM	1	1
X0327611	REMOVE AND REINSTALL BRICK PAVER	SO FT	4482	4482
X4060004	POLYMERIZED HOT-MIX ASPHALT SURFACE COURSE, STONE MATRIX ASPHALT, 9.5, N80	TON	11363	11363
* 12	SPECIALTY ITEMS			

1

1

FILE NAME = *p:\vld\84EBID\HWEG\Illinois\gov\PI\DOT\Documents\NVD\0110es\01strid\NPro\Tech\01032\BNCAD\Date\Design\01032\01032.dwg*
 USER NAME = *Bligraslee*
 DESIGNED -
 REVISIONS:
 REVISIONS:
 REVISIONS:
 REVISIONS:
 CHECKED -
 DATE -
 PLOT SCALE = 100,0000 "/>

STATE OF ILLINOIS
DEPARTMENT OF TRANSPORTATION

SUMMARY OF QUANTITIES
CERMAK RD. - IL 43 (HARLEM AVE.) TO IL 50 (CICERO AVE.)

SCALE: SHEET NO. OF SHEETS STA. TO STA.

F.A.D. RTE.	SECTION	COUNTY	TOTAL SHEETS	SHEET NO.
1453	(78-1&78-3)RS-2	COOK	54	4
CONTRACT NO. 62F74				
FED. ROAD DIST. NO. 1 ILLINOIS FED. AID PROJECT				

URBAN

SUMMARY OF QUANTITIES				CONSTRUCTION TYPE CODE			
CODE NO	ITEM	UNIT	TOTAL QUANTITIES	80% FED 20% STATE 0005			
X6030310	FRAMES AND LIDS TO BE ADJUSTED (SPECIAL)	EACH	109	109			
X7030005	TEMPORARY PAVEMENT MARKING REMOVAL	SQ FT	48,100	48,100			
Z0004562	COMBINATION CONCRETE CURB AND GUTTER REMOVAL AND REPLACEMENT	FOOT	5859	5859			
Z0030850	TEMPORARY INFORMATION SIGNING	SQ FT	51.4	51.4			
Z0033700	LONGITUDINAL JOINT SEALANT	FOOT	37567	37567			
∅ Z0076600	TRAINEES	HOUR	500	500			
∅ Z0076604	TRAINEES TRAINING PROGRAM GRADUATE	HOUR	500	500			
40603340	HOT-MIX ASPHALT SURFACE COURSE, MIX "D", N70	TON	4209	4209			
44000155	HOT-MIX ASPHALT SURFACE REMOVAL, 1.5"	SQ YD	50,110	50,110			

SUMMARY OF QUANTITIES				CONSTRUCTION TYPE CODE			
CODE NO	ITEM	UNIT	TOTAL QUANTITIES	80% FED 20% STATE 0005			

* SPECIALTY ITEMS
∅ 004Z

FILE NAME =	USER NAME = Bilgramian	DESIGNED -	REVISED -
	Office: 50131rd / Projects / 010321 / NCAD / 000 / Design / 010321 / 0001	CHECKED -	REVISED -
	PLOT SCALE = 100,000 1/16"	DATE -	REVISED -
	PLOT DATE = 3/23/2018		

**STATE OF ILLINOIS
DEPARTMENT OF TRANSPORTATION**

**SUMMARY OF QUANTITIES
CERMAK RD. - IL 43 (HARLEM AVE.) TO IL 50 (CICERO AVE.)**

F.A.U. RTE.	SECTION	COUNTY	TOTAL SHEETS	SHEET NO.
1453	(78-1&7B-3)RS-2	COOK	54	5
CONTRACT NO. 62F74				
SCALE: SHEET NO. OF SHEETS STA. TO STA.				
FED. ROAD DIST. NO. 1 [ILLINOIS] FED. AID PROJECT				

1

1

NOTES:

1. THE CONTRACTOR SHALL MILL FIRST BEFORE PATCHING BETWEEN STA. 11+43 AND STA. 177+11.7

HOT-MIX ASPHALT MIXTURE REQUIREMENTS			
MIXTURE USES	MIXTURE TYPE	AIR VOIDS @ Ndes	QUALITY MANAGEMENT PROGRAM (QMP)
PAVEMENT RESURFACING	POLYMERIZED HMA SURFACE COURSE, SMA, N80, (IL 9.5 mm); 1 3/4"	3.5% @ 80 GYR.	PFP
	POLYMERIZED LEVELING BINDER (MM), IL-4.75, N50; 3/4"	3.5% @ 50 GYR.	OCP
PATCHING	CLASS D PATCHES (HMA BINDER IL-19.0 mm)	4% @ 70 GYR	QC/OA
PARKING BAY RESURFACING	HMA SURFACE COURSE, MIX "D", N70	4% @ 70 GYR	QC/OA
QMP DESIGNATION: QUALITY CONTROL/QUALITY ASSURANCE (QC/OA); QUALITY CONTROL FOR PERFORMANCE (QCP); PAY FOR PERFORMANCE (PFP)			



NOTE 1: THE UNIT WEIGHT USED TO CALCULATE ALL HMA SURFACE MIXTURE QUANTITIES IS 112 LBS/SQ YD/IN.

NOTE 2: THE "AC TYPE" FOR POLYMERIZED HMA MIXES SHALL BE "SBS/SBR PG 76 -22" AND FOR NON-POLYMERIZED HMA THE "AC TYPE" SHALL BE "PG 64 -22" UNLESS MODIFIED BY DISTRICT ONE SPECIAL PROVISIONS.

FOR USE OF RECYCLED MATERIALS SEE DISTRICT ONE SPECIAL PROVISIONS.

QUALITY MANAGEMENT PROGRAM (QMP) IDENTIFIES THE PARTICULAR QUALITY CONTROL SPECIFICATION THAT APPLIES TO THE HMA MIXTURE.

MODEL: Default
 FILE: \\nas01c.pva.us:il08a\BID\NTEC\Illinois\gov\PI\DOT\Documents\DOT_Offices\District 1\Projects\1037_IL\CAD\Drawings\1037-18-ahr-hp\cal.dgn

USER NAME = lacymr	DESIGNED -	REVISED - ML 5/24/18
	DRAWN -	REVISED -
PLOT SCALE = 100,0000' / in.	CHECKED -	REVISED -
PLOT DATE = 5/25/2018	DATE -	REVISED -

**STATE OF ILLINOIS
DEPARTMENT OF TRANSPORTATION**

**EXISTING AND PROPOSED TYPICAL SECTIONS
CERMAK RD. - IL 43 (HARLEM AVE.) TO IL 50 (CICERO AVE.)**

SCALE: SHEET OF SHEETS STA. TO STA.

F.A.U. RTE.	SECTION	COUNTY	TOTAL SHEETS	SHEET NO.
1453	(78-1678-3)RS-2	COOK	54	6
CONTRACT NO. 62F74			ILLINOIS FED. AID PROJECT	

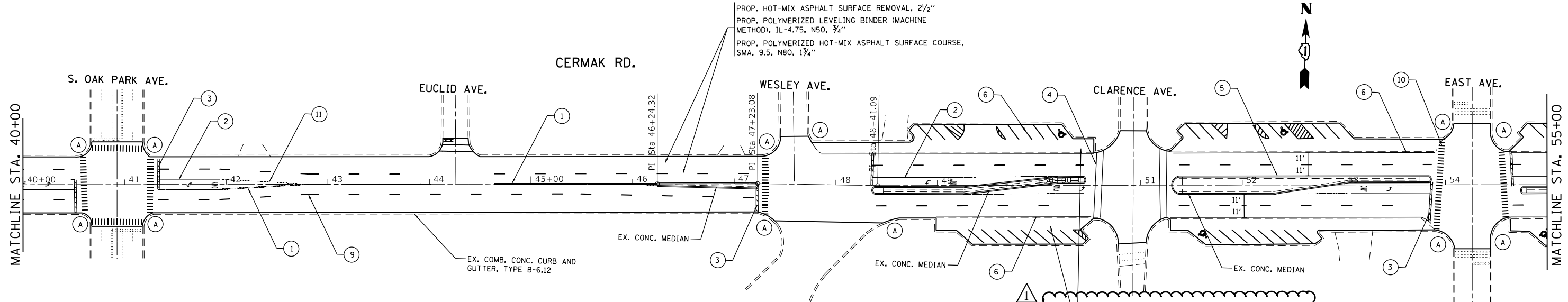

PAVEMENT MARKING LEGEND

- | | |
|---|--|
| ① THERMOPLASTIC PAVEMENT MARKING, 4" DOUBLE SOLID YELLOW CENTERLINE, 2 @ 11" C-C (TYP.) | ⑦ THERMOPLASTIC PAVEMENT MARKING 12" DIAGONAL SOLID WHITE LINE @ 75' C-C (5 MINIMUM) (TYP.) |
| ② THERMOPLASTIC PAVEMENT MARKING, 6" SOLID WHITE TURN LANE (TYP.) | ⑧ THERMOPLASTIC PAVEMENT MARKING, LETTERS AND SYMBOLS, SOLID WHITE (TYP.) |
| ③ THERMOPLASTIC PAVEMENT MARKING, 24" SOLID WHITE STOP BAR (TYP.) | ⑨ THERMOPLASTIC PAVEMENT MARKING, 4" SKIP DASH WHITE LANE LINE, 10' DASH - 30' SKIP (TYP.) |
| ④ THERMOPLASTIC PAVEMENT MARKING, 6" SOLID WHITE CROSSWALK LINE, 2 @ 6' C-C (TYP. UNLESS OTHERWISE NOTED) | ⑩ THERMOPLASTIC PAVEMENT MARKING, 12" SOLID WHITE LONGITUDINAL BAR, SPACED 2' APART (TYP.) |
| ⑤ THERMOPLASTIC PAVEMENT MARKING, 4" SINGLE SOLID YELLOW LINE (TYP.) | ⑪ THERMOPLASTIC PAVEMENT MARKING, 6" SKIP DASH WHITE TURN LANE, 2' LINE WITH 6' SPACE (TYP.) |
| ⑥ THERMOPLASTIC PAVEMENT MARKING, 4" SINGLE SOLID WHITE LINE (TYP.) | |

(PROP. PARKING BAY RESURFACING) (TYP.)
 PROP. HOT-MIX ASPHALT SURFACE REMOVAL, 1 1/2"
 PROP. HOT-MIX ASPHALT SURFACE COURSE,
 MIX "D", N70, 1 1/2"

Ⓐ PROP. PEDESTRIAN RAMP (ADA) IMPROVEMENTS

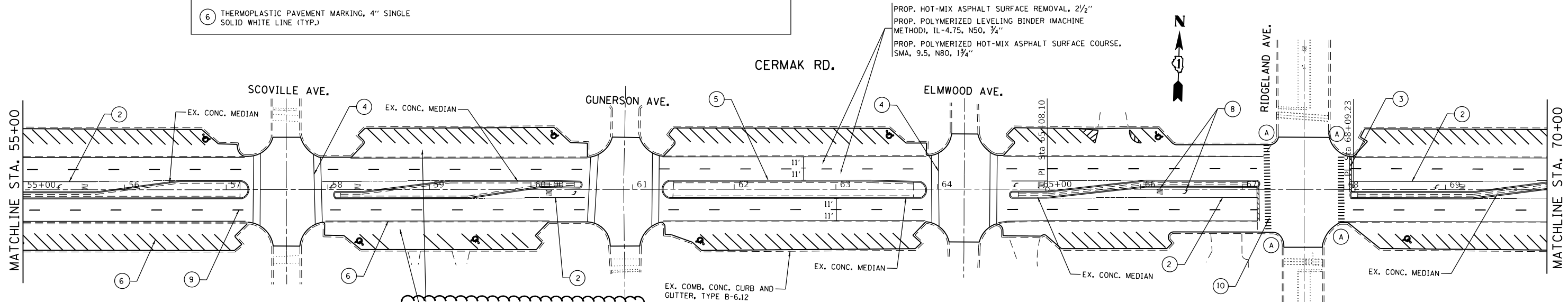

(PROP. PARKING BAY RESURFACING) (TYP.)
 PROP. HOT-MIX ASPHALT SURFACE REMOVAL, 1 1/2"
 PROP. HOT-MIX ASPHALT SURFACE COURSE,
 MIX "D", N70, 1 1/2"

Ⓐ PROP. PEDESTRIAN RAMP (ADA) IMPROVEMENTS

MODEL: Default
 FILE: h:\mhc\proj\1108\B&E\RD\ITEC\Illinois\gov\p\RD\DOT\Documents\1108\1108\0322\18-shr-pln.dgn
 PROJECT: 1108\0322\18-shr-pln.dgn
 OFFICE: 1108\0322\18-shr-pln.dgn

USER NAME = lacymr	DESIGNED -	REVISED -	ML 5/22/18
	DRAWN -	REVISED -	
PLOT SCALE = 100.0000' / in.	CHECKED -	REVISED -	
PLOT DATE = 5/23/2018	DATE -	REVISED -	

**STATE OF ILLINOIS
 DEPARTMENT OF TRANSPORTATION**

**ROADWAY PLAN CERMAK RD.
 IL. RTE. 43 (HARLEM AVE.) TO IL. RTE. 50 (CICERO AVE.)**

SCALE: 1"=50' SHEET OF SHEETS STA. 40+00 TO STA. 70+00

F.A.U. RTE.	SECTION	COUNTY	TOTAL SHEETS	SHEET NO.
1453	(78-1&78-3)RS-2	COOK	54	12
CONTRACT NO. 62F74				
ILLINOIS FED. AID PROJECT				

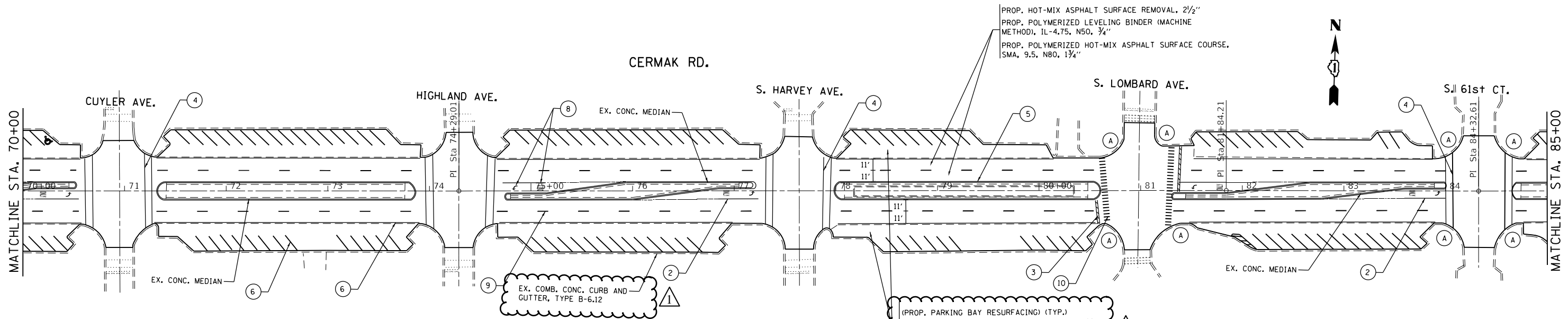

PAVEMENT MARKING LEGEND

- | | |
|---|--|
| ① THERMOPLASTIC PAVEMENT MARKING, 4" DOUBLE SOLID YELLOW CENTERLINE, 2 @ 11" C-C (TYP.) | ⑦ THERMOPLASTIC PAVEMENT MARKING 12" DIAGONAL SOLID WHITE LINE @ 75' C-C (5 MINIMUM) (TYP.) |
| ② THERMOPLASTIC PAVEMENT MARKING, 6" SOLID WHITE TURN LANE (TYP.) | ⑧ THERMOPLASTIC PAVEMENT MARKING, LETTERS AND SYMBOLS, SOLID WHITE (TYP.) |
| ③ THERMOPLASTIC PAVEMENT MARKING, 24" SOLID WHITE STOP BAR (TYP.) | ⑨ THERMOPLASTIC PAVEMENT MARKING, 4" SKIP DASH WHITE LANE LINE, 10' DASH - 30' SKIP (TYP.) |
| ④ THERMOPLASTIC PAVEMENT MARKING, 6" SOLID WHITE CROSSWALK LINE, 2 @ 6' C-C (TYP. UNLESS OTHERWISE NOTED) | ⑩ THERMOPLASTIC PAVEMENT MARKING, 12" SOLID WHITE LONGITUDINAL BAR, SPACED 2' APART (TYP.) |
| ⑤ THERMOPLASTIC PAVEMENT MARKING, 4" SINGLE SOLID YELLOW LINE (TYP.) | ⑪ THERMOPLASTIC PAVEMENT MARKING, 6" SKIP DASH WHITE TURN LANE, 2' LINE WITH 6' SPACE (TYP.) |
| ⑥ THERMOPLASTIC PAVEMENT MARKING, 4" SINGLE SOLID WHITE LINE (TYP.) | |

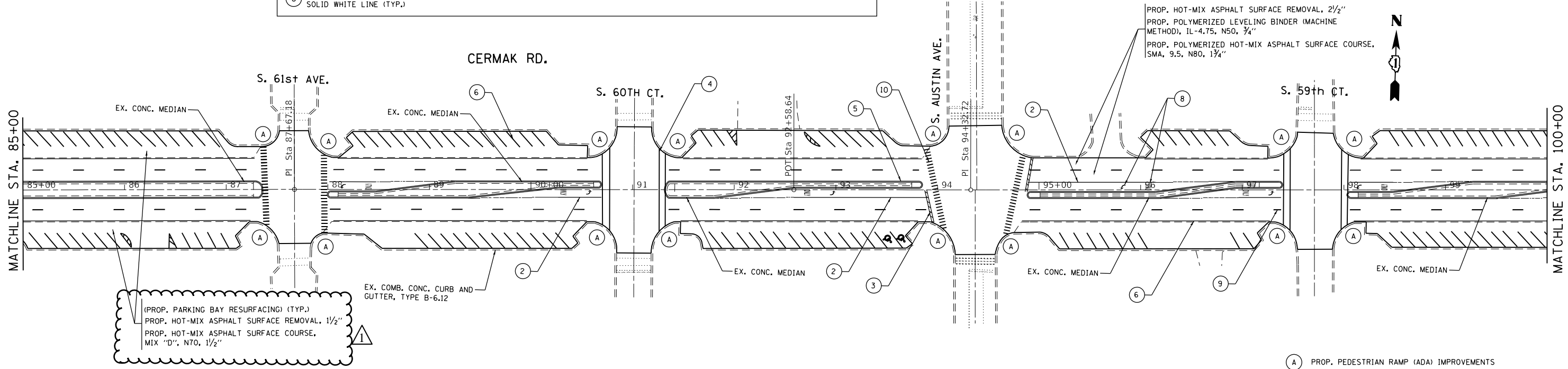

MODEL: Default
 FILE: \\nas01\p01\ul08\BEBIDNTEC\Illinois\gov\p01\ul08\BEBIDNTEC\Documents\DOT Office\Drawings\1\Project\103718\CADD\Drawings\103718-ahr-plan.dgn

USER NAME = lacymr	DESIGNED -	REVISED -	ML 5/22/18
PLOT SCALE = 100,0000' / in.	DRAWN -	REVISED -	
PLOT DATE = 5/23/2018	CHECKED -	REVISED -	
	DATE -	REVISED -	

**STATE OF ILLINOIS
DEPARTMENT OF TRANSPORTATION**

**ROADWAY PLAN CERMAK RD.
IL. RTE. 43 (HARLEM AVE.) TO IL. RTE. 50 (CICERO AVE.)**

SCALE: 1"=50' SHEET OF SHEETS STA. 70+00 TO STA. 100+00

F.A.U. RTE.	SECTION	COUNTY	TOTAL SHEETS	SHEET NO.
1453	(78-1&78-3)RS-2	COOK	54	13
CONTRACT NO. 62F74				
ILLINOIS FED. AID PROJECT				

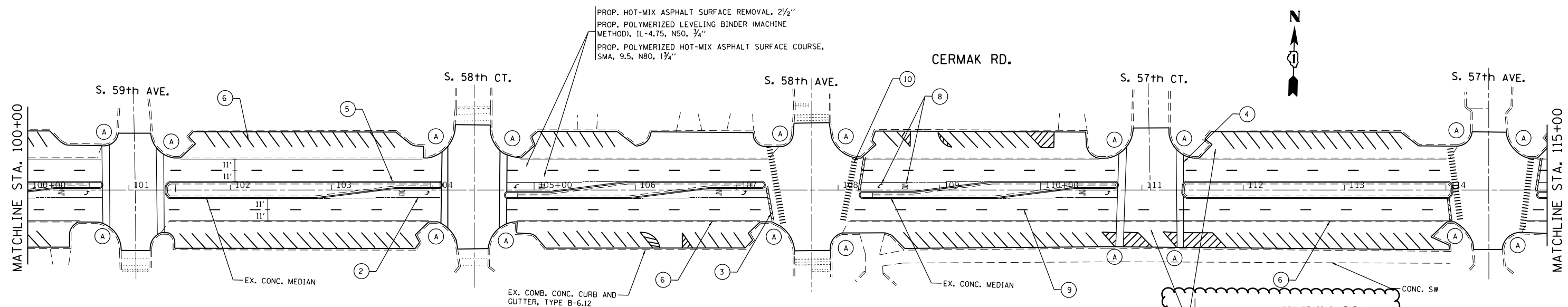

PAVEMENT MARKING LEGEND

- | | |
|---|--|
| ① THERMOPLASTIC PAVEMENT MARKING, 4" DOUBLE SOLID YELLOW CENTERLINE, 2 @ 11" C-C (TYP.) | ⑦ THERMOPLASTIC PAVEMENT MARKING 12" DIAGONAL SOLID WHITE LINE @ 75' C-C (5 MINIMUM) (TYP.) |
| ② THERMOPLASTIC PAVEMENT MARKING, 6" SOLID WHITE TURN LANE (TYP.) | ⑧ THERMOPLASTIC PAVEMENT MARKING, LETTERS AND SYMBOLS, SOLID WHITE (TYP.) |
| ③ THERMOPLASTIC PAVEMENT MARKING, 24" SOLID WHITE STOP BAR (TYP.) | ⑨ THERMOPLASTIC PAVEMENT MARKING, 4" SKIP DASH WHITE LANE LINE, 10' DASH - 30' SKIP (TYP.) |
| ④ THERMOPLASTIC PAVEMENT MARKING, 6" SOLID WHITE CROSSWALK LINE, 2 @ 6' C-C (TYP. UNLESS OTHERWISE NOTED) | ⑩ THERMOPLASTIC PAVEMENT MARKING, 12" SOLID WHITE LONGITUDINAL BAR, SPACED 2' APART (TYP.) |
| ⑤ THERMOPLASTIC PAVEMENT MARKING, 4" SINGLE SOLID YELLOW LINE (TYP.) | ⑪ THERMOPLASTIC PAVEMENT MARKING, 6" SKIP DASH WHITE TURN LANE, 2' LINE WITH 6' SPACE (TYP.) |
| ⑥ THERMOPLASTIC PAVEMENT MARKING, 4" SINGLE SOLID WHITE LINE (TYP.) | |

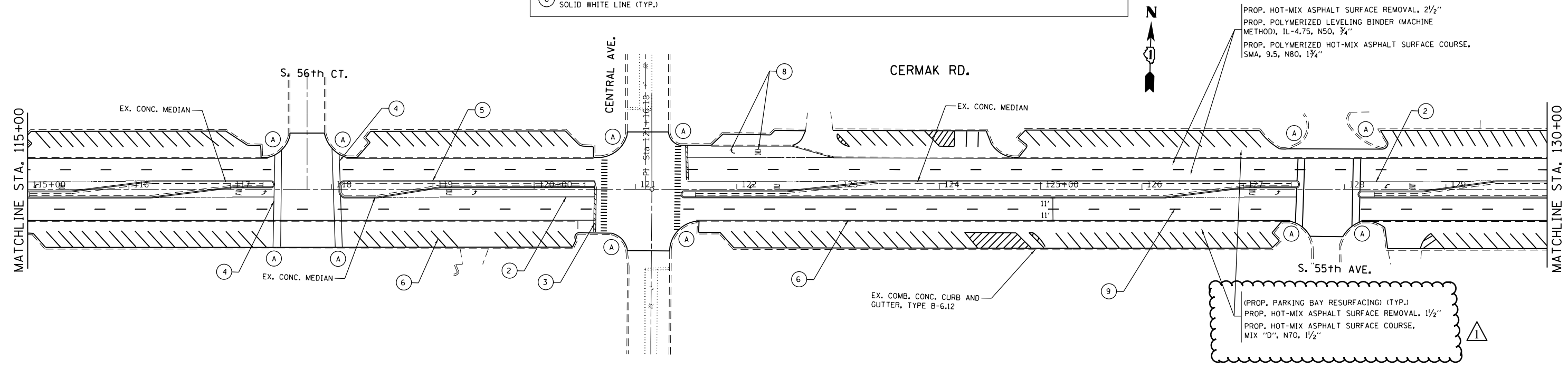

MODEL: Default
 FILE: \\nas01\pww\proj\10372\10372.dwg
 PROJECT: 10372
 USER: jacyr
 DATE: 5/23/2018

USER NAME = jacyr	DESIGNED -	REVISED -
	DRAWN -	REVISED -
PLOT SCALE = 100,0000' / in.	CHECKED -	REVISED -
PLOT DATE = 5/23/2018	DATE -	REVISED -

**STATE OF ILLINOIS
DEPARTMENT OF TRANSPORTATION**

**ROADWAY PLAN CERMAK RD.
IL. RTE. 43 (HARLEM AVE.) TO IL. RTE. 50 (CICERO AVE.)**

SCALE: 1"=50' SHEET OF SHEETS STA. 100+00 TO STA. 130+00

F.A.U. RTE.	SECTION	COUNTY	TOTAL SHEETS	SHEET NO.
1453	(78-1678-3)RS-2	COOK	54	14
CONTRACT NO. 62F74				
ILLINOIS FED. AID PROJECT				

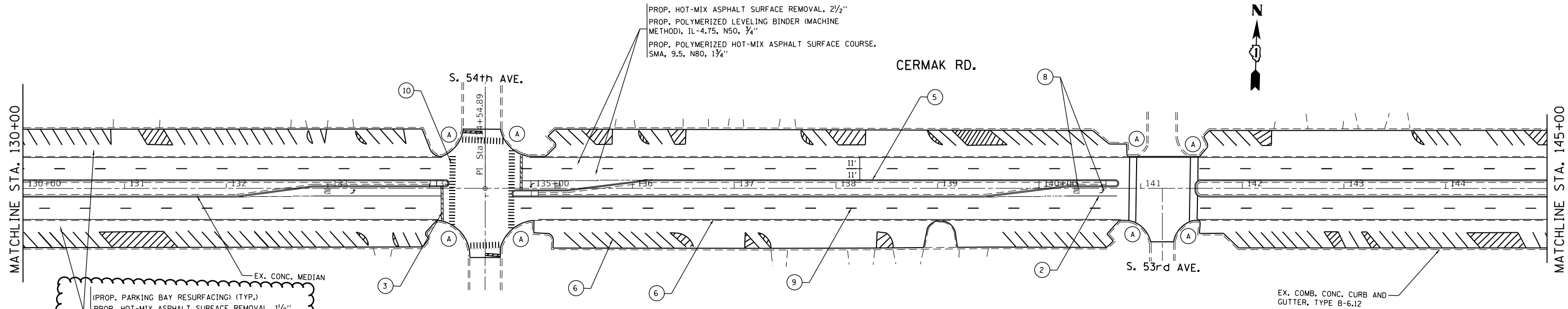

(PROP. PARKING BAY RESURFACING) (TYP.)
 PROP. HOT-MIX ASPHALT SURFACE REMOVAL, 1 1/2"
 PROP. HOT-MIX ASPHALT SURFACE COURSE,
 MIX "D", N70, 1 1/2"

PROP. HOT-MIX ASPHALT SURFACE REMOVAL, 2 1/2"
 PROP. POLYMERIZED LEVELING BINDER (MACHINE
 METHOD), IL-4.75, N50, 3/4"
 PROP. POLYMERIZED HOT-MIX ASPHALT SURFACE COURSE,
 SMA, 9.5, N80, 1 1/4"

EX. COMB. CONC. CURB AND
 GUTTER, TYPE B-6.12

PAVEMENT MARKING LEGEND

- ① THERMOPLASTIC PAVEMENT MARKING, 4" DOUBLE SOLID YELLOW CENTERLINE, 2 @ 11" C-C (TYP.)
- ② THERMOPLASTIC PAVEMENT MARKING, 6" SOLID WHITE TURN LANE (TYP.)
- ③ THERMOPLASTIC PAVEMENT MARKING, 24" SOLID WHITE STOP BAR (TYP.)
- ④ THERMOPLASTIC PAVEMENT MARKING, 6" SOLID WHITE CROSSWALK LINE, 2 @ 6' C-C (TYP. UNLESS OTHERWISE NOTED)
- ⑤ THERMOPLASTIC PAVEMENT MARKING, 4" SINGLE SOLID YELLOW LINE (TYP.)
- ⑥ THERMOPLASTIC PAVEMENT MARKING, 4" SINGLE SOLID WHITE LINE (TYP.)
- ⑦ THERMOPLASTIC PAVEMENT MARKING 12" DIAGONAL SOLID WHITE LINE @ 75' C-C (5 MINIMUM) (TYP.)
- ⑧ THERMOPLASTIC PAVEMENT MARKING, LETTERS AND SYMBOLS, SOLID WHITE (TYP.)
- ⑨ THERMOPLASTIC PAVEMENT MARKING, 4" SKIP DASH WHITE LANE LINE, 10' DASH - 30' SKIP (TYP.)
- ⑩ THERMOPLASTIC PAVEMENT MARKING, 12" SOLID WHITE LONGITUDINAL BAR, SPACED 2' APART (TYP.)
- ⑪ THERMOPLASTIC PAVEMENT MARKING, 6" SKIP DASH WHITE TURN LANE, 2' LINE WITH 6' SPACE (TYP.)

Ⓐ PROP. PEDESTRIAN RAMP (ADA) IMPROVEMENTS

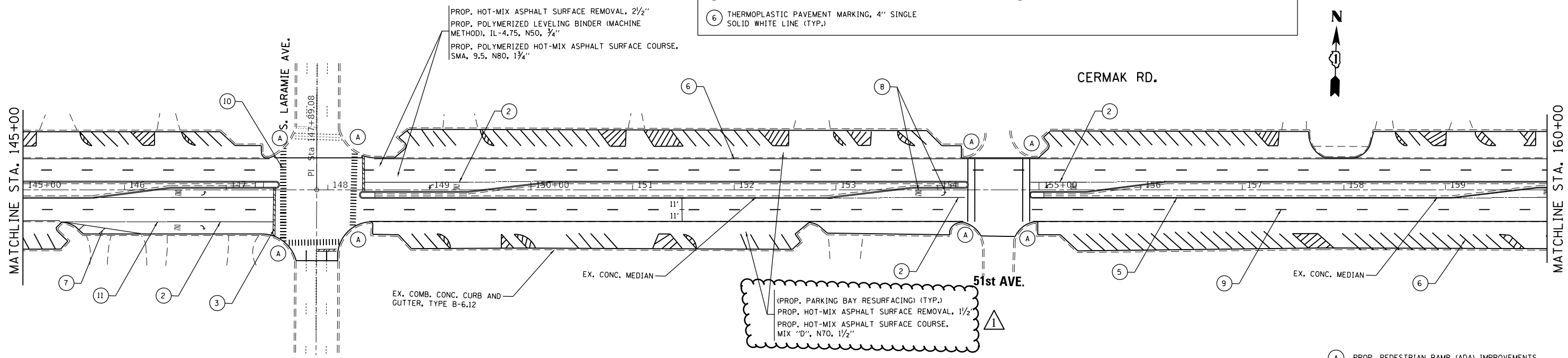

EX. COMB. CONC. CURB AND
 GUTTER, TYPE B-6.12

(PROP. PARKING BAY RESURFACING) (TYP.)
 PROP. HOT-MIX ASPHALT SURFACE REMOVAL, 1 1/2"
 PROP. HOT-MIX ASPHALT SURFACE COURSE,
 MIX "D", N70, 1 1/2"

Ⓐ PROP. PEDESTRIAN RAMP (ADA) IMPROVEMENTS

MODEL: Default
 FILE: \\nas01.cba.illinois.gov\pww\DOT\Documents\103718\CADD\Drawings\103718-ahr-plans.dgn

USER NAME = lacymr	DESIGNED -	REVISED -
PLOT SCALE = 100.0000' / in.	DRAWN -	REVISED -
PLOT DATE = 5/23/2018	CHECKED -	REVISED -
	DATE -	REVISED -

**STATE OF ILLINOIS
 DEPARTMENT OF TRANSPORTATION**

ROADWAY PLAN CERMAK RD.			
IL. RTE. 43 (HARLEM AVE.) TO IL. RTE. 50 (CICERO AVE.)			
SCALE: 1"=50'	SHEET	OF	SHEETS
	STA. 130+00	TO	STA. 160+00

F.A.U. RTE.	SECTION	COUNTY	TOTAL SHEETS	SHEET NO.
1453	(78-1678-3)RS-2	COOK	54	15
CONTRACT NO. 62F74				
ILLINOIS FED. AID PROJECT				

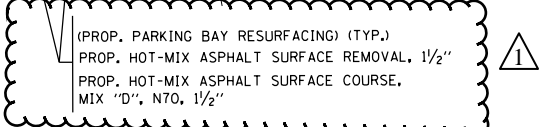
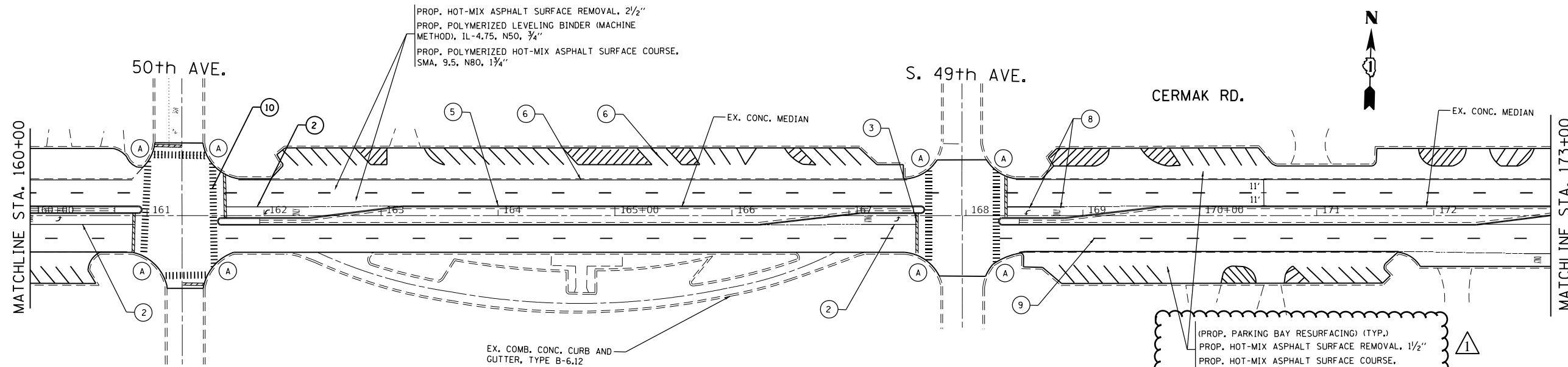

PAVEMENT MARKING LEGEND

- ① THERMOPLASTIC PAVEMENT MARKING, 4" DOUBLE SOLID YELLOW CENTERLINE, 2 @ 11" C-C (TYP.)
- ② THERMOPLASTIC PAVEMENT MARKING, 6" SOLID WHITE TURN LANE (TYP.)
- ③ THERMOPLASTIC PAVEMENT MARKING, 24" SOLID WHITE STOP BAR (TYP.)
- ④ THERMOPLASTIC PAVEMENT MARKING, 6" SOLID WHITE CROSSWALK LINE, 2 @ 6' C-C (TYP. UNLESS OTHERWISE NOTED)
- ⑤ THERMOPLASTIC PAVEMENT MARKING, 4" SINGLE SOLID YELLOW LINE (TYP.)
- ⑥ THERMOPLASTIC PAVEMENT MARKING, 4" SINGLE SOLID WHITE LINE (TYP.)
- ⑦ THERMOPLASTIC PAVEMENT MARKING 12" DIAGONAL SOLID WHITE LINE @ 75' C-C (5 MINIMUM) (TYP.)
- ⑧ THERMOPLASTIC PAVEMENT MARKING, LETTERS AND SYMBOLS, SOLID WHITE (TYP.)
- ⑨ THERMOPLASTIC PAVEMENT MARKING, 4" SKIP DASH WHITE LANE LINE, 10' DASH - 30' SKIP (TYP.)
- ⑩ THERMOPLASTIC PAVEMENT MARKING, 12" SOLID WHITE LONGITUDINAL BAR, SPACED 2' APART (TYP.)
- ⑪ THERMOPLASTIC PAVEMENT MARKING, 6" SKIP DASH WHITE TURN LANE, 2' LINE WITH 6' SPACE (TYP.)

Ⓐ PROP. PEDESTRIAN RAMP (ADA) IMPROVEMENTS

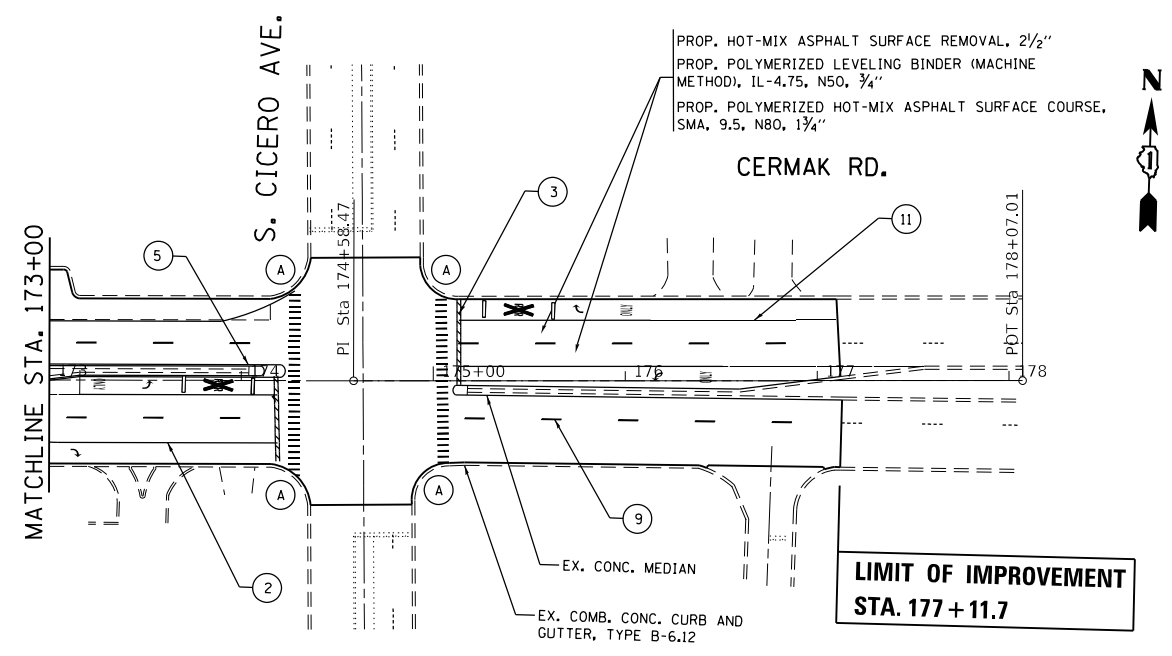

Ⓐ PROP. PEDESTRIAN RAMP (ADA) IMPROVEMENTS

MODEL: Default
 FILE: \\nas01\p01\B&E\BID\NTEC\Illinois\p01\B&E\BID\DOT\Documents\DOT_Offices\BID\1032_16\CADD\B&E\Design\1032_18-ahr-plans.dgn

USER NAME = lacymr	DESIGNED -	REVISED -	ML 5/22/18
PLOT SCALE = 100,0000' / in.	DRAWN -	REVISED -	
PLOT DATE = 5/23/2018	CHECKED -	REVISED -	
	DATE -	REVISED -	

**STATE OF ILLINOIS
 DEPARTMENT OF TRANSPORTATION**

**ROADWAY PLAN CERMAK RD.
 IL. RTE. 43 (HARLEM AVE.) TO IL. RTE. 50 (CICERO AVE.)**

SCALE: 1"=50' SHEET OF SHEETS STA. 150+00 TO STA. 177+11.7

F.A.U. RTE.	SECTION	COUNTY	TOTAL SHEETS	SHEET NO.
1453	(78-1&78-3)RS-2	COOK	54	16
CONTRACT NO. 62F74				
ILLINOIS FED. AID PROJECT				