

STATE OF ILLINOIS
DEPARTMENT OF TRANSPORTATION

F.A.P. RTE.	SECTION	COUNTY	TOTAL SHEETS	SHEET NO.
315	(28) RS-9, SW	HANCOCK	15	7
ILLINOIS CONTRACT NO. 72J54				

D-96-013-17

INDEX OF SHEETS

- 1 COVER SHEET
- 2 GENERAL NOTES
- 3-4 SUMMARY OF QUANTITIES
- 5-6 SCHEDULE OF QUANTITIES
- 7-8 TYPICAL SECTIONS
- 9 ALIGNMENT, TIES, BENCHMARKS
- 10-11 PLAN SHEETS
- 12-15 ADA-SIDEWALK DETAIL SHEETS

STANDARDS

000001-06	606001-07
001006	701311-03
424001-10	701502-08
424006-03	701701-10
424011-03	701801-06
442201-03	701901-07
602306-03	780001-05
602601-05	781001-04
604051-04	

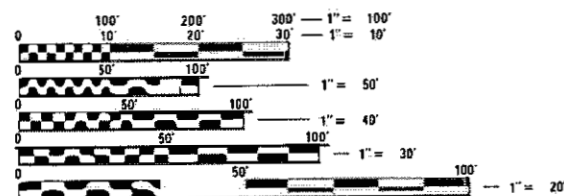

FULL SIZE PLANS HAVE BEEN PREPARED USING STANDARD ENGINEERING SCALES. REDUCED SIZED PLANS WILL NOT CONFORM TO STANDARD SCALES. IN MAKING MEASUREMENTS ON REDUCED PLANS, THE ABOVE SCALES MAY BE USED.

J.U.L.I.E.
JOINT UTILITY LOCATION INFORMATION FOR EXCAVATION
1-800-892-0123
OR 811

PROJECT ENGINEER: JAY WAVERING 217-785-9046
PROJECT MANAGER: JON KELLEY 217-785-2739

CONTRACT NO. 72J54

PROPOSED
HIGHWAY PLANS

FAP ROUTE 315 (US 136)
SECTION (28) RS-9, SW
PROJECT NHPP - XVP4 (996)
3P RESURFACING /ADA SIDEWALKS
HANCOCK COUNTY

C-96-013-17



LOCATION OF SECTION INDICATED THUS: -

ADT = 5,550 (2017) MU = 4.50%
SU = 2.52% CRS = 4.2 (2017)
PV = 92.97%

BEGIN IMPROVEMENT
STA. 67+39.00

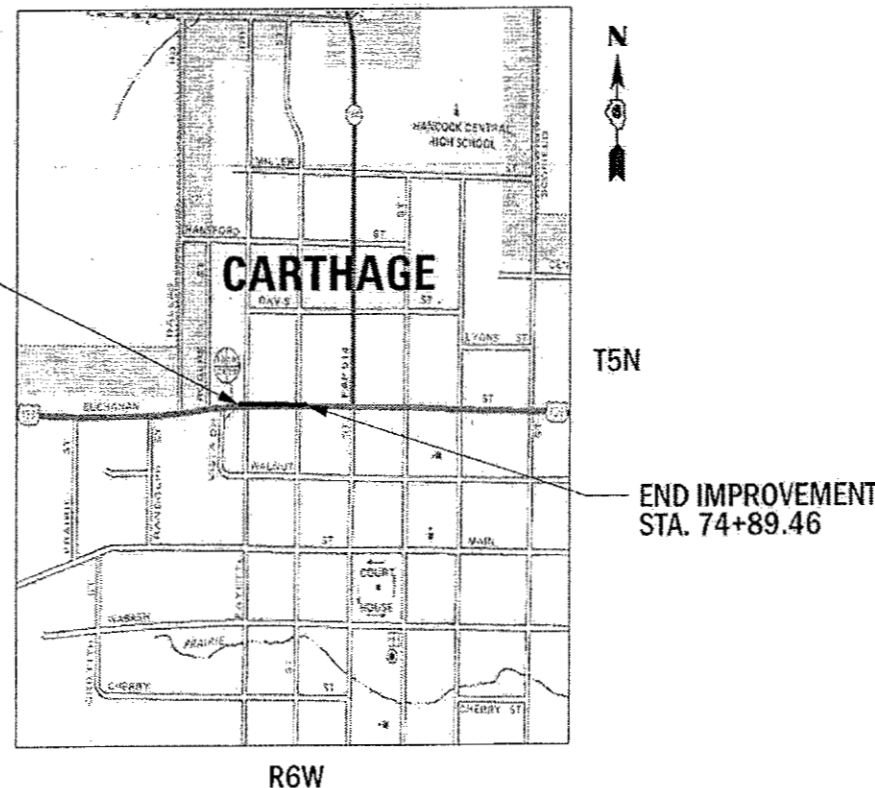

END IMPROVEMENT
STA. 74+89.46

GROSS LENGTH = 750.46 FT. = 0.14 MILE
NET LENGTH = 750.46 FT. = 0.14 MILE

STATE OF ILLINOIS
DEPARTMENT OF TRANSPORTATION

SUBMITTED *March 15 20 18*

Gilbert M. Smith, Jr.
REGIONAL ENGINEER

May 11 20 18
CO. *E.A. Elk*
ENGINEER OF DESIGN AND ENVIRONMENT

May 10 20 18
DIRECTOR OF HIGHWAYS PROJECT IMPLEMENTATION

PRINTED BY THE AUTHORITY
OF THE STATE OF ILLINOIS

GENERAL NOTES

1. IN ADDITION TO FIELD SURVEYS AND AERIAL SURVEYS, PLAN DIMENSIONS AND DETAILS RELATIVE TO THE EXISTING FACILITIES HAVE BEEN TAKEN FROM EXISTING PLANS AND ARE SUBJECT TO CONSTRUCTION VARIATIONS. IT SHALL BE THE CONTRACTOR'S RESPONSIBILITY TO VERIFY SUCH DIMENSIONS AND DETAILS IN THE FIELD. SUCH VARIATIONS SHALL NOT BE A CAUSE FOR ADDITIONAL COMPENSATION DUE TO A CHANGE IN THE SCOPE OF THE WORK. HOWEVER, THE CONTRACTOR WILL BE PAID FOR THE QUANTITY ACTUALLY FURNISHED AT THE BID PRICE FOR THE WORK.
2. ANY EXISTING ROAD SIGNS THAT INTERFERE WITH CONSTRUCTION WILL BE REMOVED OR RELOCATED AS DIRECTED BY THE ENGINEER. AFTER THE CONSTRUCTION IS COMPLETED, THE CONTRACTOR WILL REPLACE THE SIGNS AS DIRECTED BY THE ENGINEER. THIS WORK WILL NOT BE PAID SEPARATELY BUT SHALL BE CONSIDERED INCIDENTAL TO THE CONTRACT AND NO COMPENSATION WILL BE ALLOWED.
3. WHERE SECTION OR SUBSECTION MONUMENTS ARE ENCOUNTERED, THE ENGINEER SHALL BE NOTIFIED BEFORE SUCH MONUMENTS ARE REMOVED. THE CONTRACTOR SHALL PROTECT AND CAREFULLY PRESERVE ALL PROPERTY MARKERS, MONUMENTS, AND PERMANENT SURVEY MARKERS UNTIL THE OWNER AND AUTHORIZED SURVEYOR OR AGENT HAS WITNESSED OR OTHERWISE REFERENCED THEIR LOCATION.
4. ACCESS TO ALL ENTRANCES AND SIDE ROADS SHALL BE MAINTAINED AT ALL TIMES.
5. THE CONTRACTOR SHALL NOTIFY THE DISTRICT 6 BUREAU OF OPERATIONS AT (217) 785-5312 THREE WEEKS PRIOR TO IMPLEMENTING ANY TRAFFIC CONTROL.
6. THE CONTRACTOR SHALL KEEP PUBLIC STREET PAVEMENTS CLEAN OF DIRT AND DEBRIS.
7. THE THICKNESS OF HMA MIXTURES SHOWN ON THE PLANS IS THE NOMINAL THICKNESS. DEVIATIONS FROM THE NOMINAL THICKNESS WILL BE PERMITTED WHEN SUCH DEVIATIONS OCCUR DUE TO IRREGULARITIES IN THE EXISTING SURFACE OR BASE ON WHICH THE HMA MIXTURE IS PLACED.
8. UNLESS DIRECTED BY THE ENGINEER, PAVEMENT MARKING LINES SHALL NOT BE LAID DIRECTLY OVER A LONGITUDINAL CRACK OR JOINT OR OVER A TAR OR ASPHALT PAINTED LINE. THE EDGE OF A CENTERLINE OR LANE LINE SHALL BE OFFSET A MINIMUM DISTANCE OF 2" FROM THE EDGE LINE OF PAVEMENT. SEE SECTION 780 OF THE STANDARD SPECIFICATIONS FOR TRAFFIC CONTROL ITEMS.
9. ANY REFERENCE TO A STANDARD IN THESE PLANS SHALL BE INTERPRETED TO MEAN THE EDITION AS INDICATED BY THE SUB-NUMBER LISTED ON THE INDEX OF SHEETS OR THE COPY OF THE STANDARD INCLUDED IN THESE PLANS.
10. THE LOCATIONS OF THOSE BURIED AND ABOVE GROUND UTILITIES SHOWN ARE APPROXIMATE. THE CONTRACTOR SHALL BE RESPONSIBLE FOR PROTECTING UTILITY PROPERTY FROM CONSTRUCTION OPERATIONS AS OUTLINED IN ARTICLE 107.26 OF THE STANDARD SPECIFICATIONS. THE J.U.L.I.E. NUMBER IS 800-892-0123. A MINIMUM OF FORTY-EIGHT HOURS ADVANCED NOTICE IS REQUIRED.
11. ALL SAW CUTS NECESSARY TO COMPLETE THE WORK DETAILED IN THESE PLANS SHALL BE INCLUDED IN THE COST FOR THE VARIOUS PAY ITEMS INVOLVED.

MIXTURE REQUIREMENTS

Mixture Use:	HMA Surface	Leveling Binder	Base Course / Patching	Incidental
PG:	PG 64-22	PG 64-22	PG 64-22	PG 64-22
Design Air Voids:	4.0% @ N50	4.0% @ N50	4.0% @ N50	4.0% @ N50
Mixture Composition:	IL-9.5	IL-9.5	IL-19.0	IL-9.5
Friction Aggregate:	Mix "D"	N/A	N/A	Mix "C"
Quality Management:	QC/QA	QC/QA	QC/QA	QC/QA
Sublot Size:	N/A	N/A	N/A	N/A

DISTRICT SIX

EXAMINED March 13th 20 18
John C. Cunningham
 OPERATIONS ENGINEER

EXAMINED February 28th 20 18
Scott J. Graham
 PROJECT IMPLEMENTATION ENGINEER

EXAMINED February 27 20 18
Julia P. Ma
 PROGRAM DEVELOPMENT ENGINEER

PROJECT: DISTRICT SIX
 FILE NAME: \\P:\BIDDING\BIDDING\ILLINOIS\PROJECTS\DISTRICT SIX\PROJECTS\DISTRICT SIX\GENERAL NOTES.DWG

USER NAME = boydce	DESIGNED -	REVISED -
PLOT SCALE = 100,0000' / in.	DRAWN -	REVISED -
PLOT DATE = 3/15/2018	CHECKED -	REVISED -
	DATE -	REVISED -

**STATE OF ILLINOIS
DEPARTMENT OF TRANSPORTATION**

GENERAL NOTES		F.A.P. RTE.	SECTION	COUNTY	TOTAL SHEETS	SHEET NO.
		315	(28) RS-9, SW	HANCOCK	15	2
SCALE	SHEET	OF	SHEETS	STA.	TO STA.	ILLINOIS FED. AID PROJECT

PPS# 6-01118-0000

CONSTR. CODE

NHPP
80%-20%
ROADWAY
0005
URBAN

CODE NO.	ITEM	UNIT	TOTAL QUANTITY	URBAN
20200100	EARTH EXCAVATION	CU YD	55	55
20800150	TRENCH BACKFILL	CU YD	4	4
25000100	SEEDING, CLASS 1	ACRE	0.25	0.25
25000400	NITROGEN FERTILIZER NUTRIENT	POUND	23	23
25000500	PHOSPHORUS FERTILIZER NUTRIENT	POUND	23	23
25000600	POTASSIUM FERTILIZER NUTRIENT	POUND	23	23
25100115	MULCH, METHOD 2	ACRE	0.25	0.25
31101200	SUBBASE GRANULAR MATERIAL, TYPE B 4"	SQ YD	471	471
35501320	HOT-MIX ASPHALT BASE COURSE, 9"	SQ YD	471	471
35800100	PREPARATION OF BASE	SQ YD	44	44
35800200	AGGREGATE BASE REPAIR	TON	8	8
40600290	BITUMINOUS MATERIALS (TACK COAT)	POUND	2357	2357
40600625	LEVELING BINDER (MACHINE METHOD), N50	TON	178	178
40600982	HOT-MIX ASPHALT SURFACE REMOVAL - BUTT JOINT	SQ YD	569	569

PPS# 6-01118-0000

CONSTR. CODE

NHPP
80%-20%
ROADWAY
0005
URBAN

CODE NO.	ITEM	UNIT	TOTAL QUANTITY	URBAN
40600990	TEMPORARY RAMP	SQ YD	142	142
40603335	HOT-MIX ASPHALT SURFACE COURSE, MIX "D", N50	TON	267	267
40800050	INCIDENTAL HOT-MIX ASPHALT SURFACING	TON	55	55
42300400	PORTLAND CEMENT CONCRETE DRIVEWAY PAVEMENT, 8 INCH	SQ YD	16	16
42400100	PORTLAND CEMENT CONCRETE SIDEWALK 4 INCH	SQ FT	2000	2000
42400800	DETECTABLE WARNINGS	SQ FT	129	129
44000100	PAVEMENT REMOVAL	SQ YD	471	471
44000159	HOT-MIX ASPHALT SURFACE REMOVAL, 2 1/2"	SQ YD	3085	3085
44000200	DRIVEWAY PAVEMENT REMOVAL	SQ YD	19	19
44000500	COMBINATION CURB AND GUTTER REMOVAL	FOOT	405	405
44000600	SIDEWALK REMOVAL	SQ FT	1764	1764
44200124	PAVEMENT PATCHING, TYPE III, 10 INCH	SQ YD	15	15
44201789	CLASS D PATCHES, TYPE II, 12 INCH	SQ YD	88	88
44201794	CLASS D PATCHES, TYPE III, 12 INCH	SQ YD	36	36

MODEL: Default
 FILE NAME: P:\1118\08\BIDD\ITEG_Bldgns.dwg
 PLOT DATE: 3/15/2018
 PLOT SCALE: 100.0000' / in.
 USER NAME: coxte
 DESIGNED: -
 DRAWN: -
 CHECKED: -
 DATE: -
 REVISED: -
 REVISED: -
 REVISED: -
 REVISED: -

**STATE OF ILLINOIS
DEPARTMENT OF TRANSPORTATION**

SUMMARY OF QUANTITIES

F.A.P. RTE.	SECTION	COUNTY	TOTAL SHEETS	SHEET NO.
315	(28) RS-9, SW	HANCOCK	15	3
CONTRACT NO. 72J54			ILLINOIS FED. AID PROJECT	

SCALE: SHEET OF SHEETS STA. TO STA.

PPS# 6-01118-0000
CONSTR. CODE
NHPP
80%-20%
ROADWAY
0005
URBAN

CODE NO.	ITEM	UNIT	TOTAL QUANTITY	URBAN
44201796	CLASS D PATCHES, TYPE IV, 12 INCH	SQ YD	33	33
550A0090	STORM SEWERS, CLASS A, TYPE 1 18"	FOOT	30	30
55100700	STORM SEWER REMOVAL 15"	FOOT	6	6
55100900	STORM SEWER REMOVAL 18"	FOOT	34	34
60240310	INLETS, TYPE B, TYPE 11 FRAME AND GRATE	EACH	1	1
60255500	MANHOLES TO BE ADJUSTED	EACH	4	4
60257900	MANHOLES TO BE RECONSTRUCTED	EACH	1	1
60265700	VALVE VAULTS TO BE ADJUSTED	EACH	6	6
60300105	FRAMES AND GRATES TO BE ADJUSTED	EACH	4	4
60500060	REMOVING INLETS	EACH	1	1
60603800	COMBINATION CONCRETE CURB AND GUTTER, TYPE B-6.12	FOOT	436	436
67100100	MOBILIZATION	LSUM	1	1
70102622	TRAFFIC CONTROL AND PROTECTION, STANDARD 701502	LSUM	1	1
70102635	TRAFFIC CONTROL AND PROTECTION, STANDARD 701701	LSUM	1	1

PPS# 6-01118-0000
CONSTR. CODE
NHPP
80%-20%
ROADWAY
0005
URBAN

CODE NO.	ITEM	UNIT	TOTAL QUANTITY	URBAN
70102640	TRAFFIC CONTROL AND PROTECTION, STANDARD 701801	LSUM	1	1
70103815	TRAFFIC CONTROL SURVEILLANCE	CAL DA	15.0	15
70300100	SHORT TERM PAVEMENT MARKING	FOOT	523	523
70300150	SHORT TERM PAVEMENT MARKING REMOVAL	SQ FT	58	58
* 78000300	THERMOPLASTIC PAVEMENT MARKING - LINE 5"	FOOT	1762	1762
* 78004200	PREFORMED PLASTIC PAVEMENT MARKING, TYPE B - INLAID - LETTERS AND SYMBOLS	SQ FT	125	125
* 78100100	RAISED REFLECTIVE PAVEMENT MARKER	EACH	37	37
78300200	RAISED REFLECTIVE PAVEMENT MARKER REMOVAL	EACH	37	37
X7015005	CHANGEABLE MESSAGE SIGN	CAL DA	180.0	180

* SPECIALTY ITEM

MODEL - D:\DWG\BIB\BIBINTEG.BIB\BIB.DWG PW\DOT\CONTRACTS\100721\CAD\DATA\CADD\BIBINTEG.DWG 15:50:00 PM

USER NAME = COXTE	DESIGNED -	REVISED -
PLOT SCALE = 100.0000" / in.	DRAWN -	REVISED -
PLOT DATE = 3/15/2018	CHECKED -	REVISED -
	DATE -	REVISED -

STATE OF ILLINOIS
DEPARTMENT OF TRANSPORTATION

SUMMARY OF QUANTITIES

F.A.P. RTE.	SECTION	COUNTY	TOTAL SHEETS	SHEET NO.
315	(28) RS-9, SW	HANCOCK	15	4
SCALE:		SHEET OF SHEETS	STA. TO STA.	
ILLINOIS FED. AID PROJECT CONTRACT NO. 72J54				

SIDEWALK AND COMBINATION CONCRETE CURB AND GUTTER SCHEDULE								
FAP 315 US 136 LOCATION	SIDE / QUADRANT	44000600 SIDEWALK REMOVAL (SQ FT)	42400100 PCC SIDEWALK 4" (SQ FT)	42400800 DETECTABLE WARNINGS (SQ FT)	44000500 COMBINATION CURB AND GUTTER REMOVAL (FT)	60603800 COMBINATION CONCRETE CURB AND GUTTER, TYPE B-6.12 (FT)	44000200 DRIVEWAY PAVEMENT REMOVAL (SQ YD)	42300400 PCC DRIVEWAY PAVEMENT, 8" (SQ YD)
US 136 (BUCHANAN ST.)								
STA. 67+39 TO STA. 68+25	RT SIDE				40	40		
STA. 73+82 TO STA. 74+62	RT SIDE				80	80		
SIDEROAD								
FAYETTE ST.	NW	170.3	178.2	20.0	30.6	34.4	6.1	6.1
FAYETTE ST.	NE	236.4	249.5	20.0	38.1	42.2		
FAYETTE ST.	SW	264.8	330.5	14.0	53.9	54.1		
FAYETTE ST.	SE	199.7	210.2	10.0	41.8	42.0		
MARION ST.	NW	126.8	155.0	14.8	26.0	32.3		
MARION ST.	NE	154.0	174.2	20.0	23.6	29.0		
MARION ST.	SW	347.6	345.2	10.0	44.4	41.4		
MARION ST.	SE	264.3	356.6	20.0	25.6	39.8	12.7	9.7
TOTALS		1763.9	1999.3	128.8	404.1	435.3	18.8	15.8

DRAINAGE STRUCTURES								
FAP 315 US 136 STATION	OFFSET	55100700 STORM SEWER REMOVAL, 15" (FOOT)	55100900 STORM SEWER REMOVAL, 18" (FOOT)	60500060 REMOVING INLETS (EACH)	60257900 MANHOLES TO BE RECONSTRUCTED (EACH)	60240310 INLETS, TYPE B TYPE 11 FRAME & GRATE (EACH)	550A0090 STORM SEWER CLASS A, TYPE 1 - 18" (FOOT)	20800150 TRENCH BACKFILL (CU YD)
68+53.33	27.44' RT	6.0		1				
68+58.37	23.03' RT		34.0		1		30.0	3.9
68+58.25	41.22' RT					1		
TOTALS		6.0	34.0	1	1	1	30.0	3.9

SEEDING SCHEDULE						
FAP 315 US 136 LOCATION	QUADRANT	25000100 SEEDING, CLASS 1 (ACRE)	25000400 NITROGEN FERTILIZER NUTRIENT (POUND)	25000500 PHOSPHORUS FERTILIZER NUTRIENT (POUND)	25000600 POTASSIUM FERTILIZER NUTRIENT (POUND)	25100115 MULCH, METHOD 2 (ACRE)
FAYETTE ST.	NW	0.03	2.70	2.70	2.70	0.03
FAYETTE ST.	NE	0.05	4.05	4.05	4.05	0.05
FAYETTE ST.	SW	0.05	4.05	4.05	4.05	0.05
FAYETTE ST.	SE	0.00	0.00	0.00	0.00	0.00
MARION ST.	NW	0.05	4.05	4.05	4.05	0.05
MARION ST.	NE	0.05	4.05	4.05	4.05	0.05
MARION ST.	SW	0.00	0.00	0.00	0.00	0.00
MARION ST.	SE	0.04	3.15	3.15	3.15	0.04
TOTALS		0.25	22.1	22.1	22.1	0.25

TEMPORARY RAMPS						
FAP 315 US 136 LOCATION	STATION	TO	STATION	LENGTH (FT)	WIDTH (FT)	40600990 TEMPORARY RAMPS (SQ YD)
	STA 67+39.00	TO	STA 67+47.50	8.5	38.0	35.89
	STA 74+80.96	TO	STA 74+89.46	8.5	38.0	35.89
	FAYETTE ST (NORTH LEG)			5.0	36.6	20.33
	FAYETTE ST (SOUTH LEG)			5.0	30.8	17.11
	MARION ST (NORTH LEG)			5.0	29.0	16.11
	MARION ST (SOUTH LEG)			5.0	29.5	16.39
TOTAL						141.72

MODEL: Default
 FILE: \\nas01c.psu.edu\BEBID\NTEC\Illinois\gov\PIV\DOT\Documents\1\DOT_Offices\Illinois\Projects\0672154\CADD\Drawn\CAD\sheet\0672154-eh-1-schedule.dgn

USER NAME = coxte	DESIGNED -	REVISED -
	DRAWN -	REVISED -
PLOT SCALE = 100.0000 ' / in.	CHECKED -	REVISED -
PLOT DATE = 3/15/2018	DATE -	REVISED -

**STATE OF ILLINOIS
DEPARTMENT OF TRANSPORTATION**

SCHEDULE OF QUANTITIES

SCALE: SHEET OF SHEETS STA. TO STA.

F.A.P. RTE.	SECTION	COUNTY	TOTAL SHEETS	SHEET NO.
315	(28) RS-9, SW	HANCOCK	15	6
CONTRACT NO. 72J54			ILLINOIS FED. AID PROJECT	

US 136 (BUCHANAN St)

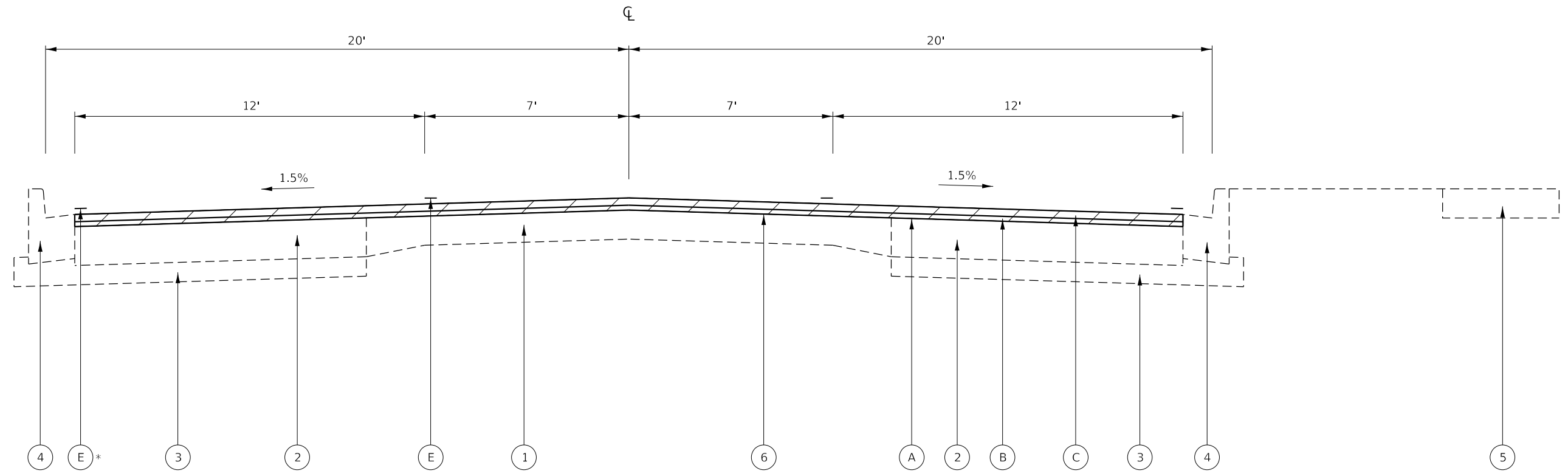

STA. 67+39.00 TO STA. 69+53.94
 STA. 73+06.82 TO STA. 74+89.46

EXISTING LEGEND

- ① EXISTING 9-6-9 PCC PAVEMENT
- ② EXISTING PCC WIDENING 8"
- ③ EXISTING GRANULAR SUBGRADE
- ④ EXISTING CONCRETE CURB & GUTTER (B-6.12)
- ⑤ EXISTING PCC SIDEWALK
- ⑥ EXISTING BITUMINOUS CONCRETE SURFACE 3"

PROPOSED LEGEND

- Ⓐ PROPOSED HMA SURFACE REMOVAL, 2 1/2"
- Ⓑ PROPOSED LEVELING BINDER 1"
- Ⓒ PROPOSED HMA SURFACE COURSE 1 1/2"
- Ⓓ PAVEMENT REMOVAL
- Ⓔ PROPOSED PAVEMENT MARKING LINE - 5"
- Ⓕ HMA BASE COURSE 9"
- Ⓖ EARTH EXCAVATION
- Ⓗ SUBBASE GRANULAR MATERIAL, TYPE B - 4"

NOTE:

*STRIPE EDGE OF PAVEMENT ONLY FROM THE BEGINNING OF JOB TO STA. 68+42.85

MODEL: Default
 FILE: \\nashville\p\proj\72154\CD\Drawings\DOT\Office\Drawings\DOT\Drawings\72154-Sub-By-Pic.dwg

USER NAME = coxte	DESIGNED -	REVISED -
	DRAWN -	REVISED -
PLOT SCALE = 40,0000' / in.	CHECKED -	REVISED -
PLOT DATE = 3/15/2018	DATE -	REVISED -

STATE OF ILLINOIS
 DEPARTMENT OF TRANSPORTATION

FAP 315 (US 136)
 TYPICAL SECTIONS

SCALE: SHEET OF SHEETS STA. TO STA.

F.A.P. RTE.	SECTION	COUNTY	TOTAL SHEETS	SHEET NO.
315	(28) RS-9, SW	HANCOCK	15	7
ILLINOIS FED. AID PROJECT			CONTRACT NO. 72J54	

US 136 (BUCHANAN St)

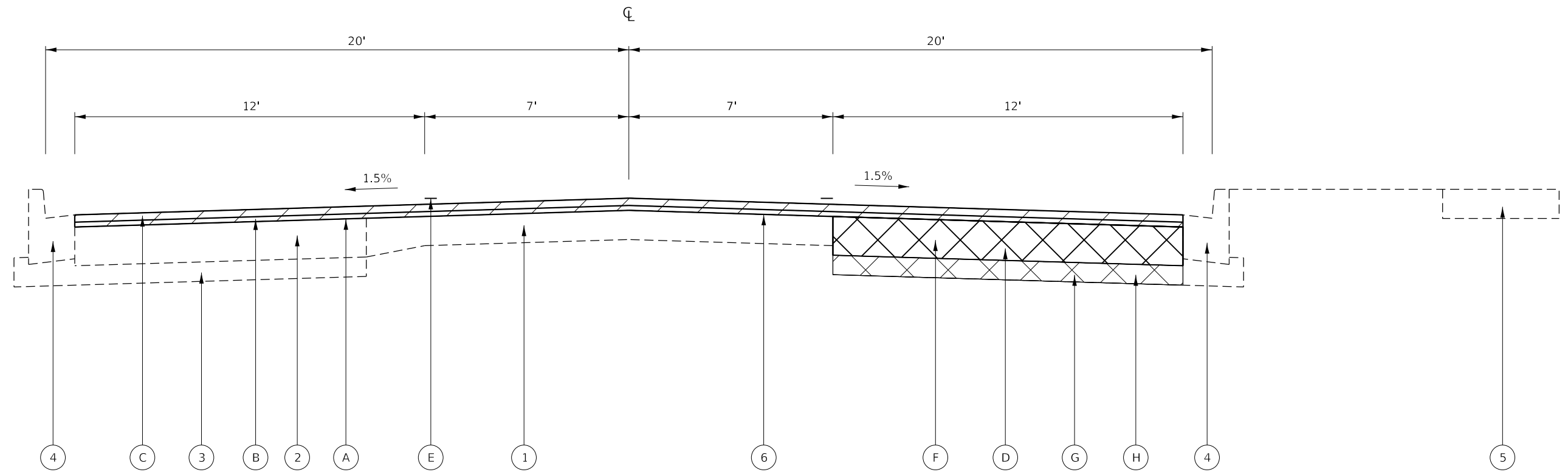

STA. 69+53.94 TO STA. 73+06.82

EXISTING LEGEND

- ① EXISTING 9-6-9 PCC PAVEMENT
- ② EXISTING PCC WIDENING 8"
- ③ EXISTING GRANULAR SUBGRADE
- ④ EXISTING CONCRETE CURB & GUTTER (B-6.12)
- ⑤ EXISTING PCC SIDEWALK
- ⑥ EXISTING BITUMINOUS CONCRETE SURFACE 3"

PROPOSED LEGEND

- Ⓐ PROPOSED HMA SURFACE REMOVAL, 2 1/2"
- Ⓑ PROPOSED LEVELING BINDER 1"
- Ⓒ PROPOSED HMA SURFACE COURSE 1 1/2"
- Ⓓ PAVEMENT REMOVAL
- Ⓔ PROPOSED PAVEMENT MARKING LINE - 5"
- Ⓕ HMA BASE COURSE 9"
- Ⓖ EARTH EXCAVATION
- Ⓗ SUBBASE GRANULAR MATERIAL, TYPE B - 4"

MODEL: Default
 FILE: \\nas0101\pub\B84E8D1D\TEC\Illinois\gov\PI\DOT\Documents\1\DOT_Offices\DI\erict_6\Projects\067254\CADD\Bans\CAD\sheet\067254-eh-ty\pic\cal.dgn

USER NAME = coxte	DESIGNED -	REVISED -
	DRAWN -	REVISED -
PLOT SCALE = 40.0000' / in.	CHECKED -	REVISED -
PLOT DATE = 3/15/2018	DATE -	REVISED -

**STATE OF ILLINOIS
DEPARTMENT OF TRANSPORTATION**

**FAP 315 (US 136)
TYPICAL SECTIONS**

SCALE: SHEET OF SHEETS STA. TO STA.

F.A.P. RTE.	SECTION	COUNTY	TOTAL SHEETS	SHEET NO.
315	(28) RS-9, SW	HANCOCK	15	8
ILLINOIS FED. AID PROJECT			CONTRACT NO. 72J54	

BENCHMARK INFORMATION			
DESCRIPTION	STATION	OFFSET	ELEVATION
BM 103: 60 D SPIKE NAIL IN POWER POLE IN FRONT OF HOUSE #254 ON SOUTH SIDE OF US 136	66+42.00	22.8' RT	NGVD '29 = 675.00
BM 104A: CHISLED SQUARE ON THE NE CORNER OF HARDEE'S PARKING LOT CURB, SW CORNER OF US 136 AND MADISON STREET	77+62.50	32.5' RT	NGVD '29 = 671.71

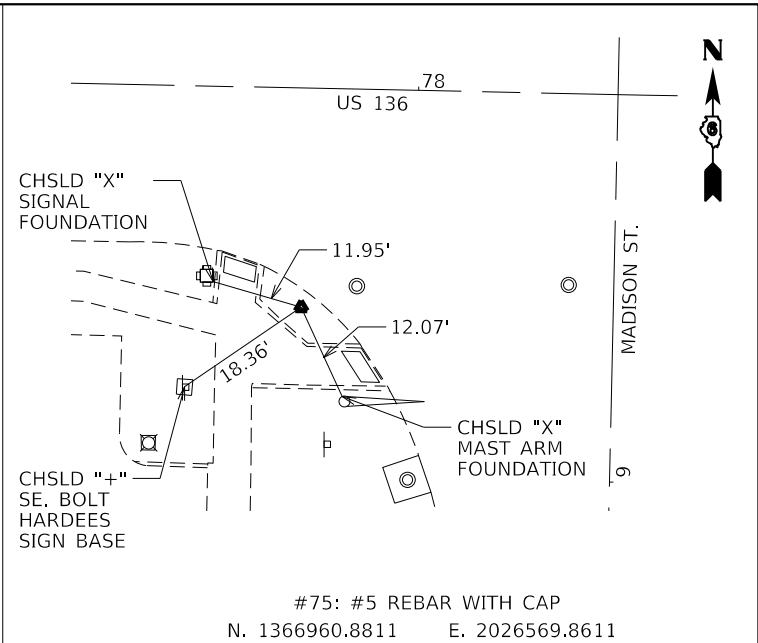
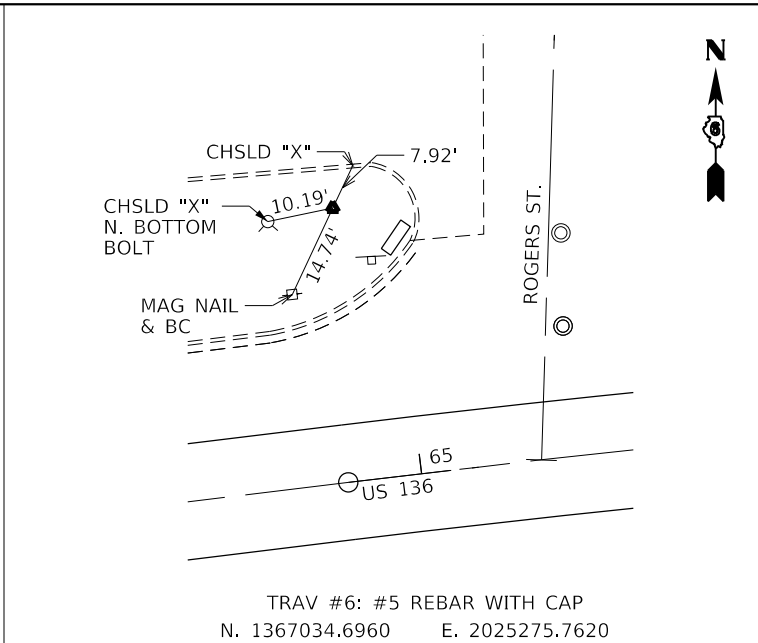

EXIST. CURVE 302
 PI STA. = 66+26.07
 $\Delta = 8^\circ 08' 18''$ (RT)
 $D = 3^\circ 00' 16''$
 $R = 1,907.12'$
 $T = 135.67'$
 $L = 270.89'$
 $E = 4.82'$
 $e =$
 $T.R. =$
 $S.E. RUN =$
 $P.C. STA. = 64+90.40$
 $P.T. STA. = 67+61.29$

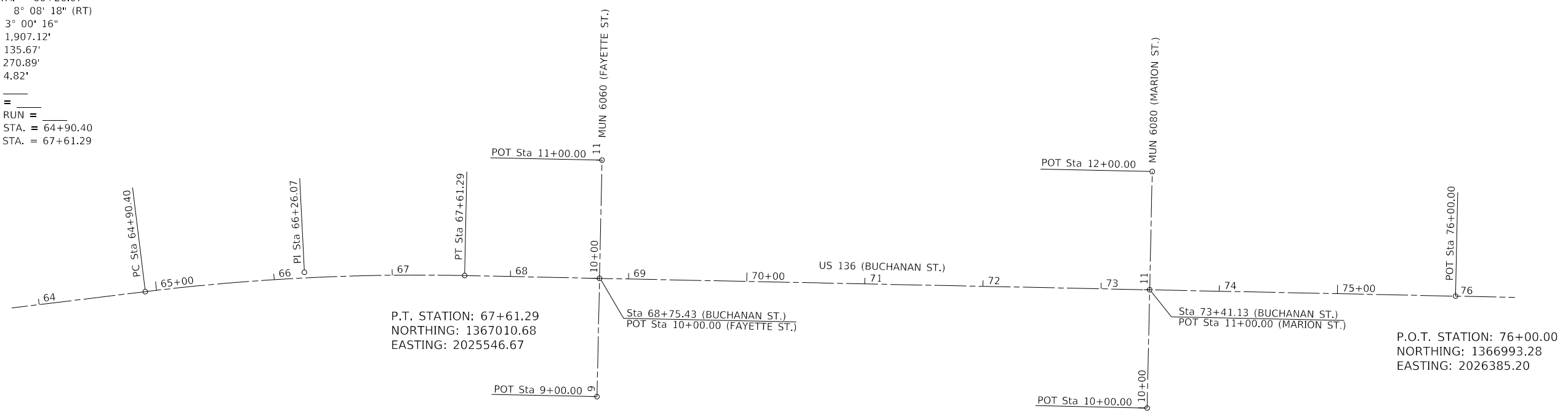

MODEL: Default
 FILE NAME: p:\u0008\BID\NTEC\Illinois\p08\RID\DOT\Documents\1\DOT_Offices\1\dot\0672154\CADD\Drawn\CAD\sheet\0672154-ah-a-TB.dgn

USER NAME = coxte	DESIGNED -	REVISED -
	DRAWN -	REVISED -
PLOT SCALE = 100.0000' / in.	CHECKED -	REVISED -
PLOT DATE = 3/15/2018	DATE -	REVISED -

**STATE OF ILLINOIS
DEPARTMENT OF TRANSPORTATION**

FAP 315 (US 136) ALIGNMENT, TIES, AND BENCHMARKS			
SCALE:	SHEET	OF SHEETS	STA. TO STA.

F.A.P. RTE. 315	SECTION (28) RS-9, SW	COUNTY HANCOCK	TOTAL SHEETS 15	SHEET NO. 9
ILLINOIS FED. AID PROJECT			CONTRACT NO. 72J54	

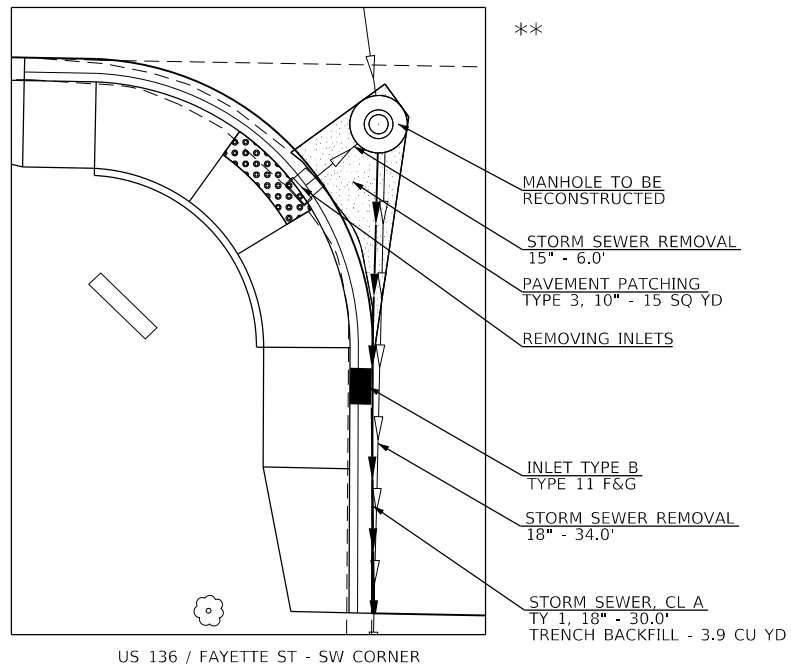

US 136 / FAYETTE ST - SW CORNER

LEGEND

	HMA SURFACE REMOVAL - BUTT JOINT		REMOVING INLETS
	PAVEMENT REMOVAL		MANHOLE TO BE RECONSTRUCTED
	DRIVEWAY PAVEMENT REMOVAL		FRAME AND LID TO BE ADJUSTED
	SIDEWALK REMOVAL		

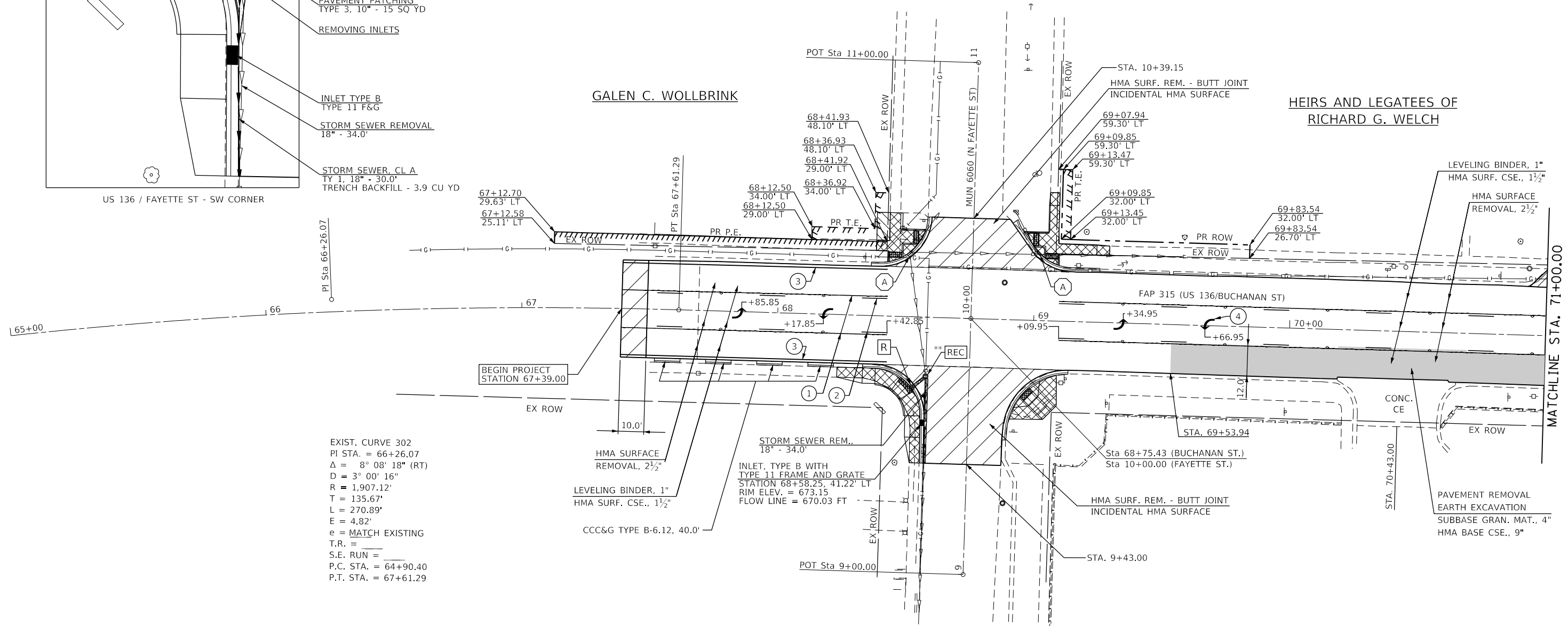

EXIST. CURVE 302
 PI STA. = 66+26.07
 $\Delta = 8^\circ 08' 18''$ (RT)
 $D = 3^\circ 00' 16''$
 $R = 1,907.12'$
 $T = 135.67'$
 $L = 270.89'$
 $E = 4.82'$
 $e = \text{MATCH EXISTING}$
 $T.R. = \text{---}$
 $S.E. \text{ RUN} = \text{---}$
 $P.C. \text{ STA.} = 64+90.40$
 $P.T. \text{ STA.} = 67+61.29$

PAVEMENT MARKING LEGEND

- ① THERMOPLASTIC PAVEMENT MARKING - LINE 5" - SOLID YELLOW
- ② THERMOPLASTIC PAVEMENT MARKING - LINE 5" - SKIP DASH YELLOW
- ③ THERMOPLASTIC PAVEMENT MARKING - LINE 5" - SOLID WHITE
- ④ PREFORMED PLASTIC PAVEMENT MARKING, TYPE B - INLAID - LETTERS AND SYMBOLS
- ◆ RAISED REFLECTIVE PAVEMENT MARKERS

NOTE: SEE SHEETS 12-15 FOR SIDEWALK RAMP DETAILS

MODEL PATH: \\s:\u0000\B&E\BIDD\TEC\Illinois\pwr\p\DOT\Documents\DOT - Offices\Bierfert @Projects\067254\CADD\Drawn\CAD\sheet\067254-shp\plan-20.dgn
 FILE NAME: pwr\p\DOT\Documents\DOT - Offices\Bierfert @Projects\067254\CADD\Drawn\CAD\sheet\067254-shp\plan-20.dgn

USER NAME = kelleyjb	DESIGNED -	REVISED -
	DRAWN -	REVISED -
PLOT SCALE = 40.0000' / in.	CHECKED -	REVISED -
PLOT DATE = 5/2/2018	DATE -	REVISED -

**STATE OF ILLINOIS
DEPARTMENT OF TRANSPORTATION**

**FAP 315 (US 136 / BUCHANAN ST)
PLAN SHEETS**

SCALE: SHEET OF SHEETS STA. TO STA.

F.A.P. RTE.	SECTION	COUNTY	TOTAL SHEETS	SHEET NO.
315	(28) RS-9, SW	HANCOCK	15	10
CONTRACT NO. 72J54				
ILLINOIS FED. AID PROJECT				

LEGEND

	HMA SURFACE REMOVAL - BUTT JOINT		REMOVING INLETS
	PAVEMENT REMOVAL		MANHOLE TO BE RECONSTRUCTED
	DRIVEWAY PAVEMENT REMOVAL		FRAME AND LID TO BE ADJUSTED
	SIDEWALK REMOVAL		

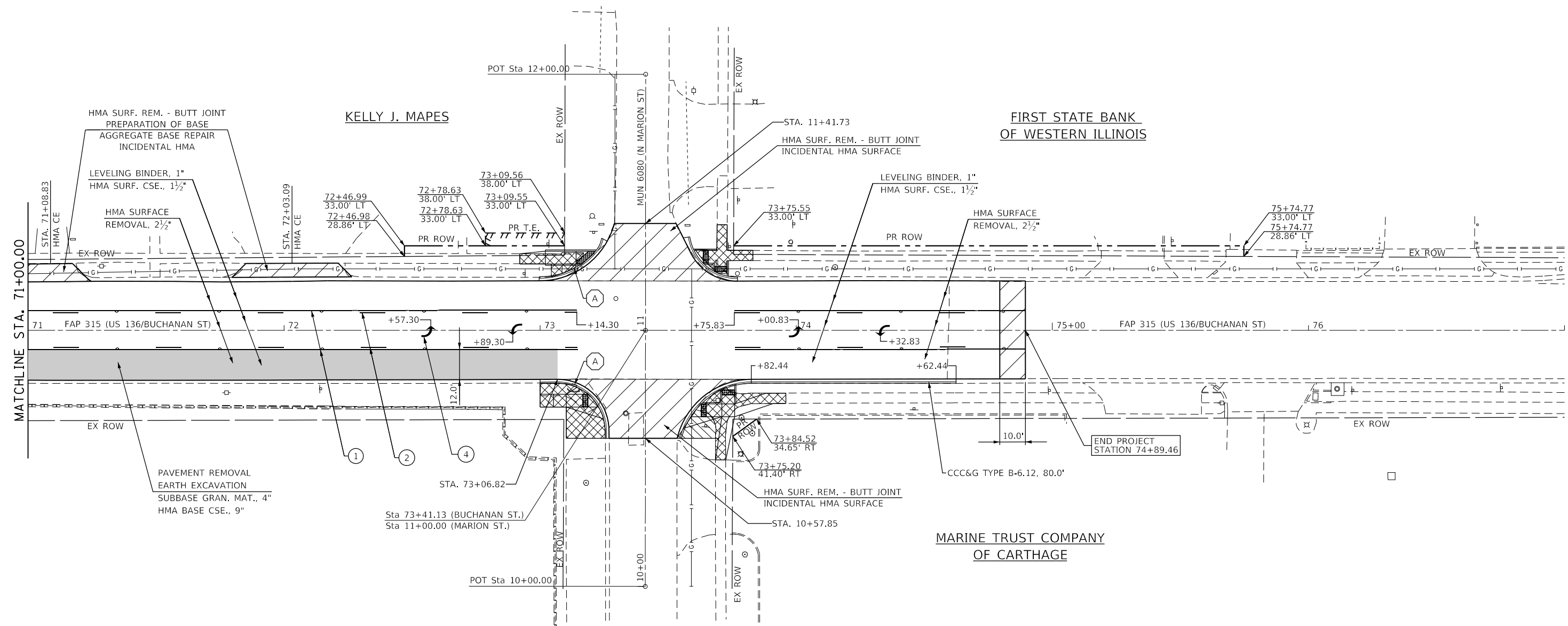

PAVEMENT MARKING LEGEND

- ① THERMOPLASTIC PAVEMENT MARKING - LINE 5" - SOLID YELLOW
- ② THERMOPLASTIC PAVEMENT MARKING - LINE 5" - SKIP DASH YELLOW
- ③ THERMOPLASTIC PAVEMENT MARKING - LINE 5" - SOLID WHITE
- ④ PREFORMED PLASTIC PAVEMENT MARKING, TYPE B - INLAID - LETTERS AND SYMBOLS
- ◆ RAISED REFLECTIVE PAVEMENT MARKERS

NOTE: SEE SHEETS 12-15 FOR SIDEWALK RAMP DETAILS

MODEL PATH: \\u0000\B&E\BID\NTEC\Illinois\pwr\pwr\DOT\Documents\DOT Office\Drawings\Projects\067254\CAD\Drawings\CAD\Sheet\067254-sht-pln-20.dgn
 FILE NAME: pwr\pwr\DOT\Documents\DOT Office\Drawings\Projects\067254\CAD\Drawings\CAD\Sheet\067254-sht-pln-20.dgn

USER NAME = coxte	DESIGNED -	REVISED -	STATE OF ILLINOIS DEPARTMENT OF TRANSPORTATION	FAP 315 (US 136 / BUCHANAN ST) PLAN SHEETS				F.A.P. RTE. 315	SECTION (28) RS-9, SW	COUNTY HANCOCK	TOTAL SHEETS 15	SHEET NO. 11
PLOT SCALE = 40.0000' / in.	CHECKED -	REVISED -		SCALE:	SHEET	OF	SHEETS	STA.	TO	STA.	CONTRACT NO. 72J54	
PLOT DATE = 3/16/2018	DATE -	REVISED -		ILLINOIS FED. AID PROJECT								

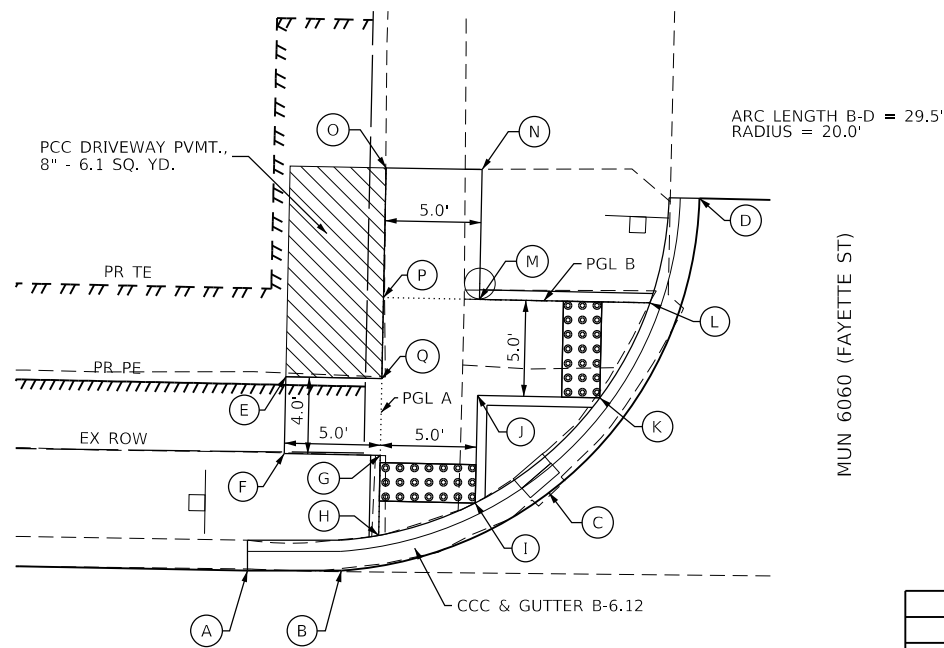

FAP 315 (US 136)

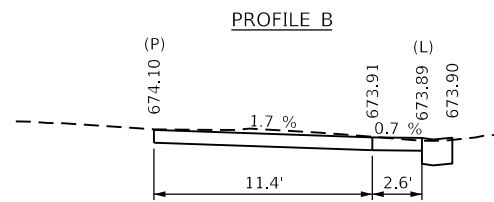
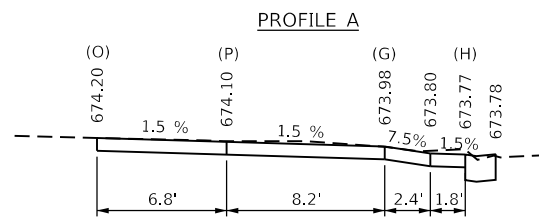

FAYETTE ST - NW CORNER			
	STATION	OFFSET	ELEVATION
A	68+35.98	19.29' LT	673.80
B	68+40.88	19.39' LT	673.79
C	68+51.60	23.68' LT	673.74
D	68+59.13	39.16' LT	674.17
E	68+37.77	29.43' LT	674.16
F	68+37.77	25.43' LT	674.08
G	68+42.77	25.43' LT	673.98
H	68+42.77	21.26' LT	673.77
I	68+47.77	23.05' LT	673.75
J	68+47.77	28.66' LT	673.94
K	68+54.15	28.66' LT	673.81
L	68+56.65	33.66' LT	673.89
M	68+47.77	33.66' LT	674.02
N	68+47.77	40.42' LT	674.20
O	68+42.77	40.41' LT	674.20
P	68+42.77	33.66' LT	674.10
Q	68+42.77	29.43' LT	674.04

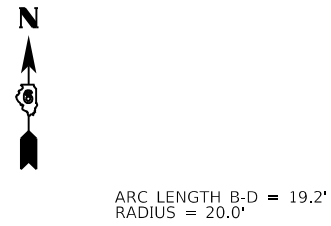

ARC LENGTH B-D = 19.2'
RADIUS = 20.0'

MUN 6060 (FAYETTE ST)

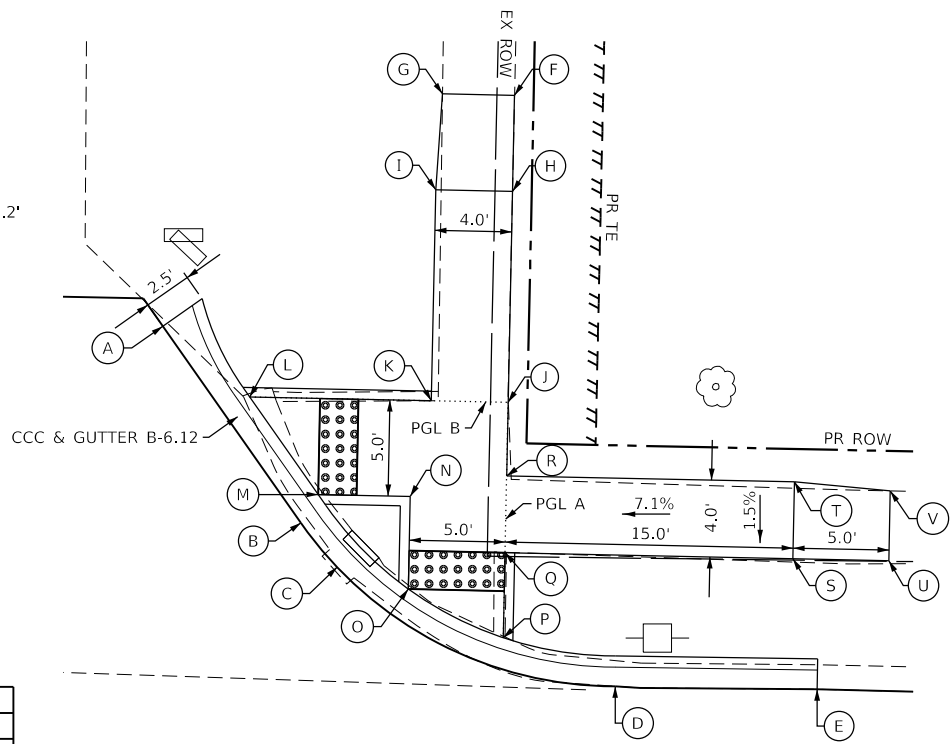

FAP 315 (US 136)

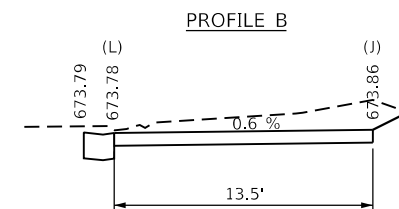
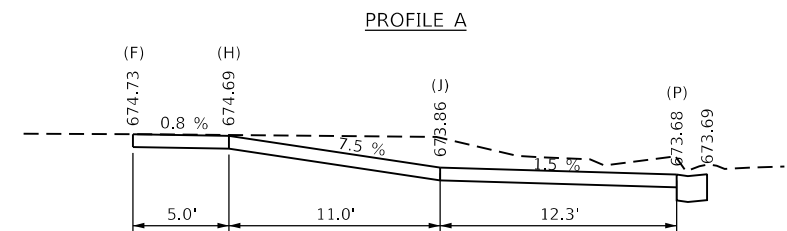

FAYETTE ST - NE CORNER			
	STATION	OFFSET	ELEVATION
A	68+90.78	37.71' LT	673.87
B	68+98.19	27.61' LT	673.69
C	69+00.12	25.35' LT	673.65
D	69+14.73	19.45' LT	673.71
E	69+25.25	19.51' LT	673.75
F	69+08.85	50.12' LT	674.73
G	69+05.08	50.12' LT	674.53
H	69+08.85	45.12' LT	674.69
I	69+04.85	45.12' LT	674.63
J	69+08.85	34.12' LT	673.86
K	69+04.85	34.12' LT	673.84
L	68+95.38	34.12' LT	673.78
M	68+99.05	29.12' LT	673.69
N	69+03.85	29.12' LT	673.75
O	69+03.85	24.29' LT	673.66
P	69+08.85	21.86' LT	673.68
Q	69+08.85	26.29' LT	673.75
R	69+08.85	30.29' LT	673.81
S	69+23.85	26.29' LT	674.82
T	69+23.85	30.29' LT	674.88
U	69+28.85	26.29' LT	674.80
V	69+28.85	29.92' LT	674.95

MODEL: Default
FILE: \\mhc-pw\illinois\project\7254\CADD\Drawings\DWG\7254-sw-ada-7215.dwg

USER NAME = kellyjb	DESIGNED -	REVISED -
DRAWN -	REVISOR -	
PLOT SCALE = 10.0000' / in.	CHECKED -	REVISED -
PLOT DATE = 5/2/2018	DATE -	REVISED -

STATE OF ILLINOIS
DEPARTMENT OF TRANSPORTATION

ADA - SIDEWALK DETAILS

SCALE: SHEET OF SHEETS STA. TO STA.

F.A.P. RTE. 315	SECTION (28) RS-9, SW	COUNTY HANCOCK	TOTAL SHEETS 15	SHEET NO. 12
CONTRACT NO. 72J54				
ILLINOIS FED. AID PROJECT				

FAP 315 (US 136)

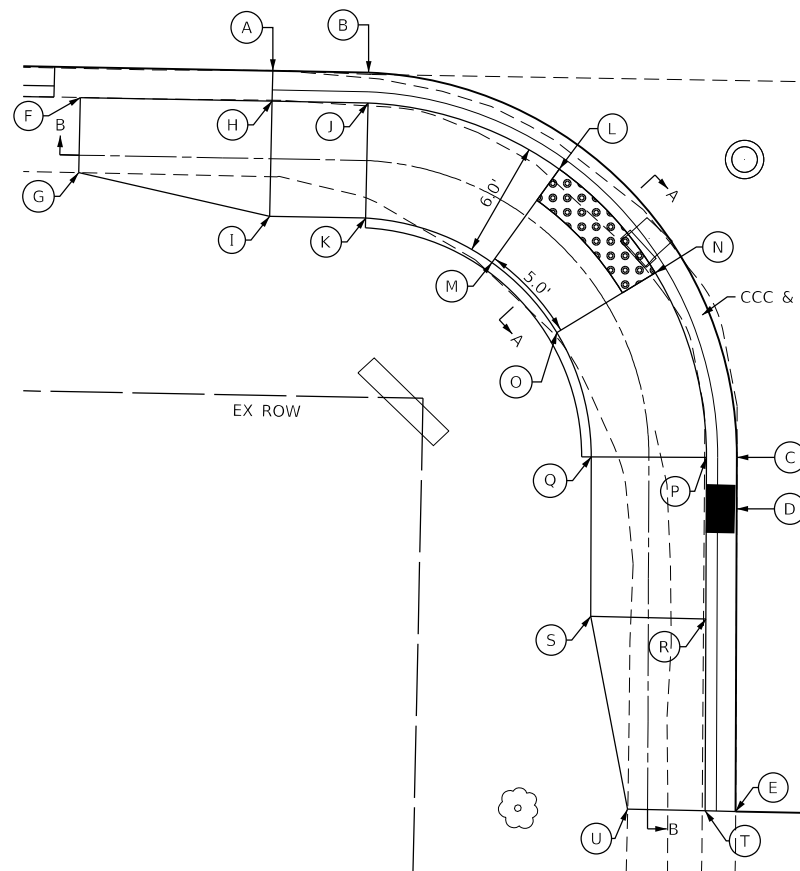

ARC LENGTH B-C = 30.7'
RADIUS = 20.0'

MUN 6060 (FAYETTE ST)

FAYETTE ST - SW CORNER			
	STATION	OFFSET	ELEVATION
A	68+33.70	18.92' RT	673.70
B	68+38.69	18.91' RT	673.62
C	68+58.29	38.56' RT	673.20
D	68+58.33	41.24' RT	673.15
E	68+58.61	57.00' RT	672.94
F	68+23.70	20.53' RT	673.96
G	68+23.70	24.44' RT	674.13
H	68+33.70	20.50' RT	674.14
I	68+33.70	26.50' RT	674.23
J	68+38.70	20.49' RT	674.06
K	68+38.70	26.50' RT	674.15
L	68+48.72	23.73' RT	673.45
M	68+45.33	28.67' RT	673.50
N	68+53.84	29.03' RT	673.34
O	68+48.77	32.25' RT	673.44
P	68+56.70	38.59' RT	673.64
Q	68+50.70	38.69' RT	673.73
R	68+56.85	47.00' RT	673.52
S	68+50.85	47.00' RT	673.61
T	68+57.02	57.00' RT	673.26
U	68+52.98	57.00' RT	673.26

SECTION A-A

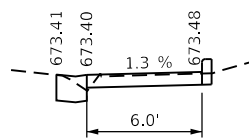

SECTION B-B

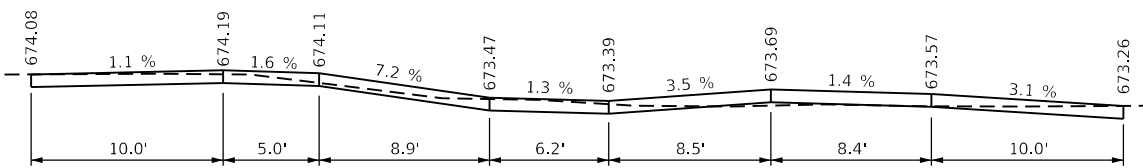

FAP 315 (US 136)

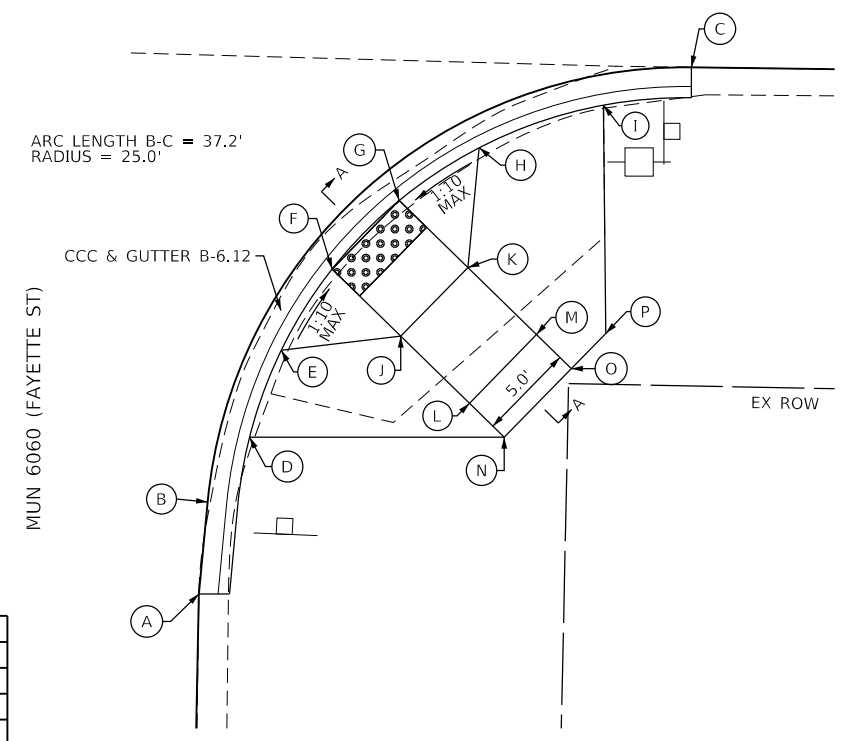

ARC LENGTH B-C = 37.2'
RADIUS = 25.0'

MUN 6060 (FAYETTE ST)

FAYETTE ST - SE CORNER			
	STATION	OFFSET	ELEVATION
A	68+88.85	47.02' RT	673.58
B	68+89.20	42.23' RT	673.61
C	69+13.94	19.06' RT	673.89
D	68+91.32	38.81' RT	674.08
E	68+92.88	34.24' RT	674.12
F	68+95.44	29.96' RT	673.71
G	68+98.86	26.31' RT	673.75
H	69+02.97	23.48' RT	674.24
I	69+09.40	21.13' RT	674.33
J	68+99.09	33.38' RT	674.09
K	69+02.51	29.73' RT	674.13
L	69+02.74	36.80' RT	674.17
M	69+06.15	33.15' RT	674.21
N	69+04.59	38.54' RT	674.23
O	69+08.01	34.89' RT	674.25
P	69+09.76	33.01' RT	674.24

SECTION A-A

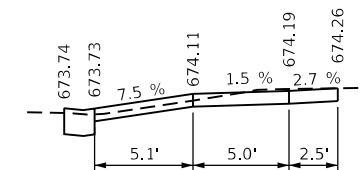

MODEL: Default
FILE: \\mhc-pw\illinois\paw\DOT\Documents\DOT_Offices\Illinois\Projects\067254\CADD\Drawings\067254-sht-15-sidewalk.dgn

USER NAME = coxte	DESIGNED -	REVISED -
	DRAWN -	REVISED -
PLOT SCALE = 10.0000' / in.	CHECKED -	REVISED -
PLOT DATE = 3/16/2018	DATE -	REVISED -

STATE OF ILLINOIS
DEPARTMENT OF TRANSPORTATION

ADA - SIDEWALK DETAILS

SCALE: SHEET OF SHEETS STA. TO STA.

F.A.P. RTE.	SECTION	COUNTY	TOTAL SHEETS	SHEET NO.
315	(28) RS-9, SW	HANCOCK	15	13
CONTRACT NO. 72J54				
ILLINOIS FED. AID PROJECT				

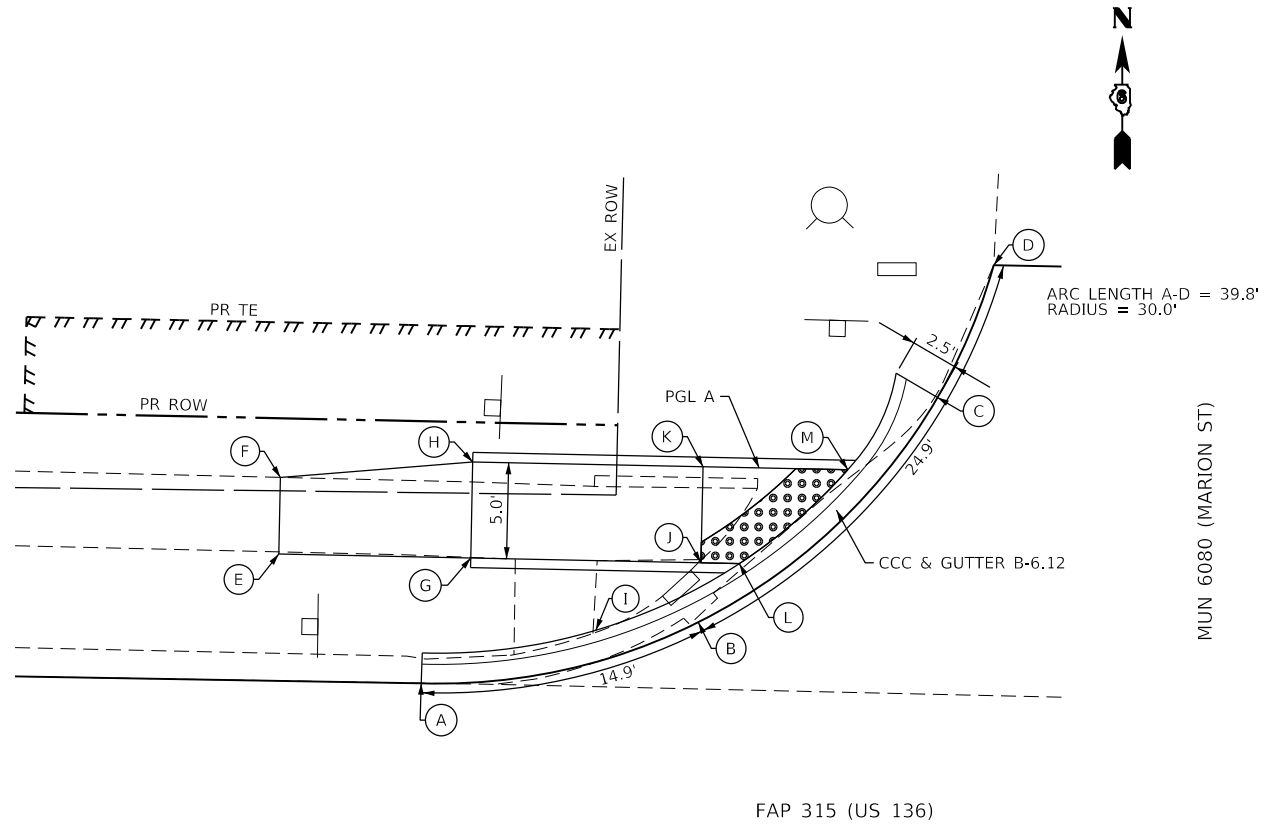

FAP 315 (US 136)

PROFILE A

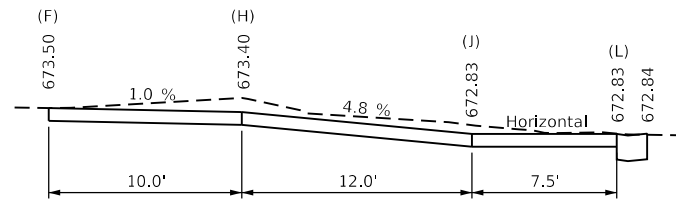

MARION ST - NW CORNER			
STATION	OFFSET	ELEVATION	
A	72+99.60	19.35' LT	672.78
B	73+13.96	22.82' LT	672.70
C	73+26.18	34.80' LT	672.91
D	73+28.97	41.74' LT	673.00
E	72+92.04	25.93' LT	673.40
F	72+92.04	29.93' LT	673.50
G	73+02.04	25.93' LT	673.33
H	73+02.04	30.93' LT	673.40
I	73+08.63	22.29' LT	673.17
J	73+14.04	25.93' LT	672.73
K	73+14.04	30.93' LT	672.83
L	73+16.04	25.93' LT	672.73
M	73+21.58	30.93' LT	672.83

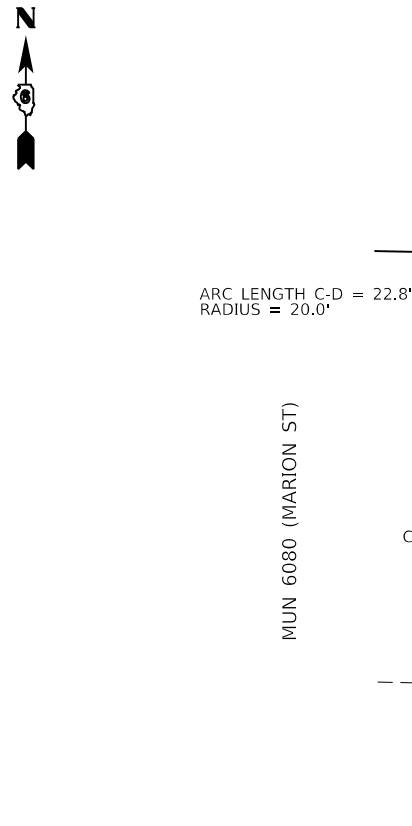

FAP 315 (US 136)

PROFILE A

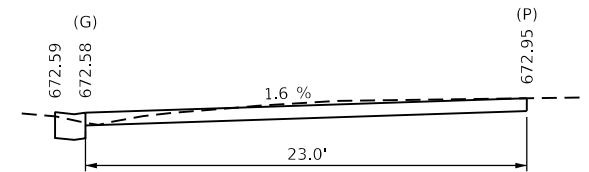

PROFILE B

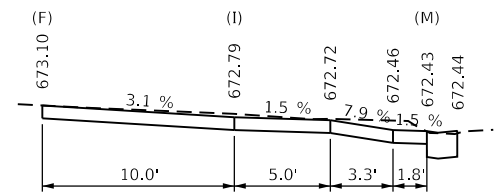

MARION ST - NE CORNER			
STATION	OFFSET	ELEVATION	
A	73+53.10	41.72' LT	672.70
B	73+55.88	36.11' LT	672.65
C	73+58.65	30.53' LT	672.59
D	73+77.07	19.25' LT	672.40
E	73+69.07	41.22' LT	673.03
F	73+73.07	41.22' LT	673.10
G	73+60.08	31.22' LT	672.58
H	73+69.07	31.22' LT	672.72
I	73+73.07	31.22' LT	672.79
J	73+63.63	26.22' LT	672.53
K	73+68.07	26.22' LT	672.64
L	73+68.07	22.95' LT	672.48
M	73+73.07	21.18' LT	672.43
N	73+73.07	27.22' LT	672.73
O	73+83.07	27.22' LT	672.84
P	73+83.07	31.22' LT	672.94

MUN 6080 (MARION ST)

MUN 6080 (MARION ST)

STATE OF ILLINOIS
DEPARTMENT OF TRANSPORTATION

ADA - SIDEWALK DETAILS

SCALE: SHEET OF SHEETS STA. TO STA.

F.A.P. RTE.	SECTION	COUNTY	TOTAL SHEETS	SHEET NO.
315	(28) RS-9, SW	HANCOCK	15	14
CONTRACT NO. 72J54				
ILLINOIS FED. AID PROJECT				

USER NAME = coxte	DESIGNED -	REVISED -
PLOT SCALE = 10.0000" / in.	DRAWN -	REVISED -
PLOT DATE = 3/15/2018	CHECKED -	REVISED -
	DATE -	REVISED -

FAP 315 (US 136)

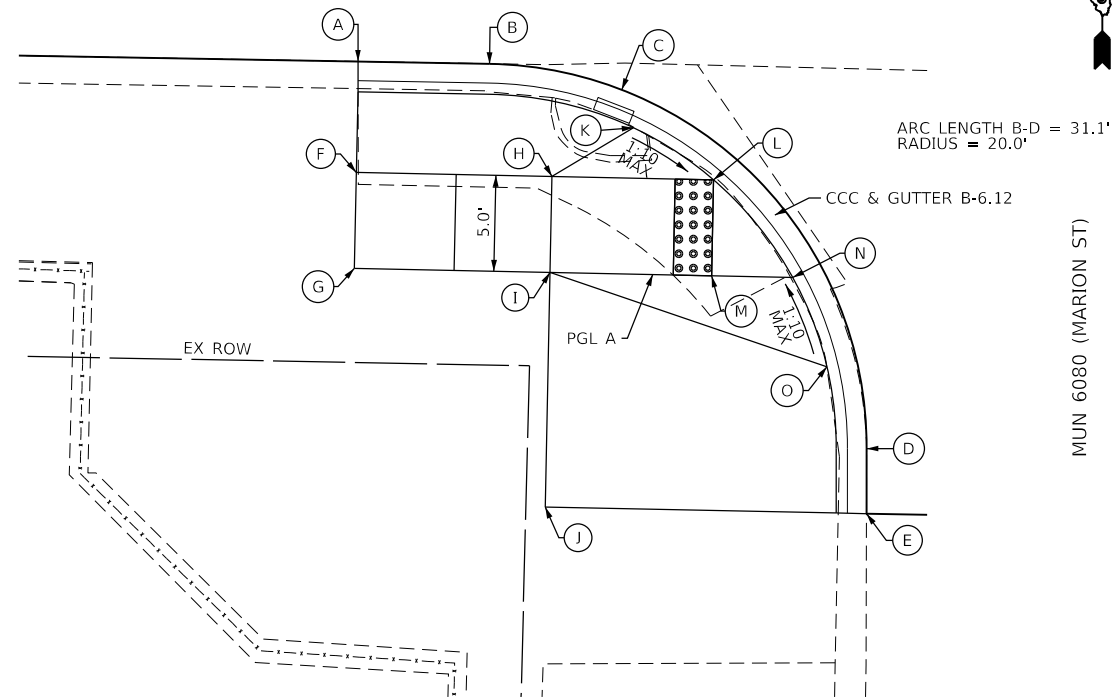

PROFILE A

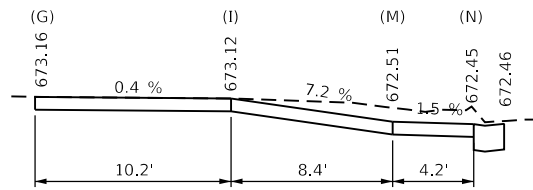

MARION ST - SW CORNER			
	STATION	OFFSET	ELEVATION
A	73+00.00	19.15' RT	672.72
B	73+06.82	19.13' RT	672.56
C	73+13.74	20.34' RT	672.40
D	73+26.88	38.76' RT	672.50
E	73+26.95	42.15' RT	672.51
F	73+00.00	24.93' RT	673.12
G	73+00.00	29.93' RT	673.16
H	73+10.20	24.93' RT	673.06
I	73+10.20	29.93' RT	673.12
J	73+10.20	42.15' RT	673.05
K	73+14.38	22.31' RT	672.85
L	73+18.62	24.93' RT	672.42
M	73+18.62	29.93' RT	672.51
N	73+22.84	29.93' RT	672.45
O	73+24.73	34.55' RT	672.92

FAP 315 (US 136)

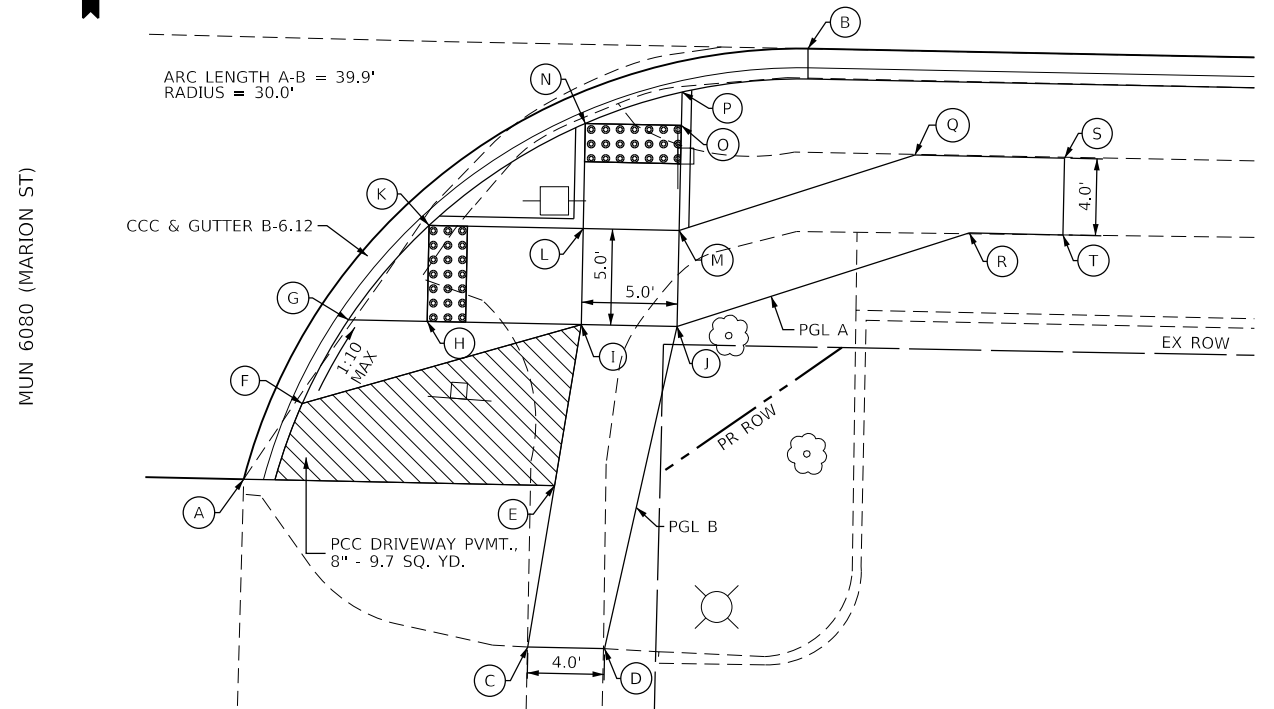

MARION ST - SE CORNER

MARION ST - SE CORNER			
	STATION	OFFSET	ELEVATION
A	73+53.51	42.15' RT	672.66
B	73+82.44	19.11' RT	672.34
C	73+68.49	50.58' RT	672.78
D	73+72.49	50.58' RT	672.71
E	73+69.71	42.15' RT	672.80
F	73+56.47	38.14' RT	673.06
G	73+58.80	33.73' RT	672.57
H	73+62.89	33.73' RT	672.59
I	73+70.92	33.73' RT	672.82
J	73+75.92	33.73' RT	672.90
K	73+62.89	28.73' RT	672.51
L	73+70.92	28.73' RT	672.79
M	73+75.92	28.73' RT	672.83
N	73+70.92	23.25' RT	672.43
O	73+75.92	23.25' RT	672.42
P	73+75.92	21.51' RT	672.39
Q	73+88.11	24.54' RT	673.10
R	73+91.04	28.54' RT	673.19
S	73+95.92	24.54' RT	673.26
T	73+95.92	28.54' RT	673.28

PROFILE A

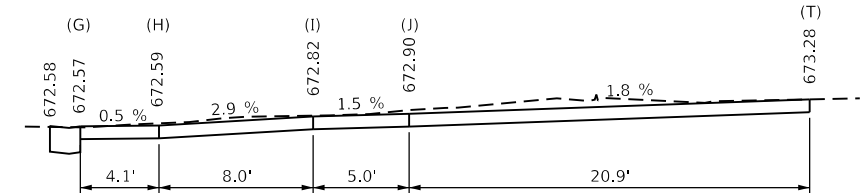

PROFILE B

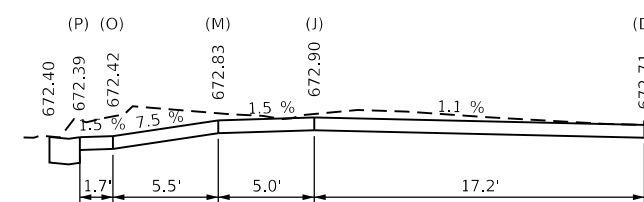

STATE OF ILLINOIS
DEPARTMENT OF TRANSPORTATION

ADA - SIDEWALK DETAILS

USER NAME = coxte	DESIGNED -	REVISED -
PLOT SCALE = 10.0000" / in.	DRAWN -	REVISED -
PLOT DATE = 3/15/2018	CHECKED -	REVISED -
	DATE -	REVISED -

SCALE: SHEET OF SHEETS STA. TO STA.

F.A.P. RTE. 315	SECTION (28) RS-9, SW	COUNTY HANCOCK	TOTAL SHEETS 15	SHEET NO. 15
ILLINOIS FED. AID PROJECT			CONTRACT NO. 72J54	

MODEL: Default
 FILE: \\mhc-pw\il08\B&E\DOT\Illinois\gov\PW\DOT\Documents\DOT - Offices\Director @ Projects\067254\CADD\Draws\CAD\Sheet\067254-swt-draws.dgn