

STATE OF ILLINOIS
DEPARTMENT OF TRANSPORTATION

F.A.P. RTE.	SECTION	COUNTY	TOTAL SHEETS	SHEET NO.
318	72(6-1)SR-1	PEORIA	10	1
		ILLINOIS	CONTRACT NO. 68E15	

INDEX OF SHEETS

- 1 COVER SHEET
- 2 GENERAL NOTES / COMMITMENTS / PROJECT SPECIFIC NOTES
- 3 SUMMARY OF QUANTITIES
- 4-6 LINE DIAGRAM
- 7-8 TYPICAL SECTIONS
- 9 SCHEDULE OF QUANTITIES
- 10 DISTRICT STANDARDS

HIGHWAY STANDARDS:

- 701101-05
- 701400-09
- 701406-11
- 701411-09
- 701428-01
- 701901-07

DISTRICT STANDARDS:

440001

IL 6: FREEWAY
ADT = 13,300 (2015)
SU = 3.57% (2015)
MU = 3.38% (2015)

IL 6 STA. EQUATION:
853 + 26.62(BK)
852 + 72.23(AH)

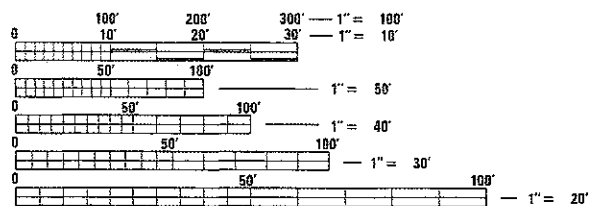

FULL SIZE PLANS HAVE BEEN PREPARED USING STANDARD ENGINEERING SCALES. REDUCED SIZED PLANS WILL NOT CONFORM TO STANDARD SCALES. IN MAKING MEASUREMENTS ON REDUCED PLANS, THE ABOVE SCALES MAY BE USED.

J.U.L.I.E.
JOINT UTILITY LOCATION INFORMATION FOR EXCAVATION
1-800-892-0123
OR 811

PROJECT ENGINEER: MIKE LEWIS 309-671-3454
PROJECT MANAGER: COREY TAVENNER
CATALOG NO. 035593-00D
CONTRACT NO. 68E15

PROPOSED
HIGHWAY PLANS

FAP ROUTE 318 (IL 6)
SECTION 72(6-1)SR-1
TYPE of IMPROVEMENT: CONTRACT MAINTENANCE
PEORIA COUNTY

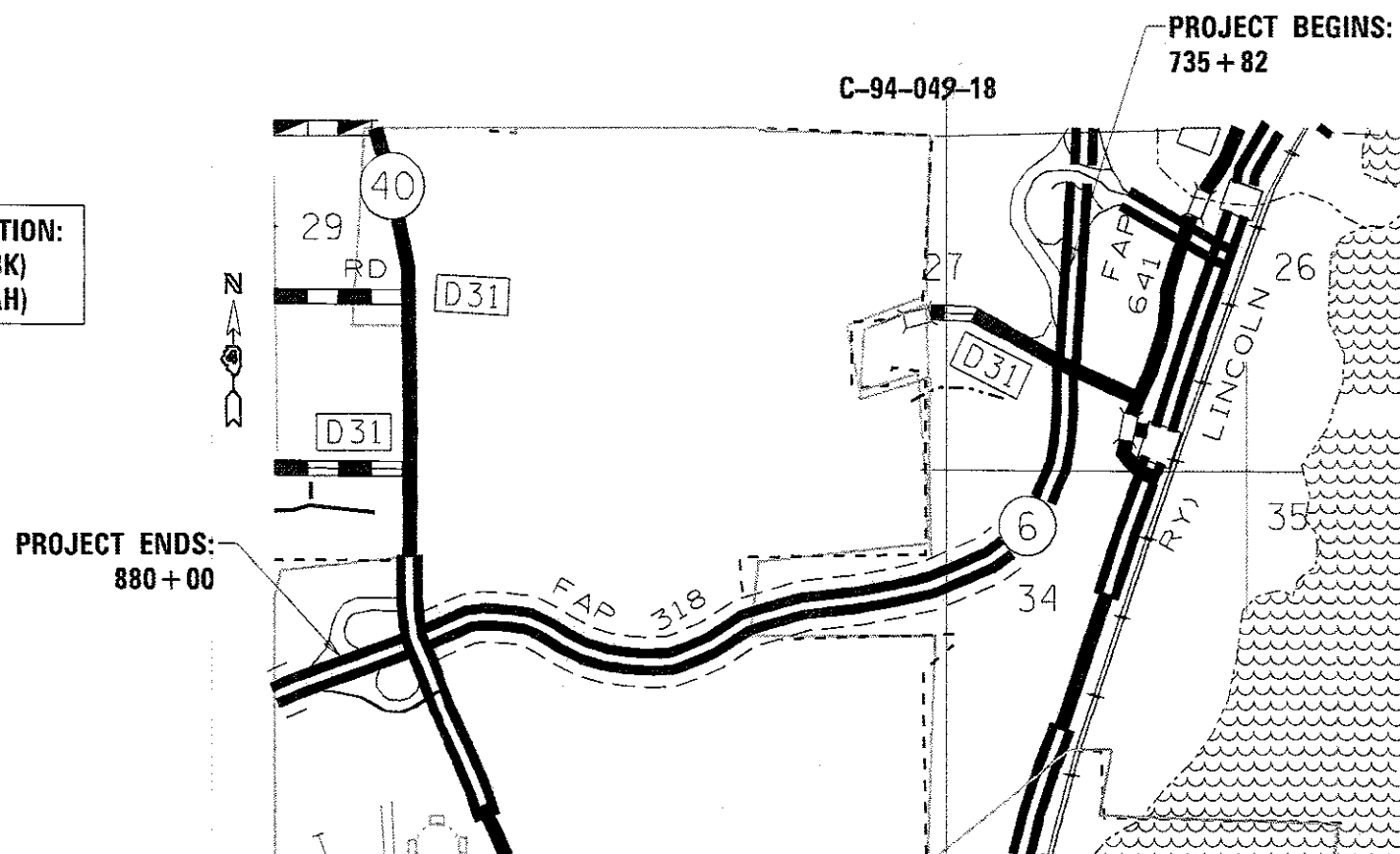

GROSS LENGTH = 14,418 FT. = 2.7307 MILE
NET LENGTH = 14,472.39 FT. = 2.741 MILE

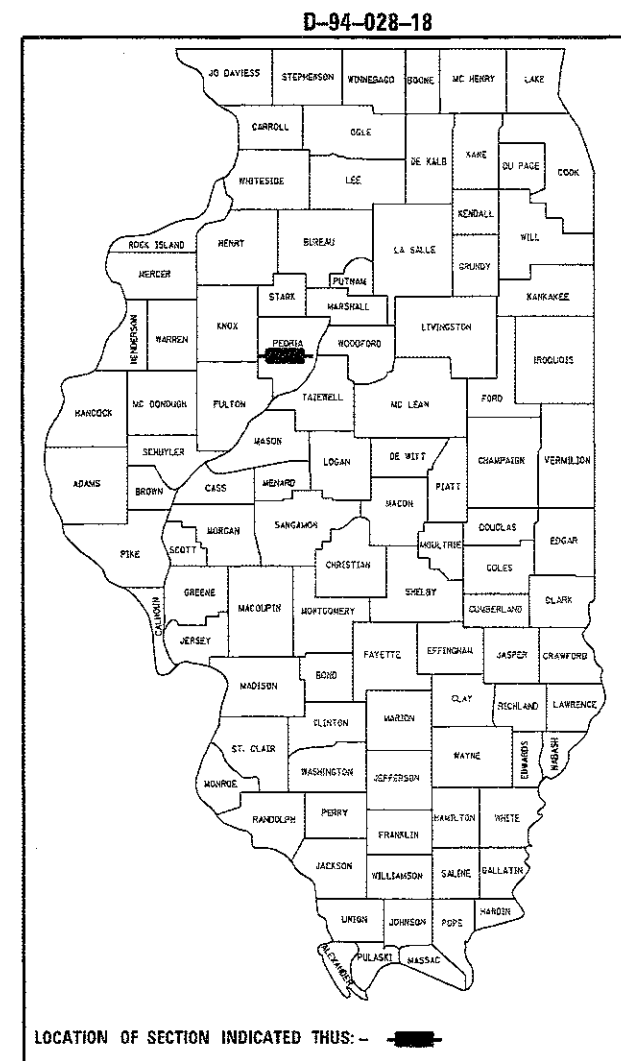

PROJECT DESCRIPTION:
SHOULDER RESTORATION
ALONG IL 6 FROM IL 40 (KNOXVILLE AVE) TO
IL 29 IN PEORIA

STATE OF ILLINOIS
DEPARTMENT OF TRANSPORTATION

SUBMITTED Mar 22 2018
Rensel A Barnett (KSD)
REGIONAL ENGINEER

May 11 2018
EA ETK
ENGINEER OF DESIGN AND ENVIRONMENT

May 21 2018
Paul P. [Signature]
DIRECTOR OF HIGHWAYS PROJECT IMPLEMENTATION

PRINTED BY THE AUTHORITY
OF THE STATE OF ILLINOIS

COMMITMENTS

Commitments are not to be altered without the written approval of all parties to which the commitment was made.

No Commitments have been made for this project.

ENVIRONMENTAL REVIEWS

Prior to the use of any proposed borrow areas, use areas (temporary access roads, detours, run-arounds, etc.) and/or waste areas, the Contractor shall file the required environmental resource request surveys according to Section 107.22 of the Standard Specifications. These surveys are required in order for the Department to conduct cultural and biological resource surveys for the proposed site.

Prior to any waste materials being removed from the construction site the required environmental resource surveys will need to be obtained and filed by the Contractor. Excess waste products removed from the construction site shall be disposed of as required in Section 202.03 of the Standard Specifications.

Any protruding metal bars shall be removed prior to the disposal of broken concrete at approved disposal sites.

The required environmental resource documentation shall include the following:

- * BDE Form 2289 (Environmental Survey Request)
- * A location map showing the size limits and location of the use area
- * Signed property owner agreement form-D4 PI0100
- * Color photographs depicting the use area
- * Borrow Area Entry Agreement form-D4 PI0101

Please note that a minimum of two weeks shall be allowed for the District to obtain the required environmental clearances.

HOT-MIX ASPHALT MIXTURE REQUIREMENTS:

Mixture Use(s):	Shoulders
AC/PG:	PG 64-22
Design Air Voids:	4.0% @ N=50
Mixture Composition: (Mixture Gradation)	IL 9.5
Friction Aggregate:	Mix C
Quality Management Program:	QC QA

Note: 1) Individual lift thickness of each mix type will be no less than 3 times nominal maximum aggregate size and no more than 6 times nominal maximum aggregate size, unless otherwise approved by the Engineer.

2) For design purposes, mixture weight for all mixes is determined to be 112.0 lb/s.y/in., unless otherwise noted.

PROJECT SPECIFIC NOTES

- In addition to priming the milled shoulders; the vertical face at the edge of pavement and the vertical face of the edge of the remaining shoulder shall be thoroughly tacked (primed) by means of dedicated spray nozzle, mounted at 45 degree, aimed toward the faces. The extra HMA prime coat shall be paid for at the contract unit price per POUND for "POLYMERIZED BITUMINOUS MATERIALS (TACK COAT)"
- Due to the poor condition of the existing inside shoulders; it shall be milled and filled prior to starting work on the outside shoulders
- All milled areas will be paved same day and no drop-offs will be permitted overnight
- Only one lane shall be permitted to be closed in a given direction at a time

MODEL: Default
 FILE NAME: \\s0104618\BID\INTEG-illinois.pwr\FWDDT\Documents\DOT-Office\District 4\Project\04_68E15\CADD\Drawings\04-xxxx-CADD.dgn

USER NAME = everscl	DESIGNED -	REVISED -
	DRAWN -	REVISED -
PLOT SCALE = 400.0000' / in.	CHECKED -	REVISED -
PLOT DATE = 3/23/2018	DATE -	REVISED -

**STATE OF ILLINOIS
DEPARTMENT OF TRANSPORTATION**

**GENERAL NOTES COMMENTS
AND PROJECT SPECIFIC NOTES**

SCALE: SHEET 2 OF 10 SHEETS STA. TO STA.

F.A. RTE. 318	SECTION 7216-1/SR1	COUNTY PEORIA	TOTAL SHEETS 10	SHEET NO. 2
CONTRACT NO. 68E15			ILLINOIS FED. AID PROJECT	

CONST. CODE	
URBAN	
IL 6	
PEORIA COUNTY	
100% STATE	
0005	

CODE NO.	ITEM	UNIT	TOTAL QUANTITY	
40600295	POLYMERIZED BITUMINOUS MATERIALS (TACK COAT)	POUND	22375	22375
44000161	HOT - MIX ASPHALT SURFACE REMOVAL, 3"	SO YD	21755	21755
48203100	HOT - MIX ASPHALT SHOULDERS	TON	3655	3655
67100100	MOBILIZATION	L SUM	1	1
70100420	TRAFFIC CONTROL AND PROTECTION, STANDARD 701411	EACH	5	5
70100700	TRAFFIC CONTROL AND PROTECTION, STANDARD 701406	L SUM	1	1
* 78001110	PAINT PAVEMENT MARKING - LINE 4"	FOOT	55917	55917
X7010410	SPEED DISPLAY TRAILER	CAL MO	0.5	0.5
X7015005	CHANGEABLE MESSAGE SIGN	CAL DA	14	14

* SPECIALTY ITEM

MODEL: Default
FILE NAME: p:\11084818\INTEC\Illinois.gov\MDOT\Documents\DOT_Offices\District 4\Projects\04_SBEIS\CAD\04_SBEIS\CAD\Drawings\04_SBEIS\CAD\00.dgn

USER NAME = everscl
PLOT SCALE = 400.0000' / in.
PLOT DATE = 3/23/2018

DESIGNED -	REVISED -
DRAWN -	REVISED -
CHECKED -	REVISED -
DATE -	REVISED -

STATE OF ILLINOIS
DEPARTMENT OF TRANSPORTATION

SUMMARY OF QUANTITIES

F.A. RTE.	SECTION	COUNTY	TOTAL SHEETS	SHEET NO.
318	7216-11SR1	PEORIA	10	3
CONTRACT NO. 68E15			ILLINOIS FED. AID PROJECT	

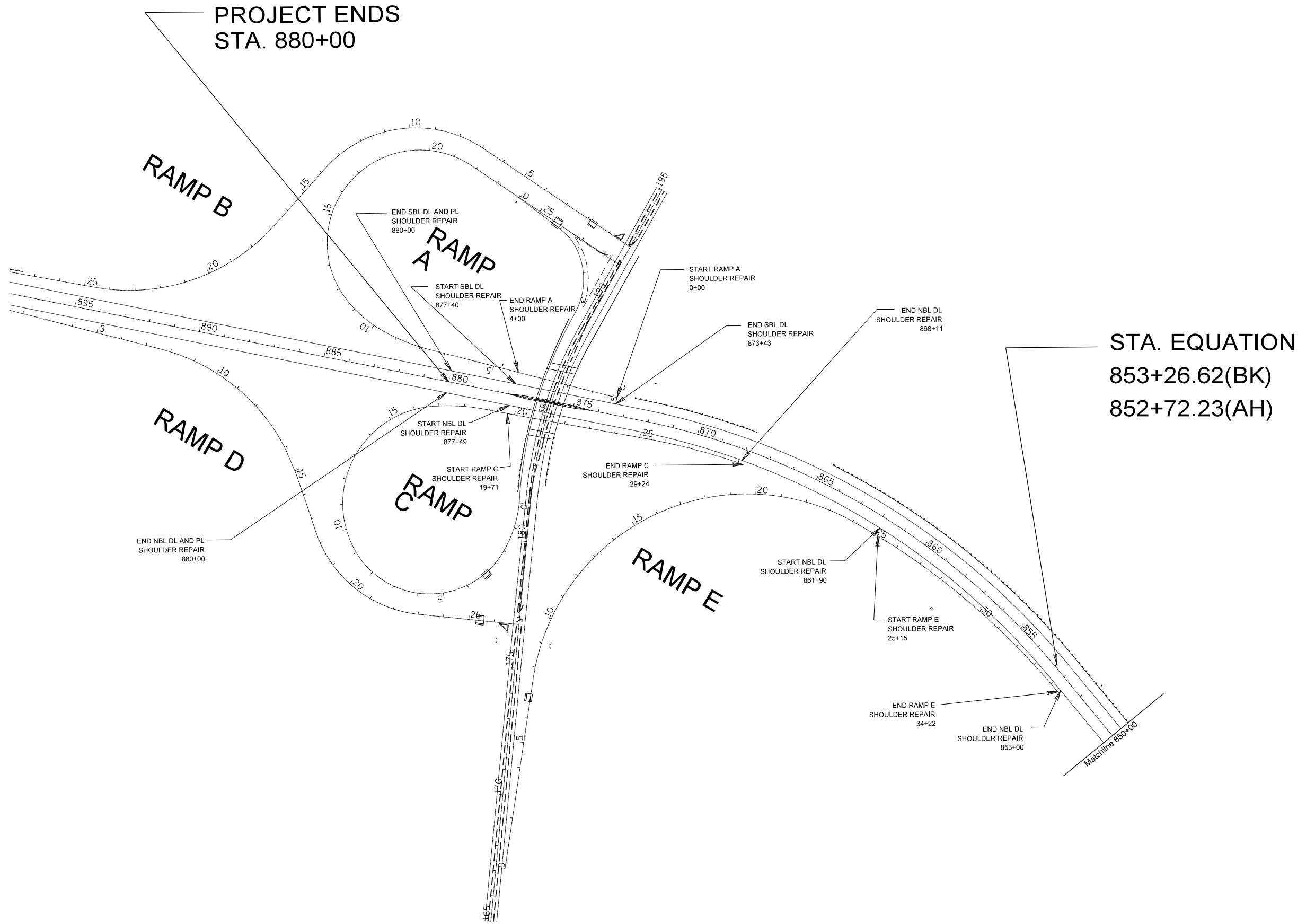
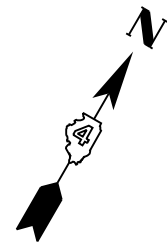

L 40
Interchange

MODEL: Default
 FILE: \\nas01c.psu.edu\B&E\ID\NTEC\Illinois\gov\PIV\DOT\Documents\1\DOT\Office\ID\Interch_4\Projects\I04_68E15\CADD\Draw\CAD\Drawings\ID\xxxx-CADD.dgn

USER NAME = eversct	DESIGNED -	REVISED -
	DRAWN -	REVISED -
PLOT SCALE = 400,0000' / in.	CHECKED -	REVISED -
PLOT DATE = 3/23/2018	DATE -	REVISED -

STATE OF ILLINOIS
DEPARTMENT OF TRANSPORTATION

LINE DIAGRAM

SCALE: SHEET OF SHEETS STA. TO STA.

F.A. RTE.	SECTION	COUNTY	TOTAL SHEETS	SHEET NO.
318	7216-1/SR1	PEORIA	10	4
CONTRACT NO. 68E15				
ILLINOIS FED. AID PROJECT				

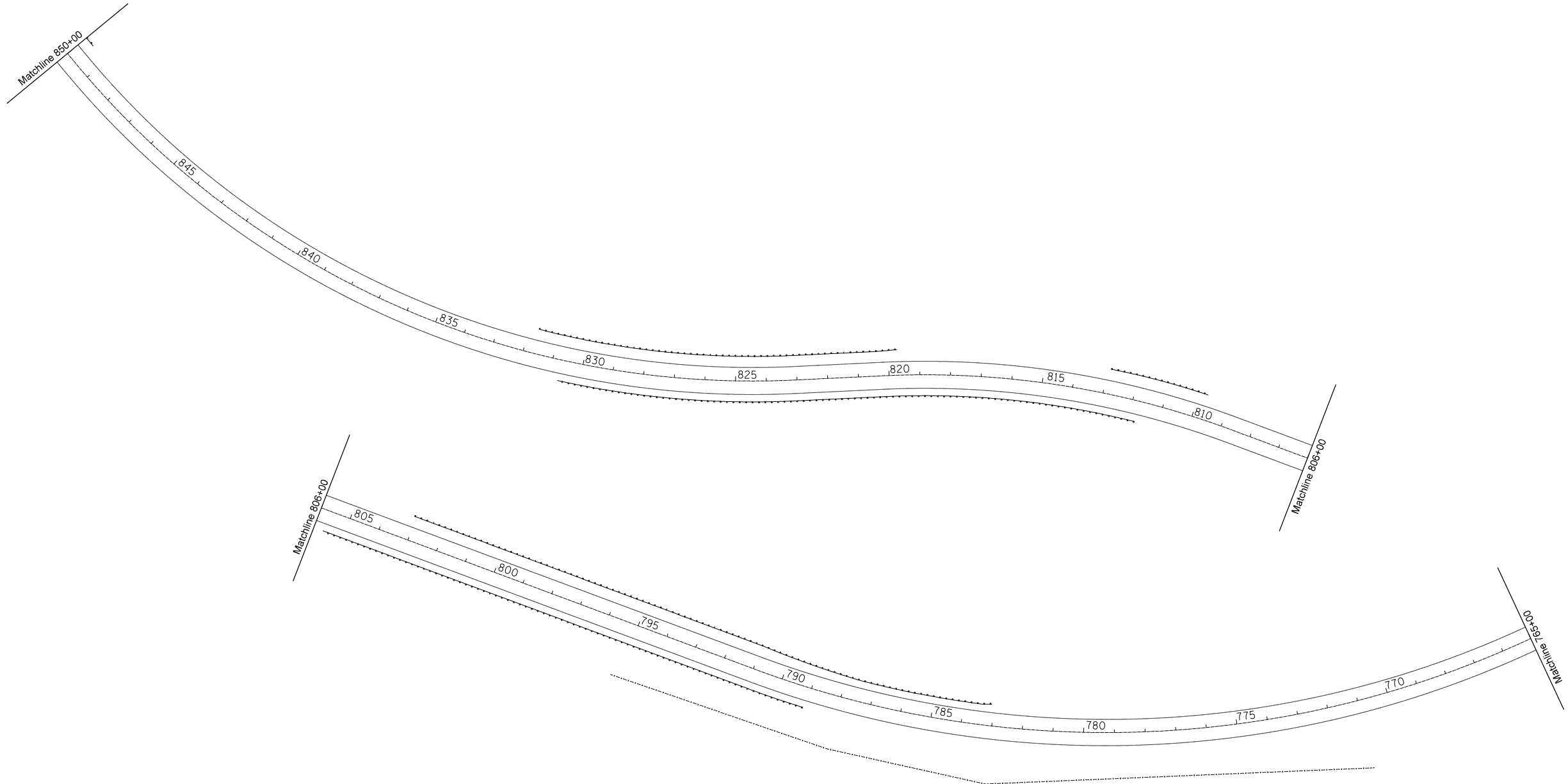
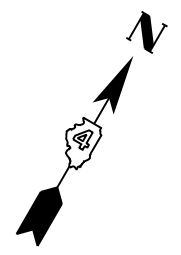

MODEL: Default
 FILE: \\nas01.cpe.uiuc.edu\BEBID\NTEC\Illinois\gov\PIV\DOT\Documents\1\DOT_Offices\Director\Projects\04_68E15\CADD\Draw\CD\Drawings\3D\axxxx-CADD.dgn

USER NAME = eversct	DESIGNED -	REVISED -
	DRAWN -	REVISED -
PLOT SCALE = 400,0000 ' / in.	CHECKED -	REVISED -
PLOT DATE = 3/23/2018	DATE -	REVISED -

**STATE OF ILLINOIS
DEPARTMENT OF TRANSPORTATION**

LINE DIAGRAM

SCALE: SHEET OF SHEETS STA. TO STA.

F.A. RTE.	SECTION	COUNTY	TOTAL SHEETS	SHEET NO.
318	7216-1/SR1	PEORIA	10	5
CONTRACT NO. 68E15				
ILLINOIS FED. AID PROJECT				



Project Begins
735+82

START SBL PL
SHOULDER REPAIR
735+82

RAMP D

RAMP B

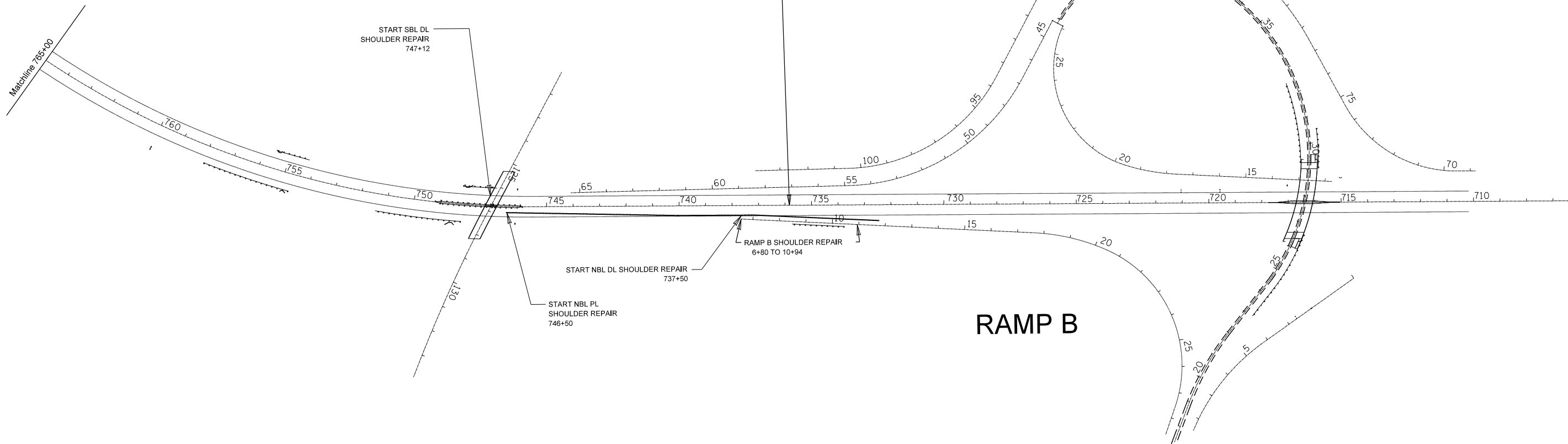

START SBL DL
SHOULDER REPAIR
747+12

START NBL DL
SHOULDER REPAIR
737+50

START NBL PL
SHOULDER REPAIR
746+50

RAMP B SHOULDER REPAIR
6+80 TO 10+94

L 29
Interchange

MODEL: Default
FILE: \\nas01c.pva\illinois\B&E\BID\NTEC\Illinois\gov\PIV\DOT\Documents\1\DOT_Offices\DI\Interch_29\Projects\04_68E15\CADD\Draws\CADrawings\DI\xxxx-CADD.dgn

USER NAME = eversct	DESIGNED -	REVISED -
	DRAWN -	REVISED -
PLOT SCALE = 400,0000' / in.	CHECKED -	REVISED -
PLOT DATE = 3/23/2018	DATE -	REVISED -

STATE OF ILLINOIS
DEPARTMENT OF TRANSPORTATION

LINE DIAGRAM

SCALE: SHEET OF SHEETS STA. TO STA.

F.A. RTE.	SECTION	COUNTY	TOTAL SHEETS	SHEET NO.
318	7216-1/SR1	PEORIA	10	6
CONTRACT NO. 68E15				
ILLINOIS FED. AID PROJECT				

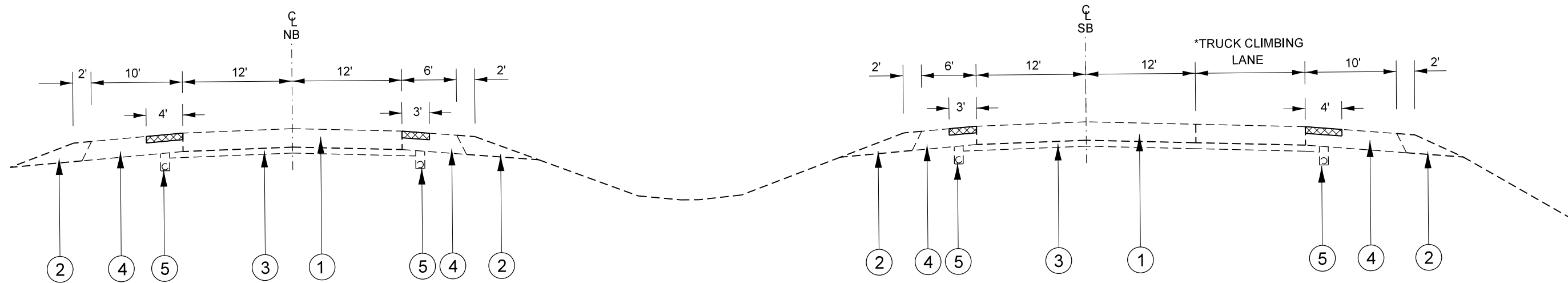

IL 6

STA. 880+00 TO STA. 735+82 (SB)
 STA. 880+00 TO STA. 737+50 (NB)

- ① EXISTING CONTINUOUSLY REINFORCED PCC PAVEMENT, 10 1/2" (7/8" LONGITUDINAL BARS)
- ② EXISTING AGGREGATE SHOULDER
- ③ EXISTING STABILIZED SUB-BASE, 4"
- ④ EXISTING HMA SHOULDER
- ⑤ EXISTING SUB-SURFACE DRAINS

PROPOSED HMA SURFACE REMOVAL 3" / PROPOSED HMA SHOULDER

* TRUCK CLIMBING LANE
 12' - STA 788+00 TO 910+00 (SB)

NOT TO SCALE

MODEL: Default
 FILE: \\nrcs-prod\illinois\B&E\BID\ITC\Illinois\gov\PIWDOT\Documents\13DOT\Office\BID\ITC\13DOT\Projects\04_68E15\CADD\Drawings\Drawings\Drawings\CADD.dgn

USER NAME = eversct	DESIGNED -	REVISED -
	DRAWN -	REVISED -
PLOT SCALE = 400,0000 ' / in.	CHECKED -	REVISED -
PLOT DATE = 3/23/2018	DATE -	REVISED -

**STATE OF ILLINOIS
 DEPARTMENT OF TRANSPORTATION**

TYPICAL SECTION

SCALE: SHEET OF SHEETS STA. TO STA.

F.A. RTE.	SECTION	COUNTY	TOTAL SHEETS	SHEET NO.
318	7216-1/5R1	PEORIA	10	7
ILLINOIS FED. AID PROJECT			CONTRACT NO. 68E15	

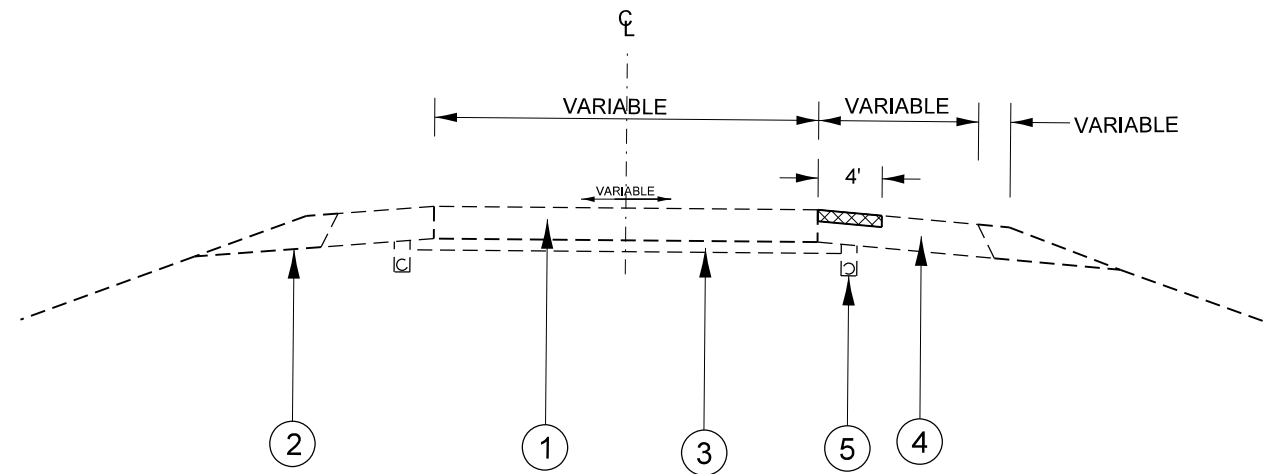

RAMP A
RAMP B
RAMP C
RAMP E

- ① EXISTING CONTINUOUSLY REINFORCED
PCC PAVEMENT, 10 1/2" (7/8" LONGITUDINAL BARS)
- ② EXISTING AGGREGATE SHOULDER
- ③ EXISTING STABILIZED SUB-BASE, 4"
- ④ EXISTING HMA SHOULDER
- ⑤ EXISTING SUB-SURFACE DRAINS

 PROPOSED HMA SURFACE REMOVAL 3"/ PROPOSED HMA SHOULDER

NOT TO SCALE

MODEL: Default
FILE: \\nas101.psu.edu\BIBED\NTEC\Illinois.gov\PIV\DOT\Documents\DOT_Offices\Illinet\1\Projects\104_68E15\CADD\Drawings\CADDrawing\3Dxxxx-CADD.dgn

USER NAME = eversct	DESIGNED -	REVISED -
	DRAWN -	REVISED -
PLOT SCALE = 400.0000 ' / in.	CHECKED -	REVISED -
PLOT DATE = 3/23/2018	DATE -	REVISED -

STATE OF ILLINOIS
DEPARTMENT OF TRANSPORTATION

TYPICAL RAMP SECTION

SCALE: SHEET OF SHEETS STA. TO STA.

F.A. RTE.	SECTION	COUNTY	TOTAL SHEETS	SHEET NO.
318	7216-11SR1	PEORIA	10	8
CONTRACT NO. 68E15				
ILLINOIS FED. AID PROJECT				

RESURFACING - SHOULDER															
	LOCATION			LENGTH	REMOVAL WIDTH		AREA		HOT-MIX ASPHALT SURFACE REMOVAL		HOT-MIX ASPHALT SHOULDERS 3"		POLYMERIZED BITUMINOUS MATERIALS (TACK COAT RATE USED IS 0.1 LB/SQ FT)		
					LT	RT	LT	RT	LT	RT	LT	RT	LT	RT	
	STA.	TO	STA.	FT	FT		SQ YD	SQ YD	SQ YD	SQ YD	TON	TON	LB	LB	
NORTH BOUND LANE	PASSING LANE SHOULDER														
	746+50	TO	853+26	10,676	3'	0	3558.67		3558.67		597.86		3736.6		
	STA. EQUATION STA. 853+26.62(BK) = 852+72.23(AH)														
	852+72	TO	880+00	2,728	3'	0	909.33		909.33		152.77		954.8		
	DRIVING LANE SHOULDER														
	737+50	TO	853+00	11,550	0	4'		5133.33		5133.33		862.4		5197.5	
	861+90	TO	868+11	621	0	4'		276.00		276.00		46.37		279.45	
877+49	TO	880+00	251	0	4'		111.56		111.56		18.74		112.95		
SOUTH BOUND LANE	PASSING LANE SHOULDER														
	735+82	TO	853+26	11,744	3'	0	3914.67		3914.67		657.66		4110.4		
	STA. EQUATION STA. 853+26.62(BK) = 852+72.23(AH)														
	852+72	TO	880+00	2,728	3'	0	909.33		909.33		152.77		954.8		
	DRIVING LANE SHOULDER														
	747+12	TO	853+26	10614	0	4'		4717.33		4717.33		792.51		4776.3	
	STA. EQUATION STA. 853+26.62(BK) = 852+72.23(AH)														
	852+72	TO	873+43	2,071	0	4'		920.44		920.44		154.63		931.95	
	877+40	TO	880+00	260	0	4'		115.56		115.56		19.41		117	
		RAMP E													
25+15		TO	34+22	907	0	4'		403.11		403.11		67.72		408.15	
RAMP B															
6+80		TO	10+94	414	0	4'		184.00		184.00		30.91		186.3	
RAMP A															
0+00		TO	4+00	400	0	4'		177.78		177.78		29.87		180	
RAMP C															
19+71	TO	29+24	953	0	4'		423.56		423.56		71.16		428.85		
RAMP D															
SUB-TOTAL									9292	12462.67	1561.06	2093.72	9756.6	12618.45	
TOTAL									21755		3655		22375		

PAINT PAVEMENT MARKING							
	LOCATION			LENGTH	LT EDGE LINE	RT EDGE LINE	
					4" SOLID	4" SOLID	
	STA.	TO	STA.	FT	YELLOW	WHITE	
NORTH BOUND LANE	PASSING LANE SHOULDER						
	746+50	TO	853+26	10,676	10,676		
	STA. EQUATION STA. 853+26.62 = 852+72.23						
	852+72	TO	880+00	2,728	2,728		
	DRIVING LANE SHOULDER						
	737+50	TO	853+00	11,550		11,550	
	861+90	TO	868+11	621		621	
877+49	TO	880+00	251		251		
SOUTH BOUND LANE	PASSING LANE SHOULDER						
	735+82	TO	853+26	11,744	11744		
	STA. EQUATION STA. 853+26.62 = 852+72.23						
	852+72	TO	880+00	2,728	2728		
	DRIVING LANE SHOULDER						
	747+12	TO	853+26	10,614		10,614	
	STA. EQUATION STA. 853+26.62 = 852+72.23						
	852+72	TO	873+43	2,071		2071	
	877+40	TO	880+00	260		260	
	RAMP E						
25+15	TO	34+22	907		907		
RAMP B							
6+80	TO	10+94	414		414		
RAMP A							
0+00	TO	4+00	400		400		
RAMP C							
19+71	TO	29+24	953		953		
RAMP D							
RAMP D							
TOTAL					27,876	28,041	

LOCATION	SPEED DISPLAY TRAILER
JOB SITE	0.5
TOTAL	
	0.5

LOCATION	TRAFFIC CONTROL AND PROTECTION, STANDARD 701406
JOB SITE	1
TOTAL	
	1

LOCATION	MOBILIZATION
JOB SITE	1
TOTAL	
	1

LOCATION	CHANGEABLE MESSAGE SIGN
JOB SITE (2 signs at 7 days)	14
TOTAL	
	14

LOCATION	TRAFFIC CONTROL AND PROTECTION, STANDARD 701411
JOB SITE	5
TOTAL	
	5

MODEL: Default
FILE: \\bls01\B&B\IDN\TEC\Illinois\gov\pww\DOT\Documents\1507 - Office\218127.ctb
PROJECT: D:\68E15\CADD\881\CAD\Drawings\881Dxxx-CADD.dgn

USER NAME = eversct	DESIGNED -	REVISED -
	DRAWN -	REVISED -
PLOT SCALE = 400,0000 ' / in.	CHECKED -	REVISED -
PLOT DATE = 3/23/2018	DATE -	REVISED -

**STATE OF ILLINOIS
DEPARTMENT OF TRANSPORTATION**

SCALE: SHEET OF SHEETS STA. TO STA.

F.A. RTE.	SECTION	COUNTY	TOTAL SHEETS	SHEET NO.
318	7216-1/SR1	PEORIA	10	9
CONTRACT NO. 68E15				
			ILLINOIS	FED. AID PROJECT

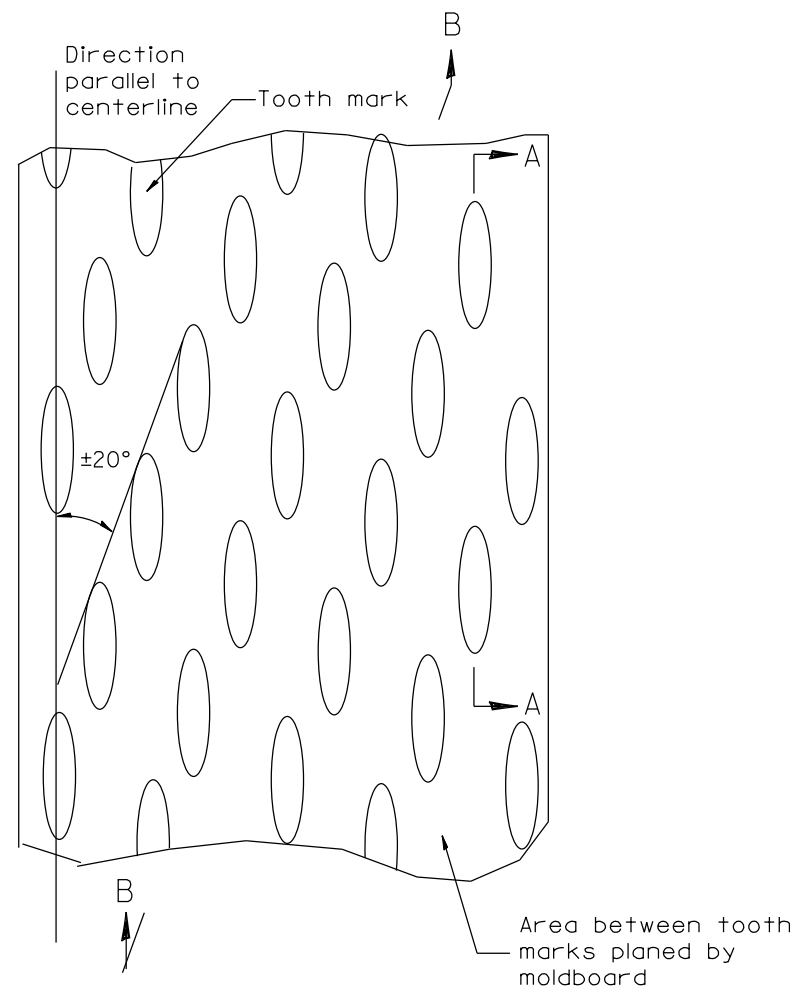

PLAN

General notes:

1. Coldmilling shall consist of two processes: Cutting with carbide teeth mounted on a rotating drum, and planing with a moldboard mounted immediately behind the cutting drum.
2. Other similar patterns will be acceptable if they consist of a smooth, flat, planed surface interspersed with a pattern of discontinuous longitudinal striations.

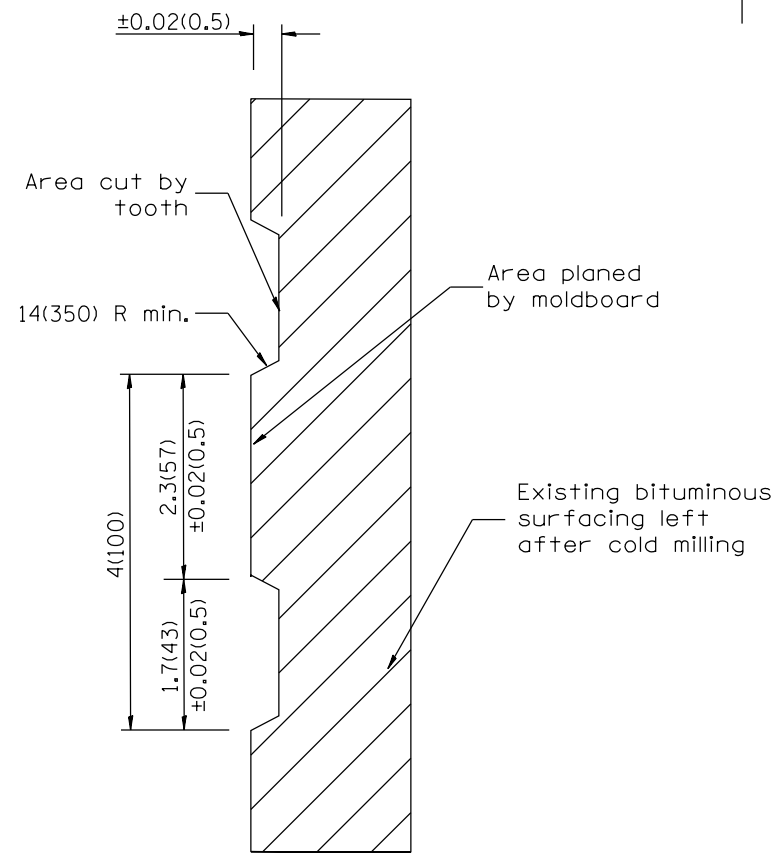

SECTION A-A

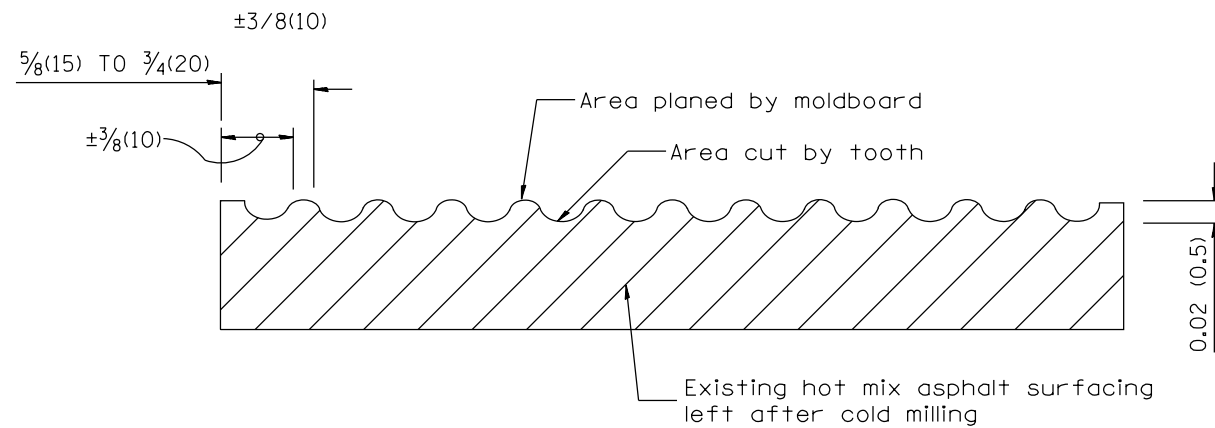

SECTION B-B PROJECTED PERPENDICULAR TO CENTERLINE

DESIGNER NOTES:
1. INCLUDE DISTRICT SPECIAL PROVISION, IF APPLICABLE.

All dimensions are in inches (millimeters) unless otherwise noted.

01-01-97	RENUM. C-104.01, NEW REVISION BOX	T.P.
04-20-98	REMOVED MILLING DETAIL FROM STANDARD	J.A.
09-08-98	CORRECT NOTE LEADER PLACEMENT	R.W.
10-16-06	REVISED TO 2007 SPEC.	M.A.

STATE OF ILLINOIS
DEPARTMENT OF TRANSPORTATION

HOT MIX ASPHALT SURFACE REMOVAL (COLD MILLING)

NOT TO SCALE

CADD STD. 440001-D4

F.A. RTE.	SECTION	COUNTY	TOTAL SHEETS	SHEET NO.
318	7216-1/SR1	PEORIA	10	10
FED. ROAD DIST. NO. ILLINOIS FED. AID PROJECT			CONTRACT NO. 68E15	