

STATE OF ILLINOIS
DEPARTMENT OF TRANSPORTATION

F.A.P. RTE.	SECTION	COUNTY	TOTAL SHEETS	SHEET NO.
331	D9 CRACK SEAL 2018-3	JAC/WIL	7	1
		ILLINOIS	CONTRACT NO. 78644	
JACKSON/WILLIAMSON				

FOR INDEX OF SHEETS, SEE SHEET NO. 3
FOR SUMMARY OF QUANTITIES, SEE SHEET NO. 5

**PROPOSED
HIGHWAY PLANS**

FAP 331 (IL 13)
SECTION D9 CRACK SEAL 2018-3

CENTERLINE CRACK SEAL
JACKSON/WILLIAMSON COUNTY

C-99-061-18

TRAFFIC DATA

FOR TRAFFIC DATA SEE SHEET NO. 3

TOWNSHIPS

CARTERVILLE, CARBONDALE

OMISSION:
141+00 (GIANT CITY RD.)
TO 223+50 (REED STATION RD.)

PROJECT BEGINS
EB 185+23.60
WB 99+00.00

PROJECT ENDS
EB 410+46.00
WB 411+02.45

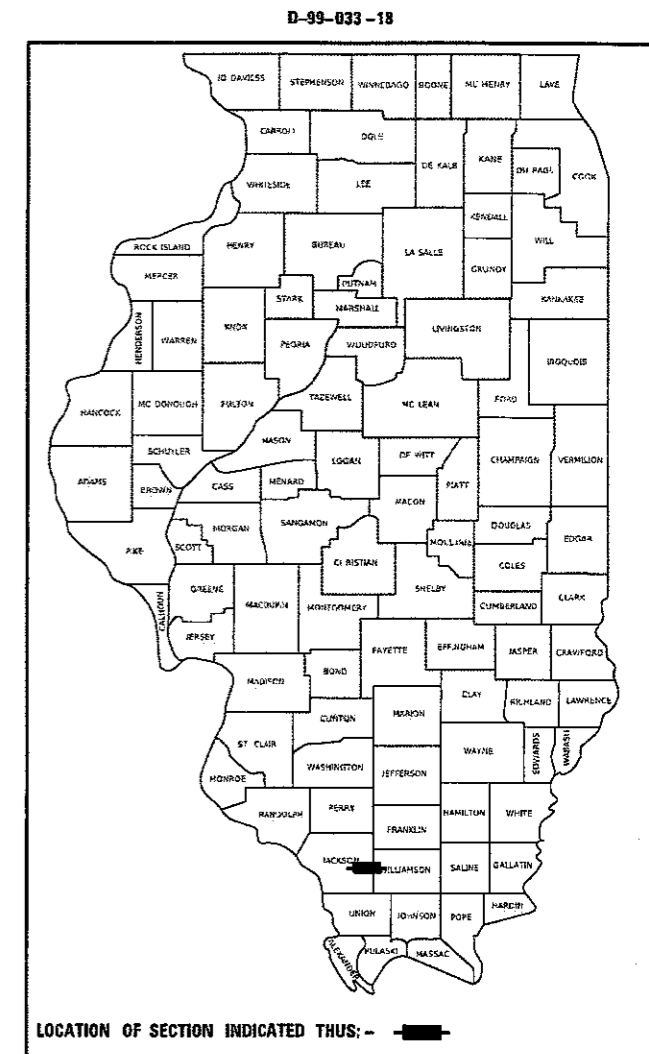
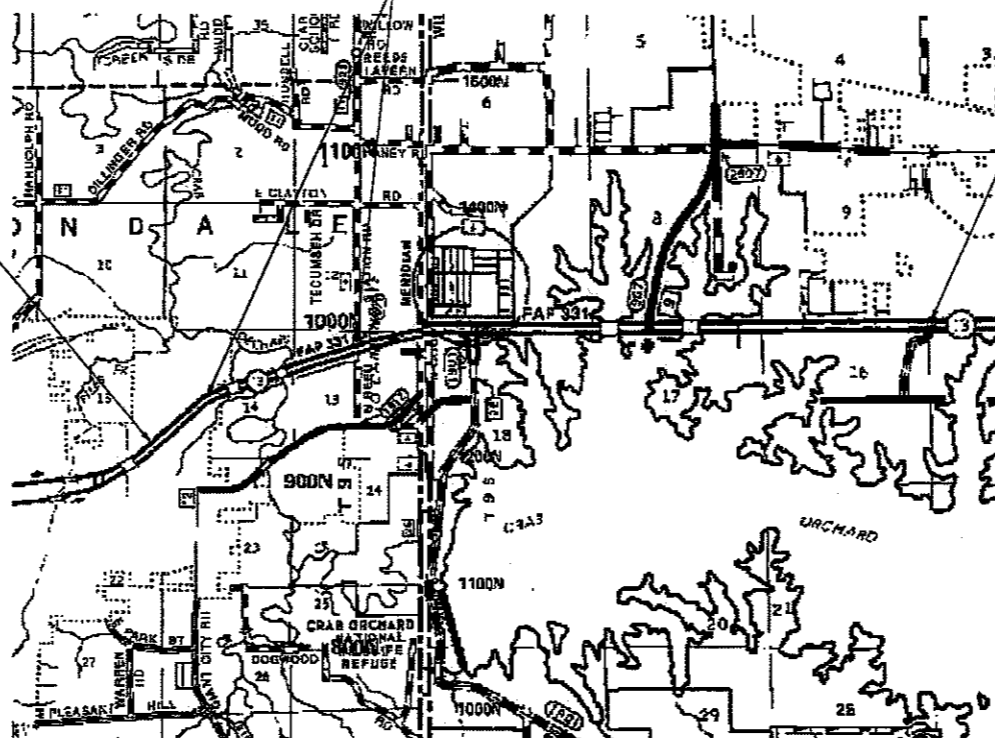

LOCATION OF SECTION INDICATED THUS: - [black rectangle] -

DESIGN DESIGNATION : N/A
COORDINATE SYSTEM : N/A
POSTED SPEED : 55 MPH

J.U.L.I.E.
JOINT UTILITY LOCATION INFORMATION FOR EXCAVATION
1-800-892-0123
OR 811

PROJECT ENGINEER: CHARLES STEIN
PROJECT DESIGNER: BEN DUGAS

CONTRACT NO. 78644

GROSS LENGTH = 31409.62 FT. = 5.95 MILES
NET LENGTH = 22475.92 FT. = 4.26 MILES

STATE OF ILLINOIS
DEPARTMENT OF TRANSPORTATION

SUBMITTED March 23 20 18
Jeffrey S Keen
REGION FIVE ENGINEER

May 11 20 18
cc E.A. Etk
ENGINEER OF DESIGN AND ENVIRONMENT

May 11 20 18
DIRECTOR OF HIGHWAYS PROJECT IMPLEMENTATION

PRINTED BY THE AUTHORITY
OF THE STATE OF ILLINOIS

USER NAME = DUCASBC	DESIGNED -	REVISED -
PLOT SCALE = 100.0000 / in	DRAWN -	REVISED -
PLOT DATE = 3/19/2018	CHECKED -	REVISED -
	DATE -	REVISED -

**STATE OF ILLINOIS
 DEPARTMENT OF TRANSPORTATION**

SCALE: SHEET OF SHEETS STA. TO STA.

F.A.P. RTE. 331	SECTION D9 CRACK SEAL 2018-3	COUNTY JAC/MIL	TOTAL SHEETS 7	SHEET NO. 2
ILLINOIS FED. AID PROJECT			CONTRACT NO. 78644	

Prepared By:

[Signature]
 DISTRICT STUDIES & PLANS ENGINEER

Examined By:

[Signature]
 DISTRICT LAND ACQUISITION ENGINEER

Examined By:

[Signature]
 DISTRICT PROGRAM DEVELOPMENT ENGINEER

Examined By:

[Signature]
 DISTRICT OPERATIONS ENGINEER

Examined By:

[Signature]
 DISTRICT PROJECT IMPLEMENTATION ENGINEER

Examined By:

[Signature]
 DISTRICT CONSTRUCTION ENGINEER

Examined By:

[Signature]
 DISTRICT MATERIALS ENGINEER

SIGNATURE SHEET

INDEX OF SHEETS

SHEET NO.	DESCRIPTION
1	COVER SHEET
2	SIGNATURE SHEET
3	INDEX OF SHEETS, GENERAL NOTES, HIGHWAY STANDARDS,
4	MIXTURE REQUIREMENTS, COMMITMENTS, STATION EQUATIONS,
5	SUMMARY OF QUANTITIES
6	SUMMARY OF QUANTITIES - CONTINUED
7	SCHEDULE OF QUANTITIES

HIGHWAY STANDARDS

701422-10	LANE CLOSURE MULTI-LANE, FOR SPEEDS ≥ 45 MPH TO 55 MPH
701426-09	LANE CLOSURE MULTI-LANE- INTERMITTANT OR MOVING OPERATION 45 MPH OR MORE
701601-09	URBAN LANE CLOSURE, MULTI-LANE 1W OR 2W WITH NON TRAVERSABLE MEDIAN
701701-10	URBAN LANE CLOSURE, MULTI-LANE INTERSECTION
701901-07	TRAFFIC CONTROL DEVICES
780001-05	TYPICAL PAVEMENT MARKINGS
781001-04	TYPICAL APPLICATION OF RAISED REFLECTIVE PAVEMENT MARKERS

GENERAL NOTES

QUANTITIES AND LOCATIONS SHOWN IN THE PLANS FOR CRACK SEALING AND CENTERLINE REPAIR ARE ESTIMATES. THE ACTUAL AMOUNT AND LOCATIONS REQUIRED WILL BE DETERMINED BY THE ENGINEER.

FACTORS USED FOR ESTIMATING PLAN QUANTITIES ARE AS FOLLOWS AND SHALL NOT BE USED FOR THE BASIS OF FINAL QUANTITIES:

ALL HOT MIX ASPHALT 2.016 TONS/CU. YD.

JOINT SEALER 1.75 LBS/FT.

IN ADDITION TO THE REQUIREMENTS OF ARTICLE 107.16 THE CONTRACTOR SHALL PROTECT THE SURFACE OF ALL BRIDGE DECKS AND BRIDGE APPROACH PAVEMENTS IN A MANNER SATISFACTORY TO THE ENGINEER BEFORE ANY EQUIPMENT IS ALLOWED TO CROSS THE STRUCTURE. PROTECTION SHALL BE PROVIDED FOR ALL EQUIPMENT AS DEFINED IN ARTICLE 101.17 REGARDLESS IF TRACK MOUNTED OR WHEELED

AFTER A LIFT OF HOT MIX ASPHALT HAS BEEN PLACED, THE LANE SHALL REMAIN CLOSED TO TRAFFIC UNTIL THE NEW MAT HAS COOLED TO 150 DEGREES FAHRENHEIT

THERE ARE NO AVAILABLE WASTE SITES ON THE EXISTING RIGHT OF WAY WITHIN THE PROJECT LIMITS. DISPOSAL WILL BE THE RESPONSIBILITY OF THE CONTRACTOR AND WASTE MUST BE DISPOSED OF IN ACCORDANCE WITH ARTICLE 202.03 OF THE STANDARD SPECIFICATIONS.

TRAFFIC DATA

IL 13 (FAP 331) JACKSON	LEG A: EB LANES LEWIS TO COUPLE	LEG B: WB LANES LEWIS TO COUPLE	LEG C:	IL 13 (FAP 331) WILLIAMSON	LEG A:	LEG B:	LEG C:
M.P.	16.41-16.57	0.00-0.12	16.57-17.31	M.P.	18.79-0.28	0.28-1.39	1.39-3.07
(2018)				(2018)			
PV =	12,790	13,350	23,050	PV =	24,895	25,430	24,470
SU =	355	380	810	SU =	710	710	505
MU =	405	430	710	MU =	785	860	405
ADT =	13,550	14,160	24,570	ADT =	26,390	27,000	25,380
(2028)				(2028)			
PV =	14,305	14,915	25,775	PV =	27,835	28,430	27,355
SU =	395	425	905	SU =	790	790	565
MU =	450	480	790	MU =	875	960	450
ADT =	15,150	15,820	27,470	ADT =	29,500	30,180	28,370
(2038)				(2038)			
PV =	15,985	16,680	28,805	PV =	31,115	31,780	30,575
SU =	440	475	1,010	SU =	885	885	630
MU =	505	535	885	MU =	980	1,075	505
ADT =	16,930	17,690	30,700	ADT =	32,980	33,740	31,710

MODEL: Default
 FILE NAME: P:\IL\B&E\BID\NTEG\Illinois.gov\PIVDOT\Documents\IDOT_Offices\District_9\Projects\78644\CADD\Drawings\0778644-Sheets.dgn

USER NAME = DUGASBC	DESIGNED -	REVISED -	STATE OF ILLINOIS DEPARTMENT OF TRANSPORTATION	INDEX OF SHEETS, GENERAL NOTES, HIGHWAY STANDARDS, TRAFFIC DATA				F.A.P. RTE.	SECTION	COUNTY	TOTAL SHEETS	SHEET NO.
PLOT SCALE = 100.0000' / in.	DRAWN -	REVISED -						331	D9 CRACK SEAL 2018-3	JAC/WIL	7	3
PLOT DATE = 3/19/2018	CHECKED -	REVISED -		SCALE: SHEET OF SHEETS STA. TO STA.				CONTRACT NO. 78644				
	DATE -	REVISED -						ILLINOIS FED. AID PROJECT JACKSON/WILLIAMSON				

MIXTURE REQUIREMENTS

Locations	HOT-MIX ASPHALT SURFACE COURSE
Mixture Use(s):	POLYMERIZED HOT-MIX ASPHALT SURFACE COURSE, MIX D, N90
AC/PG:	SBS PG76-22
ABR % (MAX):	SEE SPECIAL PROVISION
Design Air Voids:	4.0% 90 GYRATION DESIGN
Mixture Composition: (Gradation Mixture)	IL-9.5MM
Friction Aggregate:	D SURFACE
Mixture Weight:	112 LBS/SQ YD/IN
Quality Management Program:	QC/QA
Sublot Size:	N/A

COMMITMENTS

NONE

STATION EQUATIONS

STA EQ. 198+50.10 (BK) = 110+12.05 (AH) EBL
 STA EQ. 118+53.92 (BK) = 118+34.62 (AH) EBL
 STA EQ. 118+55.63 (BK) = 118+58.20 (AH) EBL
 STA EQ. 270+99.12 (BK) = 271+23.13 (AH) EBL

STA EQ. 118+10.80 (BK) = 118+09.80 (AH) WBL
 STA EQ. 118+55.63 (BK) = 118+58.20 (AH) WBL

OMISSIONS

EAST BOUND LANES

STA 141+00 TO STA 223+50 GIANT CITY RD. TO REED STATION RD.
 STA 262+00 TO STA 266+28.70 FOR INTERSECTION SPILLWAY RD.
 STA 308+84 TO STA 310+16 FOR SN 100-0018
 STA 335+38.50 TO STA 336+61.50 FOR SN 100-0020

WEST BOUND LANES

STA 151+40.15 TO STA 194+73.60 GIANT CITY RD. TO REED STATION RD.
 STA 263+00 TO STA 266+97 FOR INTERSECTION SPILLWAY RD.
 STA 308+63.25 TO STA 310+36.75 FOR SN 100-0066
 STA 335+18.83 TO STA 336+81.17 FOR SN 100-0067

MODEL: Default
 FILE NAME: P:\U188A\BEN\NITEG_ILH\proj\PIV\DOT\Documents\DOT_Offices\District 9\Projects\78644\CADD\Drawings\DOT\78644-Sheets.dgn

	USER NAME = DUGASBC	DESIGNED -	REVISED -	STATE OF ILLINOIS DEPARTMENT OF TRANSPORTATION	MIXTURE REQUIREMENTS, STATION EQUATIONS OMISSIONS, COMMITMENTS	F.A.P. RTE.	SECTION	COUNTY	TOTAL SHEETS	SHEET NO.
	PLOT SCALE = 100.0000' / in.	DRAWN -	REVISIED -			331	D9 CRACK SEAL 2018-3	JAC/WIL	7	4
	PLOT DATE = 3/19/2018	CHECKED -	REVISIED -			CONTRACT NO. 78644				
		DATE -	REVISIED -		SCALE:	SHEET	OF	SHEETS	STA.	TO STA.
						ILLINOIS		FED. AID PROJECT		

SUMMARY OF QUANTITIES

COUNTY:	COUNTY:	JACKSON CO	WILLIAMSON CO
ROUTE:	ROUTE:	IL 13	IL 13
FUNDING:	FUNDING:	100% STATE	100% STATE
LOCATION:	LOCATION:	URBAN	URBAN
	TOTAL QUANTITY	ROADWAY 0005	ROADWAY 0005

CODE NUMBER	ITEM DESCRIPTION	UNIT	TOTAL QUANTITY	JACKSON CO	WILLIAMSON CO
40600295	POLYMERIZED BITUMINOUS MATERIALS (TACK COAT)	POUND	2,449	556	1,893
40603545	POLYMERIZED HOT-MIX ASPHALT SURFACE COURSE, MIX "D", N90	TON	614	140	474
44000157	HOT-MIX ASPHALT SURFACE REMOVAL, 2"	SQ YD	5,420	1,229	4,191
45100100	CRACK ROUTING (PAVEMENT)	FOOT	35,529	21,250	14,279
45100200	CRACK FILLING	POUND	62,182	37,190	24,992
67100100	MOBILIZATION	L SUM	1	0.5	0.5
70100320	TRAFFIC CONTROL AND PROTECTION, STANDARD 701422	L SUM	1	0.5	0.5
70102630	TRAFFIC CONTROL AND PROTECTION, STANDARD 701601	L SUM	1	1	0
70102635	TRAFFIC CONTROL AND PROTECTION, STANDARD 701701	L SUM	1	0.5	0.5
70300220	TEMPORARY PAVEMENT MARKING - LINE 4"	FOOT	6,097	1,382	4,715
* 78009004	MODIFIED URETHANE PAVEMENT MARKING - LINE 4"	FOOT	6,097	1,382	4,715
* 78100100	RAISED REFLECTIVE PAVEMENT MARKER	EACH	316	72	244
78300200	RAISED REFLECTIVE PAVEMENT MARKER REMOVAL	EACH	316	72	244
X7015005	CHANGEABLE MESSAGE SIGN	CAL DAY	28	14	14

* SPECIALTY ITEM

MODEL: D:\p\k\c\...
 FILE NAME: p\w\1084\EBID\MTEC\Illinois.gov\FV\DOT\Documents\DOT_Office\District_0\Project\78644\CAD\Drawings\0778644_Sheets.dgn

USER NAME = DUGASBC DESIGNED - DRAWN - CHECKED - DATE -	REVISED - REVISED - REVISED - REVISED -	STATE OF ILLINOIS DEPARTMENT OF TRANSPORTATION	SUMMARY OF QUANTITIES	F.A.P. RTE. 331 SECTION D9 CRACK SEAL 2018-3 COUNTY JAC/WIL TOTAL SHEETS 7 SHEET NO. 5 CONTRACT NO. 78644
PLOT SCALE = 100.0000' / in. PLOT DATE = 3/20/2018		SCALE: SHEET OF SHEETS STA. TO STA.		

SUMMARY OF QUANTITIES - CONT

COUNTY:	COUNTY:	JACKSON CO	WILLIAMSON CO
ROUTE:	ROUTE:	IL 13	IL 13
FUNDING:	FUNDING:	100% STATE	100% STATE
LOCATION:	LOCATION:	URBAN	URBAN

CODE NUMBER	ITEM DESCRIPTION	UNIT	TOTAL QUANTITY	ROADWAY 0005	ROADWAY 0005
X7030005	TEMPORARY PAVEMENT MARKING REMOVAL	SQ FT	2,037	463	1,574

MODEL: D:\default
 FILE NAME: pr:\VIL094EB\DOT\TSG\Illinois.gov\FWIDOT\Documents\DOT_Offices\District 9\Projects\District 9\Projects\78644\CADD\Drawn\CAD\Drawings\0978644-5 sheets.dgn

USER NAME = DUGASBC	DESIGNED -	REVISED -
	DRAWN -	REVISED -
PLOT SCALE = 100.0000 / in.	CHECKED -	REVISED -
PLOT DATE = 3/22/2018	DATE -	REVISED -

STATE OF ILLINOIS
DEPARTMENT OF TRANSPORTATION

SCHEDULE OF QUANTITIES				
CONTINUED				
SCALE:	SHEET	OF	SHEETS	STA. TO STA.

F.A.P. RTE.	SECTION	COUNTY	TOTAL SHEETS	SHEET NO.
331	D9 CRACK SEAL 2018-3	JAC/WIL	7	6
CONTRACT NO. 78644			ILLINOIS FED. AID PROJECT	

SCHEDULE FOR IL-13 CENTERLINE REPAIR

IL-13 (FAP 331)	SECTION LENGTH	MILL WIDTH	CRACK ROUTING (PAVT)	CRACK FILLING	HMA SURF REMOVAL 2"	POLYMERIZED HMA SC MIX "D" 2"	POLYMERIZED BIT MATLS TACK CT	MOD URETH PAVEMENT MARKING LINE 4"	TEMP PAVEMENT MARKING LINE 4"	TEMP PAVEMENT MARKING REMOVAL	RAISED REFLECTIVE PVMT MKR	RAISED REFLECTIVE PVMT MKR REMOVAL	COMMENTS
COMMENT	FEET	INFO	FEET	LB	SQ YD	TONS	LB	FOOT	FOOT	SQ FT	EACH	EACH	
EASTBOUND LANES													
STA 185+23.60 TO STA 198+50.10 BK	1326.50		2654	4645									LT AND RT CENTERLINE
STA 110+12.05 AHTO STA 118+53.92 BK	841.87		1684	2947									LT AND RT CENTERLINE
STA 118+34.62 AHTO STA 118+55.63 BK	21.01		44	77									LT AND RT CENTERLINE
STA 118+58.20 AHTO STA 141+00.00	2241.80		4484	7847									
STA 141+00.00 TO STA 223+50.00	8250.00	OMIT											GIANT CITY TO REED STATION
STA 223+50.00 TO STA 237+30.00	1380.00		1380	2415									
STA 237+30.00 TO STA 247+00.00	970.00				216	25	98	243	243	81	13	13	
STA 247+00.00 TO STA 249+74.00	274.00	CO. LINE	274	480									END JACKSON COUNTY
STA 249+74.00 TO STA 262+00.00	1226.00	CO. LINE	1226	2146									BEGIN WILLIAMSON COUNTY
STA 262+00.00 TO STA 266+28.70	428.70	OMIT											SPILLWAY RD. INTERSECTION
STA 266+28.70 TO STA 270+99.12 BK	470.42	STA EQ			105	12	48	118	118	40	6	6	
STA 271+23.13 AHTO STA 308+84.00	3760.87				836	94	377	941	941	314	48	48	
STA 308+84.00 TO STA 310+16.00	132.00	SN 100-0018											BRIDGE OMISSION
STA 310+16.00 TO STA 335+38.50	2522.50		2523	4416									
STA 335+38.50 TO STA 336+61.50	123.00	SN 100-0020											BRIDGE OMISSION
STA 336+61.50 TO STA 345+50.00	888.50		889	1556									
STA 345+50.00 TO STA 349+00.00	350.00				78	9	36	88	88	30	5	5	
STA 349+00.00 TO STA 356+00.00	700.00		700	1225									
STA 356+00.00 TO STA 404+00.00	4800.00				1067	120	481	1200	1200	400	61	61	
STA 404+00.00 TO STA 410+46.00	646.00	3 LANES	646	1131									LT CENTERLINE
STA 404+00.00 TO STA 410+46.00	646.00	3 LANES			144	17	65	162	162	54	9	9	RT CENTERLINE
EB LANES TOTAL			16504	28885	2446	277	1105	2752	2752	919	142	142	
WESTBOUND LANES													
STA 99+00.00 TO STA 118+10.80 BK	1910.8	STA EQ	3822	6689									LT AND RT CENTERLINE
STA 118+09.80 AHTO STA 118+55.63 BK	45.8	STA EQ	92	161									LT AND RT CENTERLINE
STA 118+58.20 AHTO STA 134+00.00	1541.8		3084	5397									LT AND RT CENTERLINE
STA 134+00.00 TO STA 141+00.00	700.00				156	18	71	175	175	59	9	9	
STA 141+00.00 TO STA 151+40.15	1040.15		2082	3644									
STA 141+00.00 TO STA 194+73.60	5373.60	OMIT											GIANT CITY TO REED STATION
STA 194+73.60 TO STA 220+00.00	2526.40				562	63	253	632	632	211	32	32	
STA 220+00.00 TO STA 233+00.00	1300.00		1300	2275									
STA 233+00.00 TO STA 236+50.00	350.00				78	9	36	88	88	30	5	5	
STA 236+50.00 TO STA 240+00.00	350.00		350	613									
STA 240+00.00 TO STA 249+74.00	974.00	CO. LINE			217	25	98	244	244	82	13	13	END JACKSON COUNTY
STA 249+74.00 TO STA 252+00.00	226.00	CO. LINE	226	396									BEGIN WILLIAMSON COUNTY
STA 252+00.00 TO STA 254+50.00	250.00				56	7	26	63	63	21	4	4	
STA 254+50.00 TO STA 256+40.00	190.00		190	333									
STA 256+40.00 TO STA 263+00.00	660.00				147	17	67	165	165	55	9	9	
STA 263+00.00 TO STA 266+97.00	397.00	OMIT											SPILLWAY RD. INTERSECTION
STA 266+97.00 TO STA 308+63.25	4166.25		4167	7293									
STA 308+63.25 TO STA 310+36.75	173.50	SN 100-0066											BRIDGE OMISSION
STA 310+36.75 TO STA 335+18.83	2482.08				552	62	249	621	621	207	32	32	
STA 335+18.83 TO STA 336+81.17	162.34	SN 100-0067											BRIDGE OMISSION
STA 336+81.17 TO STA 339+50.00	268.83				60	7	27	68	68	23	4	4	
STA 339+50.00 TO STA 359+50.00	2000.00		2000	3500									
STA 359+50.00 TO STA 393+91.44	3441.44				765	86	345	861	861	287	44	44	
STA 393+91.44 TO STA 411+02.45	1711.01	3 LANES	1712	2996									RT CENTERLINE
STA 393+91.44 TO STA 411+02.45	1711.01	3 LANES			381	43	172	428	428	143	22	22	LT CENTERLINE
WB LANES TOTAL			19025	33297	2974	337	1344	3345	3345	1118	174	174	
PROJECT TOTALS			35529	62182	5420	614	2449	6097	6097	2037	316	316	

MODEL: D:\enr\...
 FILE NAME: ...
 PROJECT: ...
 OFFICE: ...
 DATE: 3/22/2018

USER NAME = DUGASBC	DESIGNED -	REVISED -
	DRAWN -	REVISED -
PLOT SCALE = 100.0000' / in.	CHECKED -	REVISED -
PLOT DATE = 3/22/2018	DATE -	REVISED -

**STATE OF ILLINOIS
DEPARTMENT OF TRANSPORTATION**

SCHEDULE OF QUANTITIES

SCALE: SHEET OF SHEETS STA. TO STA.

F.A.P. RTE.	SECTION	COUNTY	TOTAL SHEETS	SHEET NO.
331	D9 CRACK SEAL 2018-3	JAC/WIL	7	7
CONTRACT NO. 78644				
ILLINOIS FED. AID PROJECT JACKSON/WILLIAMSON				