

INDEX OF SHEETS

- 1. Cover Sheet
- 2. Summary Of Quantities
- 3-5. Existing Cross Sections
- 6-8. Proposed Cross Sections
- 9-10. Typical Details
- 11-16. Plan Sheets

STATE OF ILLINOIS
DEPARTMENT OF TRANSPORTATION
PROPOSED PLANS

F.A.S. ROUTE 493
14-00024-06-RS
RESURFACE
McLEAN COUNTY
BELLFLOWER-SAYBROOK RD (CH 5)
JOB: C-95-322-17
PROJECT# 6UAD (950)
FUNDING: STR, TARP

CD. HWY#	SECTION	COUNTY	TOTAL SHEETS	SHEET NO.
5	14-00024-06-RS	McLEAN	16	1

CONTRACT NO. 91560

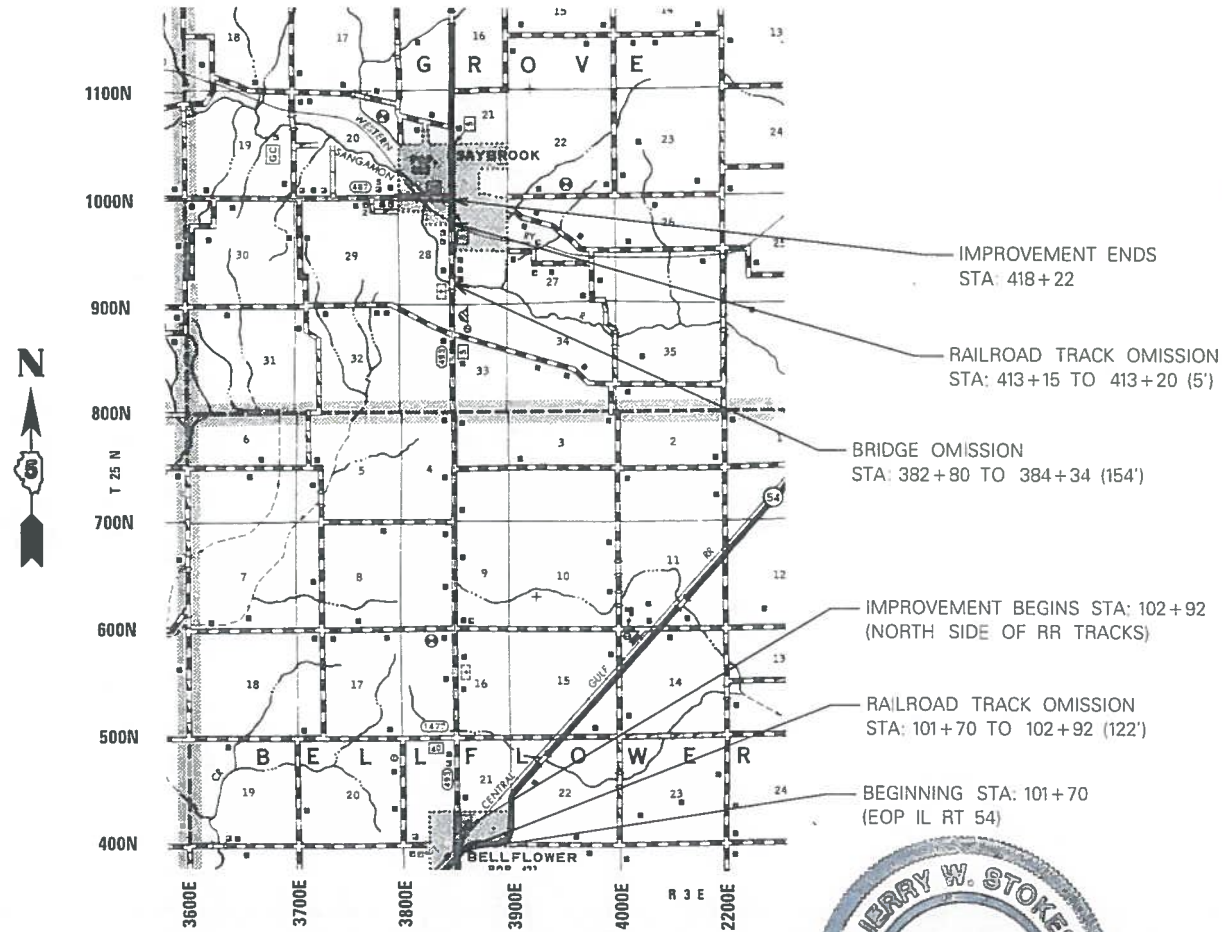

APPROXIMATE SCALE: 0 1 MILE

- NOTE: THE TOTAL LENGTH OF THE PROPOSED PROJECT IS 31,530 FEET WITH A NET LENGTH OF 31,371 FEET (5.94 MILES)
- NOTE: THESE PLANS MEET THE MINIMUM REQUIREMENTS FOR A 3R IMPROVEMENT.
- NOTE: CURRENT ADT: 825
FUNCTIONAL CLASSIFICATION: MAJOR COLLECTOR



Jerry W. Stokes
 ILLINOIS PROFESSIONAL ENGINEER #57636
 EXPIRES 11-30-19

THESE PLANS ARE NOT TO SCALE

J.U.L.I.E.
 JOINT UTILITY LOCATION INFORMATION FOR EXCAVATION
 1-800-892-0123

CONTRACT NO. 91560

**PRINTED BY THE AUTHORITY
 OF THE STATE OF ILLINOIS**

**STATE OF ILLINOIS
 DEPARTMENT OF TRANSPORTATION**

APPROVED MARCH 19 20 18
Jerry Stokes
 COUNTY ENGINEER

PASSED MARCH 23 20 18
[Signature]
 DISTRICT FIVE ENGINEER OF
 LOCAL ROADS & STREETS

Releasing For
 Bid Based on
 Limited Review March 28 20 18
[Signature]
 REGION THREE ENGINEER

STATE OF ILLINOIS
 DEPARTMENT OF TRANSPORTATION

SUMMARY OF QUANTITIES

ITEM NUMBER	ITEM	UNIT	TOTAL QUANTITY
40600290	BITUMINOUS MATERIALS (TACK COAT)	POUND	53,500
40600990	TEMPORARY RAMP	SQ YD	90
40603080	HOT-MIX ASPHALT BINDER COURSE, IL 19.0, N50	TON	7,780
40603310	HOT-MIX ASPHALT SURFACE COURSE, MIX "C", N50	TON	6,800
40800050	INCIDENTAL HOT-MIX ASPHALT SURFACING	TON	750
42400100	PORTLAND CEMENT CONCRETE SIDEWALK - 4"	SQ FT	476
42400800	DETECTABLE WARNINGS	SQ FT	56
44000155	HOT-MIX ASPHALT SURFACE REMOVAL - 1 1/2"	SQ YD	2,403
44000156	HOT-MIX ASPHALT SURFACE REMOVAL - 1 3/4"	SQ YD	76,168
44000600	SIDEWALK REMOVAL	SQ FT	668
48102100	AGGREGATE WEDGE SHOULDERS, TYPE B	TON	3,500
△ 63000001	SPBGR, TYPE A, 6' POSTS	FOOT	450
△ 63100075	TRAFFIC BARRIER TERMINAL, TYPE 5A	EACH	4
67100100	MOBILIZATION	L SUM	1
△ 78100100	RAISED REFLECTIVE PAVEMENT MARKERS	EACH	395
△ LR631020	TRAFFIC BARRIER TERMINAL, TYPE 1	EACH	4
X4401198	HOT-MIX ASPHALT SURFACE REMOVAL, VARIABLE DEPTH	SQ YD	300
△ X5619210	WATERVALVES TO BE ADJUSTED (SPECIAL)	EACH	1
X7010216	TRAFFIC CONTROL AND PROTECTION (SPECIAL)	L SUM	1
Z0033700	LONGITUDINAL JOINT SEALANT	FOOT	31,371
Z0048665	RAILROAD PROTECTIVE LIABILITY INSURANCE	L SUM	1

STATE STANDARD DETAILS

- 000001-06 STANDARD SYMBOLS, ABBREVIATIONS AND PATTERNS
- 630001-12 STEEL PLATE BEAM GUARDRAIL
- 701001-02 OFF-RD OPERATIONS, 2L, 2W MORE THAN 15' AWAY
- 701006-05 OFF-RD OPERATIONS, 2L, 2W, 15' TO 24" FROM PAVEMENT EDGE
- 701011-04 OFF-RD MOVING OPERATIONS, 2L, 2W, DAY ONLY
- 701201-04 LANE CLOSURE, 2L, 2W DAY ONLY, FOR SPEEDS ≥ 45 MPH
- 701301-04 LANE CLOSURE, 2L, 2W SHORT TIME OPERATIONS
- 701306-04 LANE CLOSURE, 2L, 2W, SLOW MOVING OPERATIONS DAY ONLY, FOR SPEEDS ≥ 45 MPH
- 701326-04 LANE CLOSURE, 2L, 2W, PAVEMENT WIDENING, FOR SPEEDS ≥ 45 MPH
- 701901-07 TRAFFIC CONTROL DEVICES
- B.L.R. 18-6 TRAFFIC CONTROL DEVICES-DAY LABOR MAINTENANCE
- B.L.R. 23-4 TRAFFIC BARRIER TERMINAL TYPE 1
- B.L.R. 24-2 MAILBOX TURNOUT FOR LOCAL ROADS
- B.L.R. 27-1 TRAFFIC BARRIER TERMINAL TYPE 5A

△ SPECIALTY ITEMS

	Binder	Incidental	Surface
PG Grade	PG 64-22	PG 64-22	PG 64-22
Design Air Voids	4.0% @ N50	4.0% @ N50	4.0% @ N50
Mixture Composition	IL-19.0	IL 9.5	IL 9.5
Friction Aggregate	N/A	Mixture C	Mixture C
Mixture Weight	112	112	112
Quality Management Program	QC/QA	QC/QA	QC/QA
Method	Correlation	-	Correlation

** FOR THE ALLOWABLE RAP/FRAP PERCENTAGES, SEE BDE 80306 RECLAIMED ASPHALT PAVEMENT AND RECLAIMED ASPHALT SHINGLES.

USER NAME = matt@omstrang PLOT SCALE = 1/8" = 100.0000' / 1"	DESIGNED - _____ DRAWN - _____ CHECKED - _____ DATE - _____	REVISED - _____ REVISED - _____ REVISED - _____ REVISED - _____	STATE OF ILLINOIS DEPARTMENT OF TRANSPORTATION	SUMMARY OF QUANTITIES	F.A.S. RTE. 493 SECTION 14-0224-06-RS COUNTY McLEAN TOTAL SHEETS 16 SHEET NO. 2 COUNTY HIGHWAY 5 CONTRACT NO. 9156D FED. ROAD DIST. NO. 5 ILLINOIS FED. AID PROJECT
			SCALE: _____	SHEET NO. 1 OF 1 SHEETS	

EXISTING TYPICAL CROSS SECTION
 BELLFLOWER-SAYBROOK RD
 14-00024-06-RS
 STA: 102+92 TO 104+36
 STA: 105+71 TO 413+15
 STA: 416+00 TO 416+46

80' R.O.W.

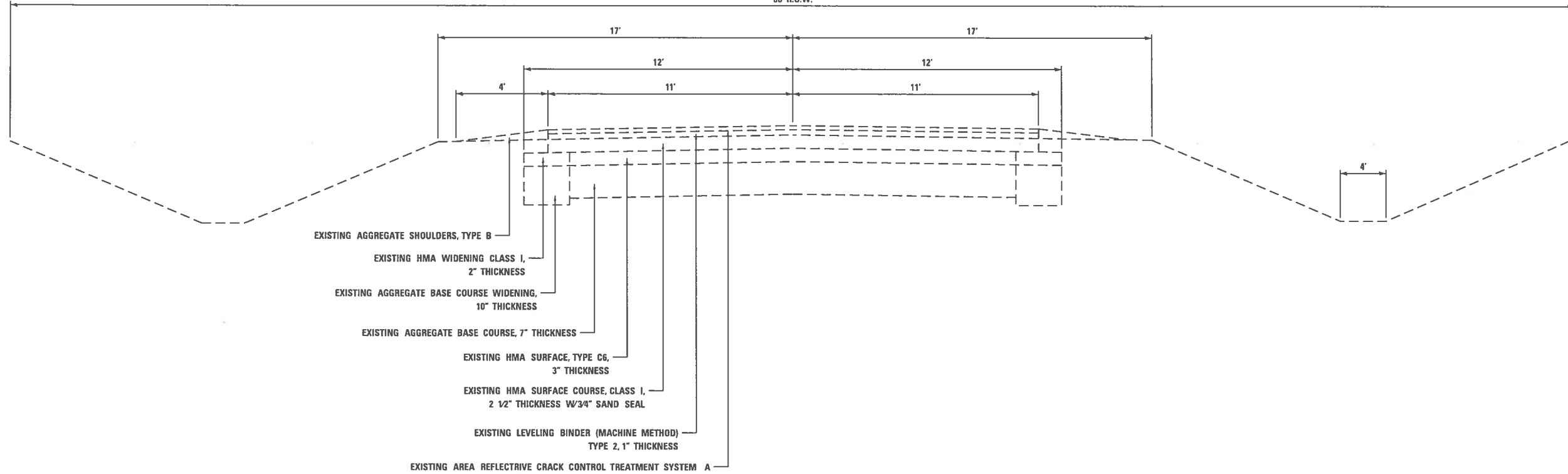

EXISTING TYPICAL CROSS SECTION
 BELLFLOWER-SAYBROOK RD
 14-00024-06-RS
 STA: 104+36 TO 105+71

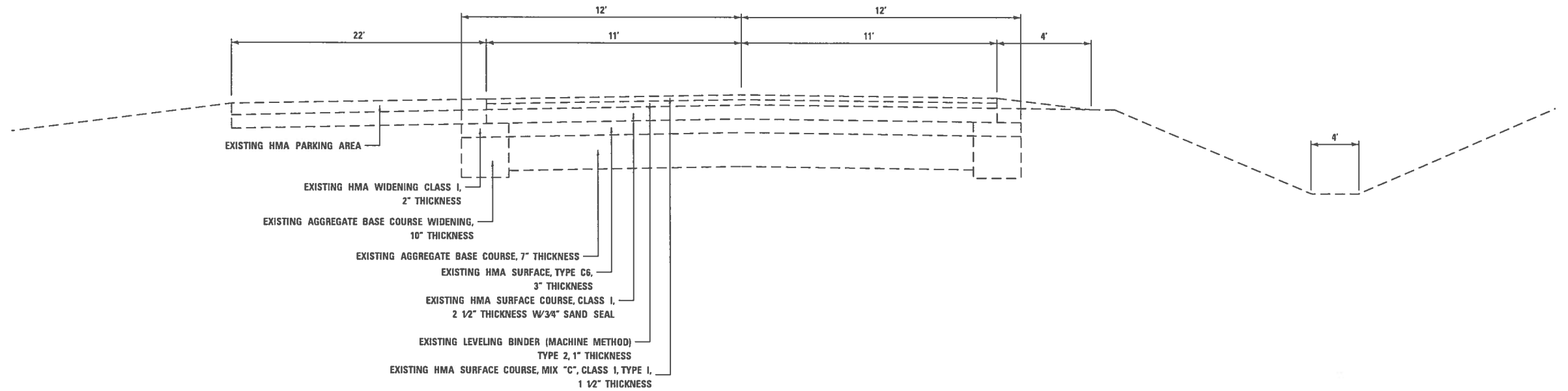

FILE NAME	USER NAME = mact.branting	DESIGNED =	REVISED =	STATE OF ILLINOIS DEPARTMENT OF TRANSPORTATION	EXISTING TYPICAL CROSS SECTIONS	F.A.S. RTE.	SECTION	COUNTY	TOTAL SHEETS	SHEET NO.	
	PLLOT SCALE = 1/8" = 100.0000' / in.	DRAWN =	REVISED =			493	14-00024-06-RS	McLEAN	16	3	
PLLOT DATE = 3/16/2018	DATE =	REVISED =	REVISED =	SCALE: NO SCALE	SHEET NO. 1 OF 3 SHEETS	STA. 102+92 TO STA. 414+32	COUNTY HIGHWAY 5	CONTRACT NO. 91560	FED. ROAD DIST NO. 5	ILLINOIS	FED. AID PROJECT

EXISTING TYPICAL CROSS SECTION
 BELLFLOWER-SAYBROOK RD
 14-00024-06-RS
 STA: 413 + 20 TO 414 + 40

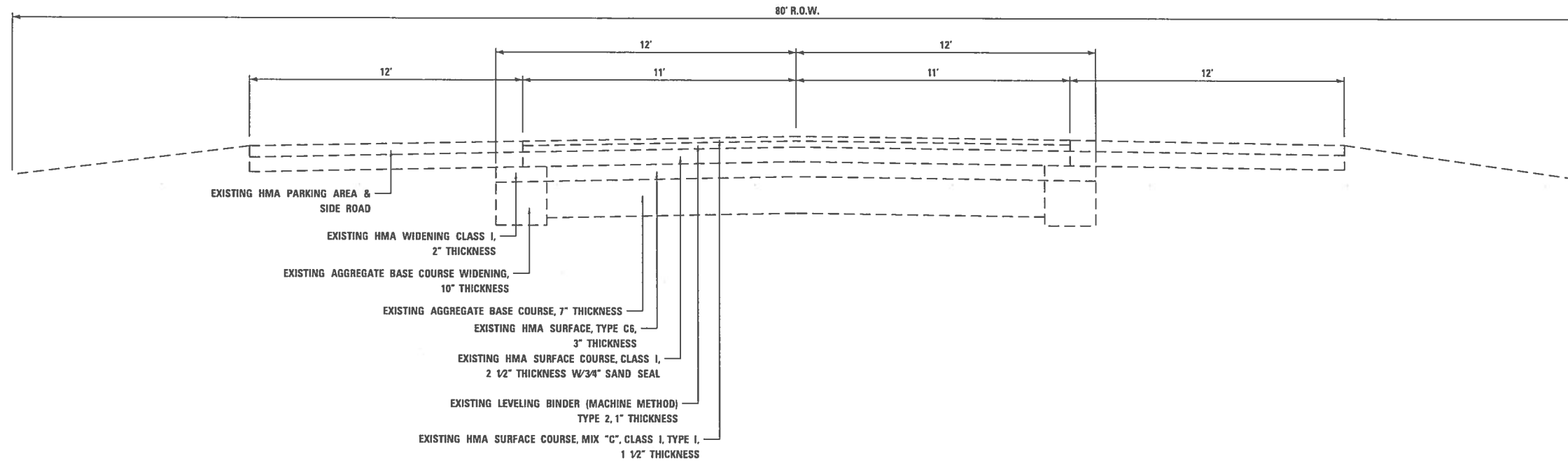

EXISTING TYPICAL CROSS SECTION
 BELLFLOWER-SAYBROOK RD
 14-00024-06-RS
 STA: 414 + 40 TO 414 + 96

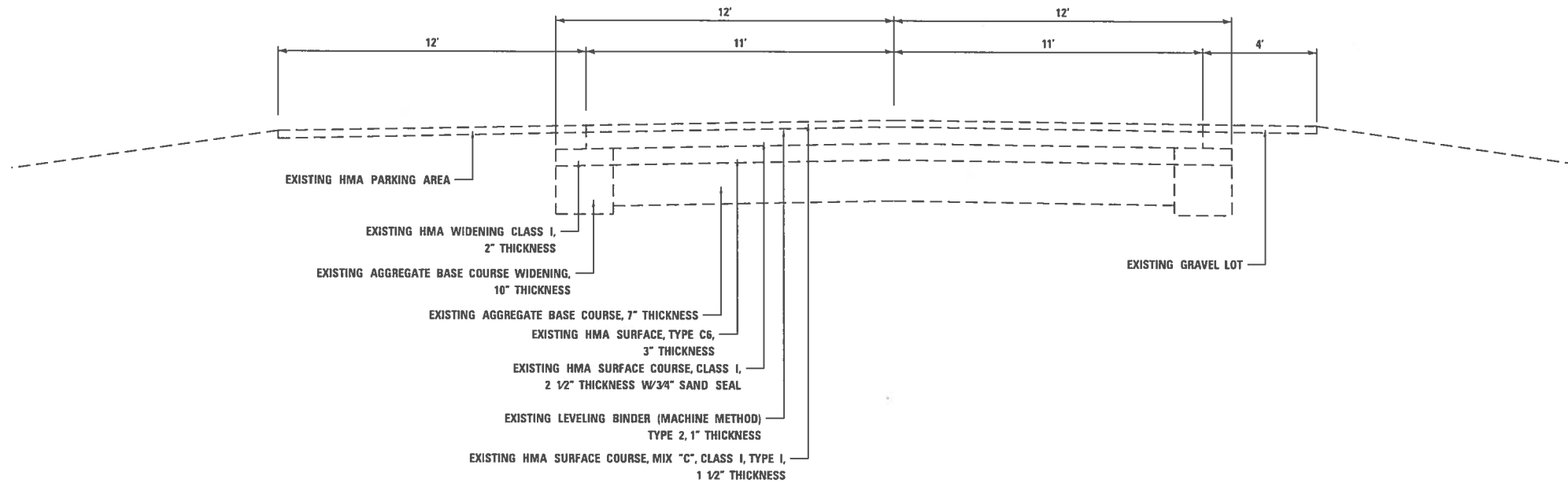

FILE NAME *	USER NAME = matt.armstrong	DESIGNED --	REVISED --	STATE OF ILLINOIS DEPARTMENT OF TRANSPORTATION	EXISTING TYPICAL CROSS SECTIONS			F.A.S. RTE.	SECTION	COUNTY	TOTAL SHEETS	SHEET NO.
	PLOT SCALE = 100.0000 /in.	DRAWN --	REVISED --					493	14-00024-06-RS	McLEAN	16	4
	PLOT DATE = 3/16/2018	CHECKED --	REVISED --					COUNTY HIGHWAY 5				CONTRACT NO. 91560
	DATE --	REVISED --		SCALE: NO SCALE	SHEET NO. 2 OF 3 SHEETS	STA. 414+32 TO STA. 415+87	FED. ROAD DIST NO. 5	ILLINOIS	FED. AID PROJECT			

EXISTING TYPICAL CROSS SECTION
 BELLFLOWER-SAYBROOK RD
 14-00024-06-RS
 STA: 414+96 TO 416+00

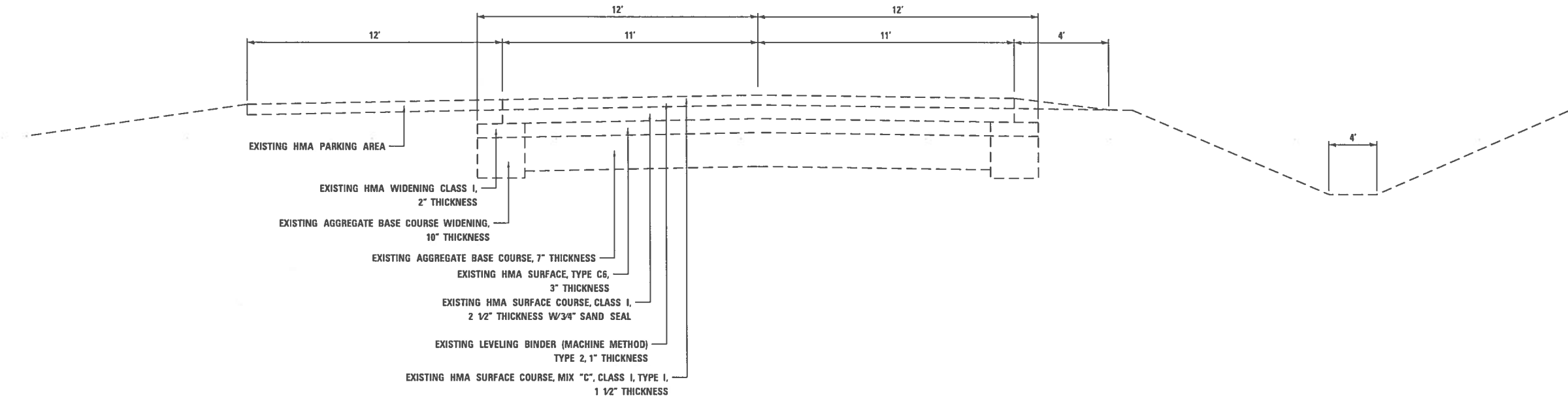

EXISTING TYPICAL CROSS SECTION
 BELLFLOWER-SAYBROOK RD
 14-00024-06-RS
 STA: 416+46 TO 418+22

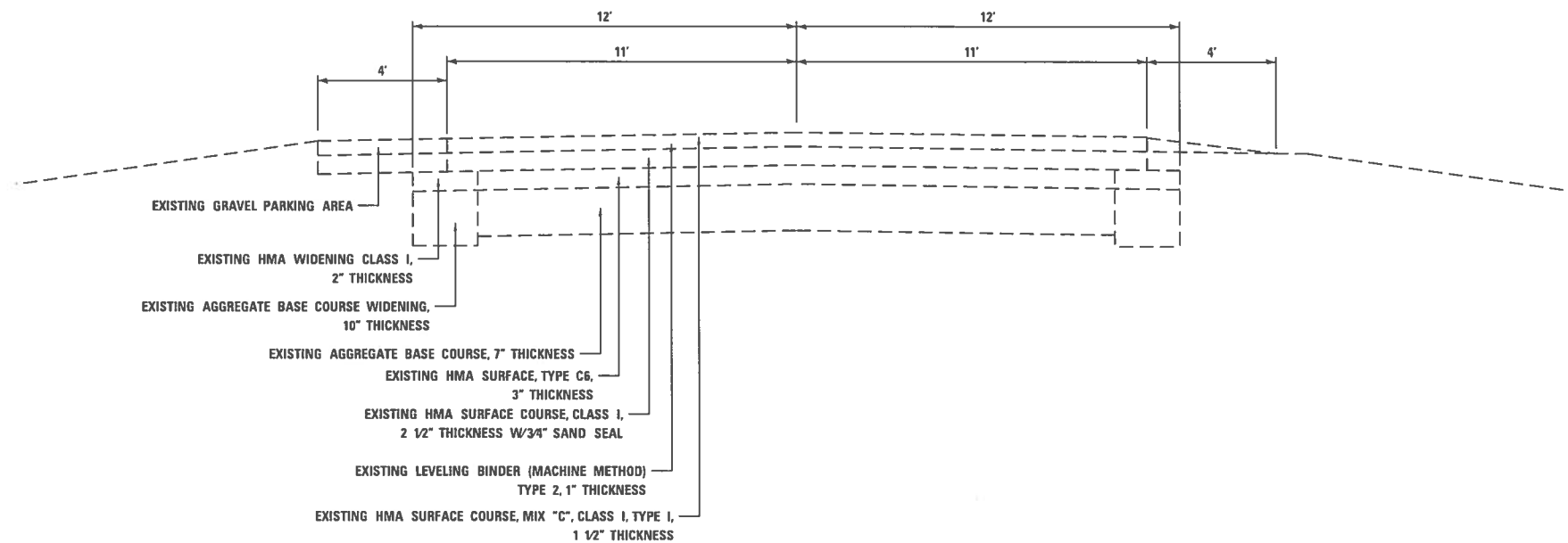

FILE NAME =	USER NAME = matt.armstrong	DESIGNED --	REVISED --	STATE OF ILLINOIS DEPARTMENT OF TRANSPORTATION	EXISTING TYPICAL CROSS SECTIONS			F.A.S. RTE.	SECTION	COUNTY	TOTAL SHEETS	SHEET NO.
	PLOT SCALE = 100.0000 /in.	DRAWN --	REVISED --					493	14-00024-06-RS	McLEAN	18	5
	PLOT DATE = 3/16/2018	CHECKED --	REVISED --		SCALE: NO SCALE SHEET NO. 3 OF 3 SHEETS STA. 415+87 TO STA. 418+22			COUNTY HIGHWAY 5		CONTRACT NO. 91560		
	DATE --	REVISED --				FED. ROAD DIST NO. 5	ILLINOIS	FED. AID PROJECT				

PROPOSED TYPICAL CROSS SECTION
 BELLFLOWER-SAYBROOK RD
 14-00024-06-RS
 STA: 102+92 TO 104+36
 STA: 105+71 TO 413+15
 STA: 416+00 TO 416+46

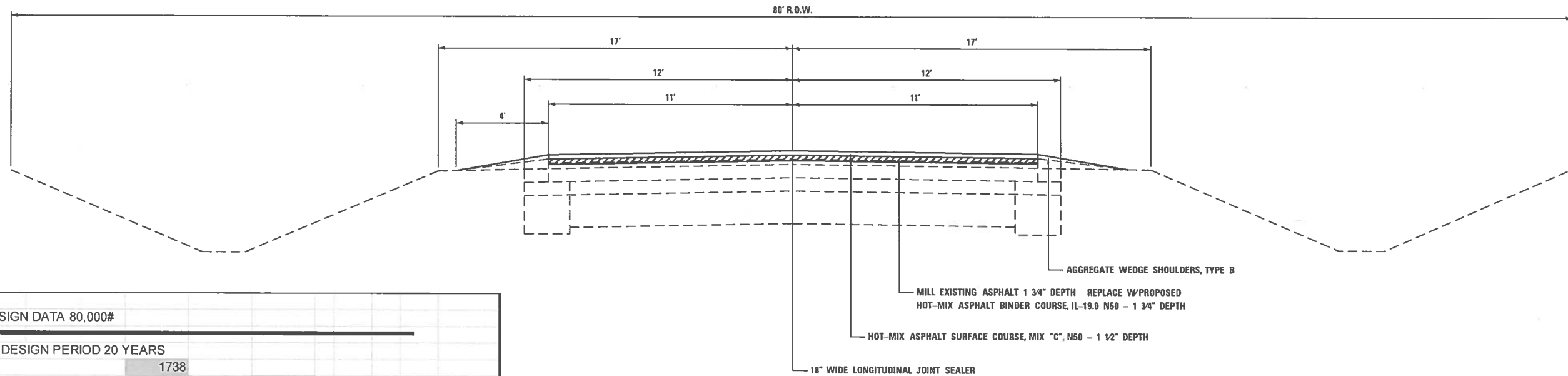

STRUCTURAL DESIGN DATA 80,000#

CLASS III ROAD DESIGN PERIOD 20 YEARS

CURRENT A.D.T. 1738
 STRUCTURAL DESIGN TRAFFIC: 2121 YEAR: 2035

PERCENT OF DESIGN TRAFFIC IN DESIGN LANE:

P.C.	88%	S.U.	7%	M.U.	5%
P.C.	1866	S.U.	148	M.U.	106

MINIMUM SOIL SUPPORT: IBR = 3.0

TRAFFIC FACTOR (T.F.)= 0.572

STRUCTURAL NUMBER, (Dt)= 3.82

PAVEMENT STRUCTURE MATERIALS:

SURFACE: PROPOSED BITUMINOUS CONCRETE	3 @ 0.40	a1= 1.20
BASE: EXISTING BITUMINOUS CONCRETE	2.625 @ 0.30	a2= 0.79
BASE: EXISTING BITUMINOUS CONCRETE	3 @ 0.23	a3= 0.69
SUBBASE: EXISTING AGGREGATE BASE COURSE	12 @ 0.10	a5= 1.20

PROPOSED Dt TOTAL 3.88

PROPOSED TYPICAL CROSS SECTION
 BELLFLOWER-SAYBROOK RD
 14-00024-06-RS
 STA: 104+36 TO 105+71

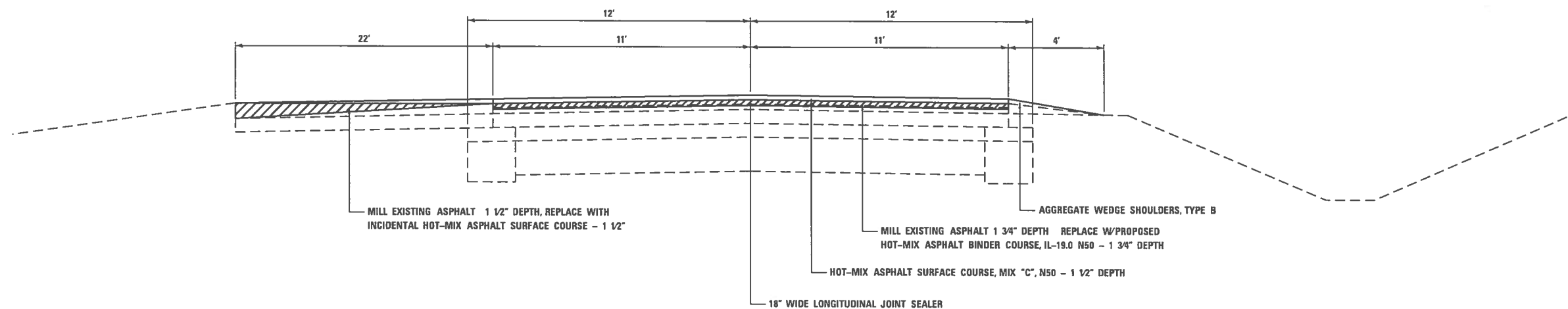

USER NAME = matt.armstrong	DESIGNED --	REVISED --	STATE OF ILLINOIS DEPARTMENT OF TRANSPORTATION	PROPOSED TYPICAL CROSS SECTIONS	F.A.S. RTE.	SECTION	COUNTY	TOTAL SHEETS	SHEET NO.
PLOT SCALE = 100.0000 /in.	DRAWN --	REVISED --			493	14-00024-06-RS	McLEAN	16	6
PLOT DATE = 3/16/2018	CHECKED --	REVISED --			COUNTY HIGHWAY 5			CONTRACT NO. 91560	
DATE --	REVISED --	REVISED --			SCALE: NO SCALE		SHEET NO. 1 OF 3 SHEETS	STA. 102+92 TO STA. 414+32	FED. ROAD DIST NO. 5

PROPOSED TYPICAL CROSS SECTION
 BELLFLOWER-SAYBROOK RD
 14-00024-06-RS
 STA: 413+20 TO 414+40

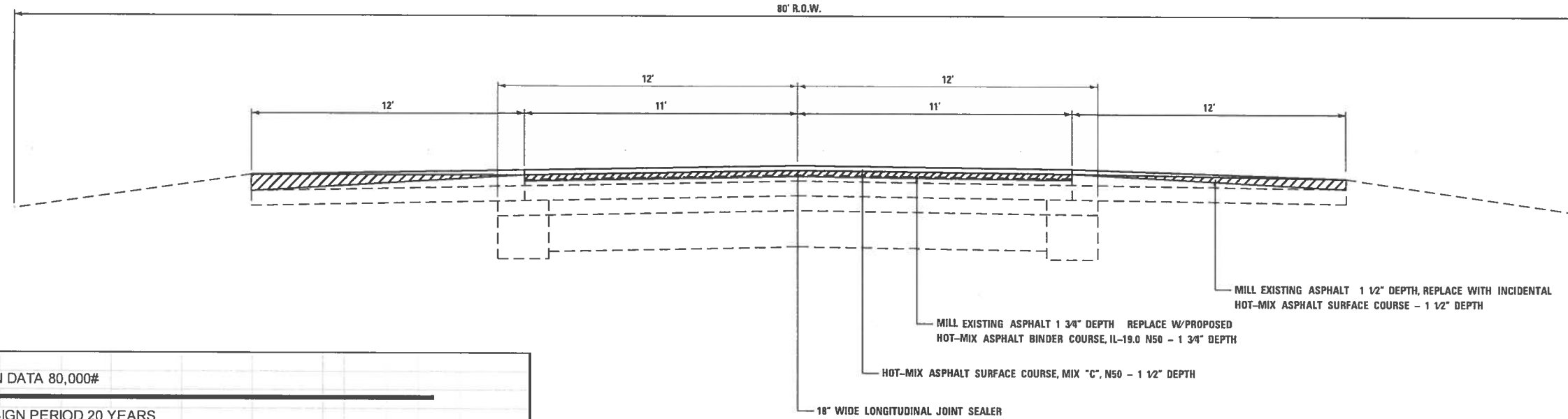

STRUCTURAL DESIGN DATA 80,000#					
CLASS III ROAD DESIGN PERIOD 20 YEARS					
CURRENT A.D.T.	1738				
STRUCTURAL DESIGN TRAFFIC:	2121	YEAR:	2035		
PERCENT OF DESIGN TRAFFIC IN DESIGN LANE:					
P.C.	88%	S.U.	7%	M.U.	5%
P.C.	1866	S.U.	148	M.U.	106
MINIMUM SOIL SUPPORT:	IBR = 3.0				
TRAFFIC FACTOR (T.F.)=	0.572				
STRUCTURAL NUMBER, (Dt)=	3.82				
PAVEMENT STRUCTURE MATERIALS:					
SURFACE: PROPOSED BITUMINOUS CONCRETE	3 @	0.40	a1=	1.20	
BASE: EXISTING BITUMINOUS CONCRETE	2.625 @	0.30	a2=	0.79	
BASE: EXISTING BITUMINOUS CONCRETE	3 @	0.23	a3=	0.69	
SUBBASE: EXISTING AGGREGATE BASE COURSE	12 @	0.10	a5=	1.20	
PROPOSED Dt TOTAL				3.88	

PROPOSED TYPICAL CROSS SECTION
 BELLFLOWER-SAYBROOK RD
 14-00024-06-RS
 STA: 414+40 TO 414+96

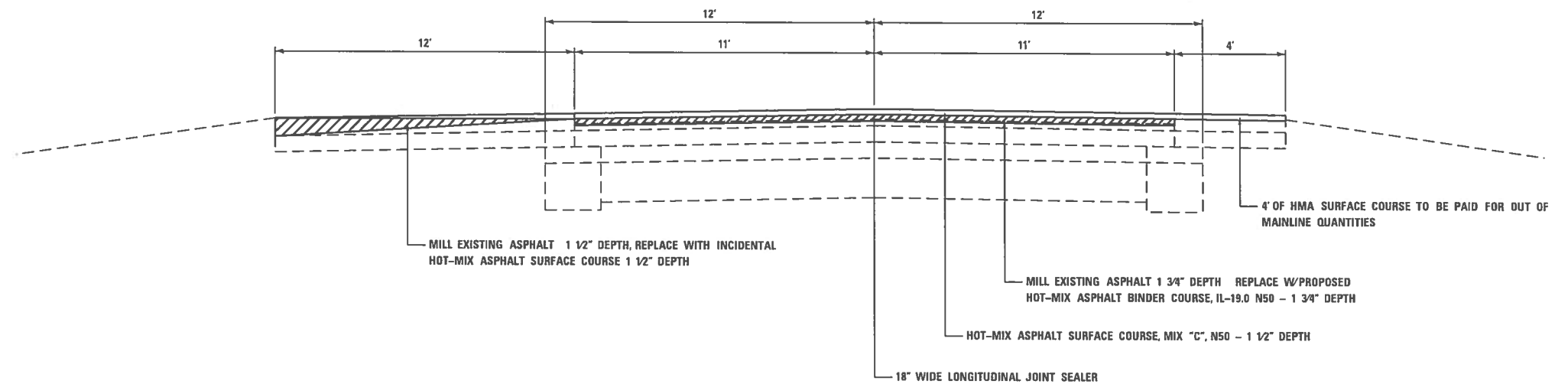

USER NAME = mmt.armstrong	DESIGNED =	REVISED =	STATE OF ILLINOIS DEPARTMENT OF TRANSPORTATION	PROPOSED TYPICAL CROSS SECTIONS	F.A.S. RTE. = 493	SECTION = 14-00024-06-RS	COUNTY = McLEAN	TOTAL SHEETS = 16	SHEET NO. = 7	
PLOT SCALE = 1/8" = 100.0000' / ft.	DRAWN =	REVISED =			SCALE: NO SCALE	SHEET NO. 2 OF 3 SHEETS	STA. 414+32 TO STA. 415+87	COUNTY HIGHWAY 5		CONTRACT NO. 91560
PLOT DATE = 3/16/2018	CHECKED =	REVISED =			FED. ROAD DIST. NO. 5		ILLINOIS	FED. AID PROJECT		

PROPOSED TYPICAL CROSS SECTION
 BELLFLOWER-SAYBROOK RD
 14-00024-06-RS
 STA: 414+96 TO 416+00

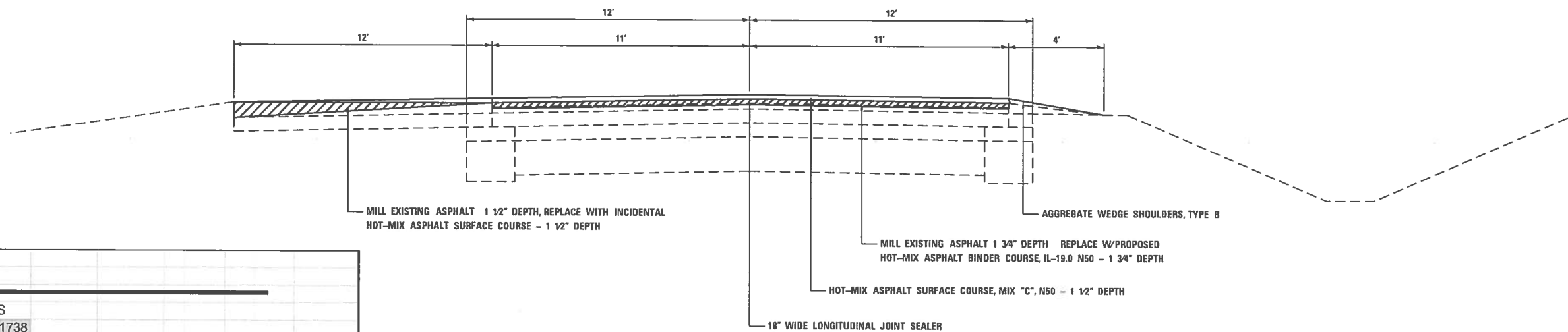

STRUCTURAL DESIGN DATA 80,000#

CLASS III ROAD DESIGN PERIOD 20 YEARS

CURRENT A.D.T. 1738

STRUCTURAL DESIGN TRAFFIC: 2121 YEAR: 2035

PERCENT OF DESIGN TRAFFIC IN DESIGN LANE:

P.C.	88%	S.U.	7%	M.U.	5%
P.C.	1866	S.U.	148	M.U.	106

MINIMUM SOIL SUPPORT: IBR = 3.0

TRAFFIC FACTOR (T.F.)= 0.572

STRUCTURAL NUMBER, (D_t)= 3.82

PAVEMENT STRUCTURE MATERIALS:

SURFACE: PROPOSED BITUMINOUS CONCRETE	3 @ 0.40	a1= 1.20
BASE: EXISTING BITUMINOUS CONCRETE	2.625 @ 0.30	a2= 0.79
BASE: EXISTING BITUMINOUS CONCRETE	3 @ 0.23	a3= 0.69
SUBBASE: EXISTING AGGREGATE BASE COURSE	12 @ 0.10	a5= 1.20

PROPOSED D_t TOTAL 3.88

PROPOSED TYPICAL CROSS SECTION
 BELLFLOWER-SAYBROOK RD
 14-00024-06-RS
 STA: 416+46 TO 418+22

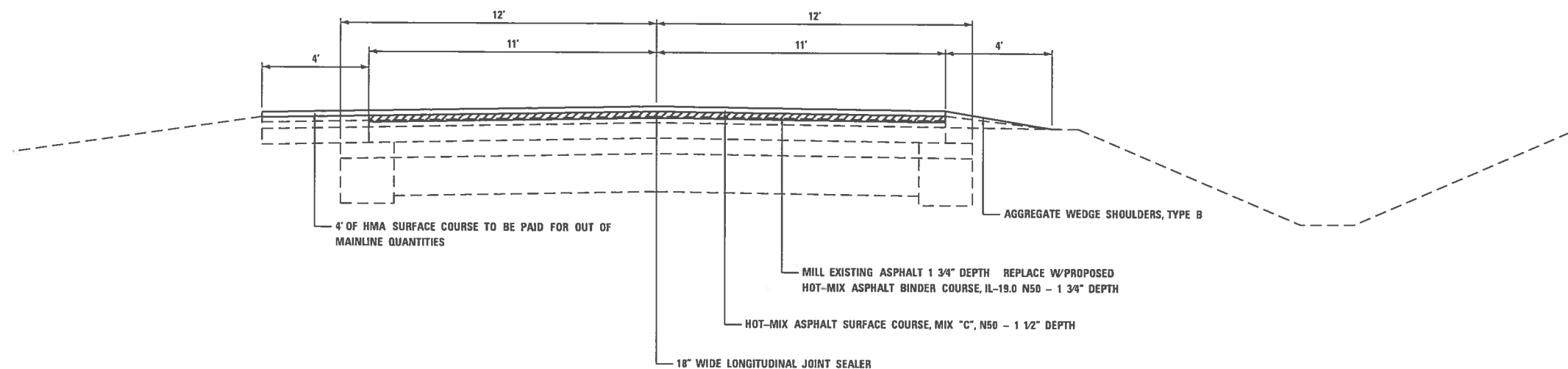

USER NAME = matt.armstrong	DESIGNED =	REVISED =
PLOT SCALE = 1/4" = 100.0000' / ft.	DRAWN =	REVISED =
PLOT DATE = 3/16/2018	CHECKED =	REVISED =
	DATE =	REVISED =

STATE OF ILLINOIS
 DEPARTMENT OF TRANSPORTATION

PROPOSED TYPICAL CROSS SECTIONS

SCALE: NO SCALE SHEET NO. 3 OF 3 SHEETS STA. 415+87 TO STA. 418+22

F.A.S. RTE. 493	SECTION 14-00024-06-RS	COUNTY McLEAN	TOTAL SHEETS 16	SHEET NO. 8
COUNTY HIGHWAY 5			CONTRACT NO. 91560	
FED. ROAD DIST. NO. 5		ILLINOIS	FED. AID PROJECT	

TYPICAL RURAL PRIVATE ENTRANCE

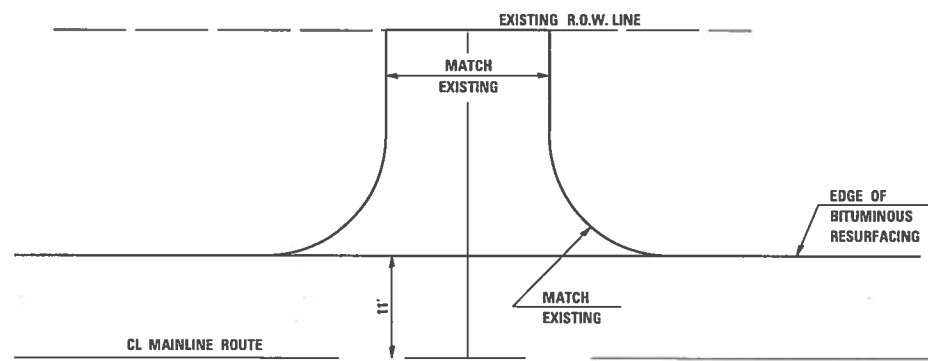

PLAN A

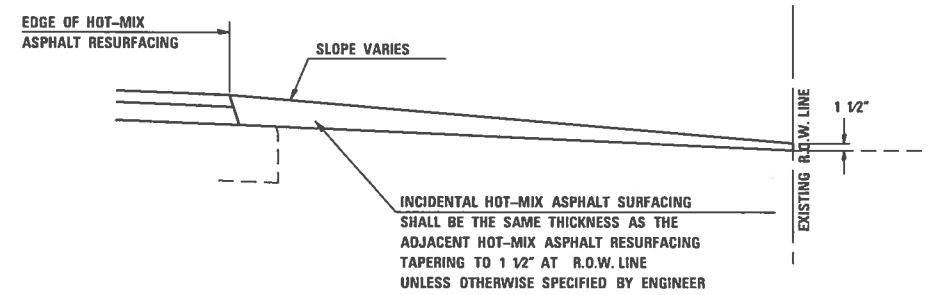

PROFILE A

TYPICAL FIELD ENTRANCE
13.8 SQ YDS (TYP.)

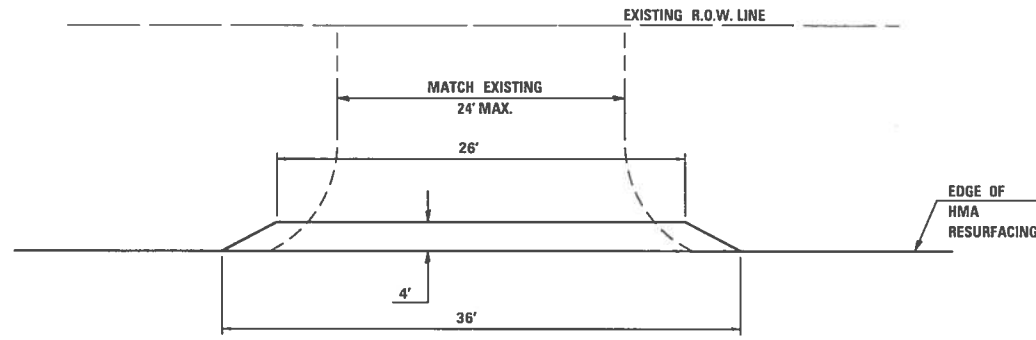

PLAN B

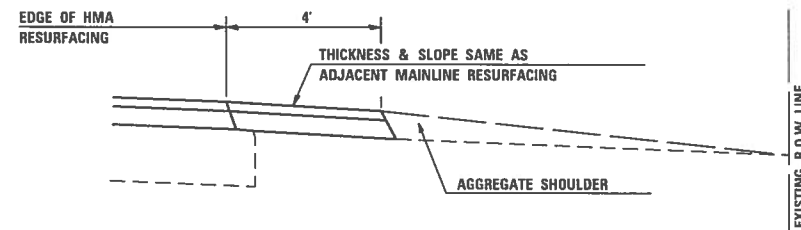

PROFILE B

TYPICAL RURAL MAILBOX TURNOUT
41 SQ YD EACH (TYP.)

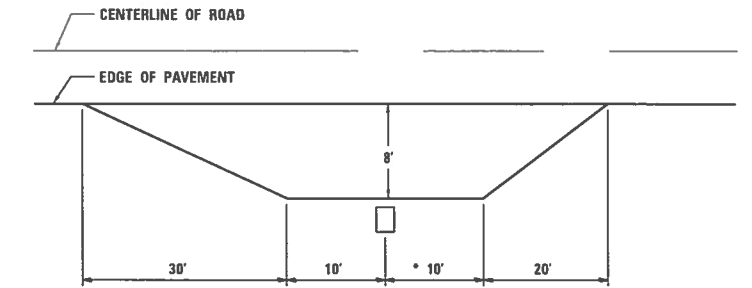

NOTE: * MULTIPLE MAILBOX CLUSTERS TO BE EXTENDED 2' FOR EACH ADDITIONAL MAILBOX

PLAN C

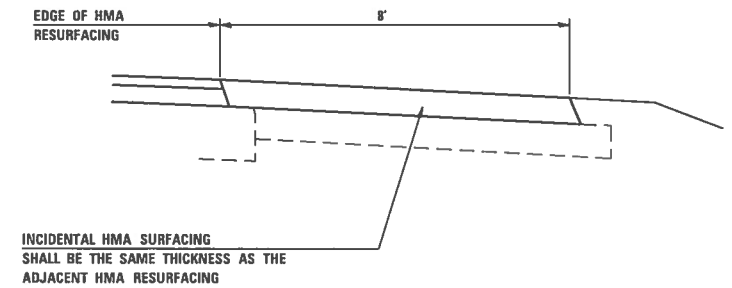

PROFILE C

TYPICAL SIDE ROAD DETAIL

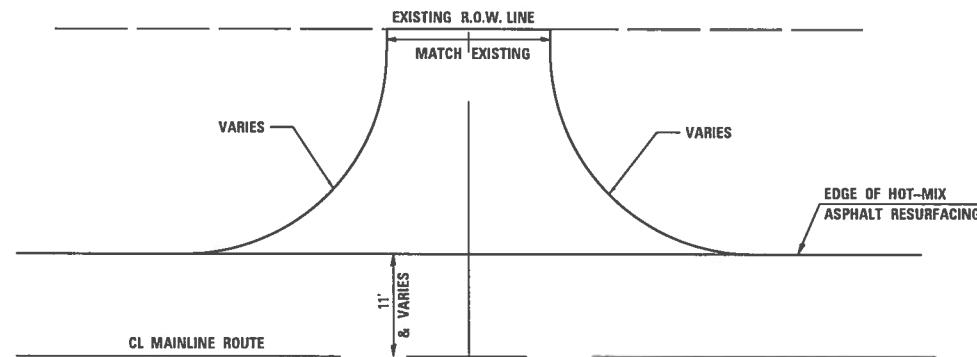

PLAN D

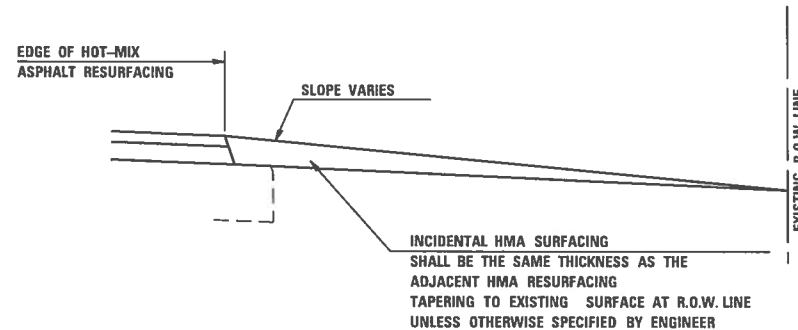

PROFILE D

TYPICAL URBAN MAILBOX TURNOUT
17 SQ YD EACH (TYP.)

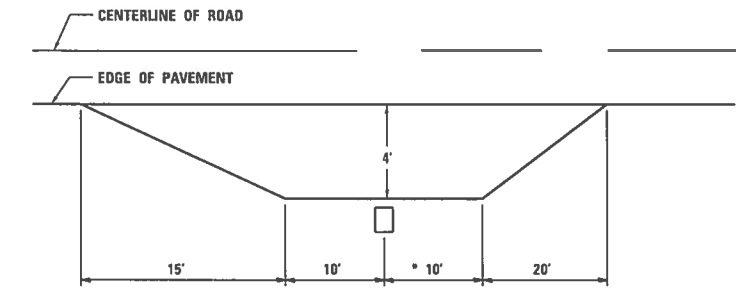

NOTE: * MULTIPLE MAILBOX CLUSTERS TO BE EXTENDED 2' FOR EACH ADDITIONAL MAILBOX

PLAN E

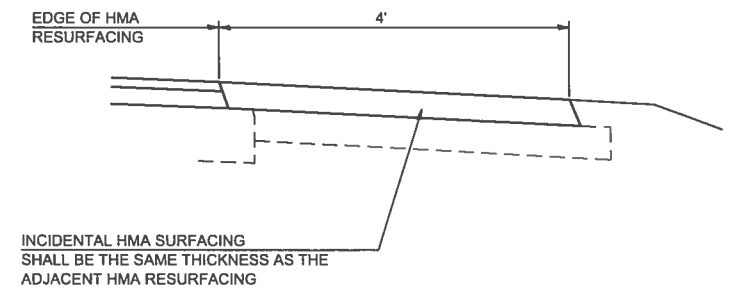

PROFILE E

NOTES:

1. ALL TEMPORARY & PERMANENT PAVEMENT STRIPING WILL BE DONE BY OTHERS.
2. ALL FIELD ENTRANCES SHALL BE CONSTRUCTED WITH THE EXTENDABLE SCREED WIDENER AND PAID FROM HOT-MIX ASPHALT BINDER AND SURFACE COURSES.
3. ALL SIDE ROAD RETURNS, PRIVATE ENTRANCES, COMMERCIAL ENTRANCES AND RURAL MAILBOX TURNOUTS ARE TO BE CONSTRUCTED AND PAID FROM INCIDENTAL HOT-MIX ASPHALT SURFACING.
4. AGGREGATE SHOULDERS SHALL BE PLACED ALONG ALL SIDEROAD RETURN RADII AND SHALL BE PLACED ALONG AND BEHIND ALL FIELD ENTRANCES, GUADRIL AND GUADRIL RUNOUTS, MAILBOX TURNOUTS AND ALL PRIVATE AND COMMERCIAL ENTRANCES UNLESS SPECIFIED BY THE RESIDENT ENGINEER.

USER NAME = mac.ernstrom	DESIGNED --	REVISED --
DRAWN -- MRA	REVISED --	REVISED --
CHECKED --	REVISED --	REVISED --
DATE --	REVISED --	REVISED --

STATE OF ILLINOIS
DEPARTMENT OF TRANSPORTATION

TYPICAL DETAILS

SCALE: SHEET NO. 1 OF 2 SHEETS STA. 102+92 TO STA. 418+22

F.A.S. RTE. 493	SECTION 14-00024-06-RS	COUNTY McLEAN	TOTAL SHEETS 16	SHEET NO. 9
COUNTY HIGHWAY 5		CONTRACT NO. 91560		
FED. ROAD DIST. NO. 5	ILLINOIS	FED. AID PROJECT		

MILLING TRANSITION DETAIL

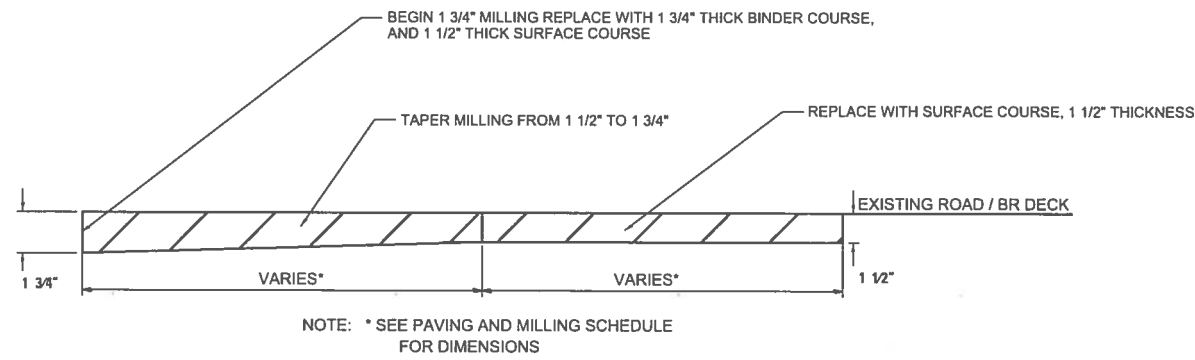

PROFILE E

PAVING AND MILLING SCHEDULE			
1-3/4" MILLING	1-1/2" MILLING	1-3/4" BINDER	1-1/2" SURFACE
103+42 - 381+25	(RR)102+92 - 103+42	103+42 - 381+25	(RR)102+92 - 382+80(BR)
385+89 - 413+15	381+25 - 382+80(BR)	385+89 - 412+65	(BR)384+34 - 413+15(RR)
413+70 - 417+72	(BR)384+34 - 385+89	413+70 - 417+72	(RR)413+20 - 418+22
	412+65 - 413+15(RR)		
	(RR)413+20 - 413+70		
	417+72 - 418+22(Lincoln St)		

SIDEWALK REMOVAL AND REPLACEMENT				
LOCATION	REMOVAL	REPLACEMENT	Det. Warning	WORK NEEDED
Kleinbeck N/W	100 SF	none		
Kleinbeck N/E	160 SF	none		
Melvin N/W	100 SF	125 SF	8 SF	
Melvin N/E	75 SF	75 SF	16 SF	curb cut/asphalt removal
Melvin S/E	160 SF	200 SF	16 SF	
Melvin S/W	5 SF	0		saw cut existing SW
Center N/W	32 SF	40 SF	8 SF	
Center S/W	36 SF	36	8 SF	saw cut existing SW

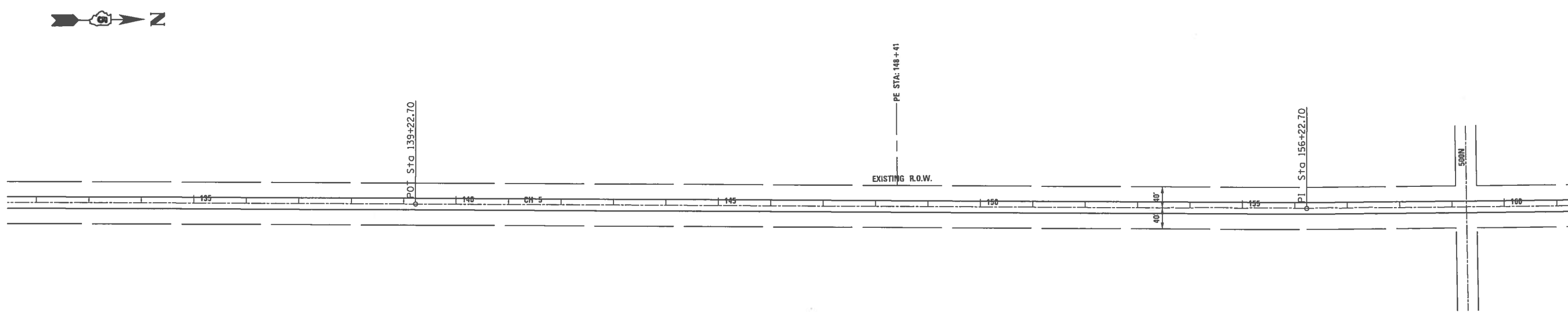
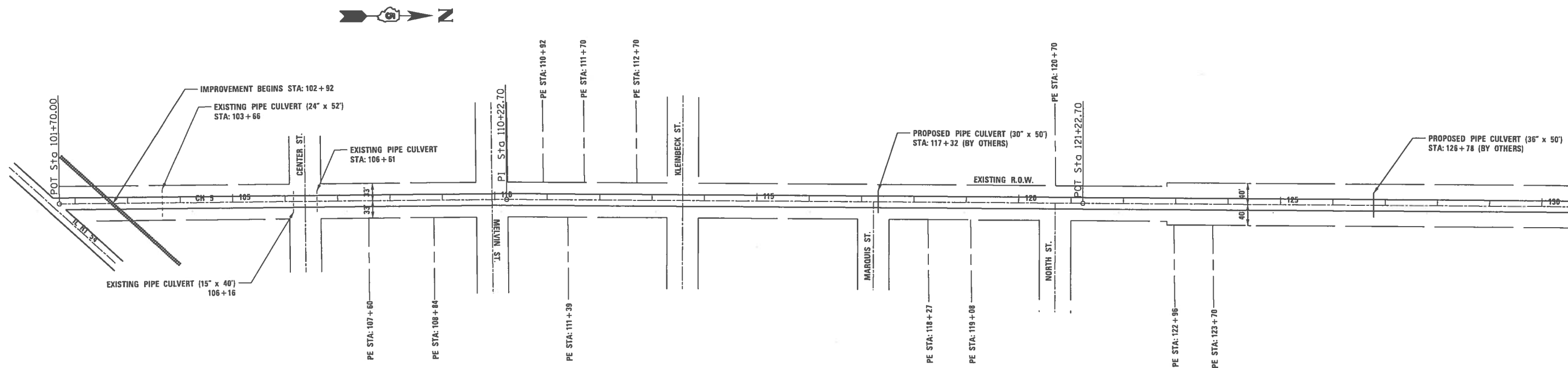

USER NAME = <u>matl.armstrong</u> PLOT SCALE = <u>200.0000 /in.</u> PLOT DATE = <u>3/19/2011</u>	DESIGNED -- _____ DRAWN -- _____ CHECKED -- _____ DATE -- _____	REVISED -- _____ REVISED -- _____ REVISED -- _____ REVISED -- _____	STATE OF ILLINOIS DEPARTMENT OF TRANSPORTATION	Bellflower-Saybrook Rd Plan		F.A.S. RTE. <u>493</u> SECTION <u>14-00024-05-RS</u> COUNTY HIGHWAY <u>5</u>	COUNTY <u>McLEAN</u> TOTAL SHEETS <u>16</u> SHEET NO. <u>11</u>	CONTRACT NO. <u>91560</u> <small>FED. ROAD DIST. NO. 5 ILLINOIS FED. AID PROJECT</small>
	SCALE: 1" = 100' SHEET 1 OF 6 SHEETS STA. 101+70 TO STA. 162+20							

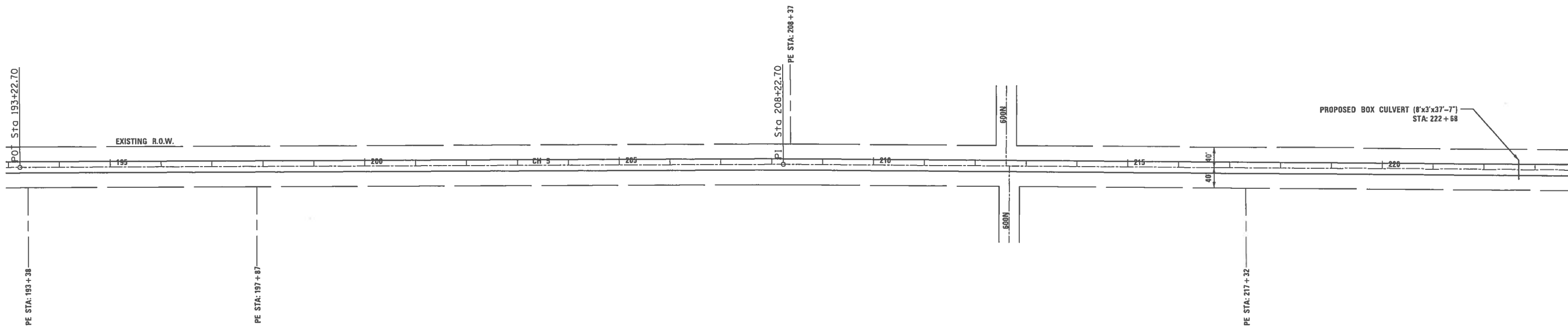
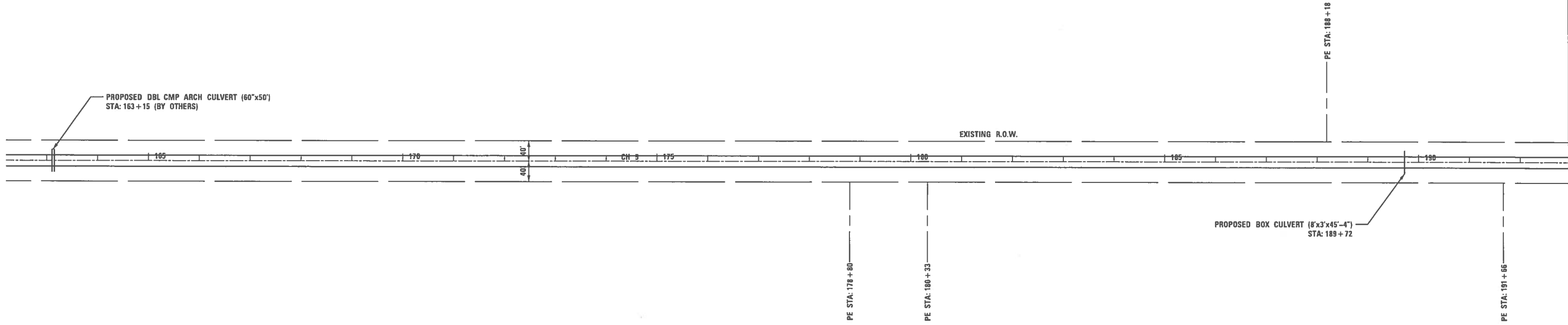

USER NAME	= msdell, or msdell@eng	DESIGNED	-	REVISED	-
DRAWN	-	CHECKED	-	REVISED	-
DATE	-	DATE	-	REVISED	-

**STATE OF ILLINOIS
DEPARTMENT OF TRANSPORTATION**

Bellflower-Saybrook Rd Plan

SCALE: 1" = 100' SHEET 2 OF 6 SHEETS STA. 162+20 TO STA. 223+70

F.A.S. RTE.	SECTION	COUNTY	TOTAL SHEETS	SHEET NO.
493	14-00024-06-RS	McLEAN	16	12
COUNTY HIGHWAY 5		CONTRACT NO. 91560		
FED. ROAD DIST. NO. 5		ILLINOIS FED. AID PROJECT		

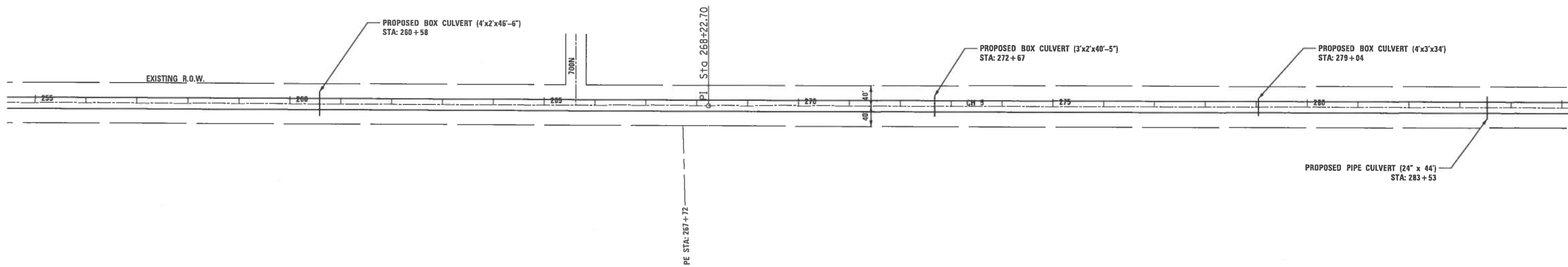
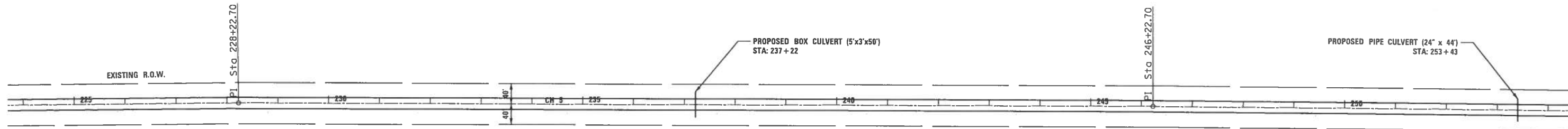

USER NAME = matt.tremstrong	DESIGNED - _____	REVISED - _____
PLOT SCALE = 200.0000 / in.	DRAWN - _____	REVISED - _____
PLOT DATE = 3/16/2018	CHECKED - _____	REVISED - _____
	DATE - _____	REVISED - _____

**STATE OF ILLINOIS
DEPARTMENT OF TRANSPORTATION**

Bellflower-Saybrook Rd Plan

SCALE: 1" = 100' SHEET 3 OF 6 SHEETS STA. 223+70 TO STA. 285+00

F.A.S. RTE. 493	SECTION 14-00024-06-RS	COUNTY McLEAN	TOTAL SHEETS 16	SHEET NO. 13
COUNTY HIGHWAY 5			CONTRACT NO. 91560	
FED. ROAD DIST. NO. 5		ILLINOIS	FED. AID PROJECT	

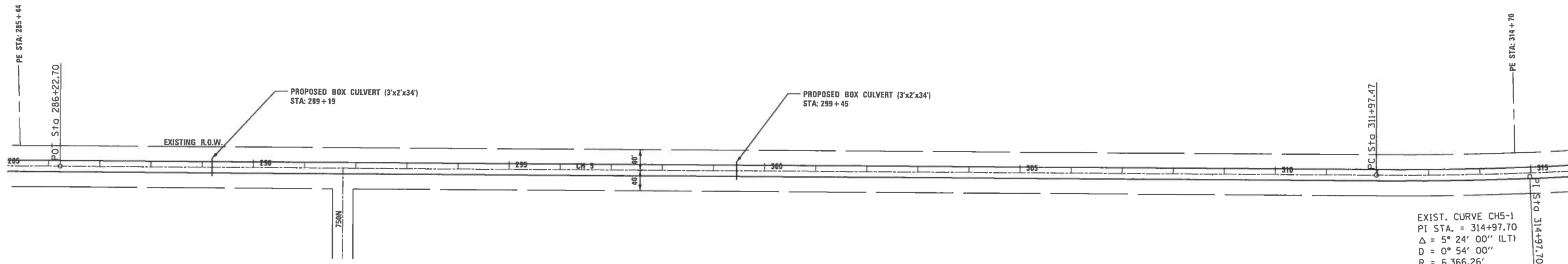

EXIST. CURVE CH5-1
 PI STA. = 314+97.70
 $\Delta = 5^\circ 24' 00''$ (LT)
 $D = 0^\circ 54' 00''$
 $R = 6,366.26'$
 $T = 300.23'$
 $L = 600.01'$
 $E = 7.08'$
 $e = \text{-----}$
 $T.R. = \text{-----}$
 $S.E. \text{ RUN} = \text{-----}$
 $P.C. \text{ STA.} = 311+97.47$
 $P.T. \text{ STA.} = 317+97.49$

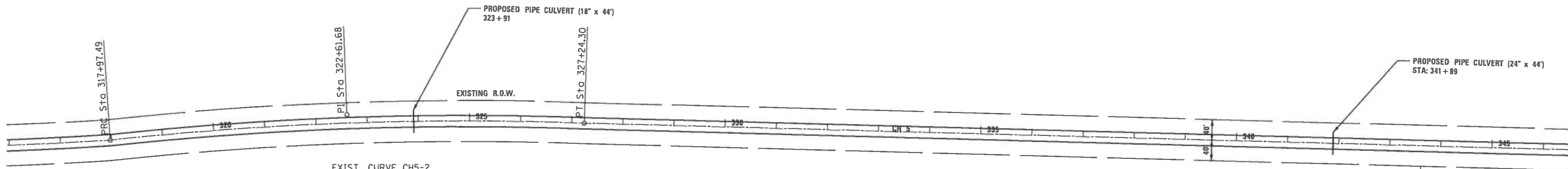

EXIST. CURVE CH5-2
 PI STA. = 322+61.68
 $\Delta = 8^\circ 11' 12''$ (RT)
 $D = 0^\circ 53' 00''$
 $R = 6,486.38'$
 $T = 464.20'$
 $L = 926.82'$
 $E = 16.59'$
 $e = \text{-----}$
 $T.R. = \text{-----}$
 $S.E. \text{ RUN} = \text{-----}$
 $P.C. \text{ STA.} = 317+97.49$
 $P.T. \text{ STA.} = 327+24.30$

USER NAME = matt.armstrong	DESIGNED -	REVISED -	STATE OF ILLINOIS DEPARTMENT OF TRANSPORTATION	Bellflower-Saybrook Rd Plan		F.A.S. RTE. = 493	SECTION = 14-00024-05-RS	COUNTY = McLEAN	TOTAL SHEETS = 16	SHEET NO. = 14		
PLOT SCALE = 200.0000 /in.	DRAWN -	REVISED -				SCALE: 1" = 100'		SHEET 4 OF 6 SHEETS		STA. 285+00 TO STA. 346+72		CONTRACT NO. 91560
PLOT DATE = 5/16/2018	CHECKED -	REVISED -				FED. ROAD DIST. NO. 5		ILLINOIS		FED. AID PROJECT		

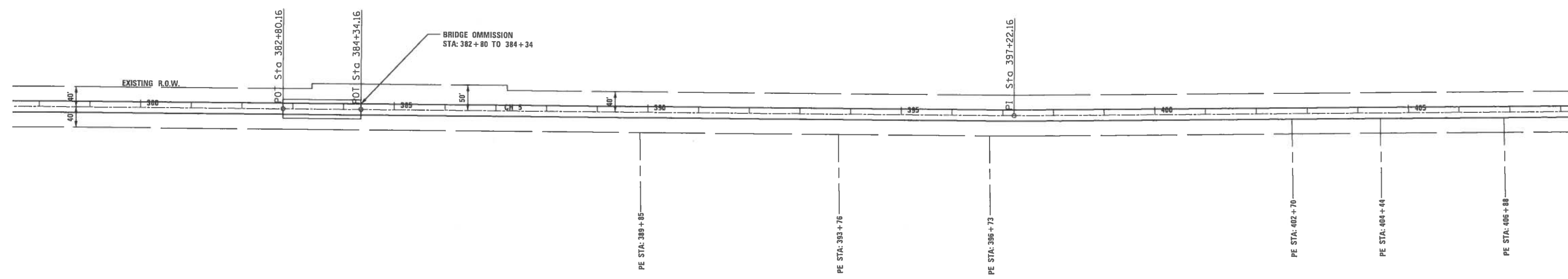
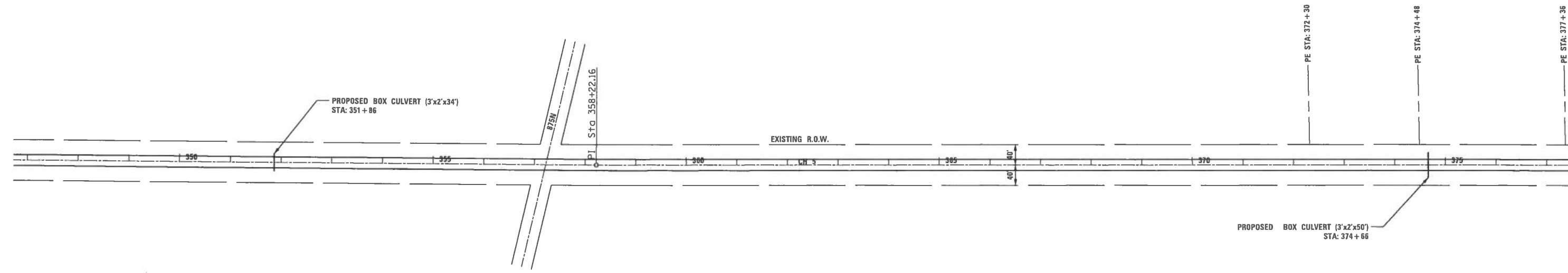

USER NAME = matt.westring PLOT SCALE = 200.0000 /in. PLOT DATE = 3/6/2018	DESIGNED - _____	REVISED - _____	STATE OF ILLINOIS DEPARTMENT OF TRANSPORTATION	Bellflower-Saybrook Rd Plan			F.A.S. RTE. 493	SECTION 14-00024-06-RS	COUNTY McLEAN	TOTAL SHEETS 16	SHEET NO. 15
	DRAWN - _____	REVISED - _____		SCALE: 1" = 100' SHEET 5 OF 6 SHEETS STA. 346+72 TO STA. 408+23			COUNTY HIGHWAY 5 CONTRACT NO. 91560				
	CHECKED - _____	REVISED - _____		FED. ROAD DIST. NO. 5 ILLINOIS FED. AID PROJECT							
DATE - _____	REVISED - _____										

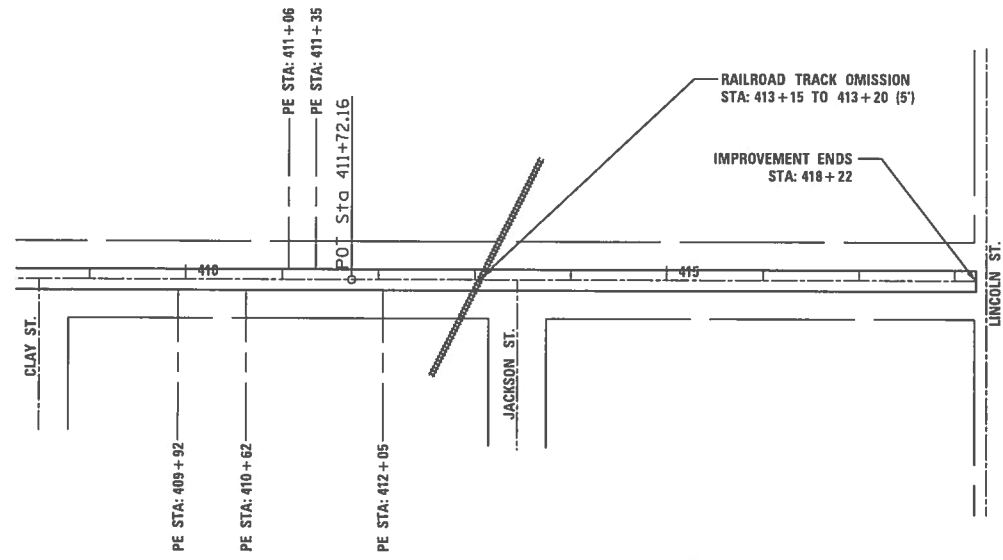

USER NAME = matt.armstrong PLOT SCALE = 200.0000 /in. PLOT DATE = 31/12/2018	DESIGNED - _____	REVISED - _____	STATE OF ILLINOIS DEPARTMENT OF TRANSPORTATION	Bellflower-Saybrook Rd Plan		F.A.S. RTE. 493	SECTION 14-00024-06-RS	COUNTY McLEAN	TOTAL SHEETS 16	SHEET NO. 16
	DRAWN - _____	REVISED - _____		SCALE: _____ SHEET 6 OF 6 SHEETS STA. 408+23 TO STA. 418+22		COUNTY HIGHWAY 5		CONTRACT NO. 91560		
	CHECKED - _____	REVISED - _____				FED. ROAD DIST. NO. 5 ILLINOIS		FED. AID PROJECT		
DATE - _____	REVISED - _____									