

06-15-2018 LETTING ITEM 194

STATE OF ILLINOIS  
DEPARTMENT OF TRANSPORTATION

F.A.P. R.T.E.	SECTION	COUNTY	TOTAL SHEETS	SHEET NO.
320	D7 HMA RESURF. 2018-2	MOULTRIE	11	1
ILLINOIS			CONTRACT NO. 74864	

FOR INDEX OF SHEETS, SEE SHEET NO. 2

ADT = 5200 (2017)

SN 017-0002 OMISSION:  
STA. 397+06.75 TO STA. 401+67.75

# PROPOSED HIGHWAY PLANS

F.A.P. ROUTE 320 (IL 121)  
SECTION D7 HMA RESURF 2018-2

RESURFACING (SMART)  
MOULTRIE COUNTY

C-97-098-18

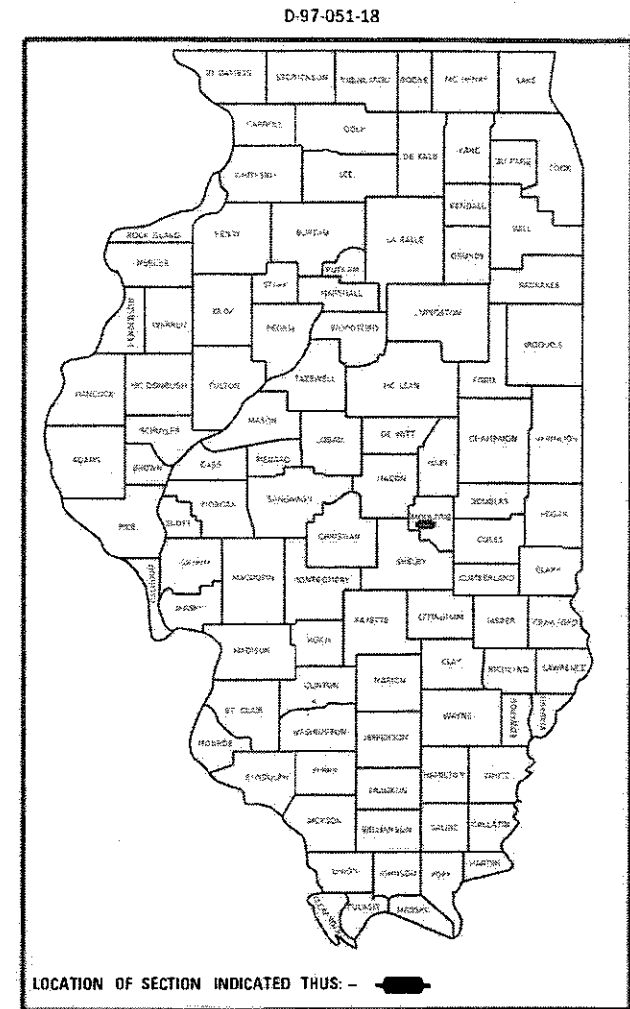

FAP 320 (IL 121)  
PROJECT BEGINS: STA. 377+00  
PROJECT ENDS: STA. 420+60

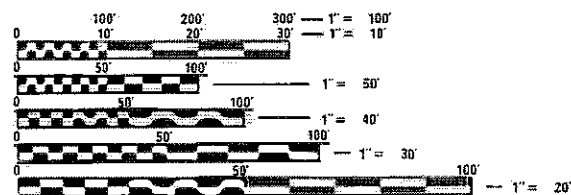
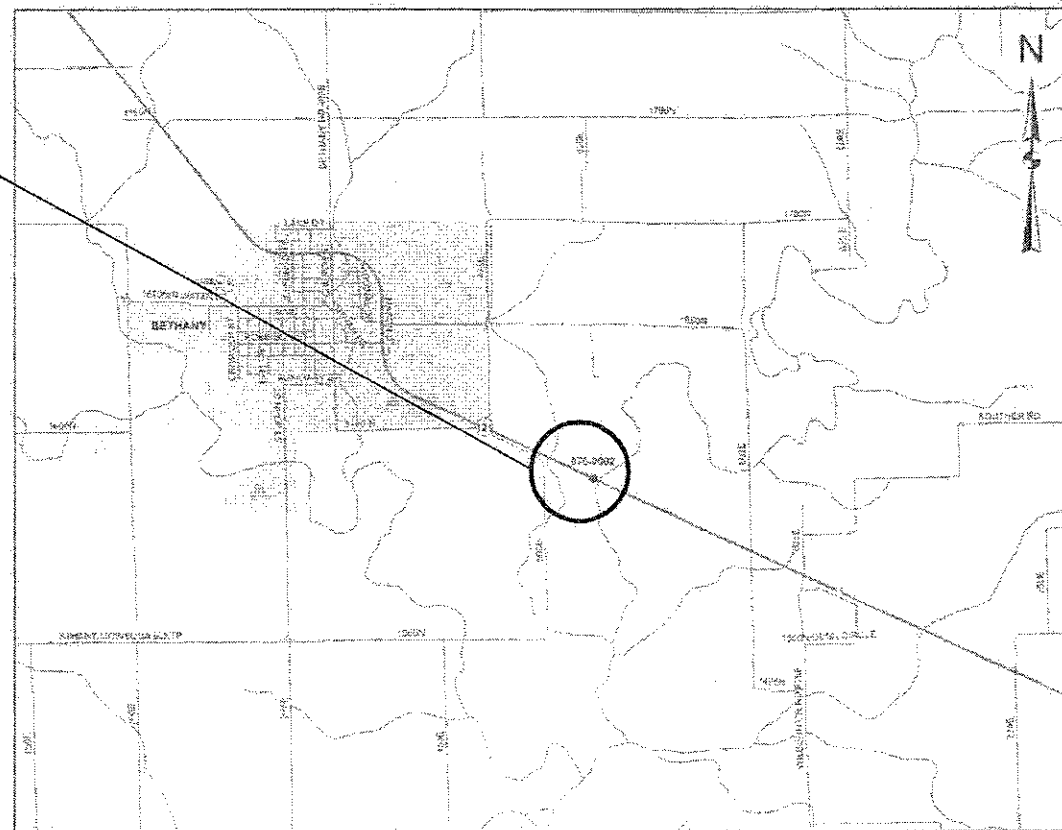

FULL SIZE PLANS HAVE BEEN PREPARED USING STANDARD ENGINEERING SCALES. REDUCED SIZED PLANS WILL NOT CONFORM TO STANDARD SCALES. IN MAKING MEASUREMENTS ON REDUCED PLANS, THE ABOVE SCALES MAY BE USED.

J.U.L.I.E.  
JOINT UTILITY LOCATION INFORMATION FOR EXCAVATION  
1-800-892-0123  
OR 811

PROJECT ENGINEER: TOM RONAN  
PROJECT MANAGER: KALEB HIRTZEL

CONTRACT NO. 74864

GROSS LENGTH = 4,360 FT. = 0.826 MILE  
NET LENGTH = 3,899 FT. = 0.738 MILE

STATE OF ILLINOIS  
DEPARTMENT OF TRANSPORTATION

SUBMITTED May 04 20 18  
Jeffrey A. South  
REGIONAL ENGINEER

May 11 20 18  
EA ETC  
ENGINEER OF DESIGN AND ENVIRONMENT

May 10 20 18  
Paul P. [Signature]  
DIRECTOR OF HIGHWAYS PROJECT IMPLEMENTATION

PRINTED BY THE AUTHORITY  
OF THE STATE OF ILLINOIS

## INDEX OF SHEETS

SHEET NO.	ITEM
1	COVER SHEET
2	INDEX OF SHEETS, HIGHWAY STANDARDS & GENERAL NOTES
3	SUMMARY OF QUANTITIES
4	TYPICAL CROSS SECTIONS
5	SCHEDULE OF QUANTITIES
6-7	PLAN SHEETS
8-11	PAVEMENT MARKING DETAILS

THE FOLLOWING STANDARDS ARE A PART OF THESE PLANS AND ARE INCLUDED FOLLOWING THE LAST NUMBERED SHEET OF THE PLANS.

STD. NO.	DESCRIPTION
000001-06	STANDARD SYMBOLS, ABBREVIATIONS, AND PATTERNS
001006	DECIMAL OF AN INCH AND OF A FOOT
442201-03	CLASS C AND D PATCHES
667101-02	PERMANENT SURVEY MARKERS
701006-05	OFF-ROAD OPERATIONS, 2L, 2W, 15' TO 24" FROM PAVEMENT EDGE
701011-04	OFF-ROAD MOVING OPERATIONS, 2L, 2W, DAY ONLY
701201-04	LANE CLOSURE, 2L, 2W, DAY ONLY, FOR SPEEDS >= 45MPH
701301-04	LANE CLOSURE, 2L, 2W, SHORT TIME OPERATIONS
701306-04	LANE CLOSURE, 2L, 2W, SLOW MOVING OPERATIONS DAY ONLY, FOR SPEEDS >= 45MPH
701311-03	LANE CLOSURE, 2L, 2W, MOVING OPERATIONS - DAY ONLY
701901-07	TRAFFIC CONTROL DEVICES
780001-05	TYPICAL PAVEMENT MARKINGS
781001-04	TYPICAL APPLICATION RAISED REFLECTIVE PAVEMENT MARKERS

## GENERAL NOTES

THIS PROJECT IS LOCATED ON FAP 320 (IL 121) IN MOULTRIE COUNTY AND EXTENDS FROM 0.4 MILES WEST OF THE WEST OKAW RIVER (SN 070-0002) TO 0.4 MILES EAST OF THE WEST OKAW RIVER. THE WORK INCLUDED IN THIS SECTION CONSISTS OF PAVEMENT PATCHING, MILLING, OVERLAYING WITH HOT-MIX ASPHALT SURFACE COURSE, AGGREGATE WEDGE SHOULDERS, PAVEMENT MARKING AND ANY OTHER WORK NECESSARY TO COMPLETE THIS SECTION.

THE MATERIAL USED FOR AGGREGATE WEDGE SHOULDERS, TYPE B SHALL BE CRUSHED STONE, CRUSHED CONCRETE OR RAP.

WHEN APPLYING SHORT TERM PAVEMENT MARKINGS, TEMPORARY TAPE SHALL BE USED ON THE SURFACE COURSE AND PAINT SHALL BE USED ON MILLED SURFACES.

THE CONTRACTOR SHALL PROVIDE INTERNET ACCESSIBILITY TO THE HOT-MIX ASPHALT PLANT QUALITY CONTROL LAB SO THAT HOT-MIX ASPHALT PLANT REPORTS CAN BE E-MAILED TO THE DISTRICT HEADQUARTERS. THIS WORK SHALL BE INCLUDED IN THE COST OF ALL HOT-MIX ASPHALT ITEMS.

THE FOLLOWING MIXTURE REQUIREMENTS ARE APPLICABLE FOR THIS PROJECT:

APPLICATION	AC/PG	DESIGN AIR VOIDS	MIXTURE COMPOSITION	FRICTION AGGREGATE	QUALITY MANAGEMENT
HMA SURFACE COURSE, MIX "D", N90 (1 1/2")	PG 64-22	4.0% @ N=90	IL - 9.5	MIXTURE D	QC/OA
CLASS "D" PATCHING	PG 64-22	4.0% @ N=90	IL - 19.0	N/A	QC/OA

THE FOLLOWING RATES OF APPLICATION HAVE BEEN USED IN THE CALCULATING PLAN QUANTITIES:

AGGREGATE SHOULDERS	2.05 TONS/CU YD
HOT-MIX ASPHALT	112 LBS/SQ YD/INCH

MODEL: Default  
 FILE NAME: P:\1108\B&E\BIDD\TEC\Illinois\gov\PI\DOT\Documents\BIDD\Office\BIDD\TCT 7\Projects\74864\CADD\B&E\PC\gennots.dgn

USER NAME = steffenmk	DESIGNED -	REVISED -
	DRAWN -	REVISED -
PLOT SCALE = 100.0000' / in.	CHECKED -	REVISED -
PLOT DATE = 5/4/2018	DATE -	REVISED -

**STATE OF ILLINOIS  
DEPARTMENT OF TRANSPORTATION**

**INDEX OF SHEETS, HIGHWAY STANDARDS  
& GENERAL NOTES**

SCALE: SHEET 1 OF 1 SHEETS STA. TO STA.

F.A.P. RTE.	SECTION	COUNTY	TOTAL SHEETS	SHEET NO.
320	D7 HMS RESURF 2018-2	MOULTRIE	11	2
CONTRACT NO. 74864				
ILLINOIS FED. AID PROJECT				



TYPICAL CROSS SECTION IL 121

STATION TO STATION  
377+00 379+00

 HOT-MIX ASPHALT SURFACE REMOVAL, 1 1/2"

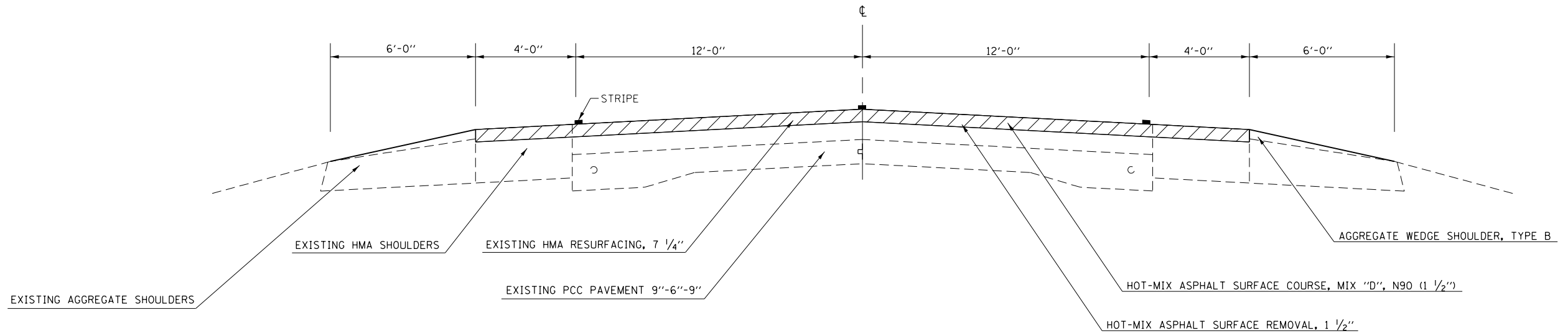

TYPICAL CROSS SECTION IL 121

STATION TO STATION  
379+00.00 397+06.75  
397+06.75 401+67.75 BRIDGE OMISSION  
401+67.75 420+60.00

 HOT-MIX ASPHALT SURFACE REMOVAL, 1 1/2"

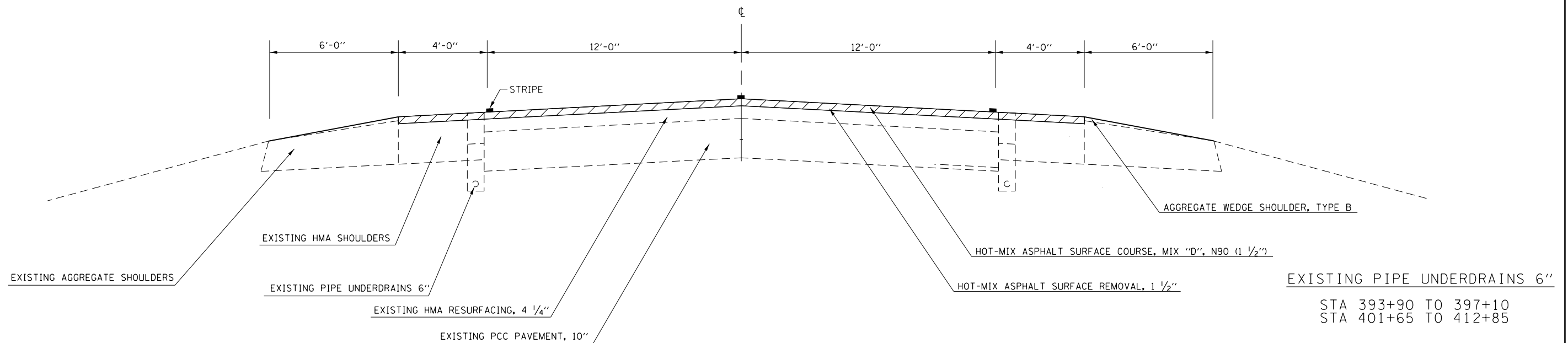

EXISTING PIPE UNDERDRAINS 6"  
STA 393+90 TO 397+10  
STA 401+65 TO 412+85

MODEL: Default  
FILE: \\mhc-pw\ulb\BEBID\NTEC\Illinois\pwr\pwr\DOT\Documents\DOT Office\Drawings\Project\74864\CADD\Drawings\74864-11-11-11.dgn

USER NAME = steffemk	DESIGNED -	REVISED -
	DRAWN -	REVISED -
PLOT SCALE = 100.0000' / in.	CHECKED -	REVISED -
PLOT DATE = 5/4/2018	DATE -	REVISED -

STATE OF ILLINOIS  
DEPARTMENT OF TRANSPORTATION

TYPICAL CROSS SECTIONS

SCALE: SHEET 1 OF 1 SHEETS STA. TO STA.

F.A.P. RTE.	SECTION	COUNTY	TOTAL SHEETS	SHEET NO.
320	D7 HMS RESURF 2018-2	MOULTRIE	11	4
ILLINOIS FED. AID PROJECT			CONTRACT NO. 74864	

PATCHING SCHEDULE IL 121							
STATION	LANE	LENGTH FEET	WIDTH FEET	CLASS D PATCHES, TYPE I, 14 INCH SQ YD	CLASS D PATCHES, TYPE II, 14 INCH SQ YD	CLASS D PATCHES, TYPE III, 14 INCH SQ YD	CLASS D PATCHES, TYPE IV, 14 INCH SQ YD
381+20	SB	4	12	-	5.3	-	-
381+30	SB EOP	6	6	4.0	-	-	-
381+30	NB EOP	6	6	4.0	-	-	-
386+45	SB	6	12	-	8.0	-	-
386+90	NB	10	12	-	13.3	-	-
387+00	NB EOP	8	6	-	5.3	-	-
387+45	NB EOP	12	6	-	8.0	-	-
388+10	NB EOP	6	6	4.0	-	-	-
388+80	NB EOP	6	6	4.0	-	-	-
388+80	SB EOP	6	6	4.0	-	-	-
388+90	NB EOP	6	6	4.0	-	-	-
389+80	SB EOP	10	6	-	6.7	-	-
390+20	NB EOP	8	6	-	5.3	-	-
390+30	NB	10	12	-	13.3	-	-
390+30	SB	6	12	-	8.0	-	-
392+70	SB EOP	6	6	4.0	-	-	-
394+10	SB	4	12	-	5.3	-	-
394+10	NB	4	12	-	5.3	-	-
395+75	NB	8	12	-	10.7	-	-
395+75	SB	4	12	-	5.3	-	-
396+25	NB	10	12	-	13.3	-	-
396+30	NB EOP	10	6	-	6.7	-	-
404+40	SB	6	12	-	8.0	-	-
404+45	SB EOP	60	6	-	-	-	40.0
405+05	SB	10	12	-	13.3	-	-
405+90	SB	15	12	-	-	20.0	-
406+00	NB	125	12	-	-	-	166.7
406+45	SB EOP	20	6	-	13.3	-	-
407+15	NB	35	12	-	-	-	46.7
407+85	SB EOP	16	6	-	10.7	-	-
408+00	NB	15	12	-	-	20.0	-
408+80	SB EOP	10	6	-	6.7	-	-
408+80	NB	20	12	-	-	-	26.7
409+10	NB EOP	15	6	-	10.0	-	-
TOTALS:				28	182	40	280

RESURFACING SCHEDULE										
STATION	TO	STATION	LENGTH FOOT	WIDTH FOOT	AREA SQ YD	TEMPORARY RAMP SQ YD	HOT-MIX ASPHALT SURFACE REMOVAL, 1 1/2" SQ YD	BITUMINOUS MATERIALS (TACK COAT) POUND	HOT-MIX ASPHALT SURFACE COURSE, MIX "D", N90 TON	AGGREGATE WEDGE SHOULDER, TYPE B TON
IL 121										
377+00	TO	397+06.75	2006.75	16	3567.6	26.6	7135.1	3210.8	599.3	228.5
397+06.75	TO	401+67.75	461.00	-	-	-	-	-	-	-
401+67.75	TO	420+60	1892.25	16	3364.0	26.6	6728.0	3027.6	565.2	215.5
PROJECT TOTALS:			4360.0	-	6932	53	13863	6239	1165	444

PAVEMENT MARKING SCHEDULE							
STATION	TO	STATION	LENGTH FOOT	SHORT TERM PAVEMENT MARKING FOOT	SHORT TERM PAVEMENT MARKING REMOVAL SQ FT	PAINT PAVEMENT MARKING - LINE 4" FOOT	RAISED REFLECTIVE PAVEMENT MARKER (TWO-WAY AMBER) EACH
IL 121							
377+00	TO	397+06.75	2006.8	200.7	66.9	4515.2	25.0
397+06.75	TO	401+67.75	461.0	-	-	1037.3	-
401+67.75	TO	420+60	1892.3	189.2	63.1	4257.6	24.0
YELLOW TOTALS:			-	-	-	1090	-
WHITE TOTALS:			-	-	-	8720	-
PROJECT TOTALS:			4360	390	130	9810	49

SURVEY MARKER SCHEDULE					
ROUTE	STATION	OFFSET (FOOT)	SIDE	COMMENT	PROTECTING OR RESETTING SURVEY MARKERS (EACH)
IL 121	391+86	0.0	-	PI - DISK IN VAULT	1
TOTALS:					1

MODEL: Default  
 FILE NAME: P:\IL08\B&E\BID\ITEG\Illinois.gov\PI\DOT\Documents\1\DOT\_Offices\121\121\_0774864-Resurfacing\_Schedule.dgn

USER NAME = steffenmk	DESIGNED -	REVISED -
	DRAWN -	REVISED -
PLOT SCALE = 100,0000' / in.	CHECKED -	REVISED -
PLOT DATE = 5/4/2018	DATE -	REVISED -

**STATE OF ILLINOIS  
DEPARTMENT OF TRANSPORTATION**

SCHEDULE OF QUANTITIES			
SCALE:	SHEET 1	OF 1	SHEETS
STA.	TO STA.		

F.A.P. RTE.	SECTION	COUNTY	TOTAL SHEETS	SHEET NO.
320	D7 HMS RESURF 2018-2	MOULTRIE	11	5
ILLINOIS			FED. AID PROJECT	
			CONTRACT NO. 74864	



PROJECT BEGINS  
STA 377+00

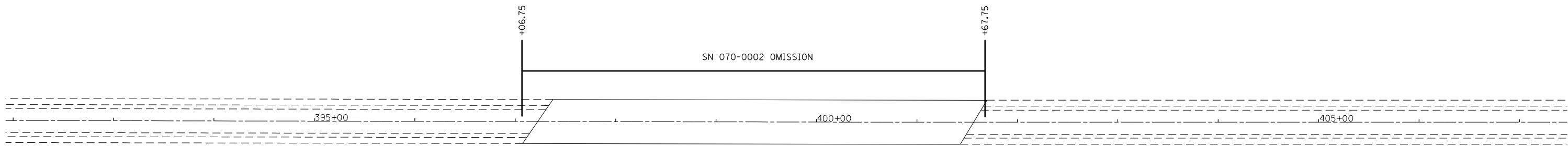
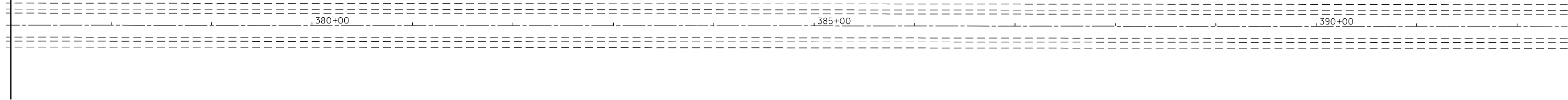

MODEL: Default  
FILE NAME: P:\1108\B&E\BIDD\ITEC\Illinois.gov\PWIDOT\Documents\DOT\_Offices\Director\7\Projects\74864\CADD\Drawings\DOT74864-Plan.dgn

USER NAME = steffenmk	DESIGNED -	REVISED -
	DRAWN -	REVISED -
PLOT SCALE = 100,0000 ' / in.	CHECKED -	REVISED -
PLOT DATE = 5/4/2018	DATE -	REVISED -

**STATE OF ILLINOIS  
DEPARTMENT OF TRANSPORTATION**

**PLAN SHEET**  
SCALE: SHEET 1 OF 2 SHEETS STA. 377+00 TO STA. 407+00

F.A.P. RTE.	SECTION	COUNTY	TOTAL SHEETS	SHEET NO.
320	D7 HMS RESURF 2018-2	MOULTRIE	11	6
CONTRACT NO. 74864			ILLINOIS FED. AID PROJECT	

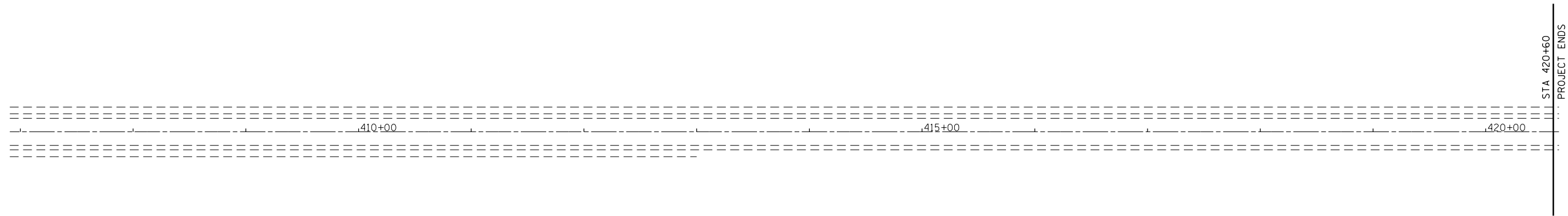

MODEL: Default  
 FILE NAME: P:\IL08\BID\NITEC\Illinois.gov\PIW\DOT\Documents\DOT\_Offices\Director\_7\Projects\74864\CADD\Drawings\CAD\Drawings\74864-PC-plan.dgn

USER NAME = steffenmk	DESIGNED -	REVISED -
	DRAWN -	REVISED -
PLOT SCALE = 100,0000 ' / in.	CHECKED -	REVISED -
PLOT DATE = 5/4/2018	DATE -	REVISED -

**STATE OF ILLINOIS**  
**DEPARTMENT OF TRANSPORTATION**

**PLAN SHEET**

SCALE: SHEET 2 OF 2 SHEETS STA. 407+00 TO STA. 420+60

F.A.P. RTE.	SECTION	COUNTY	TOTAL SHEETS	SHEET NO.
320	D7 HMS RESURF 2018-2	MOULTRIE	11	7
CONTRACT NO. 74864				
ILLINOIS		FED. AID PROJECT		

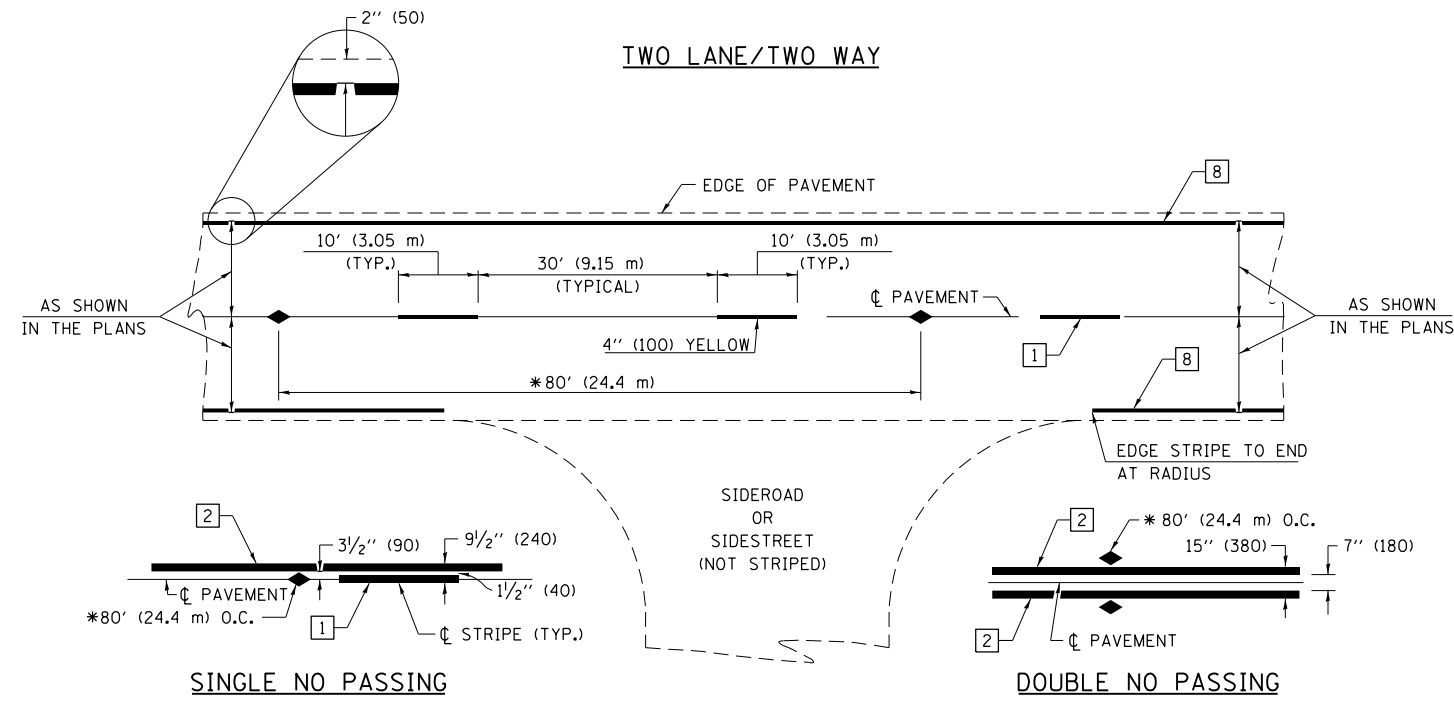

\* REDUCE TO 40' (12.2 m) O.C. ON CURVES WITH POSTED OR ADVISORY SPEEDS OF 45 mph (70 km/h) OR LESS.

PAVEMENT MARKING LEGEND

- 1 4" (100) SKIP-DASH (YELLOW)
- 2 4" (100) SOLID (YELLOW)
- 3 12" (300) DIAGONAL (YELLOW)
- 4 4" (100) DOUBLE YELLOW (NARROW)
- 5 12" (300) SOLID WHITE
- 6 RESERVED
- 7 6" (150) SKIP-DASH (WHITE)
- 8 4" (100) SOLID (WHITE)
- 9 12" (300) DIAGONAL (WHITE)
- 10 6" (150) SOLID (WHITE)
- 11 24" (600) STOP BAR (WHITE)
- 12 8" (200) SOLID (WHITE)
- 13 4" (100) PARKING WHITE

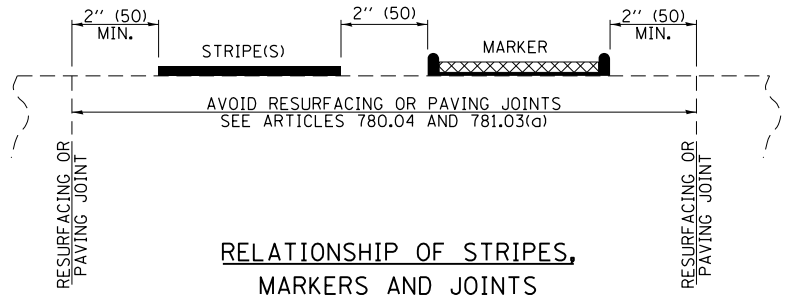

TYPICAL PAVEMENT MARKERS LEGEND

- ◆ TWO-WAY AMBER MARKER
- ▶ ONE-WAY AMBER MARKER
- ▷ ONE-WAY CRYSTAL MARKER

RAISED REFLECTIVE PAVEMENT MARKERS

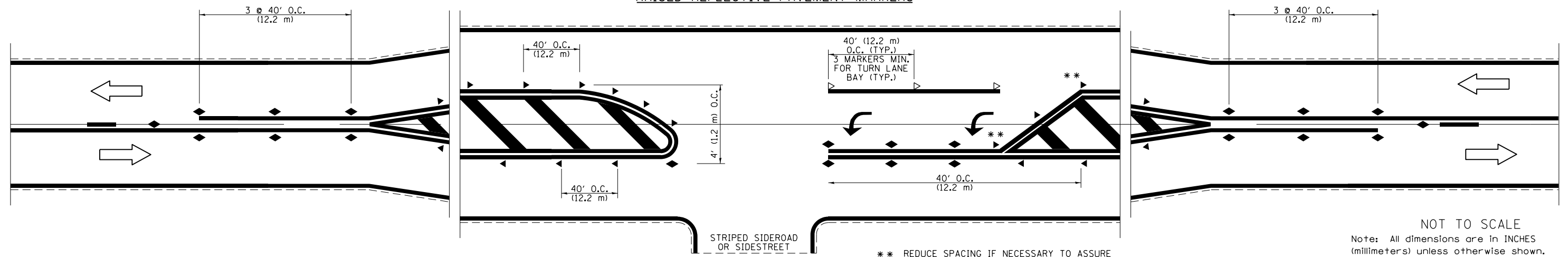

\*\* REDUCE SPACING IF NECESSARY TO ASSURE MARKERS AT CORNER POINTS.

NOT TO SCALE  
Note: All dimensions are in INCHES (millimeters) unless otherwise shown.

FILE NAME =	USER NAME = steffenmk	DESIGNED -	REVISED -	<b>STATE OF ILLINOIS DEPARTMENT OF TRANSPORTATION</b>	<b>PAVEMENT MARKING AND RAISED REFLECTIVE PAVEMENT MARKERS (RURAL &amp; URBAN APPLICATIONS)</b>	F.A.P. R.T.E.	SECTION	COUNTY	TOTAL SHEETS	SHEET NO.	
pw:\IL\084EBIDINTEG\illinois.gov\PIWIDOT\Documents\DOT Offices\District 7\Projects\74864\Drawings\CABsheets\0774864-sht-details.dwg	PLotted SCALE = 2.0000' / in.	CHECKED -	REVISED -			320	D7 HMS RESURF 2018-2	MOULTRIE	11	8	
	PLOT DATE = 5/4/2018	DATE -	REVISED -			SCALE: SHEET NO. 1 OF 4 SHEETS STA. TO STA.		CONTRACT NO. 74864		ILLINOIS FED. AID PROJECT	



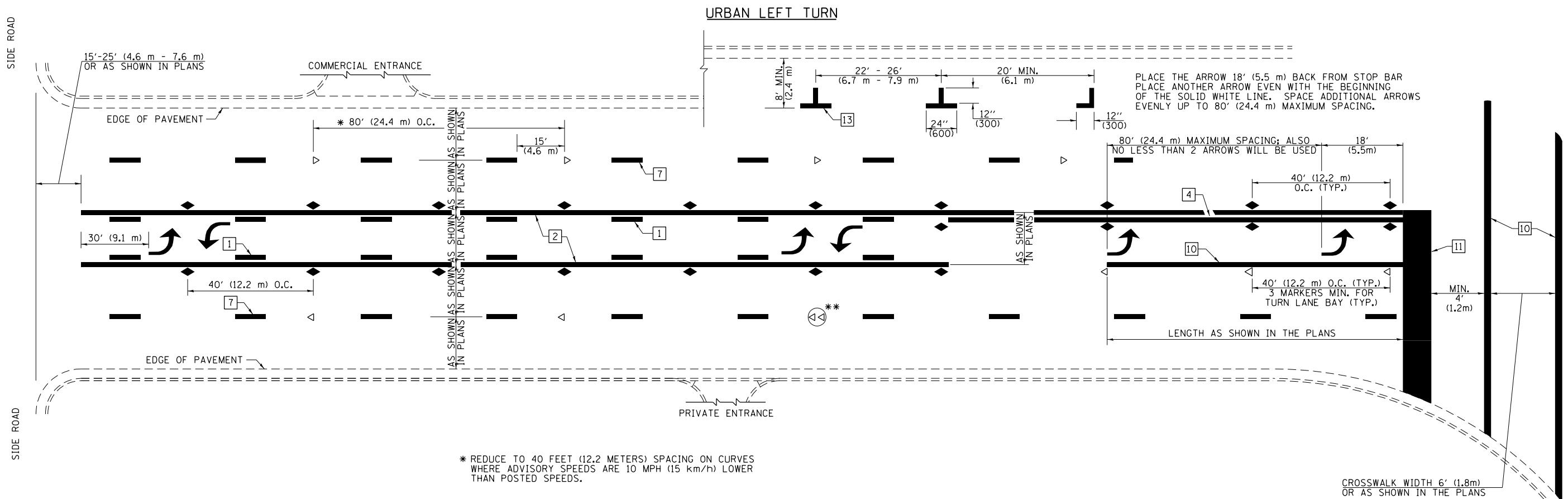

PLACE THE ARROW 18' (5.5 m) BACK FROM STOP BAR  
 PLACE ANOTHER ARROW EVEN WITH THE BEGINNING  
 OF THE SOLID WHITE LINE. SPACE ADDITIONAL ARROWS  
 EVENLY UP TO 80' (24.4 m) MAXIMUM SPACING.

\* REDUCE TO 40 FEET (12.2 METERS) SPACING ON CURVES  
 WHERE ADVISORY SPEEDS ARE 10 MPH (15 km/h) LOWER  
 THAN POSTED SPEEDS.

\*\* DOUBLE LANE LINE MARKERS SHALL BE SPECIFIED  
 AND SPACED AS SHOWN IN HIGHWAY STANDARD  
 781001 FOR MULTI-LANE DIVIDED AND UNDIVIDED  
 HIGHWAYS.

**PAVEMENT MARKING LEGEND**

- 1 4" (100) SKIP-DASH (YELLOW)
- 2 4" (100) SOLID (YELLOW)
- 3 12" (300) DIAGONAL (YELLOW)
- 4 4" (100) DOUBLE YELLOW (NARROW)
- 5 12" (300) SOLID WHITE
- 6 RESERVED
- 7 6" (150) SKIP-DASH (WHITE)
- 8 4" (100) SOLID (WHITE)
- 9 12" (300) DIAGONAL (WHITE)
- 10 6" (150) SOLID (WHITE)
- 11 24" (600) STOP BAR (WHITE)
- 12 8" (200) SOLID (WHITE)
- 13 4" (100) PARKING WHITE

**GENERAL NOTES**

1. TURN ARROW PAIRS SHALL BE PLACED AT 250' (75 m) INTERVALS AND SHALL BE EVENLY SPACED BETWEEN BOTH ENDS OF THE BIDIRECTIONAL LEFT TURN LANE. USE A MINIMUM OF TWO PAIRS PER BLOCK.
2. THE SOLID YELLOW PAVEMENT MARKINGS [2] SHOULD GENERALLY START OR END NEAR THE RADIUS POINT OF EACH STREET RETURN EXCEPT WHERE ONE OR BOTH ENDS WOULD INCLUDE STOP BARS.
3. THE SKIP-DASH PAVEMENT MARKINGS [1] OR [7] SHOULD BE CENTERED BETWEEN BOTH ENDS OF EACH CITY BLOCK AND SHALL BE PLACED SO THEY LINE UP ACROSS FROM EACH OTHER.
4. USE LARGE ARROW SIZE FOR BOTH RURAL AND URBAN LOCATIONS. (SEE LAST PAGE OF SECTION 780x FOR SYMBOLS TABLE)
5. LANE LINE EXTENSIONS SHALL BE THE SAME COLOR AND WIDTH AS THE LANE LINE BEING EXTENDED.

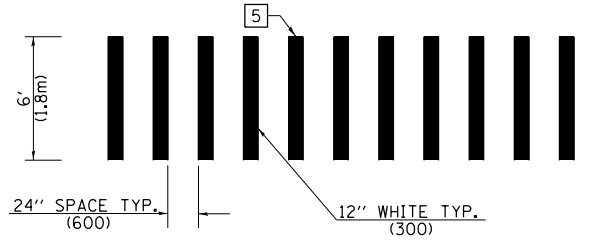

**CROSSWALK DETAIL  
 (DECATUR CITY LIMITS ONLY)**

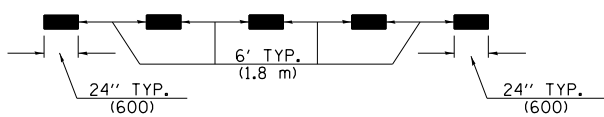

**LANE LINE EXTENSIONS**

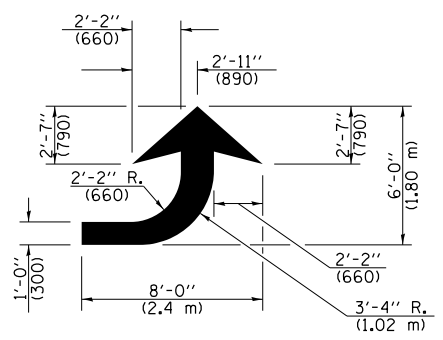

**LEFT ARROW**

REVERSE FOR RIGHT ARROW  
 AREA = 15.6 SQ. FT. (1.47 m<sup>2</sup>)  
 (WHITE)

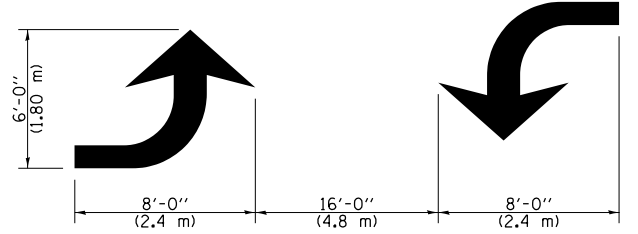

**TYPICAL DOUBLE  
 TURN ARROWS (WHITE)**

NOT TO SCALE

Note: All dimensions are in INCHES (millimeters) unless otherwise shown.

**DISTRICT 7 DETAIL NO. 7800001**

FILE NAME =	USER NAME = steffenmk	DESIGNED -	REVISED -
pw:\11\084EBIDINTEG.illinois.gov\PIWIDOT\Documents\DOT Offices\District 7\Projects\74864\Drawings\CABsheets\0774864-sht-details.dwg		CHECKED -	REVISED -
		DATE -	REVISED -

**STATE OF ILLINOIS  
 DEPARTMENT OF TRANSPORTATION**

**PAVEMENT MARKING AND RAISED REFLECTIVE PAVEMENT MARKERS  
 (RURAL & URBAN APPLICATIONS)**

SCALE: SHEET NO. 2 OF 4 SHEETS STA. TO STA.

F.A.P. RTE.	SECTION	COUNTY	TOTAL SHEETS	SHEET NO.
320	D7 HMS RESURF 2018-2	MOULTRIE	11	9
				CONTRACT NO. 74864
ILLINOIS FED. AID PROJECT				



PAVEMENT MARKINGS AT RAILROAD-HIGHWAY GRADE CROSSING

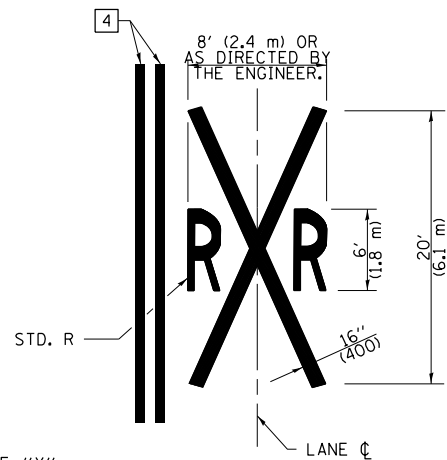
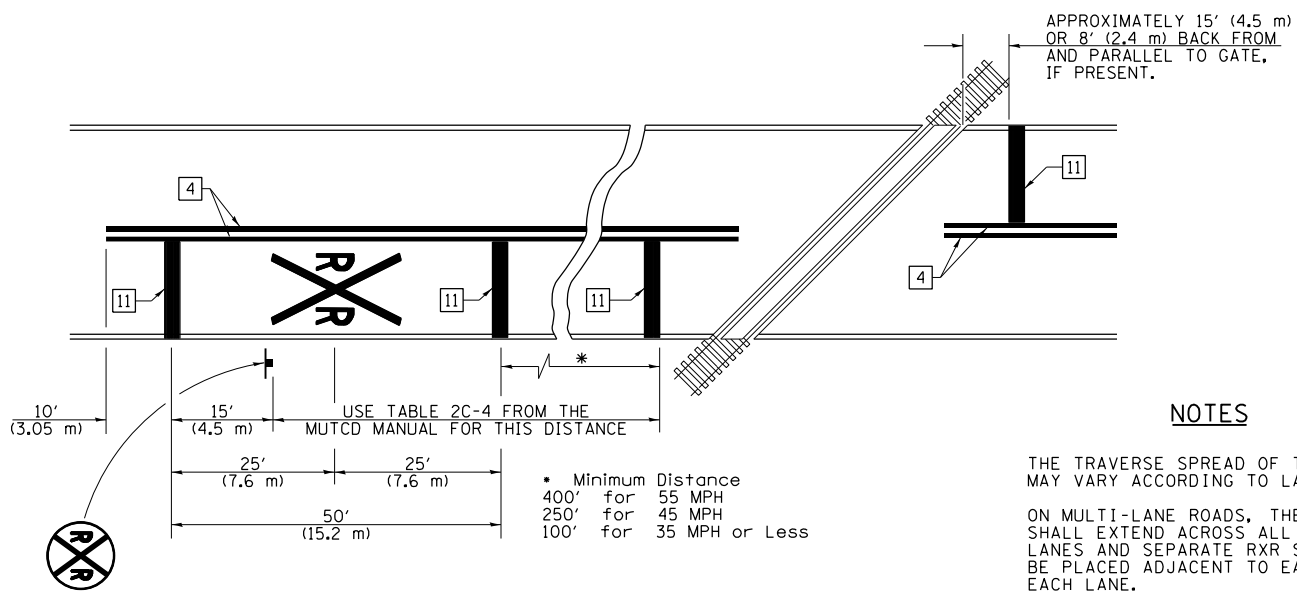

NOTES

THE TRAVERSE SPREAD OF THE "X" MAY VARY ACCORDING TO LANE WIDTH.

ON MULTI-LANE ROADS, THE STOP LINES SHALL EXTEND ACROSS ALL APPROACH LANES AND SEPARATE R X R SYMBOLS SHALL BE PLACED ADJACENT TO EACH OTHER IN EACH LANE.

WHEN THE PAVEMENT MARKING SYMBOL IS USED, A PORTION OF THE SYMBOL SHOULD BE LOCATED DIRECTLY ADJACENT TO THE ADVANCE WARNING SIGN (W10-1) AS PLACED BY TABLE II-1, CONDITION B OF THE MUTCD.

PAVEMENT MARKING LEGEND

- 1 4" (100) SKIP-DASH (YELLOW)
- 2 4" (100) SOLID (YELLOW)
- 3 12" (300) DIAGONAL (YELLOW)
- 4 4" (100) DOUBLE YELLOW (NARROW)
- 5 12" (300) SOLID WHITE
- 6 RESERVED
- 7 6" (150) SKIP-DASH (WHITE)
- 8 4" (100) SOLID (WHITE)
- 9 12" (300) DIAGONAL (WHITE)
- 10 6" (150) SOLID (WHITE)
- 11 24" (600) STOP BAR (WHITE)
- 12 8" (200) SOLID (WHITE)
- 13 4" (100) PARKING WHITE

RAILROAD CROSSING WITH INTERCONNECT ONLY

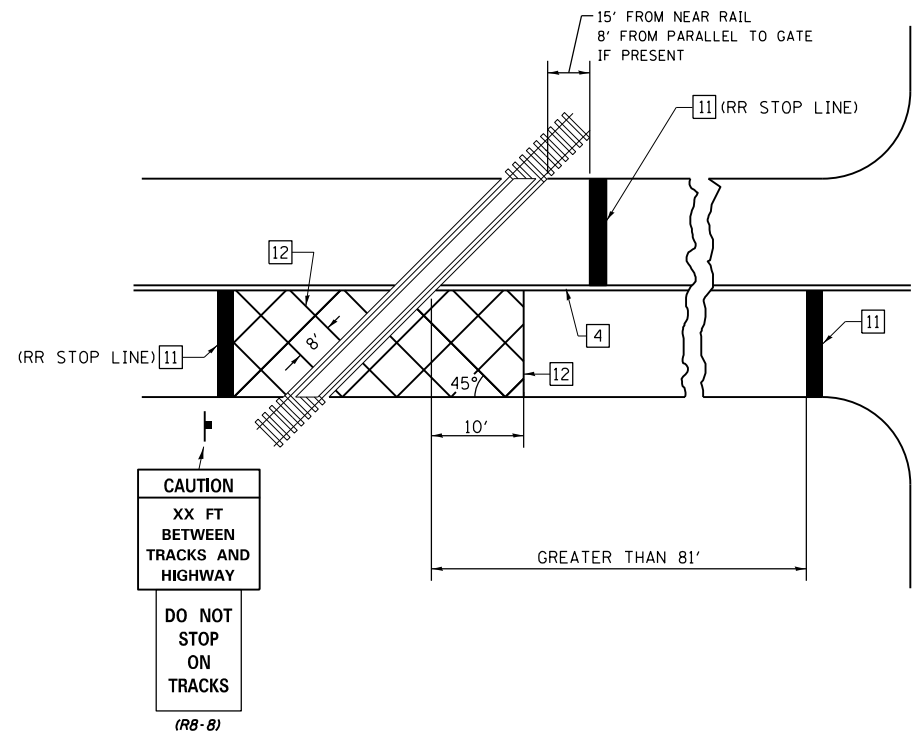

RAILROAD CROSSING WITH INTERCONNECT AND PRE-SIGNALS

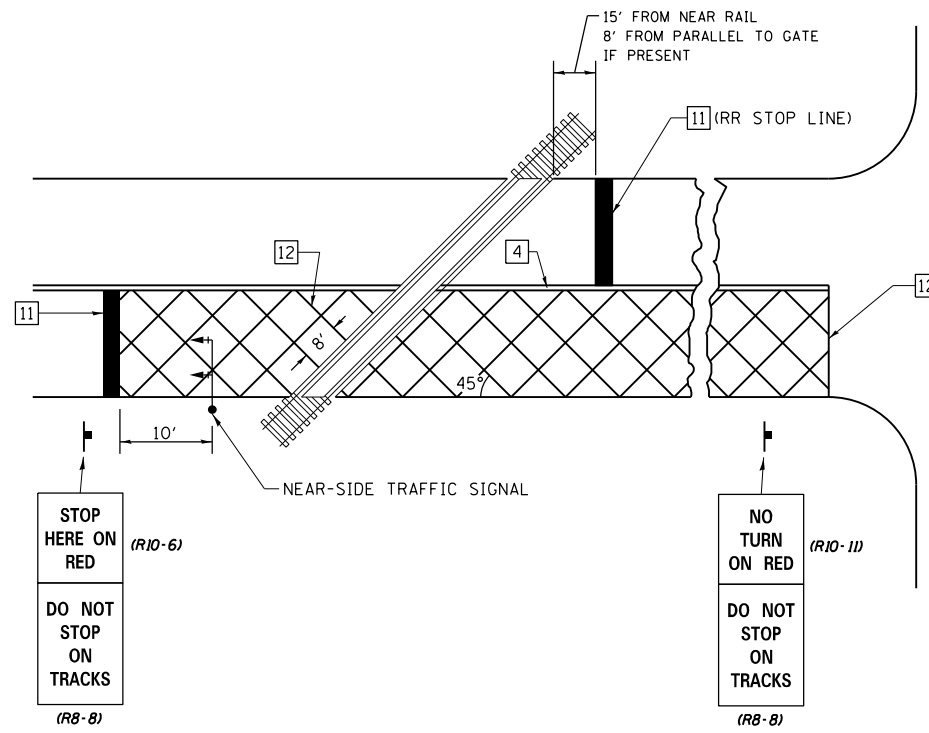

GENERAL NOTES

- SUPPLEMENTAL PAVEMENT MARKINGS TO BE INSTALLED ONLY ON APPROACHES TO INTERSECTIONS CONTROLLED BY TRAFFIC SIGNALS WHICH ARE INTERCONNECTED WITH THE RAILROAD WARNING SIGNALS.
- EXTEND PAVEMENT MARKINGS TO THE INTERSECTION ONLY WHERE NEAR-SIDE TRAFFIC SIGNALS ARE USED.

SUPPLEMENTAL PAVEMENT MARKING TREATMENT FOR RAILROAD-HIGHWAY GRADE CROSSING

NOT TO SCALE

Note: All dimensions are in INCHES (millimeters) unless otherwise shown.

FILE NAME =	USER NAME = steffenmk	DESIGNED -	REVISED -
pw:\IL\084EBID\INTEG.illinois.gov\PIWIDOT\Documents\IDOT Offices\District 7\Projects\74864\DRAWING\CABsheets\0774864-sht-details.dwg		CHECKED -	REVISED -
		DATE -	REVISED -

STATE OF ILLINOIS  
DEPARTMENT OF TRANSPORTATION

PAVEMENT MARKING AND RAISED REFLECTIVE PAVEMENT MARKERS  
(RURAL & URBAN APPLICATIONS)

SCALE: SHEET NO. 4 OF 4 SHEETS STA. TO STA.

DISTRICT 7 DETAIL NO. 7800001

F.A.P. RTE.	SECTION	COUNTY	TOTAL SHEETS	SHEET NO.
320	D7 HMS RESURF 2018-2	MOULTRIE	11	11
CONTRACT NO. 74864			ILLINOIS FED. AID PROJECT	