

DATE	
BY	
PLAN	
NO.	
DATE	
BY	
PROFILE	
NO.	

DATE	
BY	
PROFILE	
NO.	
DATE	
BY	
PLAN	
NO.	

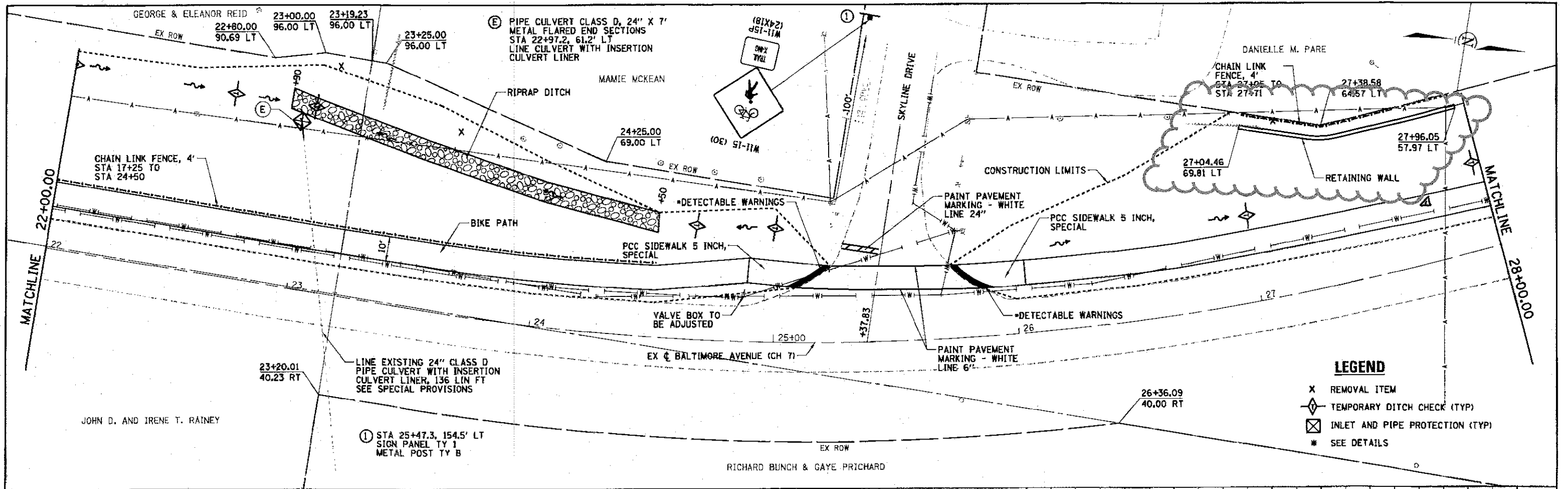

**LEGEND**

- X REMOVAL ITEM
- ◇ TEMPORARY DITCH CHECK (TYP)
- ⊠ INLET AND PIPE PROTECTION (TYP)
- \* SEE DETAILS

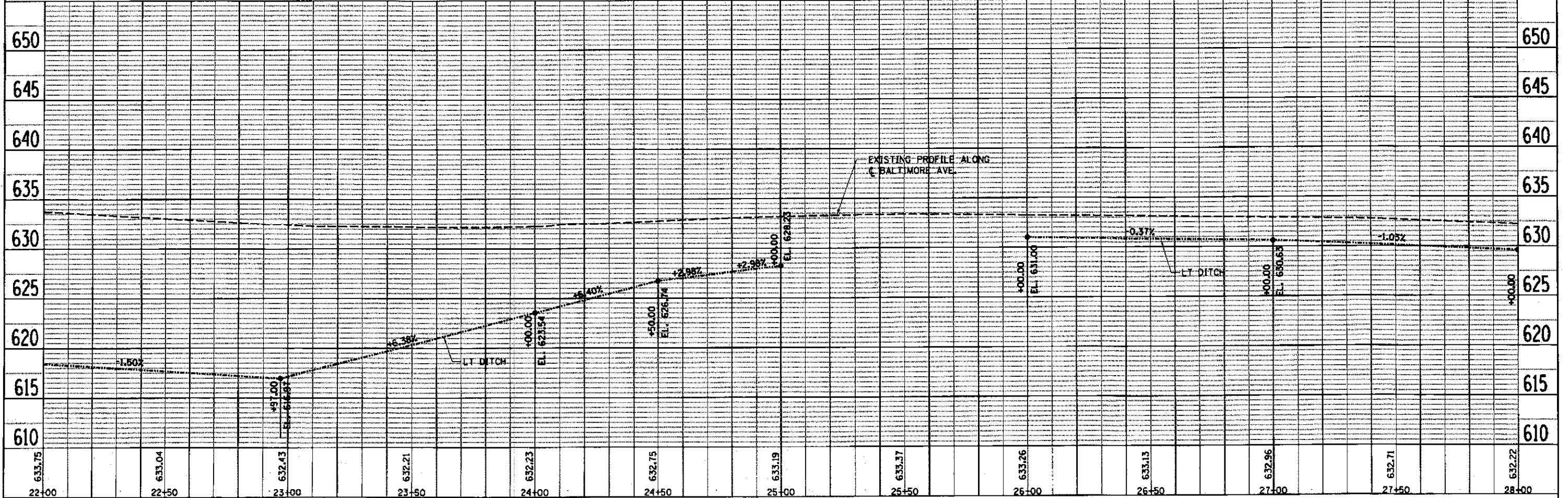

FILE NAME	USER NAME = csaifert	DESIGNED -	REVISED - A 6/5/18	<b>CHASTAIN &amp; ASSOCIATES LLC</b> CONSULTING ENGINEERS DECATUR (217) 428-8644 SCHAUMBURG (773) 714-0050 ROCKFORD (815) 489-0050 184-001397	<b>BIKE PATH - PLAN AND PROFILE</b> <b>BALTIMORE AVENUE</b>		F.A.U. RTE.	SECTION	COUNTY	TOTAL SHEETS	SHEET NO.
1:\municipalities\maccon county\5631 Lost Bridge Road Bike Trail\CADD\Civil\Phase II-Bal...	PLOT SCALE = 48.0000' / 1" =	CHECKED -	REVISED -		7449	15-00233-01-BT	MACON	95	15		
PLOT DATE = 6/4/2018	DATE	REVISED -	REVISED -		SCALE: 1"=20'		SHEET NO. 3 OF 8 SHEETS		STA. 22+00 TO STA. 28+00	CONTRACT NO. 95765	
ILLINOIS FED. AID PROJECT											

PLAN  
 DATE  
 BY  
 CHECKED  
 NO. OF WAY CHECKED  
 NO. OF STRUCTURE NOTATIONS CIPED

PROFILE  
 DATE  
 BY  
 CHECKED  
 NO. OF STRUCTURE NOTATIONS CIPED

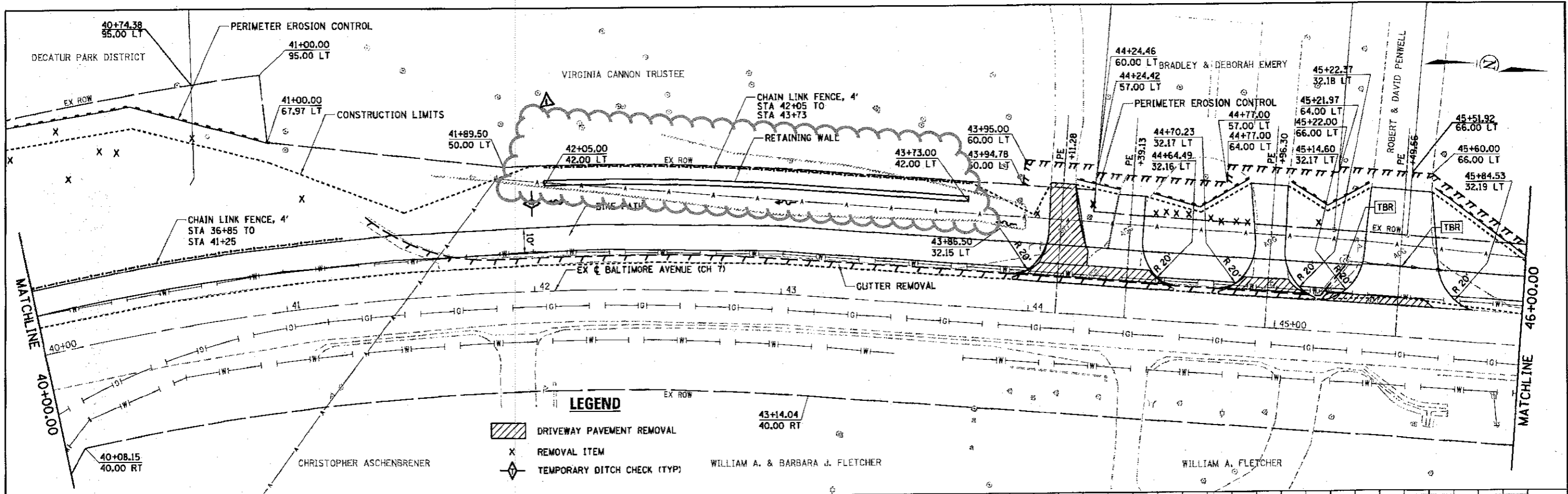

**LEGEND**  
 DRIVEWAY PAVEMENT REMOVAL  
 REMOVAL ITEM  
 TEMPORARY DITCH CHECK (TYP)

WILLIAM A. & BARBARA J. FLETCHER  
 WILLIAM A. FLETCHER

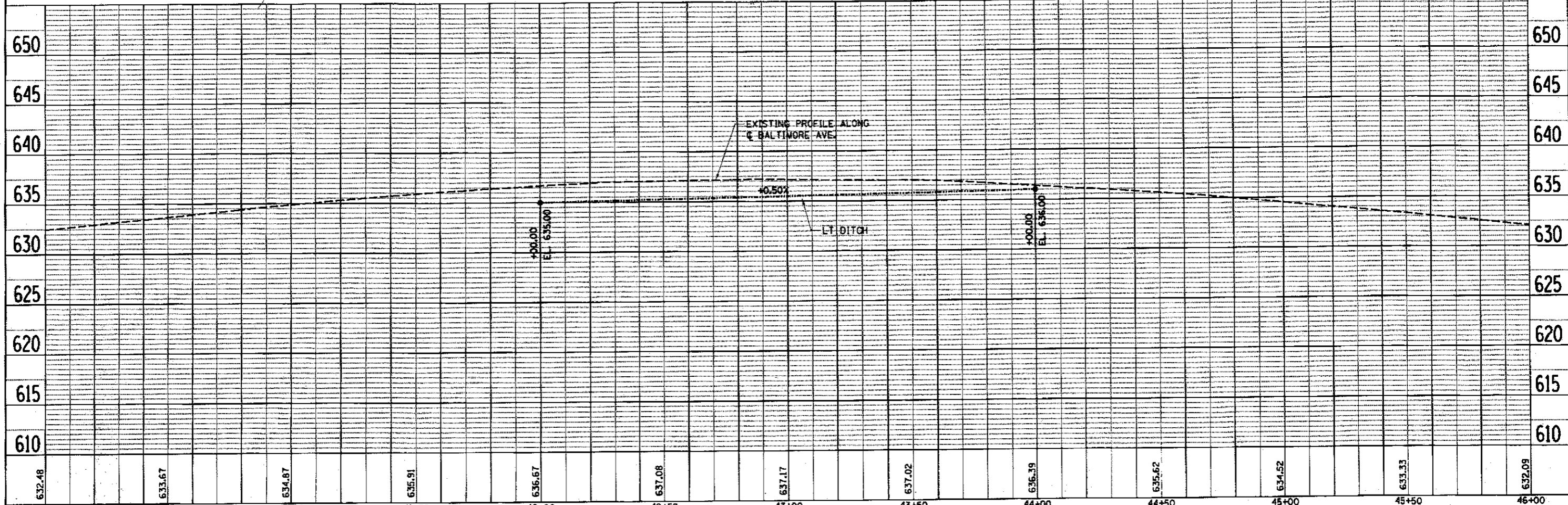

40+00	40+50	41+00	41+50	42+00	42+50	43+00	43+50	44+00	44+50	45+00	45+50	46+00
632.48	633.67	634.87	635.91	636.67	637.08	637.17	637.02	636.39	635.62	634.52	633.33	632.09

FILE NAME =	USER NAME = osiefert	DESIGNED =	REVISION =
age Road Bike Trail\CAD\Civil\Phase II-Bal	ORANGE.dgn		6/5/18
PLOT SCALE = 1/8" = 1' in.	CHECKED =	REVISION =	
PLOT DATE = 6/4/2018	DATE =	REVISION =	

**CHASTAIN & ASSOCIATES LLC**  
 CONSULTING ENGINEERS

DECATUR (217) 422-8544  
 SCHAUMBURG (773) 714-0050  
 ROCKFORD (815) 489-0050  
 184-001397

**BIKE PATH - PLAN AND PROFILE**  
**BALTIMORE AVENUE**

SCALE: 1"=20'  
 SHEET NO. 6 OF 8 SHEETS  
 STA. 40+00 TO STA. 46+00

F.A.U. RTE.	SECTION	COUNTY	TOTAL SHEETS
7449	15-00233-01-BT	MACON	85
			18
			CONTRACT NO. 95765
ILLINOIS FED. AID PROJECT			

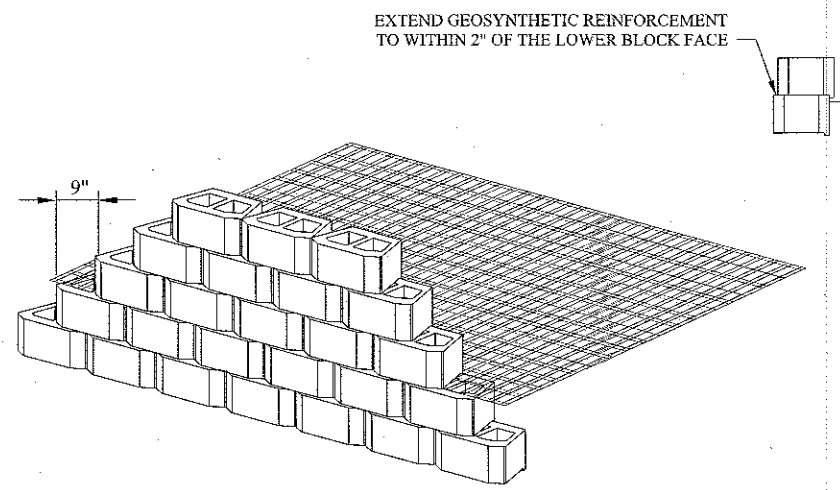
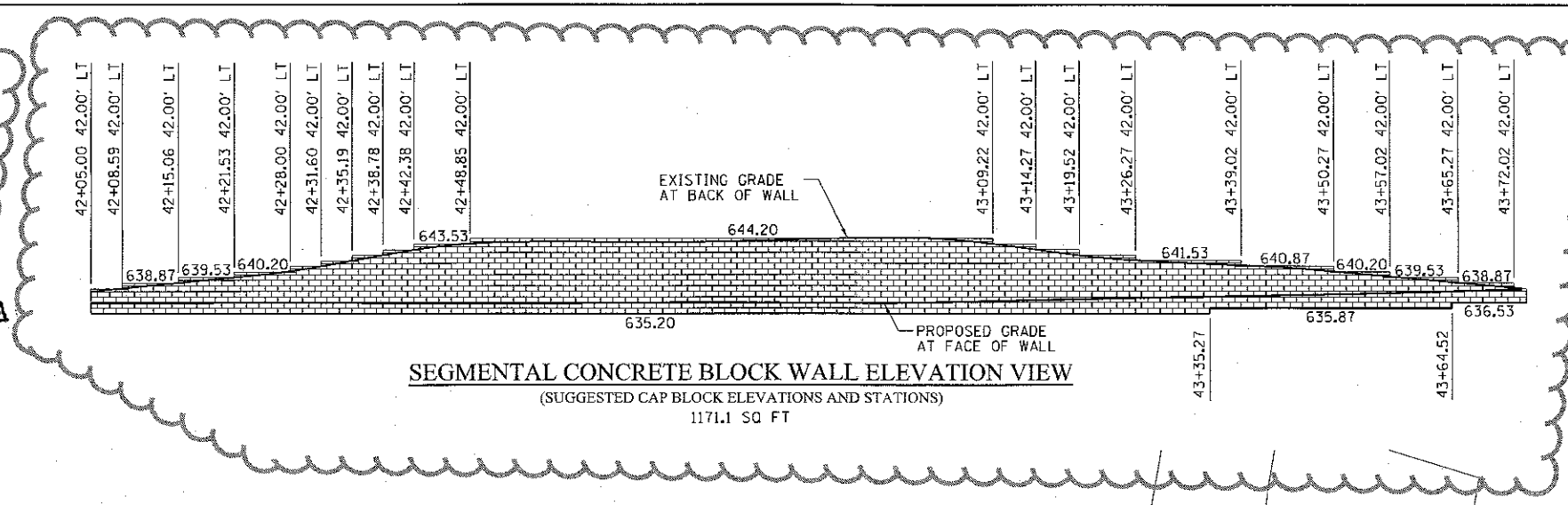
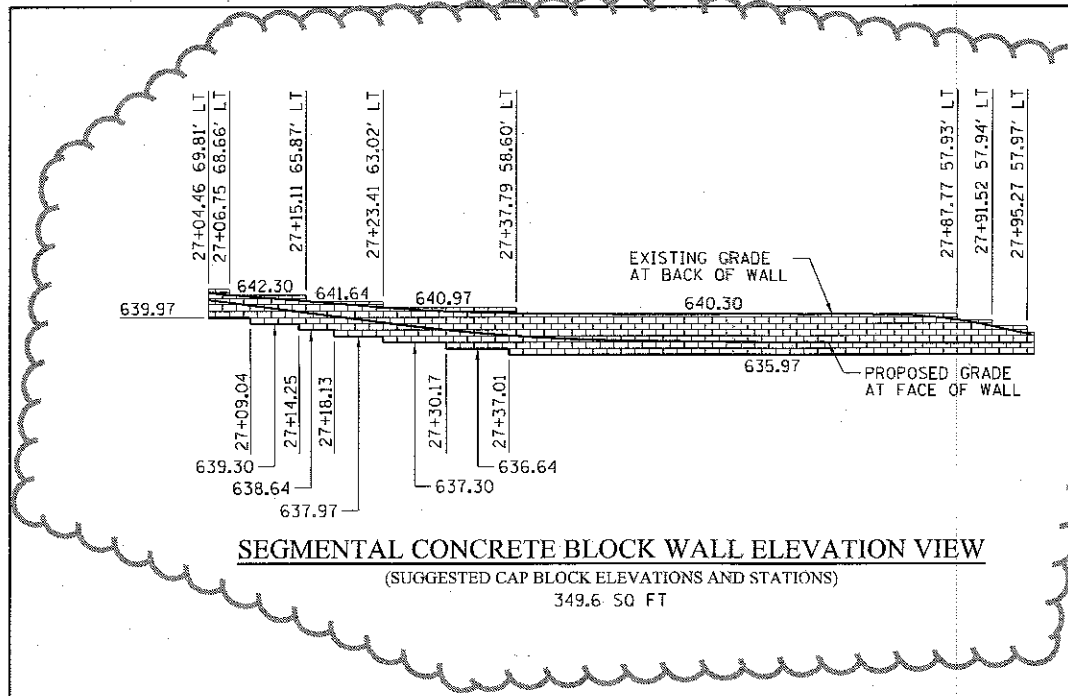

**BEVELED UNITS  
REINFORCEMENT CONNECTION DETAIL**

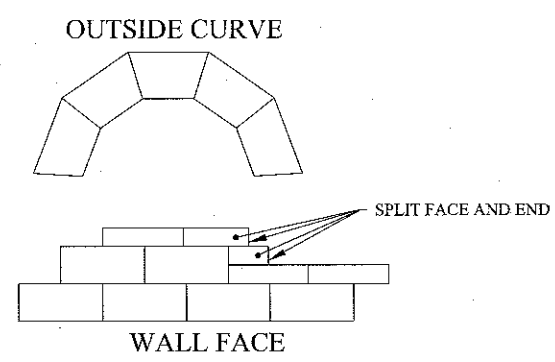

1. Always start capping wall from the lowest elevation.
2. Lay out caps prior to using adhesive.
3. Cut caps to fit. Various combinations of long and short cap faces will be necessary for radii greater than the minimum.
4. Alternate short and long cap faces every other cap to achieve a straight row of caps.
5. Use exterior-grade construction adhesive to secure caps.

**CAP BLOCK DETAILS**

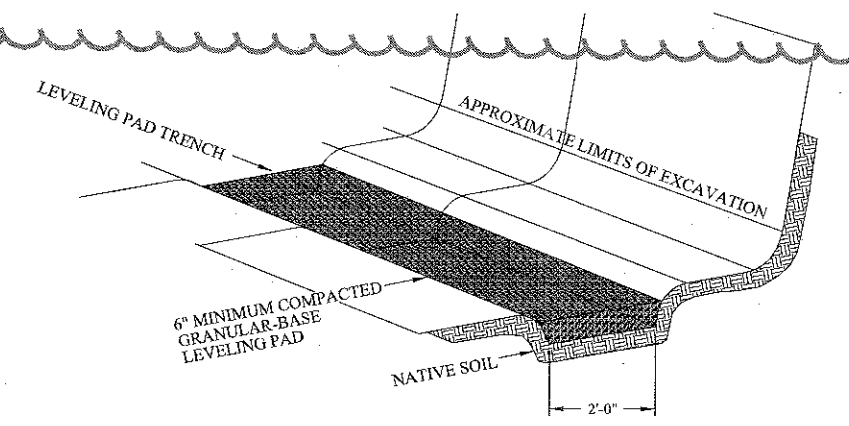

**TYPICAL BASE PREPARATION DETAIL**

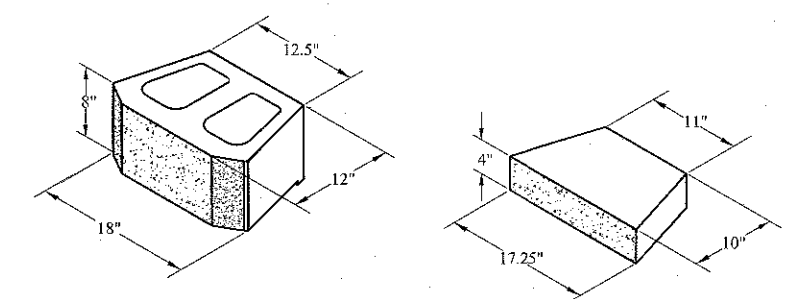

**BEVELED UNIT  
ISOMETRIC VIEW BLOCK DETAILS  
CAP UNIT**

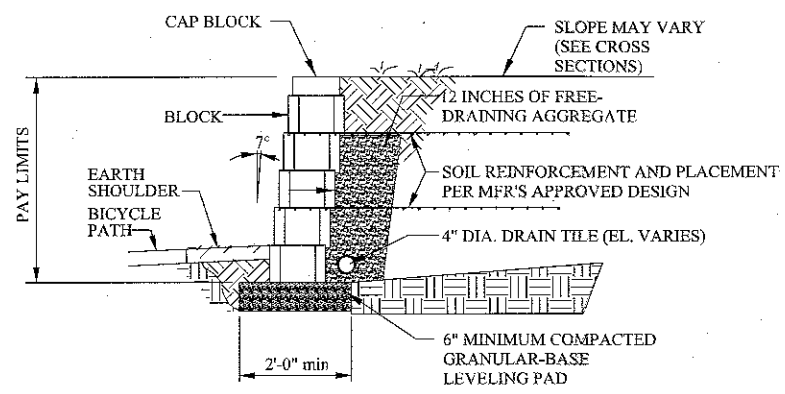

**SEGMENTAL CONCRETE BLOCK WALL SECTION**

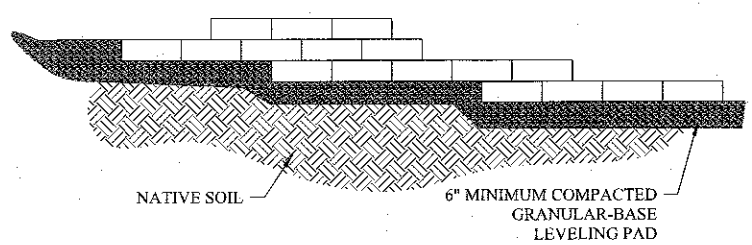

**TYPICAL STEP-UP DETAIL**

**GENERAL NOTES**

1. Suggested station and elevation subject to change depending on manufacturer's block size.
2. Offsets shown in elevation view are to front of wall.
3. Use of soil reinforcement and drainage system subject to manufacturer's approved design.
4. Total estimated quantity for segmental concrete block wall = 1,520.7 sq ft.
5. Drain pipes shall be sloped 1/8" per foot minimum and shall be discharged at lowest point of wall into storm sewer or ground.
6. The following shall be included in the cost of segmental concrete block wall:
  - a. All excavation required for wall construction
  - b. Leveling Pad
  - c. Drain Tile
  - d. Soil Reinforcement (if required)
  - e. Free-draining aggregate
7. See Article 522.12 of the Standard Specifications for payment information.

FILE NAME =	USER NAME = osterfort	DESIGNED =	REVISED =
\\municipalities\macon county\5631 Lost	Bridge Road Bike Trail\CADD\Civil\Phase-II-Bo	09\DRAWN\5631.dgn	6/5/18
PLOT SCALE = 48,0000 / 1/8"	CHECKED =	REVISED =	REVISED =
PLOT DATE = 6/5/2018	DATE =	REVISED =	REVISED =

**CHASTAIN & ASSOCIATES LLC**  
CONSULTING ENGINEERS

DECATUR (217) 422-8544  
SCHAUMBURG (773) 714-0050  
ROCKFORD (815) 489-0050  
184-001397

<b>BIKE PATH - RETAINING WALL DETAIL</b>		F.A.I.L. R.T.E.	SECTION	COUNTY	TOTAL SHEETS	SHEET NO.
BALTIMORE AVENUE		7449	15-00233-01-BT	MACON	85	25
SCALE:	SHEET NO. OF SHEETS	STA. TO STA.	CONTRACT NO. 95765			
ILLINOIS FED. AID PROJECT						

DATE	
BY	
FINAL SURVEY	SUBMITTED
NOTE BOOK	PLOTTED
NO.	TEMPLATE
	AREAS CHECKED

DATE	
BY	
ORIGINAL SURVEY	SUBMITTED
NOTE BOOK	PLOTTED
NO.	TEMPLATE
	AREAS CHECKED

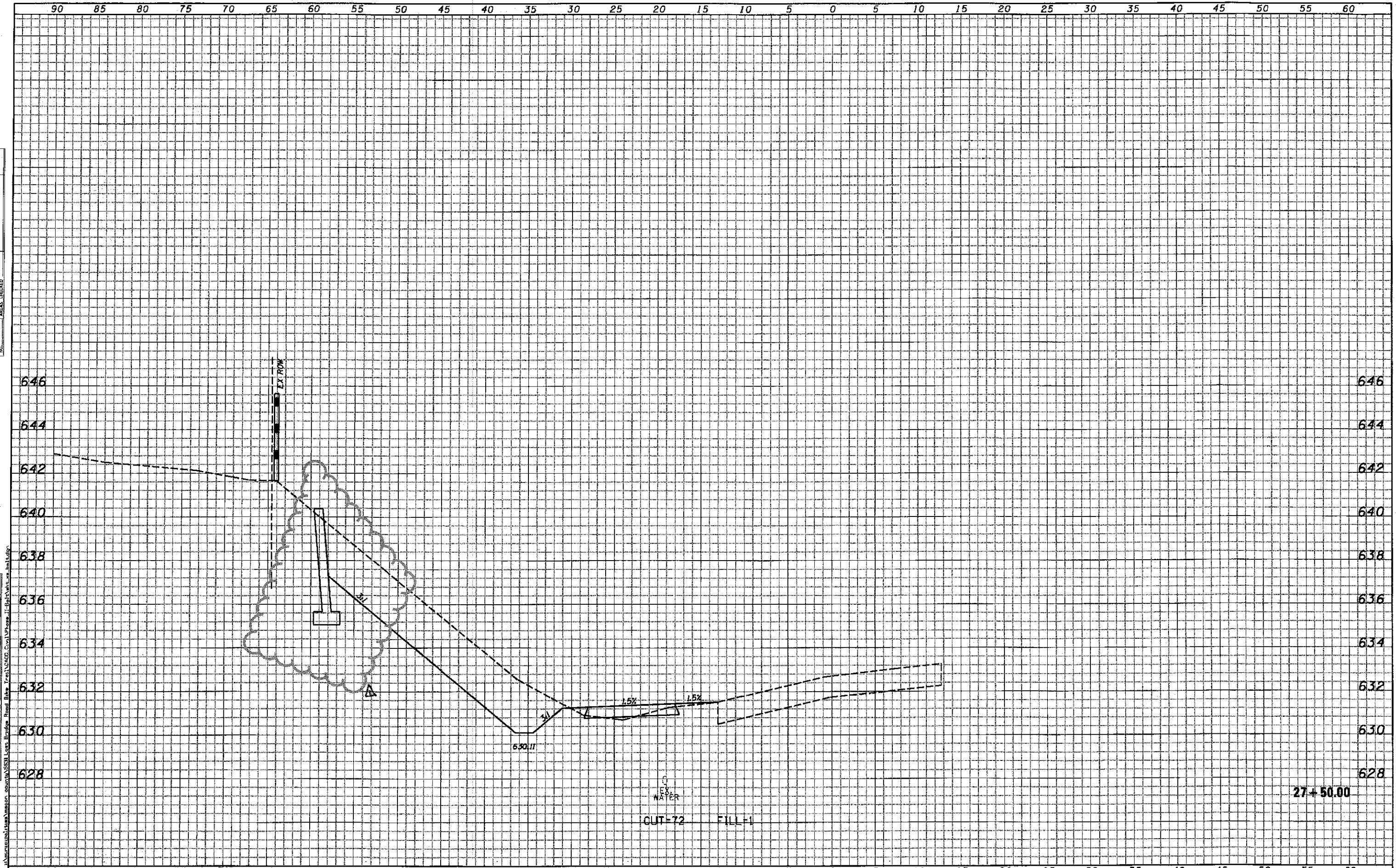

USER NAME = osiafer-t	DESIGNED -	REVISOR -	DATE - 4/5/18	<b>CHASTAIN &amp; ASSOCIATES LLC</b> CONSULTING ENGINEERS DECATUR (217) 488-8544 SCHAUMBURG (773) 714-0050 ROCKFORD (815) 489-0050 184-001397	<b>BIKE PATH - CROSS SECTIONS</b> <b>BALTIMORE AVENUE</b>				FULL RTE. 7449	SECTION 15-00233-01-BY	COUNTY MACON	TOTAL SHEETS 85	SHEET NO. 52
PLOT SCALE = 10,0000' / 1"	DRAWN -	REVISOR -	DATE -		SCALE: 5'H / 2"	SHEET NO. OF	SHEETS	STA. 27+50.00	TO STA. 27+50.00	CONTRACT NO. 95765			
PLOT DATE = 6/4/2018	CHECKED -	REVISOR -	DATE -		ILLINOIS FED. AID PROJECT								
	DATE -	REVISOR -	DATE -										

BY \_\_\_\_\_ DATE \_\_\_\_\_  
 SURVEYED \_\_\_\_\_  
 PLOTTED \_\_\_\_\_  
 NOTE BOOK \_\_\_\_\_  
 AREAS CHECKED \_\_\_\_\_

BY \_\_\_\_\_ DATE \_\_\_\_\_  
 SURVEYED \_\_\_\_\_  
 PLOTTED \_\_\_\_\_  
 NOTE BOOK \_\_\_\_\_  
 AREAS CHECKED \_\_\_\_\_

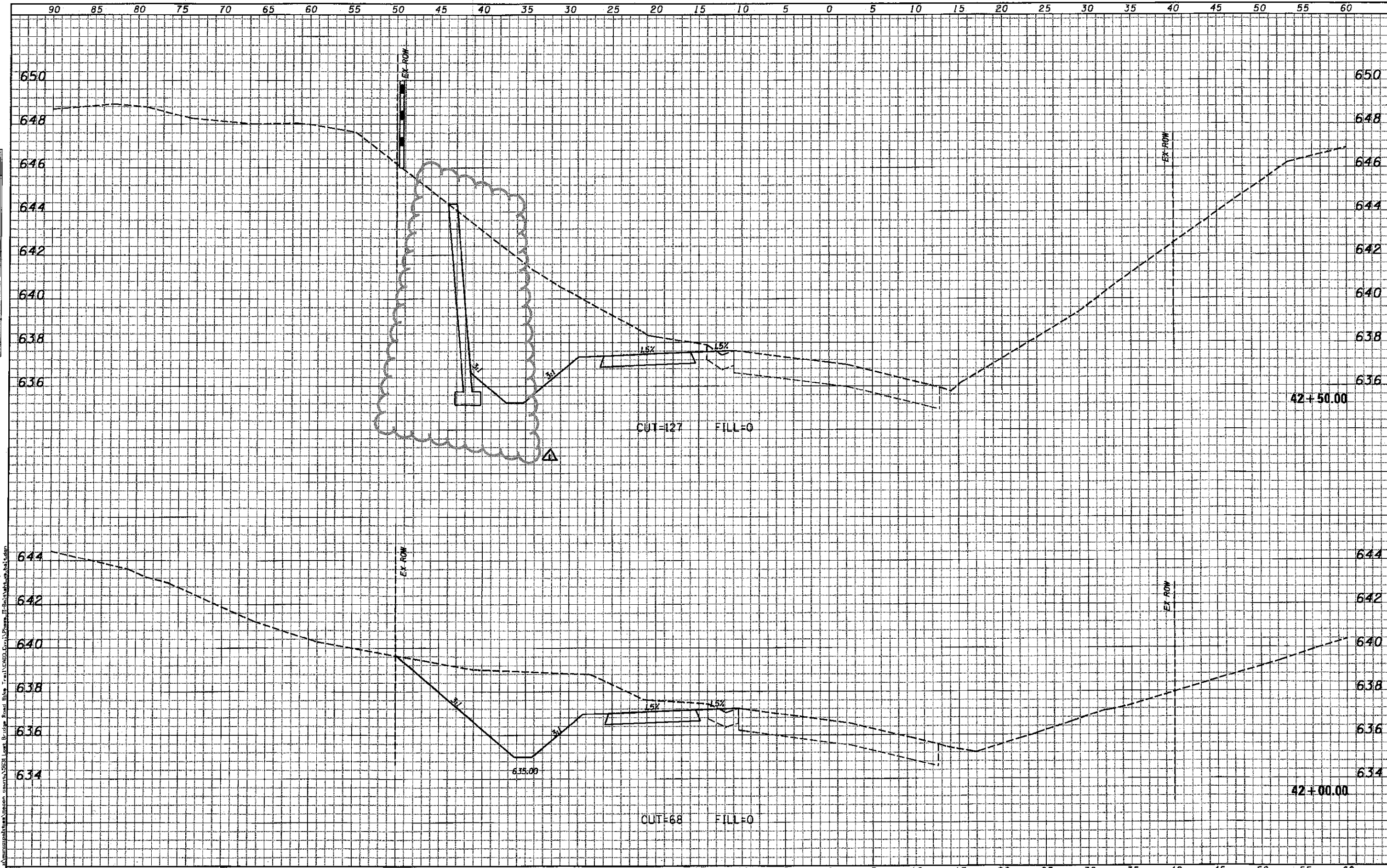

USER NAME - cawfert PLDT SCALE = 1/8" = 1' / in. PLDT DATE = 6/4/2018	DESIGNED - DRAWN - CHECKED - DATE -	REVISED - REVISED - REVISED - REVISED -	Δ 6/5/18	<b>CHASTAIN &amp; ASSOCIATES LLC</b> CONSULTING ENGINEERS DECATUR (317) 422-8544 SCHAUMBURG (773) 714-0050 ROCKFORD (815) 489-0050 184-001397	<b>BIKE PATH - CROSS SECTIONS</b> <b>BALTIMORE AVENUE</b> SCALE: 5H / 2V SHEET NO. OF SHEETS STA. 42+00.00 TO STA. 42+50.00	F.A.U. RTE. 7449 SECTION 15-00233-01-BT COUNTY MACON TOTAL SHEETS 85 TO 95765 CONTRACT NO. 95765 ILLINOIS FED. AID PROJECT
---	--	--	----------	--	---	---

DATE	
BY	
SURVEYED	
PLOTTED	
NOTE BOOK	
NO.	

DATE	
BY	
ORIGINAL SURVEY	
PLOTTED	
NOTE BOOK	
NO.	

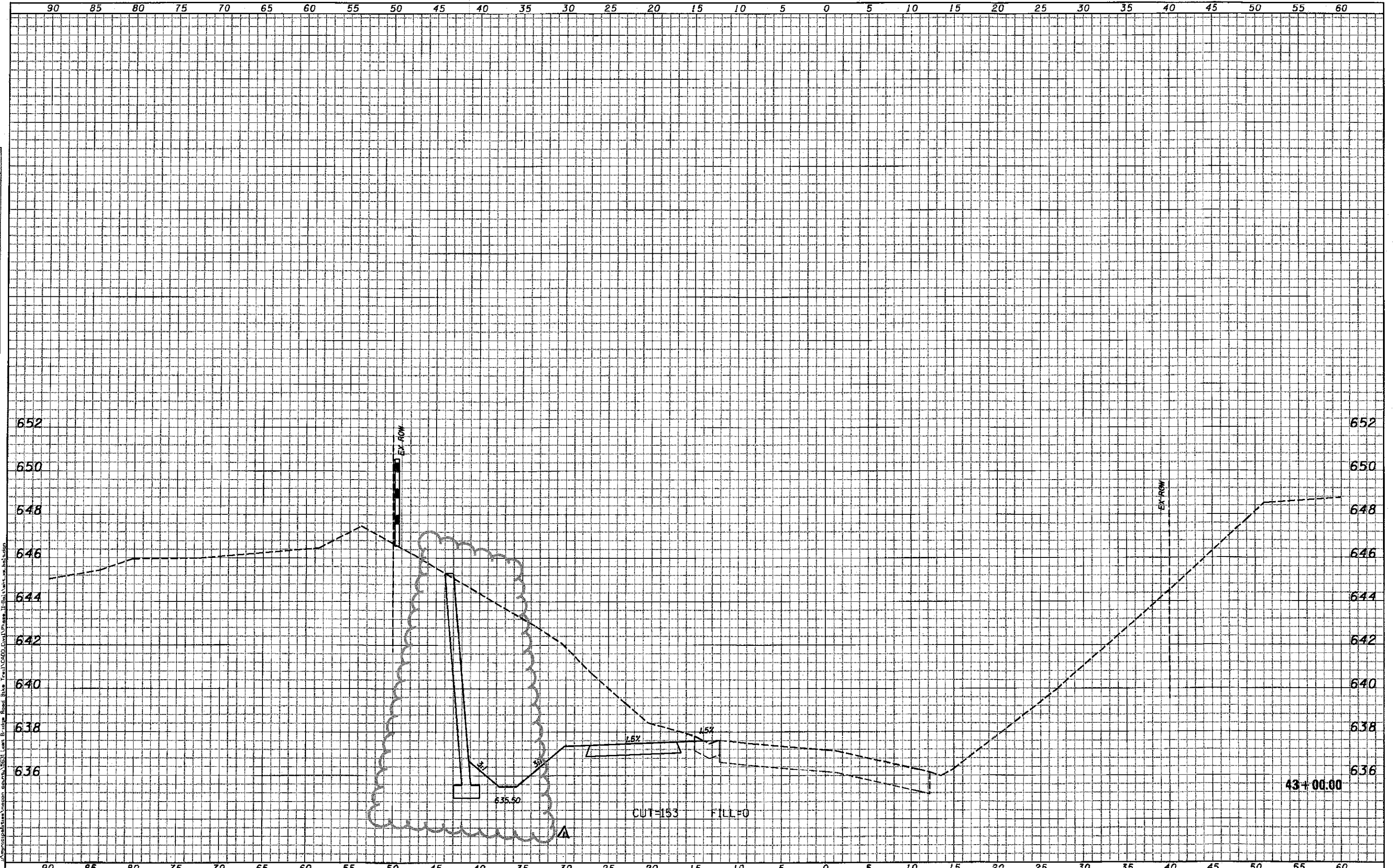

USER NAME - casefert	DESIGNED -	REVISED - <b>6/5/18</b>	<b>CHASTAIN &amp; ASSOCIATES LLC</b> CONSULTING ENGINEERS DECATUR (317) 422-8544 SCHAMBURG (773) 714-0050 ROCKFORD (815) 489-0050 (84-001397)	<b>BIKE PATH - CROSS SECTIONS</b> <b>BALTIMORE AVENUE</b>			F.A.J.L. RTE.	SECTION	COUNTY	TOTAL SHEETS	SHEET NO.
PLDT SCALE = 10:8000 / 1"	DRAWN -	REVISED -		7449	15-00233-01-BT	WACON	85	71			
PLDT DATE = 6/4/2018	CHECKED -	REVISED -		SCALE: 5'H / 2"V    SHEET NO. OF SHEETS    STA. 43+00.00 TO STA. 43+00.00			CONTRACT NO. 95765				
	DATE -	REVISED -					ILLINOIS FED. AID PROJECT				

DATE	
BY	
SURVEYED	
PLOTTED	
NOTE BOOK	
TEMP. DATE	
AREAS CHECKED	
NO.	

DATE	
BY	
SURVEYED	
PLOTTED	
NOTE BOOK	
TEMP. DATE	
AREAS CHECKED	
NO.	

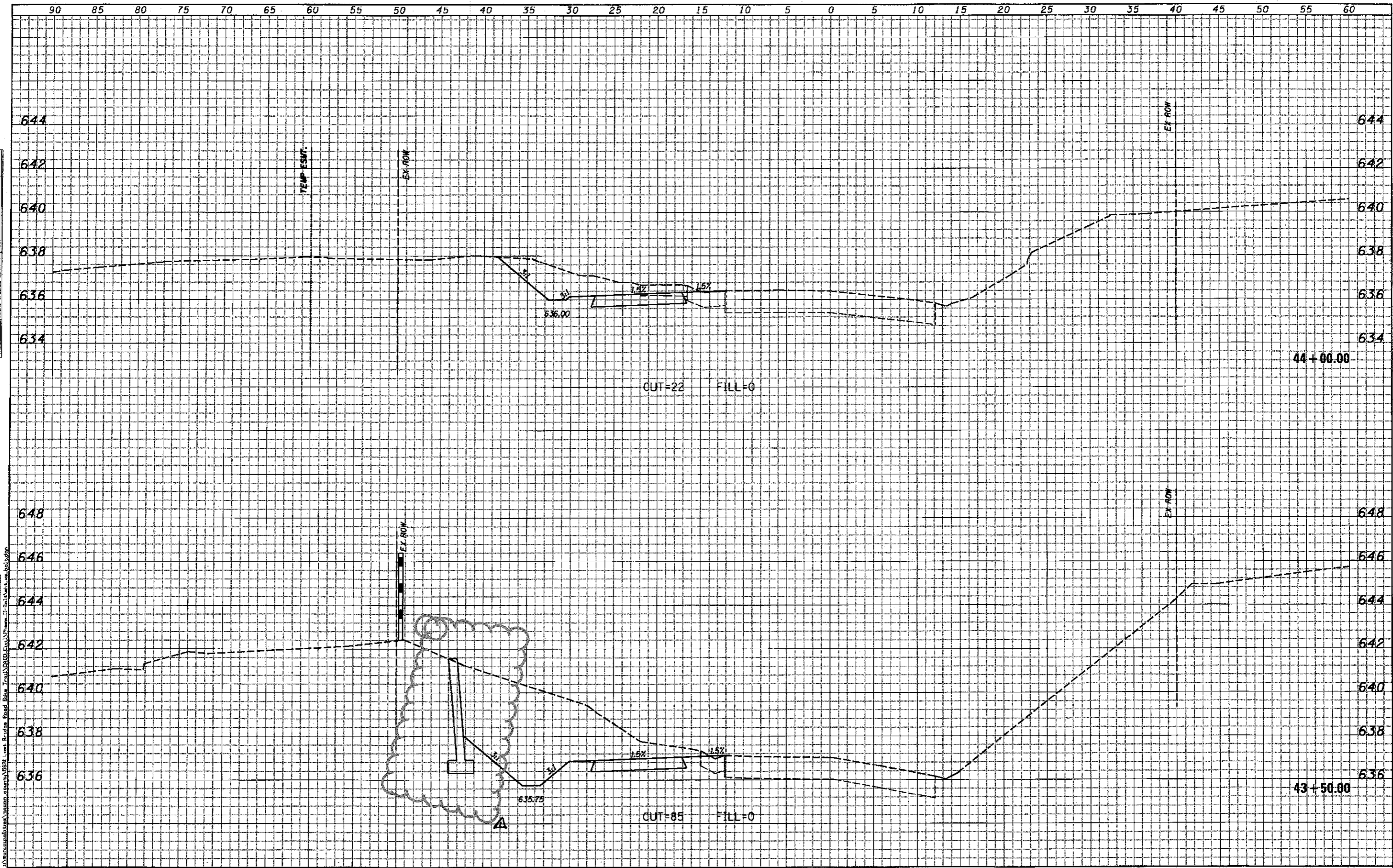

USER NAME = 091010-rs	DESIGNED -	REVISED - $\Delta$ 6/5/18	<b>CHASTAIN &amp; ASSOCIATES LLC</b> CONSULTING ENGINEERS DECATUR (217) 422-8544 SCHAUMBURG (773) 714-0050 ROCKFORD (815) 489-0050 184-001397	<b>BIKE PATH - CROSS SECTIONS</b> <b>BALTIMORE AVENUE</b>			F.A.U. RTE.	SECTION	COUNTY	TOTAL SHEET NO.
PLOT SCALE = 1/8" = 1' / 32'	DRAWN -	REVISED -		7449	15-00233-01-BT	MACON	85	72		
PLOT DATE = 6/4/2018	CHECKED -	REVISED -		SCALE: 5'H / 2"V			SHEET NO. OF SHEETS		STA. 43+50.00 TO STA. 44+00.00	CONTRACT NO. 95765
	DATE -	REVISED -					ILLINOIS FED. AID PROJECT			