

DISTRICT 1 DESIGN - PLAN PREP ENGINEER/ KEN ENG (847) 705-4247

F.A.U. RTE.	SECTION	COUNTY	TOTAL SHEETS	SHEET NO.
1340	2727 & 2828 RS-4	COOK	20	1

CONTRACT NO. 60722

D-91-202-01



STATE OF ILLINOIS
DEPARTMENT OF TRANSPORTATION
DIVISION OF HIGHWAYS

**PROPOSED
HIGHWAY PLANS**

F.A.U. ROUTE 1340 (TOUHY AVE)
US 41 (LINCOLN AVENUE) TO LAWNSDALE AVENUE
SECTION: (2727 & 2828) RS-4
RESURFACING (MAINTENANCE)
COOK COUNTY
C-91-105-99

FOR INDEX OF SHEETS, SEE SHEET NO. 2

IMPROVEMENT IS LOCATED IN THE VILLAGE OF LINCOLNWOOD

IMPROVEMENT BEGINS STA. 0+00

OMISSION: STA. 26+00 TO STA. 40+00

IMPROVEMENT ENDS STA. 48+17

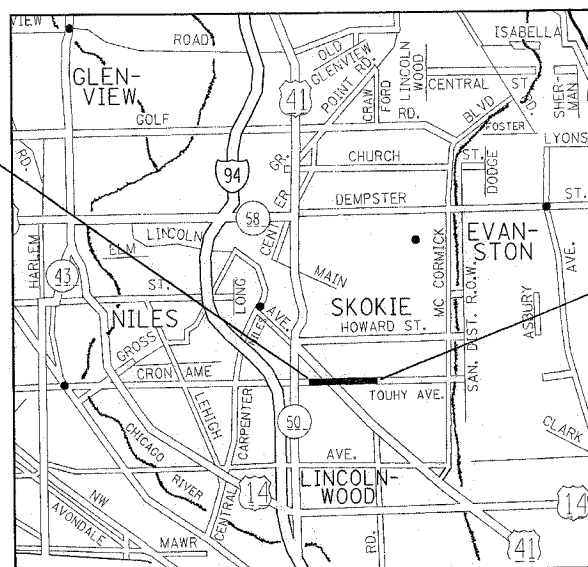

NILES TOWNSHIP

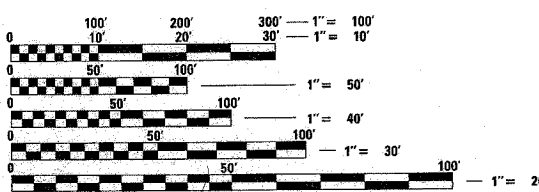
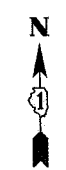

FULL SIZE PLANS HAVE BEEN PREPARED USING STANDARD ENGINEERING SCALES. REDUCED SIZED PLANS WILL NOT CONFORM TO STANDARD SCALES. IN MAKING MEASUREMENTS ON REDUCED PLANS, THE ABOVE SCALES MAY BE USED.

J.U.L.I.E.
JOINT UTILITY LOCATION INFORMATION FOR EXCAVATION
1-800-892-0123

CONTRACT NO. 60722

TRAFFIC DATA

ADT = 32,200 (2002)
SPEED LIMIT = 35 MPH

MAP SCALE

NO SCALE

GROSS LENGTH OF IMPROVEMENT = 4817 LINEAL FEET = 0.91 MILES
NET LENGTH OF IMPROVEMENT = 3417 LINEAL FEET = 0.65 MILES

STATE OF ILLINOIS
DEPARTMENT OF TRANSPORTATION
DIVISION OF HIGHWAYS

SUBMITTED March 31, 2006

Diane M. O'Keefe
DEPUTY DIRECTOR OF HIGHWAYS, REGION ENGINEER

May 12, 2006
Mike Stine
ENGINEER OF DESIGN AND ENVIRONMENT

May 12, 2006
Milton R. See
DIRECTOR OF HIGHWAYS, CHIEF ENGINEER

**PRINTED BY THE AUTHORITY
OF THE STATE OF ILLINOIS**

F.A.U. RTE.	SECTION	COUNTY	TOTAL SHEETS	SHEET NO.
1340	(2727&2828) RS-4	COOK	20	2
STA.		TO STA.		
FED. ROAD DIST. NO.		ILLINOIS FED. AID PROJECT		

CONTRACT NO. 60722

INDEX OF SHEETS

<u>SHEET NO.</u>	<u>DESCRIPTION</u>
1.	TITLE SHEET
2.	INDEX OF SHEETS, STATE STANDARDS, AND GENERAL NOTES
3	SUMMARY OF QUANTITIES
4-5	EXISTING AND PROPOSED TYPICAL SECTIONS
6-7	ROADWAY AND PAVEMENT MARKING PLANS
8-9	TRAFFIC SIGNAL AND DETECTOR LOOPS REPLACEMENT
10-21	DISTRICT ONE DETAILS

STATE STANDARDS:

- 000001-04 STANDARD SYMBOLS, ABBREVIATIONS, AND PATTERNS
- 442201-01 CLASS C AND D PATCHES
- 424001-04 CURB RAMPS FOR SIDEWALKS
- 602301-02 INLET, TYPE A
- 604001-02 FRAME AND LIDS, TYPE 1
- 604016-01 FRAME AND GRATE, TYPE 4
- 606001-02 CONCRETE CURB & COMBINATION CONCRETE CURB & GUTTER
- 606306-01 CORRUGATED PC CONCRETE MEDIANS
- 701601-04 URBAN LANE CLOSURE, MULTILANE, 1W OR 2W WITH NONTRAVERSABLE MEDIAN
- 701606-04 URBAN LANE CLOSURE, MULTILANE, 2W WITH MOUNTABLE MEDIAN
- 701701-04 URBAN LANE CLOSURE, MULTILANE INTERSECTION
- 702001-06 TRAFFIC CONTROL DEVICES
- 780001-01 TYPICAL PAVEMENT MARKINGS
- 886001 DETECTOR LOOP INSTALLATIONS
- 886006 TYPICAL LAYOUT FOR DETECTION LOOPS

GENERAL NOTES:

BEFORE STARTING ANY EXCAVATION, THE CONTRACTOR SHALL CALL "JULIE" AT 800-892-0123 FOR FIELD LOCATIONS OR BURIED ELECTRIC, TELEPHONE, AND GAS FACILITIES. (48 HOUR NOTIFICATION REQUIRED)

3 METER (10 FEET) TRANSITIONS SHALL BE USED TO MATCH PROPOSED CURB & GUTTER AND MEDIAN ITEMS OF WORK TO EXISTING CURB & GUTTERS AND MEDIANS IN THE FIELD, UNLESS OTHERWISE SHOWN. THE TRANSITIONS SHALL BE PAID FOR AT THE CONTRACT UNIT PRICE FOR THE PROPOSED ITEMS OF WORK SPECIFIED.

THE CONTRACTOR SHALL COORDINATE CONSTRUCTION ACTIVITIES WITH UTILITY COMPANIES.

THE CONTRACTOR WILL NOT BE ABLE TO SET UP A YARD OR FIELD OFFICE ON STATE PROPERTY WITHOUT THE WRITTEN PERMISSION OF THE DEPARTMENT.

BUTT JOINTS WILL BE INSTALLED AT THE ENDS OF RESURFACING (WHERE RESURFACING MEETS EXISTING PAVEMENT). IN ACCORDANCE WITH THE "BUTT JOINT AND BITUMINOUS TAPER DETAILS" SHEET INCLUDED IN THE PLANS UNLESS OTHERWISE SPECIFIED.

REMOVAL OF THE BITUMINOUS OVERLAY ON GUTTER TO BE INCLUDED IN BITUMINOUS SURFACE REMOVAL 2 1/2"

WHEN MILLED PAVEMENT IS OPEN TO TRAFFIC, THE MAXIMUM GRADE DIFFERENTIAL BETWEEN PASSES OF THE MILLING MACHINE SHALL NOT EXCEED 1 1/2 INCHES WHERE THE SPEED LIMIT IS 45 MPH OR LESS, AND 1 INCH WHERE THE SPEED LIMIT IS GREATER THAN 45 MPH. WITH WRITTEN APPROVAL FROM THE RESIDENT ENGINEER. A MAXIMUM GRADE DIFFERENTIAL OF 3 INCHES MAY BE ALLOWED IF THE EDGE OF THE MILLING IS SLOPED A MINIMUM OF 1:3 (V:H)

BUTT JOINTS WILL BE INSTALLED AT THE ENDS OF ALL RESURFACING (WHERE RESURFACING MEETS EXISTING PAVEMENT) IN ACCORDANCE WITH THE "BUTT JOINT AND BITUMINOUS TAPER DETAILS" SHEET INCLUDED IN THE PLANS, UNLESS OTHERWISE SPECIFIED.

THE RESIDENT ENGINEER SHALL CONTACT MR. WALTER CZARNY, AREA TRAFFIC FIELD ENGINEER, AT (773) 685-8386 A MINIMUM OF 2 WEEKS PRIOR TO PLACEMENT OF PERMANENT PAVEMENT MARKINGS.

REVISIONS		ILLINOIS DEPARTMENT OF TRANSPORTATION TOUHY AVENUE INDEX OF SHEETS LIST OF STATE STANDARDS PLAN NOTES
NAME	DATE	
		SCALE: VERT. DRAWN BY HORIZ. CHECKED BY DATE

PLOT DATE = 4/6/2006
FILE NAME = c:\projects\4128201\4128201.dwg
PLOT SCALE = 5/8"=1' / IN.
USER NAME = c:\admin

CONTRACT NO. 60722

SUMMARY OF QUANTITIES			URBAN 100% STATE	CONSTRUCTION TYPE CODE					
CODE NO	ITEM	UNIT	TOTAL QUANTITIES	I000					
40600200	BITUMINOUS MATERIALS (PRIME COAT)	TON	19	19					
40600300	AGGREGATE (PRIME COAT)	TON	23	23					
40600400	MIXTURE FOR CRACKS, JOINTS, AND FLANGEWAYS	TON	8	8					
40600895	CONSTRUCTING TEST STRIP	EACH	1	1					
40600980	BITUMINOUS SURFACE REMOVAL - BUTT JOINT	SQ YD	292	292					
40601000	BITUMINOUS REPLACEMENT OVER PATCHES	TON	176	176					
42001300	PROTECTIVE COAT	SQ YD	679	679					
42400200	PORTLAND CEMENT CONCRETE SIDEWALK 5 INCH	SQ FT	330	330					
42400800	DETECTABLE WARNINGS	SQ FT	72	72					
44000008	BITUMINOUS SURFACE REMOVAL 2 1/2"	SQ YD	21642	21642					
44000110	BITUMINOUS REMOVAL OVER PATCHES 2 1/2"	SQ YD	1271	1271					
44000600	SIDEWALK REMOVAL	SQ FT	330	330					
44001700	COMBINATION CONCRETE CURB AND GUTTER REMOVAL AND REPLACEMENT	FOOT	2885	2885					
44003510	MEDIAN REMOVAL PARTIAL DEPTH	SQ FT	973	973					
44201729	CLASS D PATCHES, TYPE II, 7 INCH	SQ YD	394	394					
44201733	CLASS D PATCHES, TYPE III, 7 INCH	SQ YD	360	360					
44201735	CLASS D PATCHES, TYPE IV, 7 INCH	SQ YD	502	502					
55039700	STORM SEWERS TO BE CLEANED	FOOT	1022	1022					
60250400	CATCH BASINS TO BE ADJUSTED WITH NEW TYPE 1 FRAME, OPEN LID	EACH	1	1					
60300305	FRAMES AND LIDS TO BE ADJUSTED	EACH	12	12					
60300310	FRAMES AND LIDS TO BE ADJUSTED (SPECIAL)	EACH	50	50					
60406000	FRAMES AND LIDS, TYPE 1, OPEN LID	EACH	2	2					
60406100	FRAMES AND LIDS, TYPE 1, CLOSED LID	EACH	36	36					
67000400	ENGINEER'S FIELD OFFICE, TYPE A	CAL MO	6	6					
70102625	TRAFFIC CONTROL AND PROTECTION, STANDARD 701606	L SUM	1	1					

SUMMARY OF QUANTITIES			URBAN 100% STATE	CONSTRUCTION TYPE CODE					
CODE NO	ITEM	UNIT	TOTAL QUANTITIES	I000					
70300100	SHORT-TERM PAVEMENT MARKING	FOOT	5124	5124					
70300210	TEMPORARY PAVEMENT MARKING - LETTERS AND SYMBOLS	SQ FT	510	510					
70300220	TEMPORARY PAVEMENT MARKING - LINE 4"	FOOT	45188	45188					
70300240	TEMPORARY PAVEMENT MARKING - LINE 6"	FOOT	9792	9792					
70300260	TEMPORARY PAVEMENT MARKING - LINE 12"	FOOT	2464	2464					
70300280	TEMPORARY PAVEMENT MARKING - LINE 24"	FOOT	2280	2280					
* 78000100	THERMOPLASTIC PAVEMENT MARKING - LETTERS AND SYMBOLS	SQ FT	255	255					
* 78000200	THERMOPLASTIC PAVEMENT MARKING - LINE 4"	FOOT	22594	22594					
* 78000400	THERMOPLASTIC PAVEMENT MARKING - LINE 6"	FOOT	4896	4896					
* 78000600	THERMOPLASTIC PAVEMENT MARKING - LINE 12"	FOOT	1232	1232					
* 78000650	THERMOPLASTIC PAVEMENT MARKING - LINE 24"	FOOT	1140	1140					
* 78100100	RAISED REFLECTIVE PAVEMENT MARKER	EACH	326	326					
78300200	RAISED REFLECTIVE PAVEMENT MARKER REMOVAL	EACH	326	326					
* 88600600	DETECTOR LOOP REPLACEMENT	FOOT	985	985					
X0322256	TEMPORARY INFORMATION SIGNING	SQ FT	51.4	51.4					
X0656100	DRIVEWAY PAVEMENT REMOVAL AND REPLACEMENT	SQ YD	64	64					
X4066548	POLYMERIZED BITUMINOUS CONCRETE SURFACE COURSE, SUPERPAVE, MIX "F", N90	TON	2400	2400					
X4067100	POLYMERIZED LEVELING BINDER (MACHINE METHOD), SUPERPAVE, IL-4.75, N50	TON	909	909					
X4409400	BITUMINOUS SURFACE REMOVAL 1 3/4"	SQ YD	2838	2838					
Z0018500	DRAINAGE STRUCTURES TO BE CLEANED	EACH	43	43					

* SPECIALTY ITEMS

REVISIONS	
NAME	DATE

ILLINOIS DEPARTMENT OF TRANSPORTATION
SUMMARY OF QUANTITIES
TOUHY AVENUE

4/6/2006 10:45:00 AM C:\pcc\cib\tr\tr\2006\112020\sum.m3

F.A.U. RTE.	SECTION	COUNTY	TOTAL SHEETS	SHEET NO.
1370	2727&2828RS-4	COOK	20	4
STA.	TO STA.			
FED. ROAD DIST. NO.	ILLINOIS	FED. AID PROJECT		

CONTRACT NO. 60722

LEGEND

- ① EXISTING COMBINATION CONCRETE CURB AND GUTTER, TYPE B6.12
- ② EXISTING P.C.C. BASE (7 ") ±
- ③ EXISTING BITUMINOUS OVERLAY (3 3/4 ") ±
- ④ EXISTING STABILIZED SUBBASE, 4"
- ⑤ PROPOSED BITUMINOUS SURFACE REMOVAL, 2 1/2"
- ⑥ PROPOSED BITUMINOUS SURFACE REMOVAL, 1 3/4"
- ⑦ PROPOSED POLYMERIZED LEVELING BINDER (MACHINE METHOD), SUPERPAVE, IL-4.75, N50, 3/4"
- ⑧ PROPOSED POLYMERIZED BITUMINOUS CONCRETE SURFACE COURSE, SUPERPAVE, MIX "F", N90, 1 3/4"

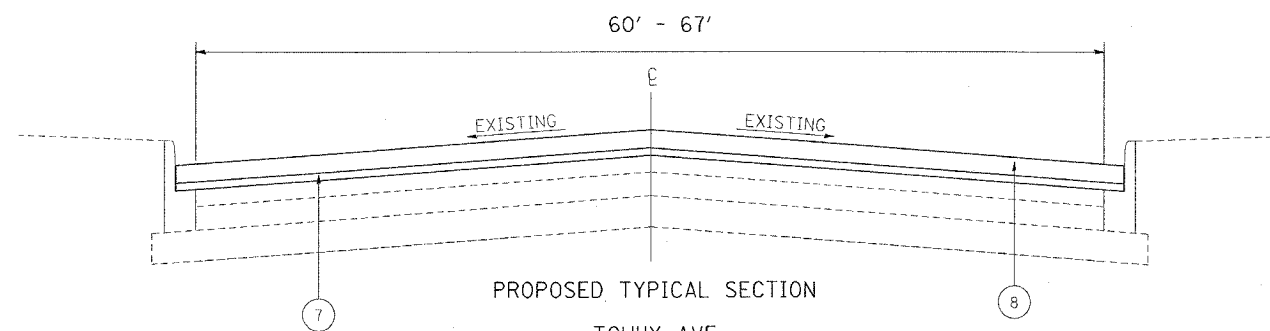
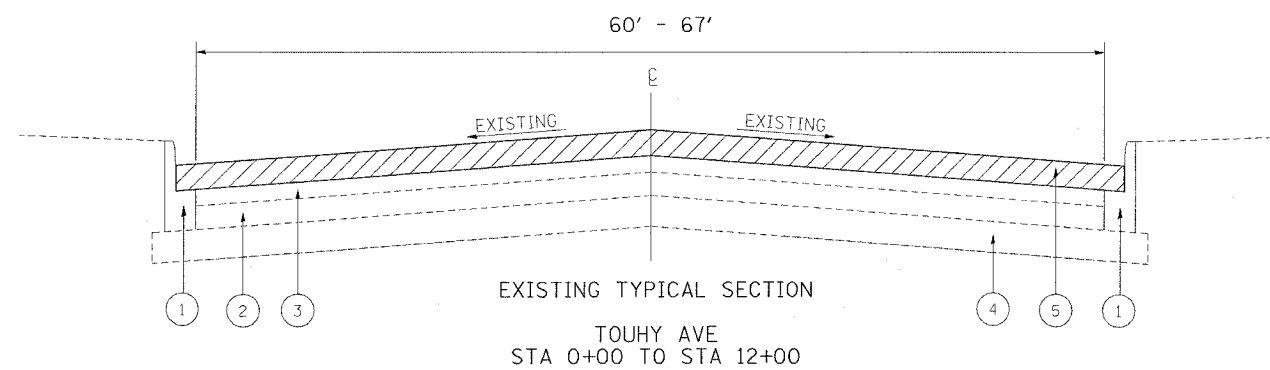

NOTES:

- REMOVAL OF THE BITUMINOUS OVERLAY ON GUTTER TO BE INCLUDED IN BITUMINOUS SURFACE REMOVAL, 2-1/2"
- WHERE THERE ARE NO PARKING LANES, RESURFACING WILL BE THE FULL DEPTH OF 2-1/2". SEE PLAN SHEETS FOR AREA OF PARKING LANES

MIXTURE REQUIREMENTS

MIXTURE USES	POLYMERIZED LEVELING BINDER (MACHINE METHOD), SUPERPAVE, IL-4.75, N50	POLYMERIZED BITUMINOUS CONCRETE SURFACE COURSE, SUPERPAVE, MIX "F", N90	BITUMINOUS REPLACEMENT OVER PATCHES - (BINDER IL-19MM)	CLASS D PATCHES (BINDER IL-19MM)	BITUMINOUS BASE COURSE WIDENING, SUPERPAVE
AC/PG:	SBS/SBR PG 76-28	SBS/SBR 70-22	PG 64-22	PG 64-22	PG 58-22
RAP % (MAX)	0	0	15	15	50
DESIGN AIR VOIDS	2.5 % @ 50 GYR	4% @ 90 GYR	4% @ 70 GYR	4% @ 70 GYR	2% @ 50 GYR

THE UNIT WEIGHT USED TO CALCULATE ALL BITUMINOUS SURFACE MIX QUANTITIES IS 112 LBS/SQYD/IN

REVISIONS	
NAME	DATE

ILLINOIS DEPARTMENT OF TRANSPORTATION
TOUHY AVENUE
EXISTING AND PROPOSED
TYPICAL CROSS SECTIONS
SCALE: NO SCALE
DATE
DRAWN BY
CHECKED BY

F.A.U. RTE.	SECTION	COUNTY	TOTAL SHEETS	SHEET NO.
1340	(2727&2828)RS-4	COOK	20	5
STA.	TO STA.			
FED. ROAD DIST. NO.	ILLINOIS FED. AID PROJECT			

CONTRACT NO. 60722

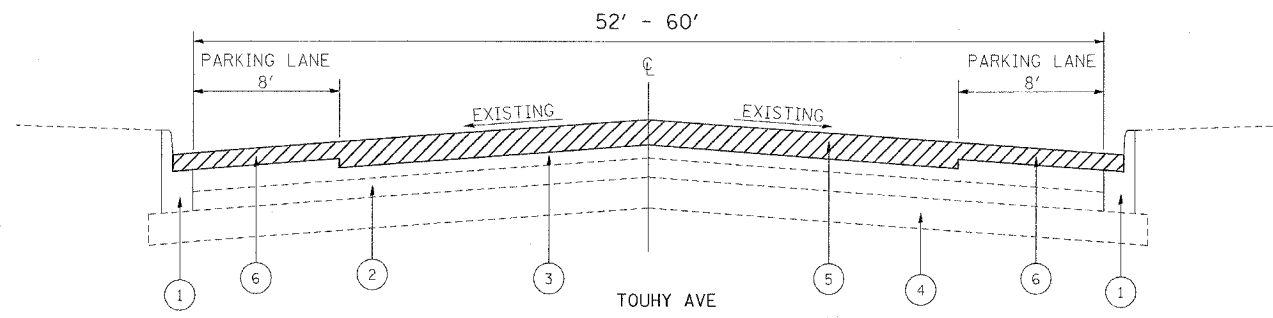

EXISTING TYPICAL SECTION
STA. 12+00 TO STA. 25+15
STA. 40+00 TO STA. 44+20

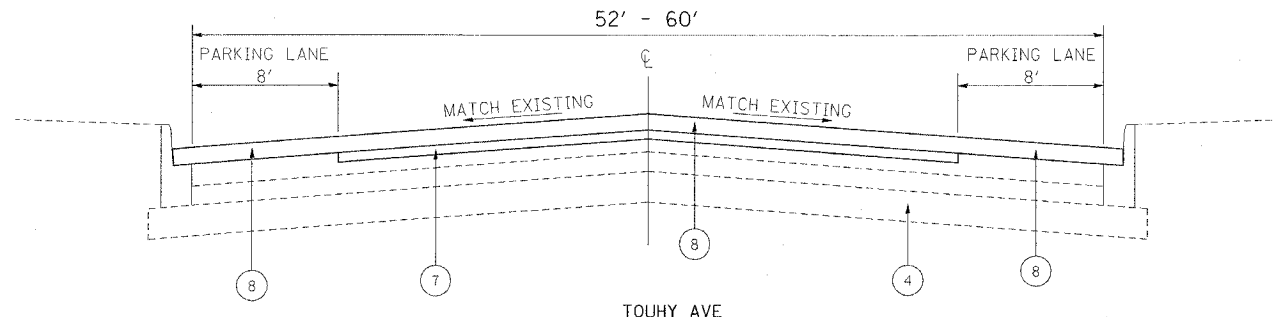

PROPOSED TYPICAL SECTION
STA. 12+00 TO STA. 25+15
STA. 40+00 TO STA. 44+20

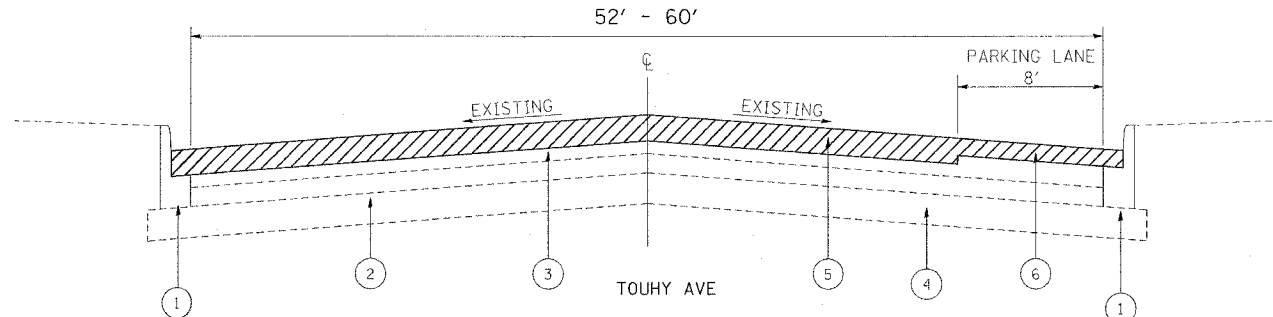

EXISTING TYPICAL SECTION
STA. 44+20 TO STA. 48+17 (PARKING LANE ON RIGHT)

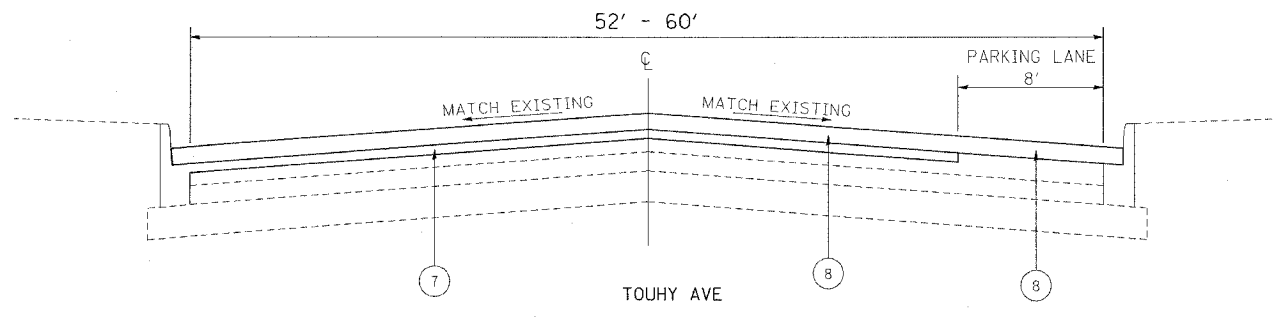

PROPOSED TYPICAL SECTION
STA. 44+20 TO STA. 48+17 (PARKING LANE ON RIGHT)

LEGEND

- ① EXISTING COMBINATION CONCRETE CURB AND GUTTER, TYPE B6.12
- ② EXISTING P.C.C. BASE (7 ") ±
- ③ EXISTING BITUMINOUS OVERLAY (3 3/4 ") ±
- ④ EXISTING STABILIZED SUBBASE, 4"
- ⑤ PROPOSED BITUMINOUS SURFACE REMOVAL, 2 1/2"
- ⑥ PROPOSED BITUMINOUS SURFACE REMOVAL, 1 3/4"
- ⑦ PROPOSED POLYMERIZED LEVELING BINDER (MACHINE METHOD), SUPERPAVE, IL-4.75, N50, 3/4"
- ⑧ PROPOSED POLYMERIZED BITUMINOUS CONCRETE SURFACE COURSE, SUPERPAVE, MIX "F", N90, 1 3/4"

NOTES:

- REMOVAL OF THE BITUMINOUS OVERLAY ON GUTTER TO BE INCLUDED IN BITUMINOUS SURFACE REMOVAL, 2-1/2"
- WHERE THERE ARE NO PARKING LANES, RESURFACING WILL BE THE FULL DEPTH OF 2-1/2". SEE PLAN SHEETS FOR AREA OF PARKING LANES

REVISIONS	
NAME	DATE

ILLINOIS DEPARTMENT OF TRANSPORTATION
TOUHY AVENUE
EXISTING AND PROPOSED
TYPICAL CROSS SECTIONS

SCALE: NO SCALE
DATE
DRAWN BY
CHECKED BY

PLOT DATE = 4/6/2006
 FILE NAME = c:\p\projects\2006\1228281\1228281.dwg
 PLOT SCALE = 1/8" = 1'-0"
 USER NAME = ommhnm

F.A.I. RTE.	SECTION	COUNTY	TOTAL SHEETS	SHEET NO.
1340	12727 & 2628RS-4	COOK	20	6
STA. 0+00		TO STA. 25+18		
FED. ROAD DIST. NO.	ILLINOIS	FED. AID PROJECT		

CONTRACT NO. 60722

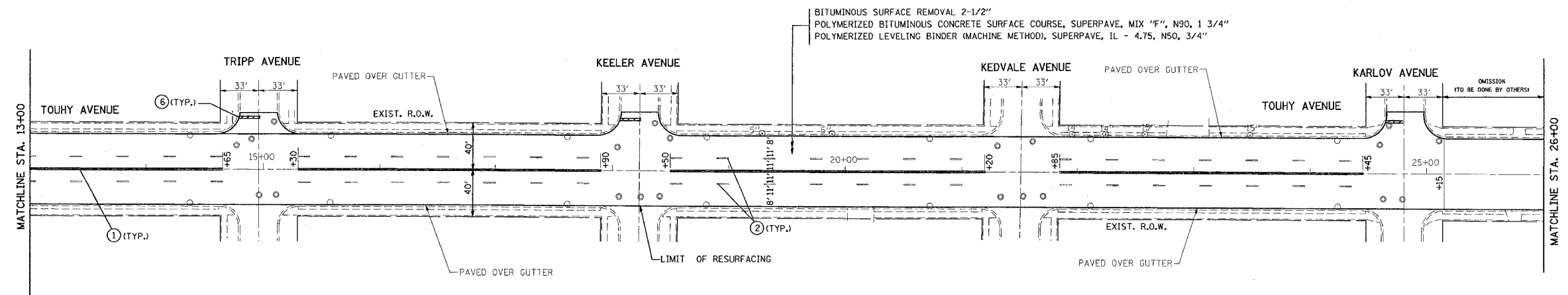
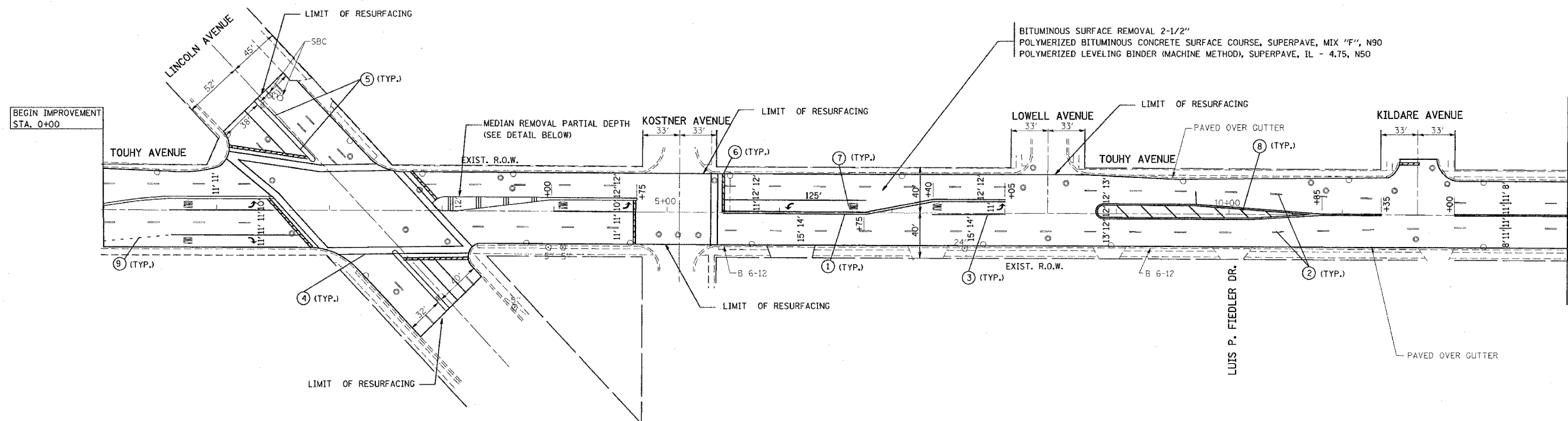

STRIPING LEGEND

- ① 4" DOUBLE YELLOW
- ② 4" LANE LINE - WHITE (10' DASH, 30' SPACED)
- ③ 6" TURN LANE - WHITE
- ④ 6" CROSS WALK - WHITE (2 @ 6' SPACE)
- ⑤ 4" MEDIAN OUTLINE - YELLOW
- ⑥ 24" STOP BAR - WHITE
- ⑦ LETTERS & SYMBOLS - WHITE - LARGE
- ⑧ 12" DIAGONALS - YELLOW
- ⑨ 6" DASHED LINE - WHITE (2' DASH, 6' SPACE)
- ⑩ 12" DIAGONALS - WHITE

NOTES:
ALL PAVEMENT MARKING SHALL BE PLACED THROUGHOUT THE IMPROVEMENT ACCORDING TO DISTRICT 1 TYPICAL PAVEMENT MARKING.

RAISED REFLECTIVE PAVEMENT MARKERS SHALL BE PLACED THROUGHOUT THE IMPROVEMENT ACCORDING TO THE TYPICAL APPLICATION OF RAISED REFLECTIVE PAVEMENT MARKER DETAIL. DOUBLE PAVEMENT MARKERS SHALL BE USED AS NOTED IN THE DETAIL.

THE RESIDENT ENGINEER SHALL VERIFY ALL EXISTING PAVEMENT MARKING BEFORE MILLING.

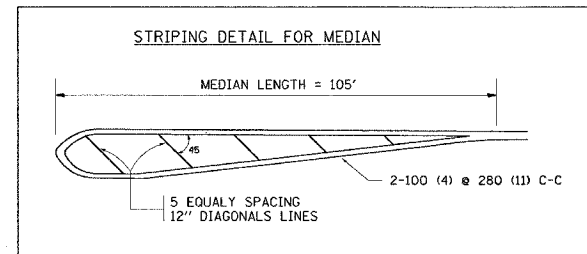
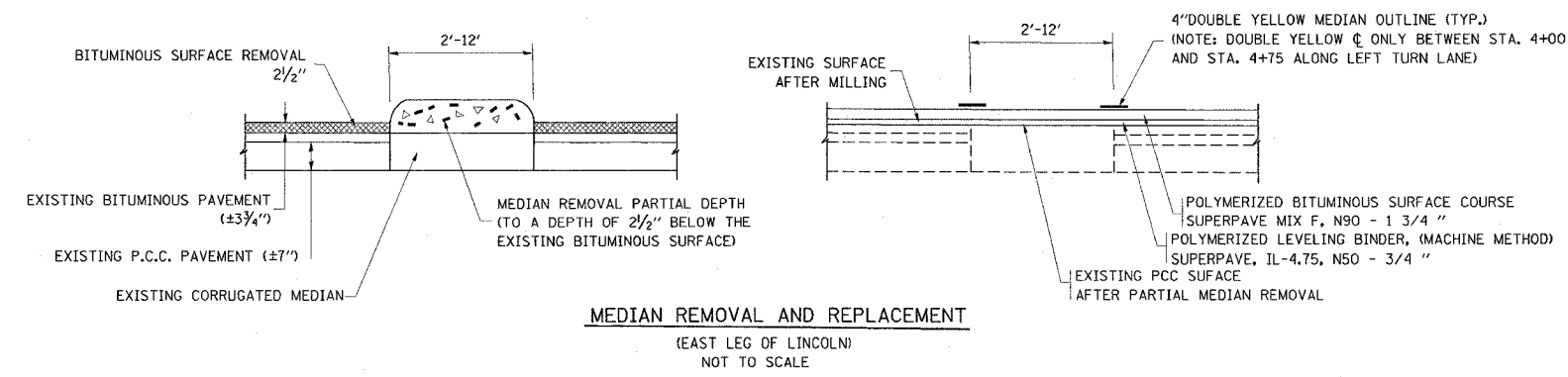

REVISIONS	
NAME	DATE

ILLINOIS DEPARTMENT OF TRANSPORTATION
TOUHY AVENUE
ROADWAY AND PAVEMENT MARKING PLANS
STA. 0+00 TO STA. 26+00

SCALE: VERT. 1"=50'
HORIZ. 1"=50'

DATE: _____ DRAWN BY: _____
CHECKED BY: _____

PLOT DATE = 4/6/2006
 FILE NAME = c:\projects\12727\12727.dwg
 USER NAME = gchenahm

F.A.U. RTE.	SECTION	COUNTY	TOTAL SHEETS	SHEET NO.
1340	42727 & 28281RS-4	COOK	20	7
STA. 26+00		TO STA. 53+14		
FED. ROAD DIST. NO.	ILLINOIS	FED. AID PROJECT		

CONTRACT NO. 60722

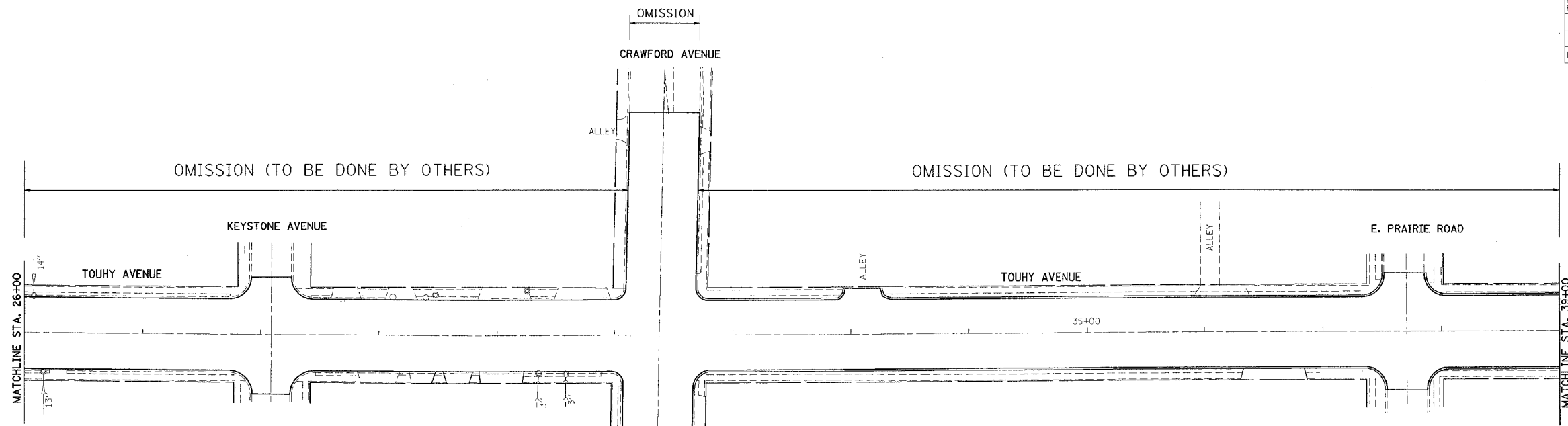

STRIPING LEGEND

- ① 4" DOUBLE YELLOW
- ② 4" LANE LINE - WHITE (10' DASH, 30' SPACE)
- ③ 6" TURN LANE - WHITE
- ④ 6" CROSS WALK - WHITE (6' SOLID @ 2' SPACE)
- ⑤ 4" MEDIAN OUTLINE - YELLOW
- ⑥ 24" STOP BAR - WHITE
- ⑦ LETTERS & SYMBOLS - WHITE - LARGE
- ⑧ 12" DIAGONALS - YELLOW
- ⑨ 6" DASHED LINE - WHITE (2' DASH, 6' SPACE)
- ⑩ 4" EDGE LINE - WHITE
- ⑪ 12" DIAGONALS - WHITE

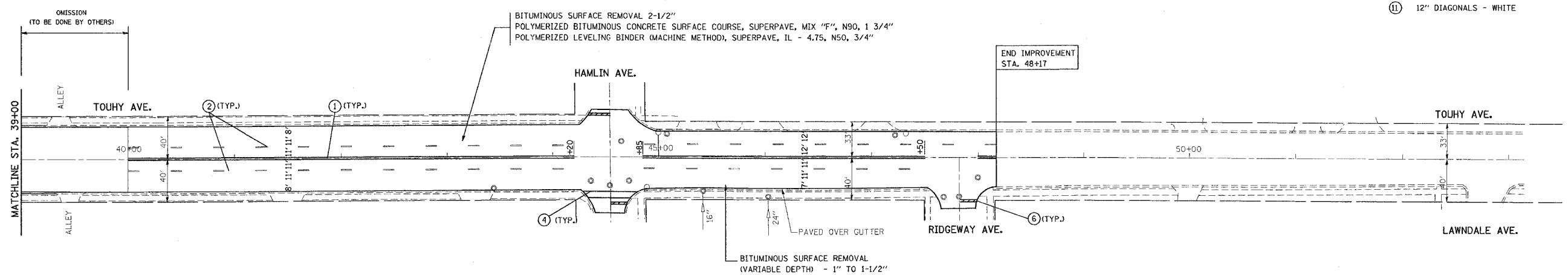

NOTES:
ALL PAVEMENT MARKING SHALL BE PLACED THROUGHOUT THE IMPROVEMENT ACCORDING TO DISTRICT 1 TYPICAL PAVEMENT MARKING.

RAISED REFLECTIVE PAVEMENT MARKERS SHALL BE PLACED THROUGHOUT THE IMPROVEMENT ACCORDING TO THE TYPICAL APPLICATION OF RAISED REFLECTIVE PAVEMENT MARKER DETAIL DOUBLE PAVEMENT MARKERS SHALL BE USED AS NOTED IN THE DETAIL.

THE RESIDENT ENGINEER SHALL VERIFY ALL EXISTING PAVEMENT MARKING BEFORE MILLING.

REVISIONS	
NAME	DATE

ILLINOIS DEPARTMENT OF TRANSPORTATION

TOUHY AVENUE
ROADWAY AND PAVEMENT MARKING PLANS
STA. 26+00 TO END IMPROVEMENT

SCALE: VERT. 1"=50'
HORIZ. 1"=50'

DATE _____ DRAWN BY _____
CHECKED BY _____

PLOT DATE = 4/6/2006
FILE NAME = c:\proje\1340\1340281\1340281.dwg
PLOT SCALE = 1/8"=1'-0" / IN.
USER NAME = csmhsh

SECTION	COUNTY	TOTAL SHEETS	SHEET NO.
1240	COOK	20	8
STA. TO STA.		FED. ROAD DIST NO 7 ILLINOIS	
		FED AID PROJECT	

CONTRACT NO.: 60722

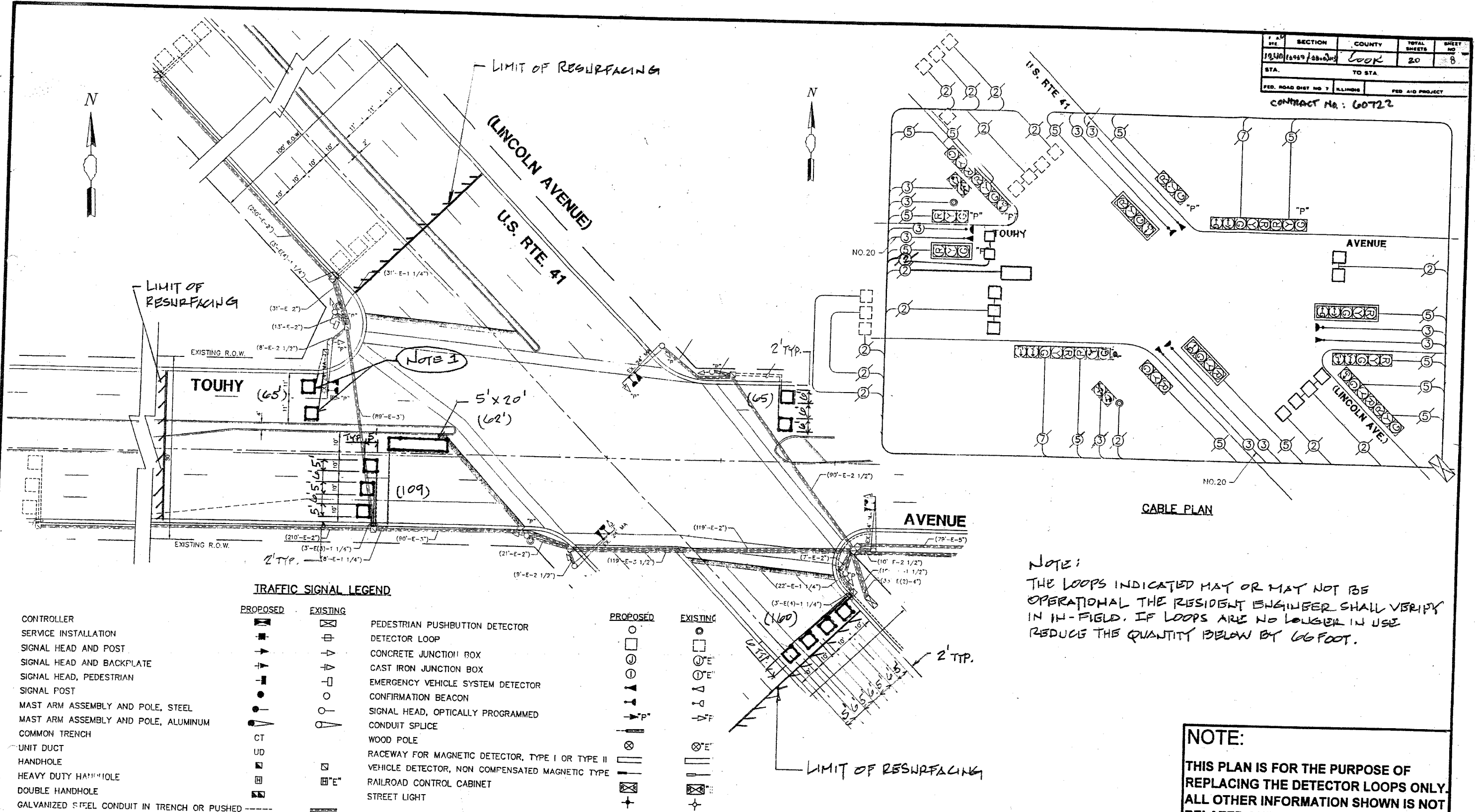

TRAFFIC SIGNAL LEGEND

CONTROLLER	EXISTING	PEDESTRIAN PUSHBUTTON DETECTOR	PROPOSED	EXISTING	DETECTOR LOOP
SERVICE INSTALLATION	EXISTING	DETECTOR LOOP	PROPOSED	EXISTING	CONCRETE JUNCTION BOX
SIGNAL HEAD AND POST	EXISTING	CAST IRON JUNCTION BOX	PROPOSED	EXISTING	EMERGENCY VEHICLE SYSTEM DETECTOR
SIGNAL HEAD AND BACKPLATE	EXISTING	EMERGENCY VEHICLE SYSTEM DETECTOR	PROPOSED	EXISTING	CONFIRMATION BEACON
SIGNAL HEAD, PEDESTRIAN	EXISTING	CONFIRMATION BEACON	PROPOSED	EXISTING	SIGNAL HEAD, OPTICALLY PROGRAMMED
SIGNAL POST	EXISTING	SIGNAL HEAD, OPTICALLY PROGRAMMED	PROPOSED	EXISTING	CONDUIT SPLICE
MAST ARM ASSEMBLY AND POLE, STEEL	EXISTING	CONDUIT SPLICE	PROPOSED	EXISTING	WOOD POLE
MAST ARM ASSEMBLY AND POLE, ALUMINUM	EXISTING	WOOD POLE	PROPOSED	EXISTING	RACEWAY FOR MAGNETIC DETECTOR, TYPE I OR TYPE II
COMMON TRENCH	EXISTING	RACEWAY FOR MAGNETIC DETECTOR, TYPE I OR TYPE II	PROPOSED	EXISTING	VEHICLE DETECTOR, NON COMPENSATED MAGNETIC TYPE
UNIT DUCT	EXISTING	VEHICLE DETECTOR, NON COMPENSATED MAGNETIC TYPE	PROPOSED	EXISTING	RAILROAD CONTROL CABINET
HANDHOLE	EXISTING	RAILROAD CONTROL CABINET	PROPOSED	EXISTING	STREET LIGHT
HEAVY DUTY HANDHOLE	EXISTING	STREET LIGHT	PROPOSED	EXISTING	
DOUBLE HANDHOLE	EXISTING		PROPOSED	EXISTING	
GALVANIZED STEEL CONDUIT IN TRENCH OR PUSHED	EXISTING		PROPOSED	EXISTING	

NOTE:
THE LOOPS INDICATED MAY OR MAY NOT BE OPERATIONAL. THE RESIDENT ENGINEER SHALL VERIFY IN THE FIELD. IF LOOPS ARE NO LONGER IN USE REDUCE THE QUANTITY BELOW BY 66 FOOT.

NOTE:
THIS PLAN IS FOR THE PURPOSE OF REPLACING THE DETECTOR LOOPS ONLY. ALL OTHER INFORMATION SHOWN IS NOT RELATED AND WILL BE DISREGARDED.

REPLACE ALL DETECTOR LOOPS AS SHOWN
(WITHIN THE RESURFACING LIMITS)

CODE NO.	QUANTITY	UNIT	ITEM
00000000	461	Foot	Detector Loop Replacement

REVISIONS	
NAME	DATE

ILLINOIS DEPARTMENT OF TRANSPORTATION
DETECTOR LOOP REPLACEMENT
U.S. RTE. 41 @ TOUHY AVENUE
SCALE: 1" = 20'
DATE: APRIL 2005
DRAWN BY: JHE
DESIGNED BY: JHE
CHECKED BY: JHE

P. & S. SHE.	SECTION	COUNTY	TOTAL SHEETS	SHEET NO.
1349 (1/17/05) 451	ASH	COOK	20	9
STA.		TO STA.		
FED. ROAD DIST NO. 7		ILLINOIS		FED. AID PROJECT

CONTRACT NO.: 00722

TRAFFIC SIGNAL LEGEND

- CONTROLLER
- SERVICE INSTALLATION
- SIGNAL HEAD AND POST
- SIGNAL HEAD AND BACKPLATE
- SIGNAL HEAD, PEDESTRIAN
- SIGNAL POST
- MAST ARM ASSEMBLY AND POLE, STEEL
- MAST ARM ASSEMBLY AND POLE, ALUMINUM
- COMMON TRENCH
- UNIT DUCT
- HANDHOLE
- HEAVY DUTY HANDHOLE
- DOUBLE HANDHOLE
- GALVANIZED STEEL CONDUIT IN TRENCH OR PUSHED

- | PROPOSED | EXISTING | PROPOSED | EXISTING |
|----------|----------|----------|----------|
| | | | |
| | | | |
| | | | |
| | | | |
| | | | |
| | | | |
| | | | |

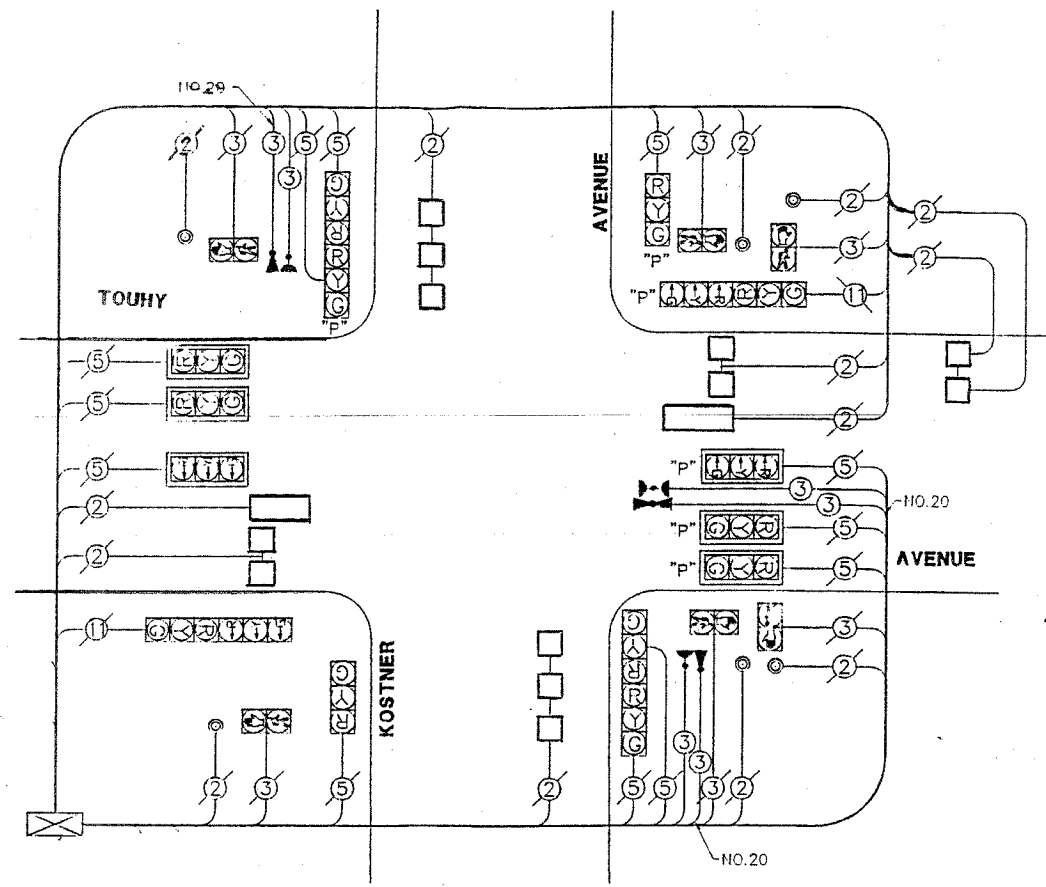

CABLE PLAN

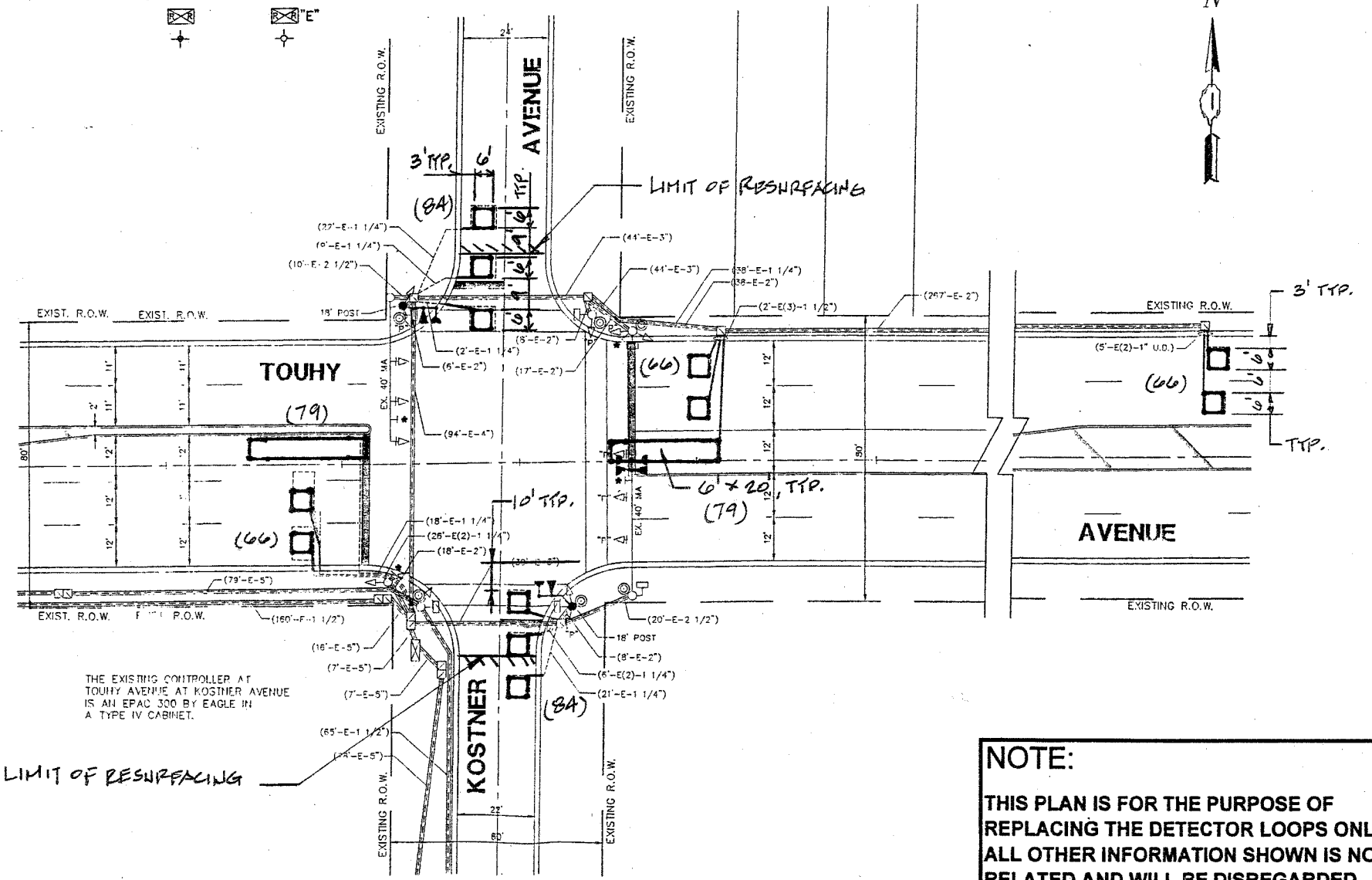

THE EXISTING CONTROLLER AT TOUHY AVENUE AT KOSTNER AVENUE IS AN EPAC 300 BY EAGLE IN A TYPE IV CABINET.

NOTE:
THIS PLAN IS FOR THE PURPOSE OF REPLACING THE DETECTOR LOOPS ONLY. ALL OTHER INFORMATION SHOWN IS NOT RELATED AND WILL BE DISREGARDED.

REPLACE ALL DETECTOR LOOPS AS SHOWN
(WITHIN THE RESURFACING LIMITS)

CODE NO.	QUANTITY	UNIT	ITEM
524	524	Foot	Detector Loop Replacement

REVISIONS	
NAME	DATE

ILLINOIS DEPARTMENT OF TRANSPORTATION
DETECTOR LOOP REPLACEMENT
TOUHY AVE. @ KOSTNER AVE
SCALE: 1" = 20'
DATE: APRIL, 2005
DRAWN BY: JHE
DESIGNED BY: JHE
CHECKED BY: JHE

P. A. REL.	SECTION	COUNTY	TOTAL SHEETS	SHEET NO.
1340	*	COOK	20	11
STA.	TO STA.			
FED. ROAD DIST. NO.	ILLINOIS	FED. AID PROJECT		

* SECTION: (2727 & 2828) RS-4
CONTRACT No.: 60722

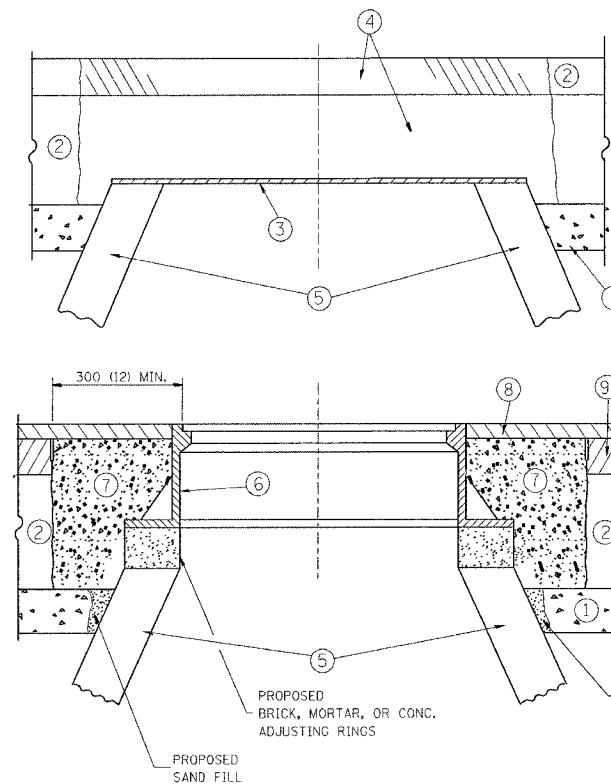

CONSTRUCTION PROCEDURES

STAGE 1 (BEFORE PAVEMENT MILLING)

- A) REMOVE A MINIMUM OF 300 (12) OF THE PAVEMENT FROM AROUND THE STRUCTURE.
- B) REMOVE THE EXISTING FRAME AND LID FROM THE STRUCTURE.
- C) COVER THE STRUCTURE OPENING WITH A 900 (36) DIAMETER METAL PLATE.
- D) BACKFILL WITH CRUSHED STONE AND A MINIMUM 40 (1 1/2) THICK BITUMINOUS MATERIAL APPROVED BY THE ENGINEER.

STAGE 2 (AFTER PAVEMENT MILLING)

- A) REMOVE THE BITUMINOUS MATERIAL AND CRUSHED STONE.
- B) INSTALL THE FRAME AND LID; ADJUST THE FRAME TO ITS FINAL SURFACE ELEVATION.
- C) THE SURROUNDING SPACE SHALL BE FILLED WITH CLASS SI CONCRETE, OR BITUMINOUS CONCRETE SURFACE OR BINDER COURSE MATERIAL TO THE ELEVATION OF THE SURFACE OF THE EXISTING BASE COURSE OR THE BINDER COURSE.

THE PROCEDURE EXPLAINED ABOVE SHALL CONFORM TO THE APPLICABLE PORTIONS OF SECTIONS 353, 406, 602, AND 603 OF THE STANDARD SPECIFICATIONS.

LEGEND

- ① SUB-BASE GRANULAR MATERIAL
- ② EXISTING PAVEMENT
- ③ 900 (36) DIAMETER METAL PLATE
- ④ PROPOSED CRUSHED STONE AND BITUMINOUS MATERIAL
- ⑤ EXISTING STRUCTURE
- ⑥ FRAME AND LID (SEE NOTES)
- ⑦ CLASS SI CONCRETE, BITUMINOUS CONCRETE SURFACE OR BINDER COURSE MATERIAL
- ⑧ PROPOSED BITUMINOUS CONCRETE SURFACE COURSE
- ⑨ PROPOSED BITUMINOUS CONCRETE BINDER COURSE

NOTES:

EXISTING BROKEN FRAMES AND LIDS SHALL BE REMOVED AND DISPOSED OF BY THE CONTRACTOR AND SHALL BE REPLACED AS DIRECTED BY THE ENGINEER. REPLACEMENT FRAMES AND LIDS WILL BE PAID FOR IN ACCORDANCE WITH ARTICLE 109.04 OF THE STANDARD SPECIFICATIONS UNLESS A SEPARATE PAY ITEM HAS BEEN PROVIDED.

IF THE EXISTING LIDS ARE OPEN, THE FRAME WILL BE ADJUSTED TO THE ELEVATION OF THE MILLED PAVEMENT SURFACE PRIOR TO THE MILLING OPERATION. THE FRAME WILL NOT BE REMOVED AND COVERED BY THE METAL PLATE.

CITY OF CHICAGO CASTINGS ARE THE PROPERTY OF THE CITY AND THE CONTRACTOR SHALL NOTIFY THE CITY FOR REMOVAL AND DISPOSITION OF THE CASTINGS.

THE METAL PLATE USED TO COVER THE STRUCTURE SHALL REMAIN THE PROPERTY OF THE CONTRACTOR.

WHEN STRUCTURES ARE TO BE ADJUSTED OR RECONSTRUCTED, THE LOWERING AND RAISING OF THE FRAMES AND LIDS WILL NOT BE PAID FOR SEPARATELY BUT WILL BE INCLUDED IN THE COST OF THE CORRESPONDING PAY ITEM.

LOCATION OF STRUCTURES:

THE CONTRACTOR WILL BE REQUIRED TO KEEP A RECORD OF THE LOCATIONS OF THE BURIED STRUCTURES ACCORDING TO THE STATION AND DISTANCE LEFT OR RIGHT OF THE CENTERLINE OF PAVEMENT. UPON COMPLETION OF THE WORK, THE CONTRACTOR WILL DELIVER THE RECORD TO THE ENGINEER.

BASIS OF PAYMENT: FRAMES AND LIDS TO BE ADJUSTED, SPECIAL EACH

NEW FRAMES AND LIDS, WHEN SPECIFIED, WILL BE PAID FOR SEPARATELY.

DETAILS FOR FRAMES AND LIDS ADJUSTMENT WITH MILLING

ALL DIMENSIONS ARE IN MILLIMETERS (INCHES) UNLESS OTHERWISE SHOWN

ILLINOIS DEPARTMENT OF TRANSPORTATION

DETAILS FOR FRAMES AND LIDS ADJUSTMENT WITH MILLING

REVISIONS	
NAME	DATE
R. SHAH	10/25/94
R. SHAH	01/30/95
R. SHAH	03/10/95
A. ABBAS	03/21/97
R. WIEDEMAN	05/14/04

SCALE: NONE
DATE: 10/7/2005

DRAWN BY
CHECKED BY
BD600-03 (BD-8)

REVISION DATE: 05/17/04

F.A. RTE.	SECTION	COUNTY	TOTAL SHEETS	SHEET NO.
1340	*	COOK	20	12
STA.	TO STA.			
FED. ROAD DIST. NO.	ILLINOIS	FED. AID PROJECT		

* SECTION: (2727 & 2828) RS-4
CONTRACT No.: 60722

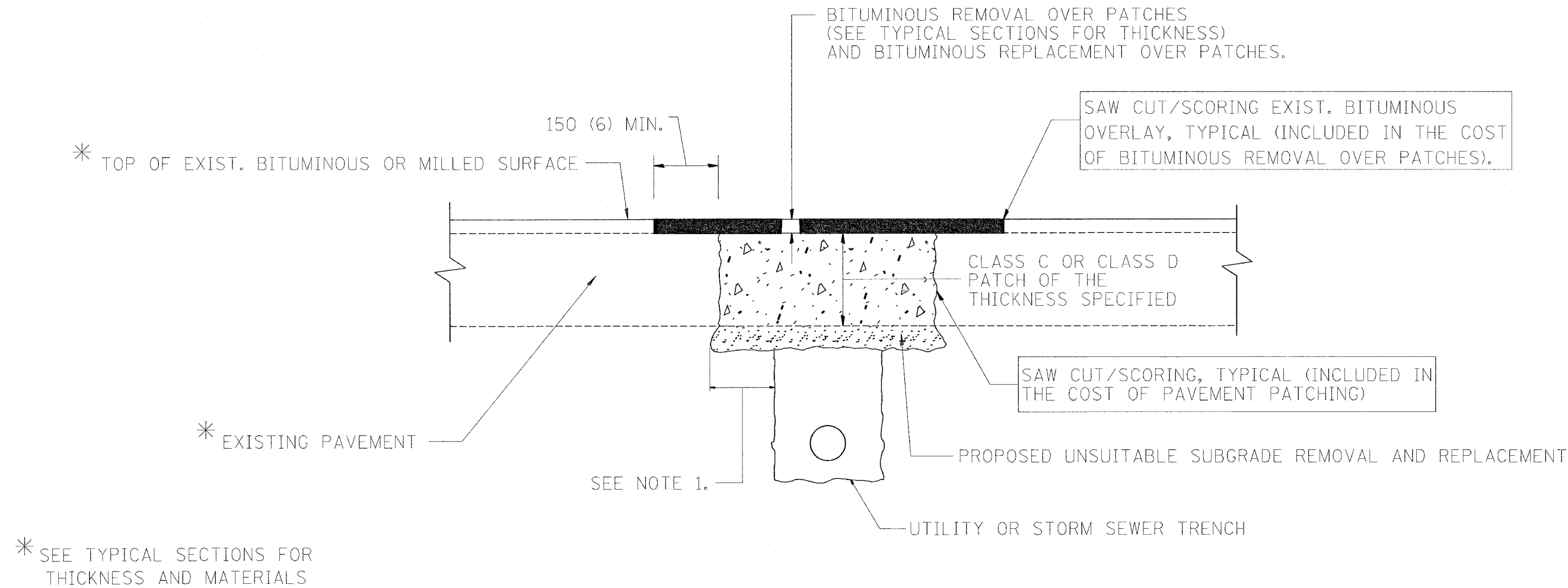

NOTES:

1. THE WIDTH OF THE FULL DEPTH PATCH OVER A TRENCH SHALL BE 300 (12) WIDER ON EACH SIDE OF THE TRENCH.
2. FOR METHOD OF MEASUREMENT AND BASIS OF PAYMENT, SEE SPECIAL PROVISION "PATCHING WITH BITUMINOUS OVERLAY REMOVAL".

SEQUENCE OF CONSTRUCTION

1. REMOVE THE EXISTING BITUMINOUS MATERIAL OVER THE AREA TO BE PATCHED.
2. REMOVE AND REPLACE FULL DEPTH PATCHES
3. REPLACE BITUMINOUS MATERIAL OVER THE AREA TO BE PATCHED.

ALL DIMENSIONS ARE IN MILLIMETERS (INCHES) UNLESS OTHERWISE SHOWN.

REVISIONS	
NAME	DATE
R. SHAH	10/25/94
R. SHAH	01/14/95
R. SHAH	03/23/95
R. SHAH	04/24/95
A. HOUSEH	03/15/96
A. ABBAS	03/21/97
A. ABBAS	01/20/98
ART ABBAS	04/27/98

ILLINOIS DEPARTMENT OF TRANSPORTATION
PAVEMENT PATCHING FOR BITUMINOUS SURFACED PAVEMENT

SCALE: VERT. _____
HORIZ. _____
DATE 10/7/2005
DRAWN BY _____
CHECKED BY _____

F. & S. NO.	SECTION	COUNTY	TOTAL SHEETS	SHEET NO.
1340	*	COOK	20	14
STA.	TO STA.			
FED. ROAD DIST. NO.	ILLINOIS	FED. AID PROJECT		

* SECTION: (2727 & 2828) RS-4
CONTRACT No.: 60722

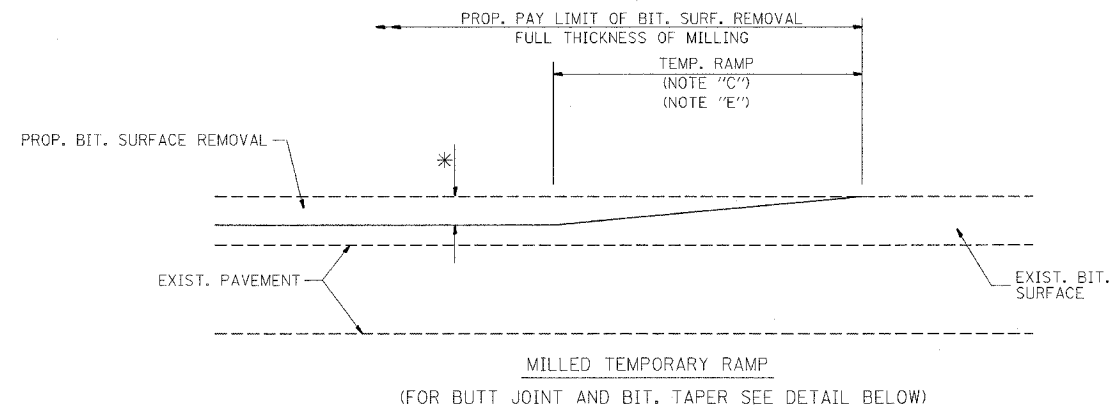

OPTION 1

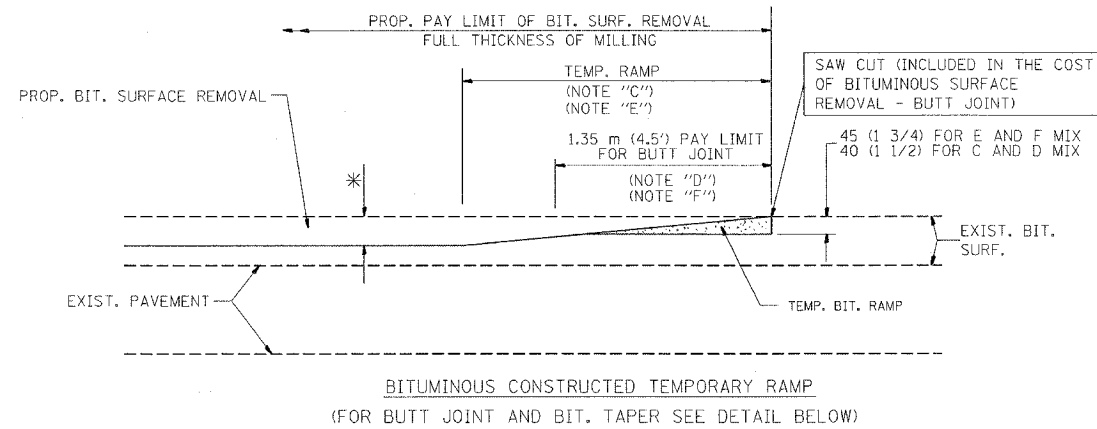

OPTION 2
TYPICAL TEMPORARY RAMP

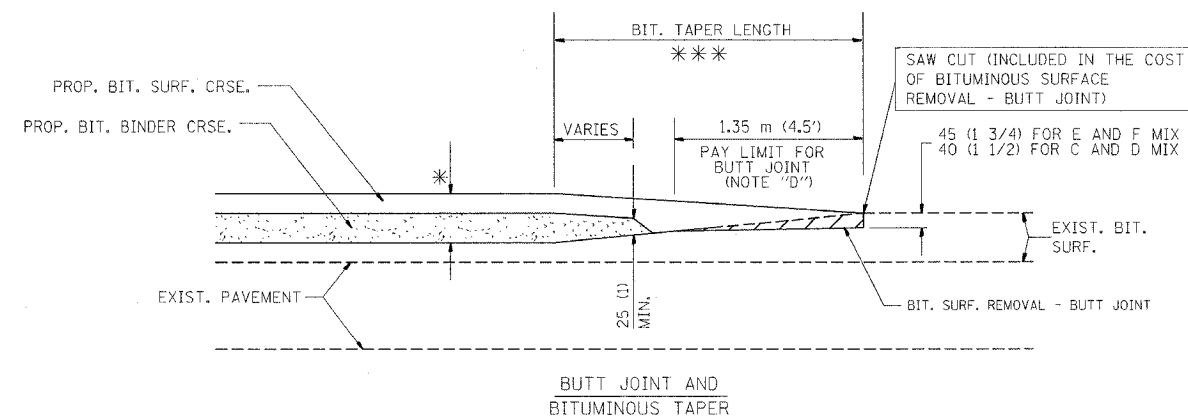

TYPICAL BUTT JOINT AND BITUMINOUS TAPER
FOR MILLING AND RESURFACING

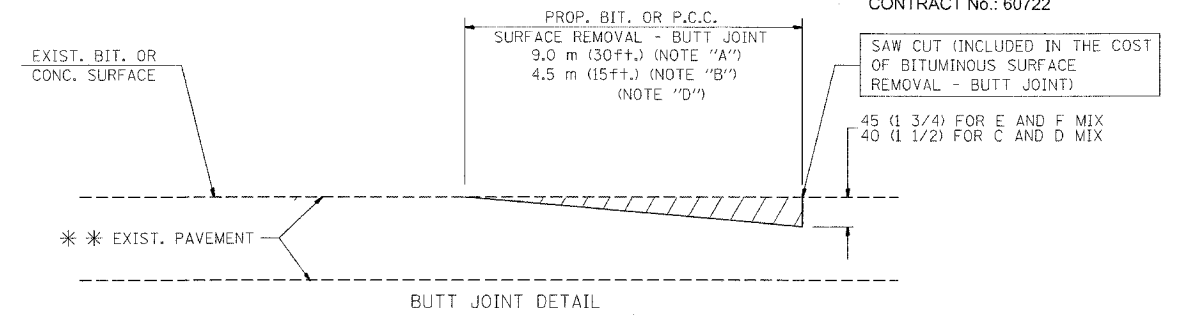

BUTT JOINT DETAIL

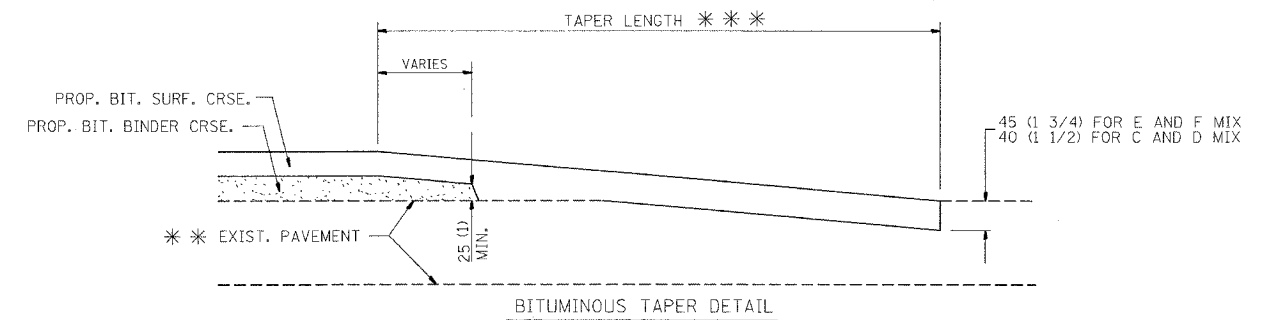

TYPICAL BUTT JOINT AND BITUMINOUS TAPER
FOR RESURFACING ONLY

*** PC CONCRETE, BITUMINOUS OR BITUMINOUS RESURFACED PAVEMENT.

NOTES

- A: MAINLINE ROADWAYS AND MAJOR SIDE ROADS.
 - B: MINOR SIDE ROADS.
 - C: THE TEMP. RAMP SHALL BE CONSTRUCTED IMMEDIATELY UPON REMOVAL OF THE EXISTING BITUMINOUS SURFACE.
 - D: THE BUTT JOINT SHALL BE CONSTRUCTED IMMEDIATELY PRIOR TO PLACING THE PROPOSED BITUMINOUS COURSES.
 - E: TAPER THE TEMP. RAMP AT A RATE OF 900 (3 FT.) PER INCH OF MILLING THICKNESS.
 - F: INSTALLATION AND REMOVAL OF THE 1.35 m (4.5') TEMP. BIT. RAMP WILL BE PAID AS "BITUMINOUS SURFACE REMOVAL - BUTT JOINT".
 - G: SEE ARTICLE 406.18 AND 406.24 OF THE STANDARD SPECIFICATIONS FOR "BITUMINOUS AND PCC SURFACE REMOVAL, BUTT JOINT".
- * SEE TYPICAL SECTIONS FOR MILLING THICKNESS.
- *** 6.1 m (20') PER 25 (1) RESURFACING (NOTE "A")
3.0 m (10') PER 25 (1) RESURFACING (NOTE "B")

ALL DIMENSIONS ARE IN MILLIMETERS (INCHES) UNLESS OTHERWISE SHOWN.

ILLINOIS DEPARTMENT OF TRANSPORTATION

BUTT JOINT AND BITUMINOUS TAPER DETAILS

SCALE: NONE
DATE PLOTTED: 10/7/2005

DRAWN BY
CHECKED BY
BD400-05 (VI-BD32)

REVISIONS	
NAME	DATE
M. DE YONG	6-13-90
M. DE YONG	7-3-90
M. DE YONG	3-27-92
R. SHAH	09/09/94
R. SHAH	10/25/94
A. ABBAS	03/21/97
M. GOMEZ	04/06/01

BASIS OF PAYMENT:

THE BUTT JOINT WILL BE PAID FOR PER SQUARE METER (SQUARE YARD.) AS "BITUMINOUS SURFACE REMOVAL - BUTT JOINT" OR AS "PORTLAND CEMENT CONCRETE SURFACE REMOVAL - BUTT JOINT".

F.A. RTE.	SECTION	COUNTY	TOTAL SHEETS	SHEET NO.
1340	*	COOK	20	15
STA.	TO STA.			
FED. ROAD DIST. NO. 1 ILLINOIS FED. AID PROJECT				

* SECTION: (2727 & 2828) RS-4
CONTRACT No.: 60722

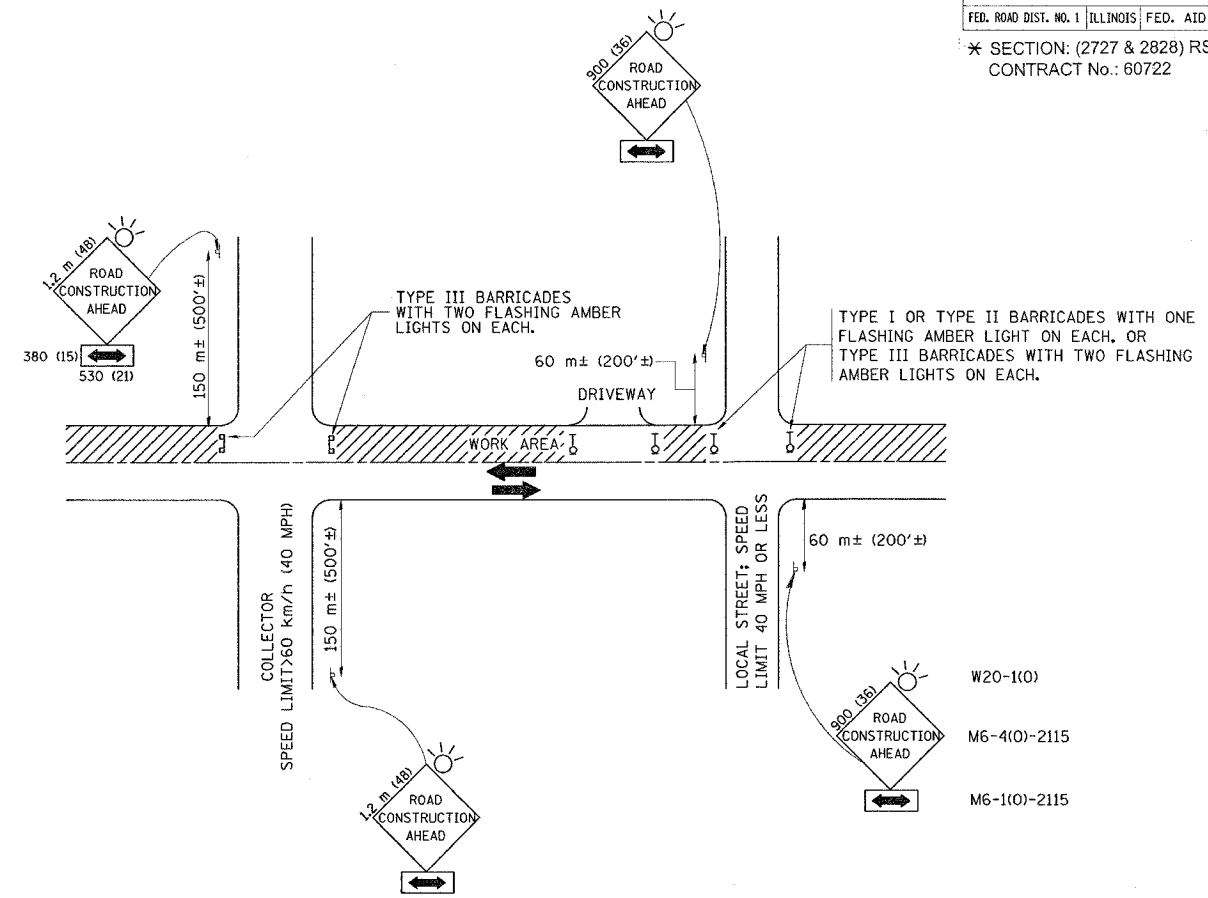

TRAFFIC CONTROL AND PROTECTION FOR SIDE ROADS, INTERSECTIONS, AND DRIVEWAYS

NOTES:

- A. FOR NO LANE RESTRICTION ON THE SIDE ROAD OR DRIVEWAYS
- SIDE ROAD WITH A SPEED LIMIT OF 60 km/h (40 MPH) OR LESS AS SHOWN ON THE DRAWING AND AS DIRECTED BY THE ENGINEER:
 - ONE **ROAD CONSTRUCTION AHEAD** SIGN 900x900 (36x36) WITH A FLASHER AND FLAG MOUNTED ON IT APPROXIMATELY 60 m (200') IN ADVANCE OF THE MAIN ROUTE.
 - THE CLOSED PORTION OF THE MAIN ROUTE SHALL BE PROTECTED BY BLOCKING WITH TYPE I, TYPE II OR TYPE III BARRICADES, 1/3 OF THE CROSS SECTION OF THE CLOSED PORTION.
 - SIDE ROAD WITH A SPEED LIMIT GREATER THAN 60 km/h (40 MPH) AS SHOWN ON THE DRAWING AND AS DIRECTED BY THE ENGINEER:
 - ONE **ROAD CONSTRUCTION AHEAD** SIGN 1.2 m x 1.2 m (48x48) WITH A FLASHER MOUNTED ON IT APPROXIMATELY 150 m (500') IN ADVANCE OF THE MAIN ROUTE.
 - THE CLOSED PORTION OF THE MAIN ROUTE SHALL BE PROTECTED BY BLOCKING WITH TYPE III BARRICADES, 1/2 OF THE CROSS SECTION OF THE CLOSED PORTION.
 - WHEN THE SIDE ROAD LIES BETWEEN THE BEGINNING OF THE MAINLINE SIGNING AND THE WORK ZONE, A SINGLE HEADED ARROW (M6-1) SHALL BE USED IN LIEU OF THE DOUBLE HEADED ARROW (M6-4).
- B. FOR A LANE CLOSURE ON A SIDE ROAD OR DRIVEWAY:
- USE APPLICABLE PORTIONS OF THE TYPICAL APPLICATION OF TRAFFIC CONTROL DEVICES (STD. 701501, STD. 701606 OR THE APPROPRIATE STANDARD). THE SPACING OF SIGNS AND BARRICADES SHALL BE ADJUSTED FOR FIELD CONDITIONS AS DIRECTED BY THE ENGINEER. THE DIRECTIONAL ARROW SHALL BE COVERED OR REMOVED WHEN NO LONGER CONSISTENT WITH THE SIDE ROAD LANE CLOSURE.
- C. ADVANCE WARNING SIGNS ARE TO BE OMITTED ON DRIVEWAY UNLESS OTHERWISE NOTED.
- D. THE TRAFFIC CONTROL AND PROTECTION FOR SIDE ROADS, INTERSECTIONS, AND DRIVEWAYS SHALL BE INCIDENTAL TO THE COST OF SPECIFIED TRAFFIC CONTROL STANDARDS OR ITEMS.

REVISIONS	
NAME	DATE
L.H.A.	6/89
T. RAMMACHER	09/08/94
J. OBERLE	10/18/95
A. HOUSEH	03/06/96
A. HOUSEH	10/15/96
T. RAMMACHER	01/06/00

ILLINOIS DEPARTMENT OF TRANSPORTATION
TRAFFIC CONTROL AND PROTECTION
FOR
SIDE ROADS, INTERSECTIONS, AND
DRIVEWAYS

SCALE: VERT. HORIZ.
DATE 10/7/2005

DRAWN BY
CHECKED BY
TC-10

CONTRACT NO.				
F.A. RTE.	SECTION	COUNTY	TOTAL SHEETS	SHEET NO.
1340	*	COOK	20	16
STA.		TO STA.		
FED. ROAD DIST. NO.	ILLINOIS	FED. AID PROJECT		
* SECTION: (2727 & 2828) RS-4				
CONTRACT No.: 60722				

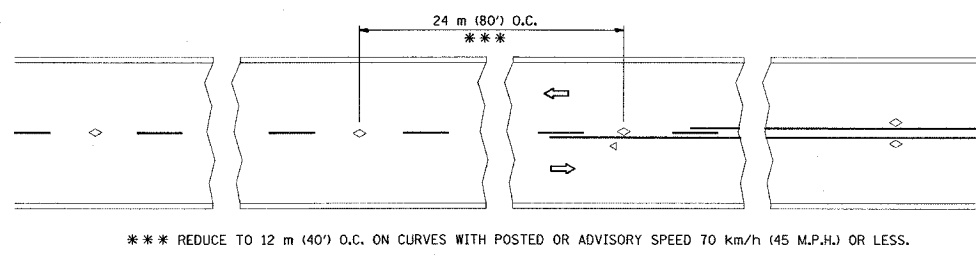

TWO-LANE/TWO-WAY

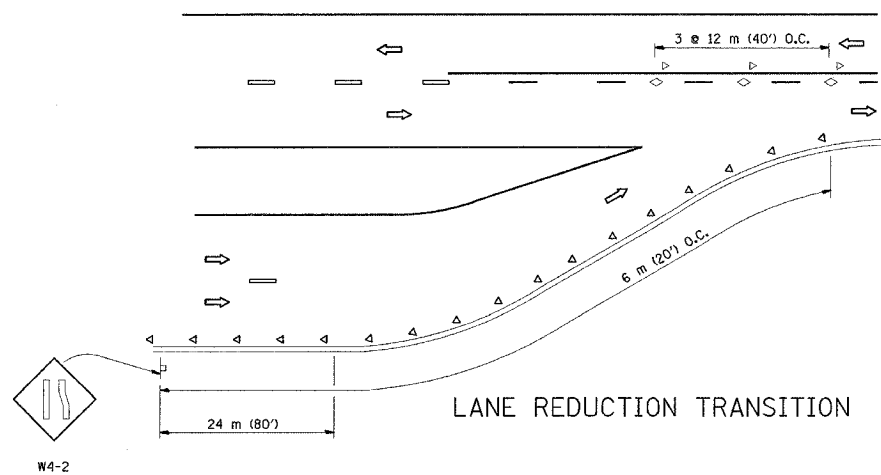

LANE REDUCTION TRANSITION

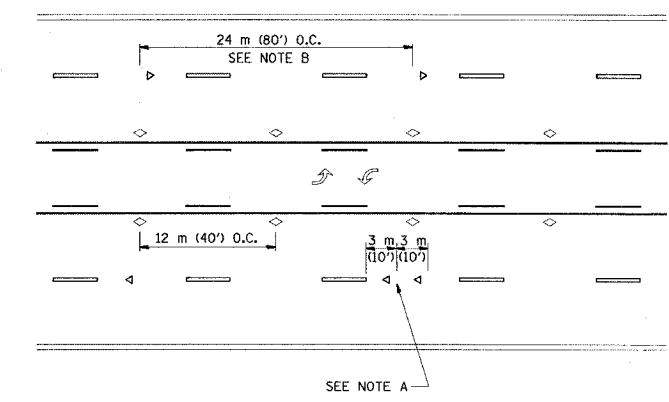

TWO-WAY LEFT TURN

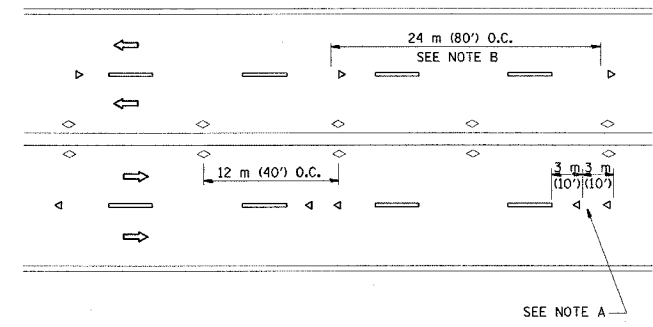

MULTI-LANE/UNDIVIDED

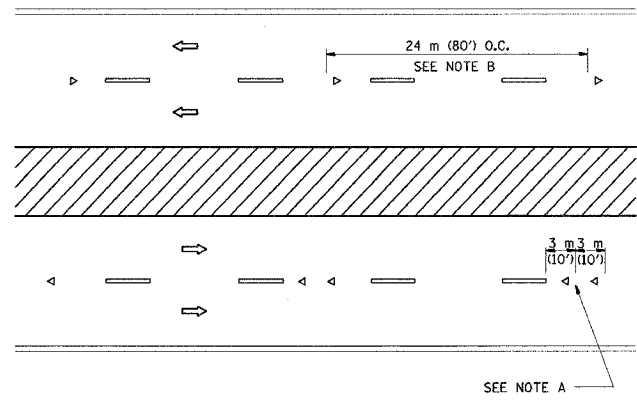

MULTI-LANE/DIVIDED

GENERAL NOTES

1. MARKERS USED WITH DASHED LINES SHALL BE CENTERED IN THE GAP BETWEEN SEGMENTS.
2. MARKERS USED ADJACENT TO SOLID LINES SHALL BE OFFSET 50 TO 75 (2 TO 3) TOWARD TRAFFIC AS SHOWN.
3. MARKERS THROUGH TANGENTS LESS THAN 150 m (500') IN LENGTH BETWEEN CURVES SHALL BE INSTALLED AT THE LESSER OF THE TWO CURVE SPACINGS.

LANE MARKER NOTES

- A. USE DOUBLE LANE LINE MARKERS SPACED AS SHOWN.
- B. REDUCE TO 12 m (40') O.C. ON CURVES WHERE ADVISORY SPEEDS ARE 20 km/h (10 M.P.H.) LOWER THAN POSTED SPEEDS.

SYMBOLS

- YELLOW STRIPE
- WHITE STRIPE
- ◁ ONE-WAY AMBER MARKER
- ◄ ONE-WAY CRYSTAL MARKER (W/O)
- ◇ TWO-WAY AMBER MARKER

DESIGN NOTES

1. DOUBLE LANE LINE MARKERS SHALL BE USED UNLESS SPECIFIED OTHERWISE.
2. EXCEPT AS SHOWN ON THE LANE REDUCTION TRANSITION AND FREEWAY EXIT RAMP DETAIL, MARKERS ARE NOT TO BE SPECIFIED ON RIGHT EDGE LINES.
3. THE EXACT MARKER LIMITS, SPACING, AND COLOR SHOULD BE INCLUDED IN THE PLANS.
4. MARKERS SHOULD NOT BE USED ALONGSIDE CURBS EXCEPT FOR EXTREMELY SHORT SECTIONS OF CURBS WHERE NOT MORE THAN TWO MARKERS WOULD BE INVOLVED.

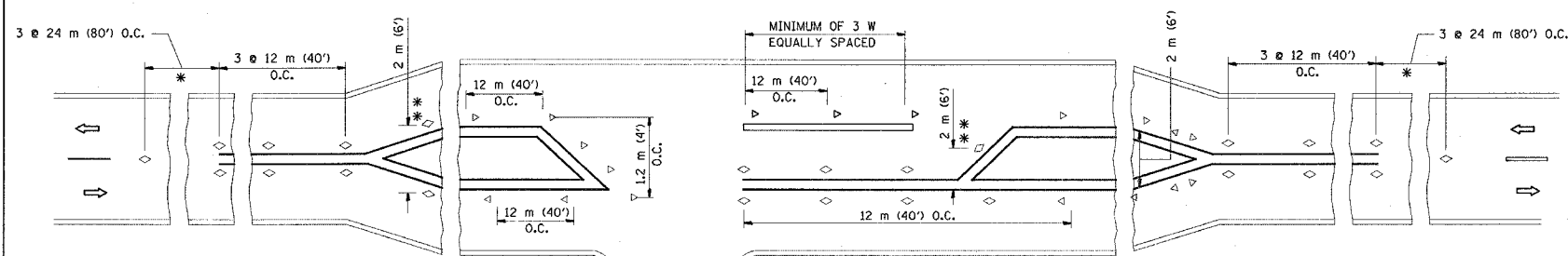

LEFT TURN

* SEE TWO-LANE/TWO-WAY WHERE MARKERS CONTINUE
 ** WHERE THE MEDIAN WIDTH IS 2 m (6') OR LESS USE TWO-WAY MARKERS.

All dimensions are in millimeters (Inches) unless otherwise shown.

REVISIONS	
NAME	DATE
T. RAMMACHER	09-19-94
T. RAMMACHER	03-12-99
T. RAMMACHER	01-06-00

ILLINOIS DEPARTMENT OF TRANSPORTATION
 TYPICAL APPLICATIONS
 RAISED REFLECTIVE PAVEMENT
 MARKERS (SNOW-PLOW RESISTANT)

SCALE: NONE
 DATE: 4/6/2006
 DRAWN BY CADD
 CHECKED BY
 TC-11
 REVISION DATE: 01/06/00

PLOT DATE = 4/6/2006
 FILE NAME = W:\distrs\atc1.dgn
 PLOT SCALE = 50,000 / 1" IN.
 USER NAME = cadden

P. L. NO.	SECTION	COUNTY	TOTAL SHEETS	SHEET NO.
1340	*	COOK	20	17
STA.	TO STA.			
FED. ROAD DIST. NO.	BUILDING	FED. AID PROJECT		

* SECTION: (2727 & 2828) RS-4
CONTRACT No.: 60722

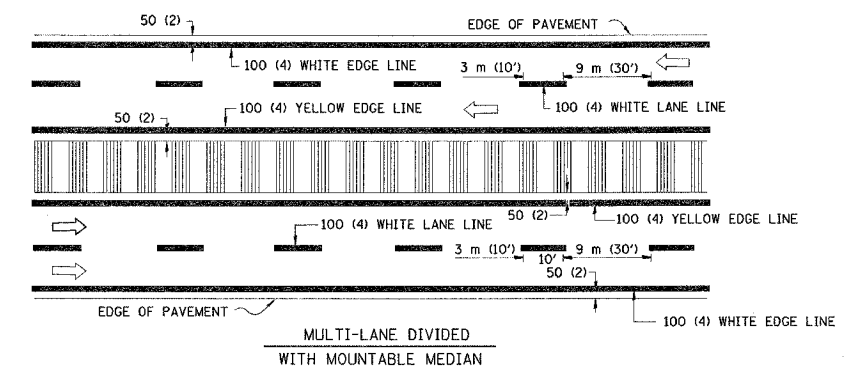
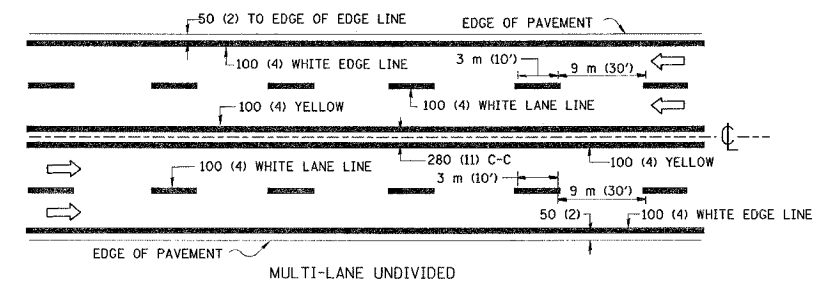
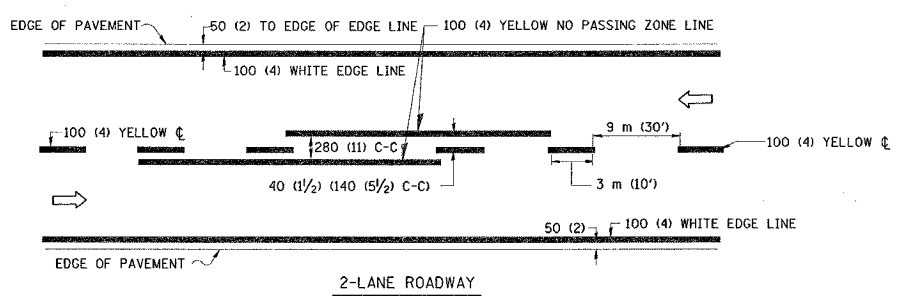

NOTE: MEDIANS WITH BARRIER CURB DO NOT REQUIRE AN EDGE LINE

TYPICAL LANE AND EDGE LINE MARKING

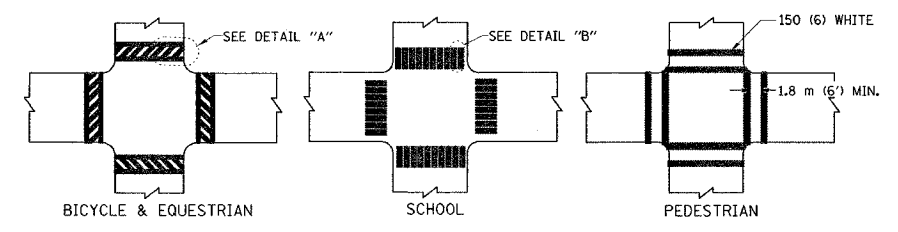

TYPICAL CROSSWALK MARKING

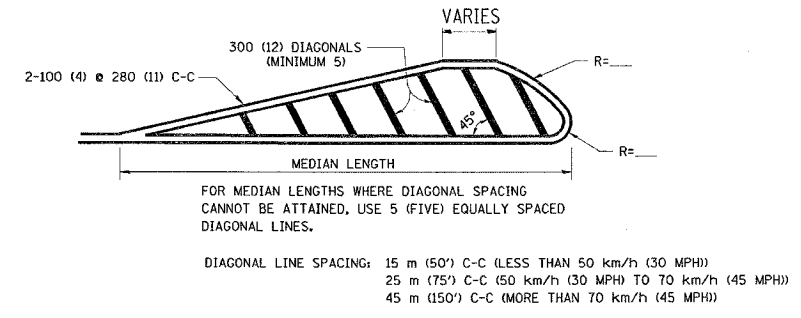
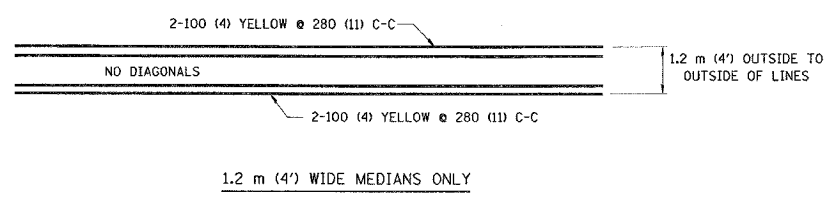

TYPICAL PAINTED MEDIAN MARKING

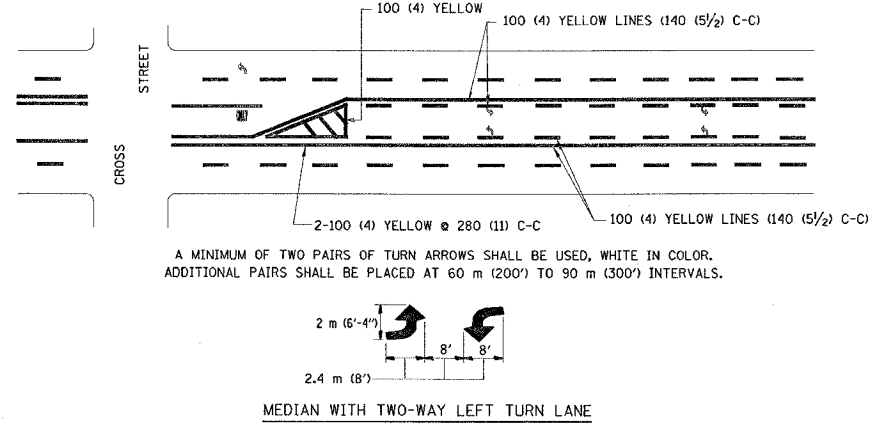

TYPICAL TURN LANE MARKING

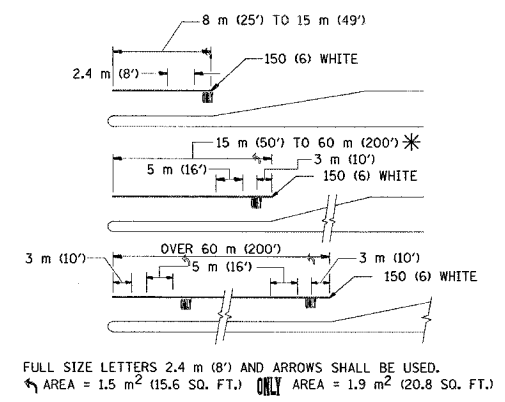

FULL SIZE LETTERS 2.4 m (8') AND ARROWS SHALL BE USED.
AREA = 1.5 m² (15.6 SQ. FT.) ONLY AREA = 1.9 m² (20.8 SQ. FT.)
* TURN LANES IN EXCESS OF 120 m (400') IN LENGTH MAY HAVE AN ADDITIONAL SET OF ARROW - "ONLY" INSTALLED MIDWAY BETWEEN THE OTHER TWO SETS OF ARROW - "ONLY".

TYPICAL TURN LANE MARKING

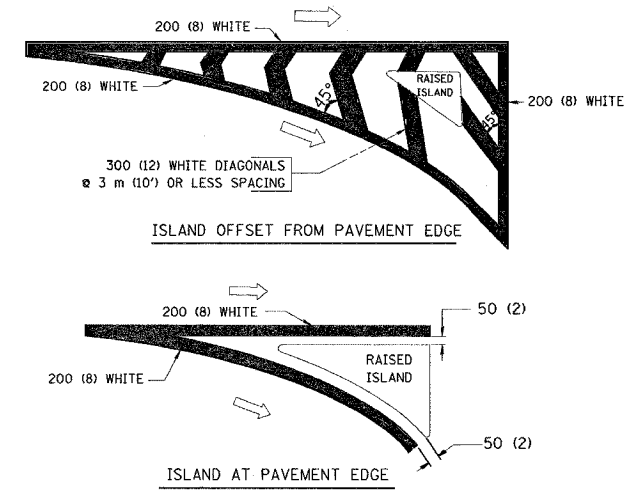

TYPICAL ISLAND MARKING

TYPE OF MARKING	WIDTH OF LINE	PATTERN	COLOR	SPACING / REMARKS
CENTERLINE ON 2 LANE PAVEMENT	100 (4)	SKIP-DASH	YELLOW	3 m (10') LINE WITH 9 m (30') SPACE
CENTERLINE ON MULTI-LANE UNDIVIDED PAVEMENT	2 @ 100 (4)	SOLID	YELLOW	280 (11) C-C
NO PASSING ZONE LINES: FOR ONE DIRECTION FOR BOTH DIRECTIONS	100 (4) 2 @ 100 (4)	SOLID SOLID	YELLOW YELLOW	140 (5 1/2) C-C FROM SKIP-DASH CENTERLINE 280 (11) C-C OMIT SKIP-DASH CENTERLINE BETWEEN
LANE LINES	100 (4) 125 (5) ON FREEWAYS	SKIP-DASH SKIP-DASH	WHITE WHITE	3 m (10') LINE WITH 9 m (30') SPACE
DOTTED LINES (EXTENSIONS OF CENTER, LANE OR TURN LANE MARKINGS)	SAME AS LINE BEING EXTENDED	SKIP-DASH	SAME AS LINE BEING EXTENDED	600 (2') LINE WITH 1.8 m (6') SPACE
EDGE LINES	100 (4)	SOLID	YELLOW-LEFT WHITE-RIGHT	OUTLINE MOUNTABLE MEDIANS IN YELLOW; EDGE LINES ARE NOT USED NEXT TO BARRIER CURB
TURN LANE MARKINGS	150 (6) LINE; FULL SIZE LETTERS & SYMBOLS (2.4 m (8'))	SOLID	WHITE	SEE TYPICAL TURN LANE MARKING DETAIL
TWO WAY LEFT TURN MARKING	2 @ 100 (4) EACH DIRECTION 2.4 m (8') LEFT ARROW	SKIP-DASH AND SOLID IN PAIRS	YELLOW WHITE	3 m (10') LINE WITH 9 m (30') SPACE FOR SKIP-DASH; 140 (5 1/2) C-C BETWEEN SOLID LINE AND SKIP-DASH LINE SEE TYPICAL TWO-WAY LEFT TURN MARKING DETAIL
CROSSWALK LINES (PEDESTRIAN) A. DIAGONALS (BIKE & EQUESTRIAN) B. LONGITUDINAL BARS (SCHOOL)	2 @ 150 (6) 300 (12) @ 45° 300 (12) @ 90°	SOLID SOLID SOLID	WHITE WHITE WHITE	NOT LESS THAN 1.8 m (6') APART 600 (2') APART SEE TYPICAL CROSSWALK MARKING DETAILS.
STOP LINES	600 (24)	SOLID	WHITE	PLACE 1.2 m (4') IN ADVANCE OF AND PARALLEL TO CROSSWALK, IF PRESENT. OTHERWISE, PLACE AT DESIRED STOPPING POINT. PARALLEL TO CROSSROAD CENTERLINE, WHERE POSSIBLE
PAINTED MEDIANS	2 @ 100 (4) WITH 300 (12) DIAGONALS @ 45° NO DIAGONALS USED FOR 1.2 m (4') WIDE MEDIANS	SOLID	YELLOW: TWO WAY TRAFFIC WHITE: ONE WAY TRAFFIC	280 (11) C-C FOR THE DOUBLE LINE SEE TYPICAL PAINTED MEDIAN MARKING.
GORE MARKING AND CHANNELIZING LINES	200 (8) WITH 300 (12) DIAGONALS @ 45°	SOLID	WHITE	DIAGONALS: 4.5 m (15') C-C (LESS THAN 50 km/h (30 MPH)) 6 m (20') C-C (50 km/h (30 MPH) TO 70 km/h (45 MPH)) 9 m (30') C-C (OVER 70 km/h (45 MPH))
RAILROAD CROSSING	600 (24) TRANSVERSE LINES; "RR" IS 1.8 m (6') LETTERS; 400 (16) LINE FOR "X"	SOLID	WHITE	SEE STATE STANDARD 780001 AREA OF: "R"=0.33m ² (3.6 SQ. FT.) EACH "X"=5.0 m ² (54.0 SQ. FT.)
SHOULDER DIAGONALS	300 (12) @ 45°	SOLID	WHITE - RIGHT YELLOW - LEFT	15 m (50') C-C (LESS THAN 50 km/h (30 MPH)) 25 m (75') C-C (50 km/h (30 MPH) TO 70 km/h (45 MPH)) 45 m (150') C-C (OVER 70 km/h (45 MPH))

FOR FURTHER DETAILS ON PAVEMENT MARKING REFER TO STANDARD SPECIFICATIONS FOR ROAD AND BRIDGE CONSTRUCTION AND STATE STANDARD 780001.

All dimensions are in millimeters (inches) unless otherwise shown.

ILLINOIS DEPARTMENT OF TRANSPORTATION
DISTRICT ONE
TYPICAL PAVEMENT MARKINGS

REVISIONS	
NAME	DATE
EVERS	03-19-90
T. RAMMACHER	10-27-94
ALEX HOUSEH	10-09-96
ALEX HOUSEH	10-17-96
T. RAMMACHER	01-06-00

SCALE: NONE
DATE: 10/7/2005
DRAWN BY: CADD
CHECKED BY:
TC-13
REVISION DATE: 01/06/00

F. A. DIST.	SECTION	COUNTY	TOTAL SHEETS	SHEET NO.
1340	*	COOK	20	18
STA.		TO STA.		
FED. ROAD DIST. NO.	BLDGMS	FED. AID PROJECT		



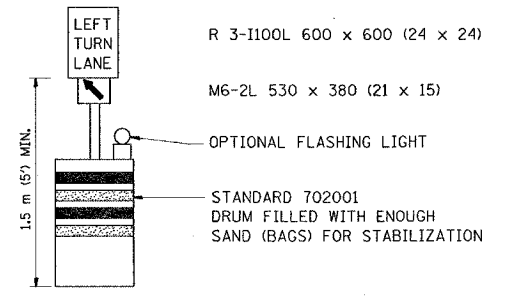
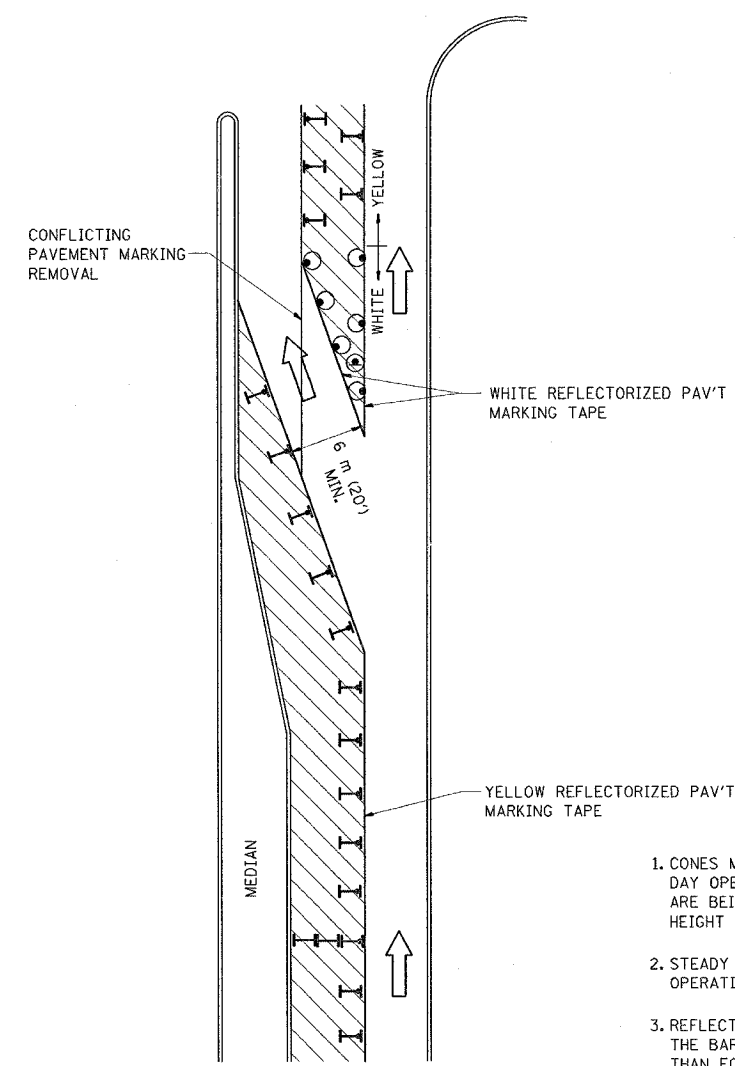

* SECTION: (2727 & 2828) RS-4
CONTRACT No.: 60722

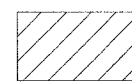
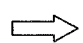
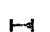

GENERAL NOTES

1. CONES MAY BE SUBSTITUTED FOR BARRICADES OR DRUMS AT HALF THE SPACING DURING DAY OPERATIONS. CONES SHALL BE A MINIMUM OF 710 (28) IN HEIGHT. WHEN CONES ARE BEING USED, THE "LEFT TURN LANE" SIGN MAY BE SKID MOUNTED AT A MINIMUM HEIGHT OF 1.5 m (5').
2. STEADY BURNING LIGHTS WILL NOT BE REQUIRED ON BARRICADES OR DRUMS FOR DAY OPERATIONS. ALL LIGHTS SHALL BE MONODIRECTIONAL.
3. REFLECTORIZED TEMPORARY PAVEMENT MARKING TAPE SHALL BE PLACED THROUGHOUT THE BARRICADED AREA OF EACH TURN BAY WHERE THE CLOSURE TIME IS GREATER THAN FOURTEEN DAYS.
4. THIS APPLICATION ALSO APPLIES WHEN WORK IS BEING PERFORMED IN THE RIGHT LANE(S) AND THE RIGHT TURN BAY IS TO REMAIN OPEN. UNDER THIS CONDITION, "RIGHT TURN LANE" R3-100 600 x 600 (24 x 24) AND M6-2R 530 x 380 (21 x 15) SHALL BE USED.
5. THESE CONTROLS SHALL SUPPLEMENT MAINLINE TRAFFIC CONTROL FOR LANE CLOSURES.
6. LONGITUDINAL DIMENSIONS MAY BE ADJUSTED TO FIT FIELD CONDITIONS.
7. FORM BT 725 IS REQUIRED.
8. TRAFFIC CONTROL AND PROTECTION AT TURN BAYS (TO REMAIN OPEN TO TRAFFIC) SHALL BE INCLUDED IN THE COST SPECIFIED TRAFFIC CONTROL STANDARDS OR ITEMS.

LEGEND

-  WORK AREA
-  LANE OPEN TO TRAFFIC
-  TYPE I OR II BARRICADE WITH STEADY BURN LIGHT
-  DRUM WITH STEADY BURN LIGHT
-  DRUM WITH SIGN (WITH OPTIONAL FLASHING LIGHT) SEE DETAIL
-  TYPE I OR II CHECK BARRICADE WITH FLASHING LIGHT

All dimensions are in millimeters (inches) unless otherwise shown.

ILLINOIS DEPARTMENT OF TRANSPORTATION
TRAFFIC CONTROL AND PROTECTION
AT TURN BAYS
(TO REMAIN OPEN TO TRAFFIC)

SCALE: NONE
DATE: 10/1/2005

DRAWN BY
CHECKED BY LHA
TC-14
REVISION DATE: 01/06/00

REVISIONS	
NAME	DATE
T. RAMMACHER	09/08/94
A. HOUSEH	11/07/95
A. HOUSEH	10/12/96
T. RAMMACHER	01/06/00

F. A. RFL	SECTION	COUNTY	TOTAL SHEETS	SHEET NO
1340	*	COOK	20	19
STA.		TO STA.		
FED. ROAD DIST. NO.		ILLINOIS	FED. AID PROJECT	

* SECTION: (2727 & 2828) RS-4
CONTRACT No.: 60722

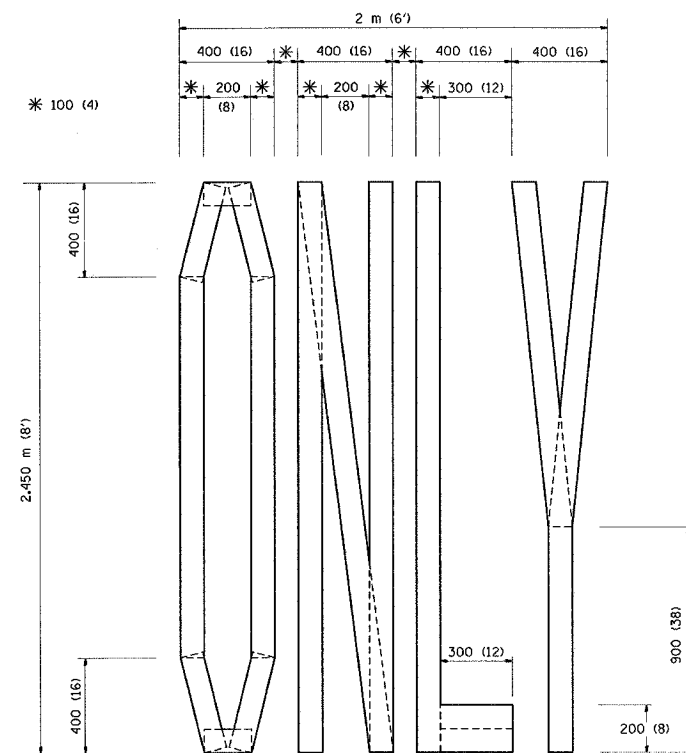

QUANTITY
100 (4) LINE = 19.7 m (64.1 ft.)
1.97 sq. m (21.1 sq. ft.)

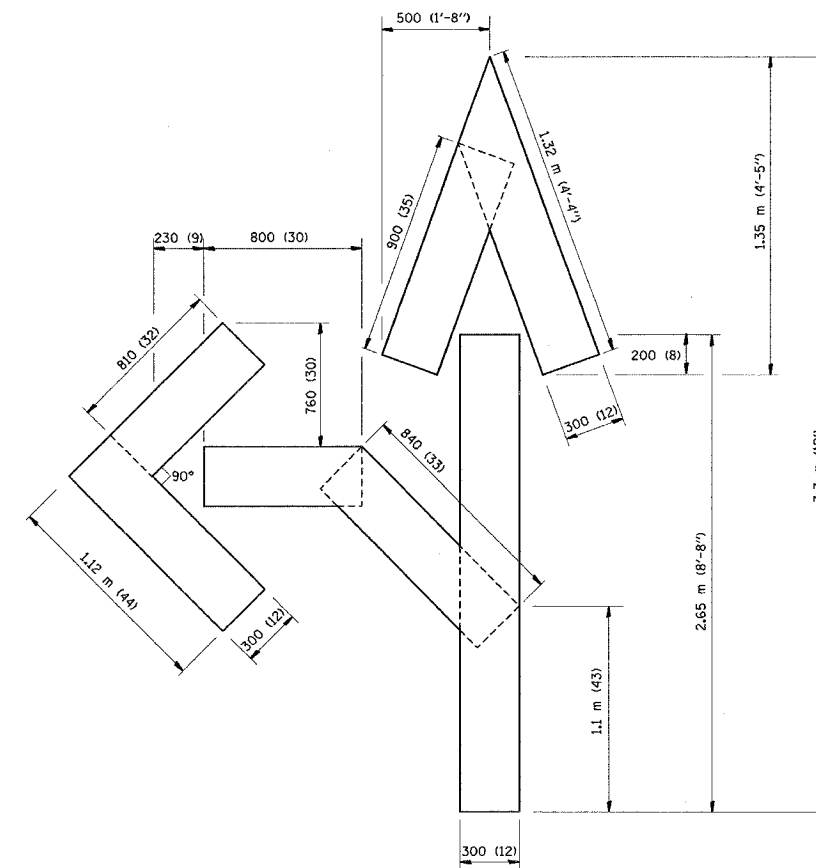

QUANTITY
100 (4) LINE = 25.3 m (82.5 ft.)
2.53 sq. m (27.5 sq. ft.)

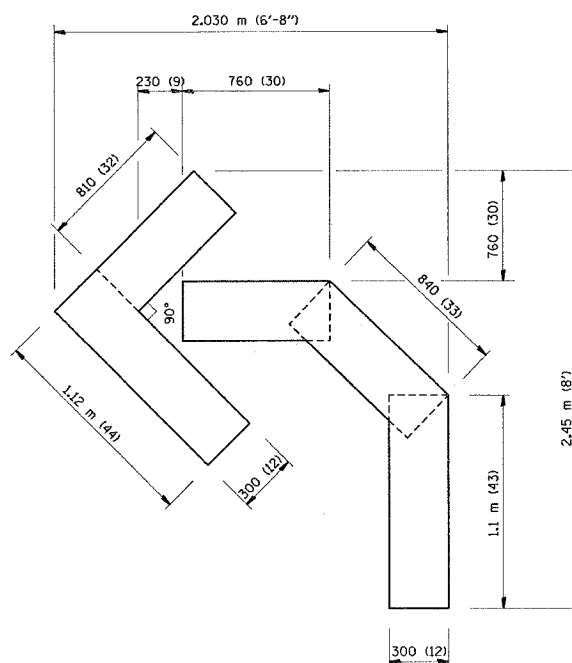

QUANTITY
100 (4) LINE = 13.9 m (45.5 ft.)
1.39 sq. m (15.2 sq. ft.)

All dimensions are in millimeters (Inches) unless otherwise shown.

ILLINOIS DEPARTMENT OF TRANSPORTATION

PAVEMENT MARKING
LETTERS AND SYMBOLS
FOR TRAFFIC STAGING

REVISIONS	
NAME	DATE
T. RAMMACHER	09/18/94
J. OBERLE	06/01/96
T. RAMMACHER	06/05/96
T. RAMMACHER	11/04/97
T. RAMMACHER	03/02/98
E. GOMEZ	08/28/00

SCALE: NONE
DATE 10/7/2005

DRAWN BY CADD
CHECKED BY TC-16

REVISION DATE: 08/28/00

F.A. RTE.	SECTION	COUNTY	TOTAL SHEETS	SHEET NO.
1340	*	COOK	20	20
STA.		TO STA.		
FED. ROAD DIST. NO. 1		ILLINOIS FED. AID PROJECT		
* SECTION: (2727 & 2828) RS-4				
CONTRACT No.: 60722				

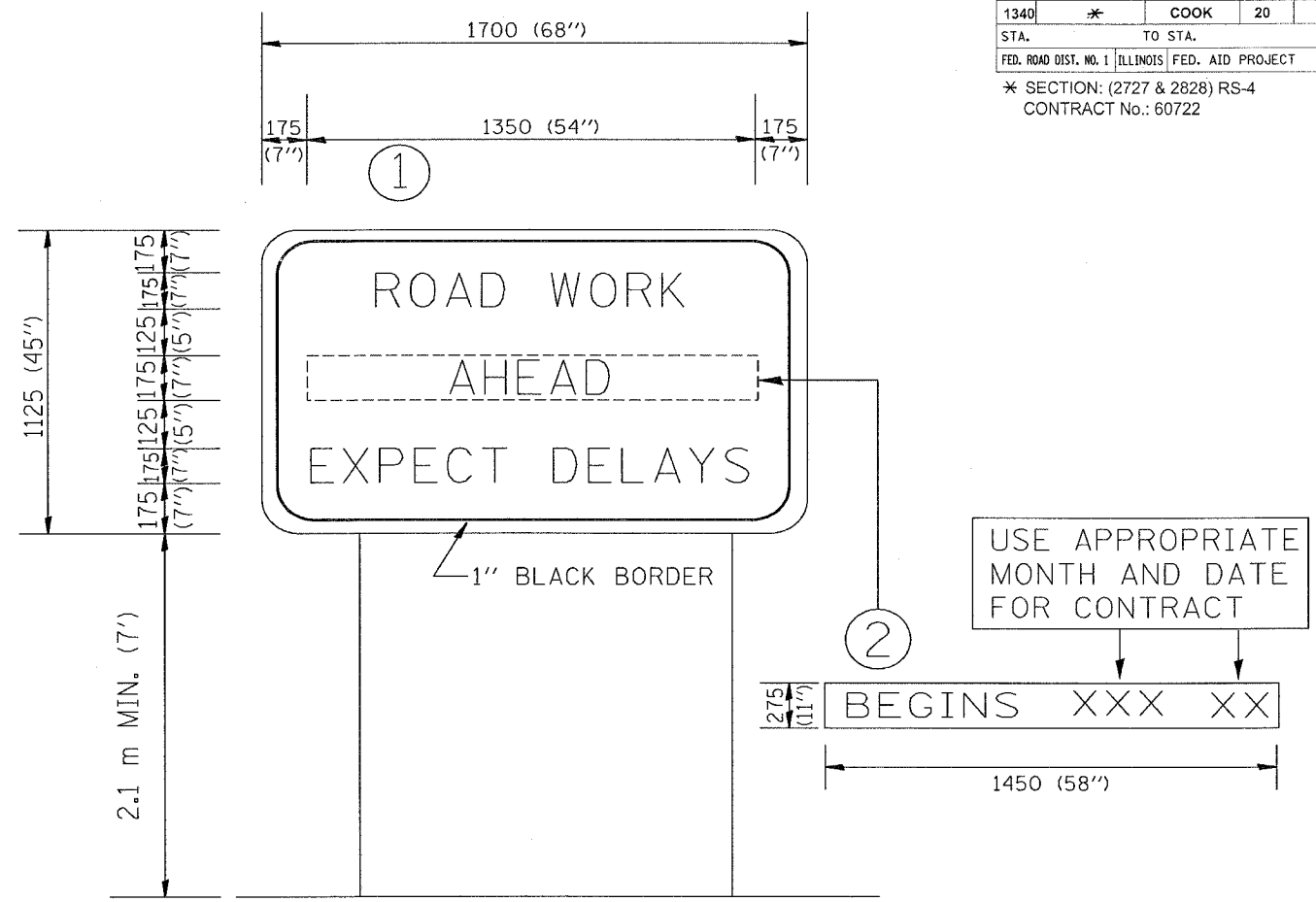

NOTES:

1. USE BLACK LETTERING ON ORANGE BACKGROUND.
2. ERECT SIGNS IN ADVANCE OF THE LOCATION FOR THE "ROAD CONSTRUCTION AHEAD" SIGN AT LOCATIONS AS DIRECTED BY THE ENGINEER.
3. ERECT SIGN ① WITH INSTALLED PANEL ② ONE WEEK PRIOR TO THE START OF CONSTRUCTION.
4. REMOVE PANEL ② SOON AFTER THE START OF CONSTRUCTION.
5. SEE SPECIAL PROVISION FOR "TEMPORARY INFORMATION SIGNING" FOR ADDITIONAL INFORMATION.
6. ONE SIGN ASSEMBLY EQUALS 2.3 SQ. M. (25.70 SQ. FT.)

ALL DIMENSIONS ARE IN MILLIMETERS (INCHES) UNLESS OTHERWISE SHOWN.

REVISIONS	
NAME	DATE
R. MIRS	9-15-97
R. MIRS	12-11-97
T. RAMMACHER	2-2-99

ILLINOIS DEPARTMENT OF TRANSPORTATION
 TEMPORARY INFORMATION SIGNING

SCALE: DATE 10/7/2005

DRAWN BY: BUR. OF DESIGN
 CHECKED BY: