

ARTERIAL-VOLUME DENSITY ("FAR BACK" DETECTION)
CROSS STREET-VOLUME DENSITY ("FAR BACK" DETECTION)

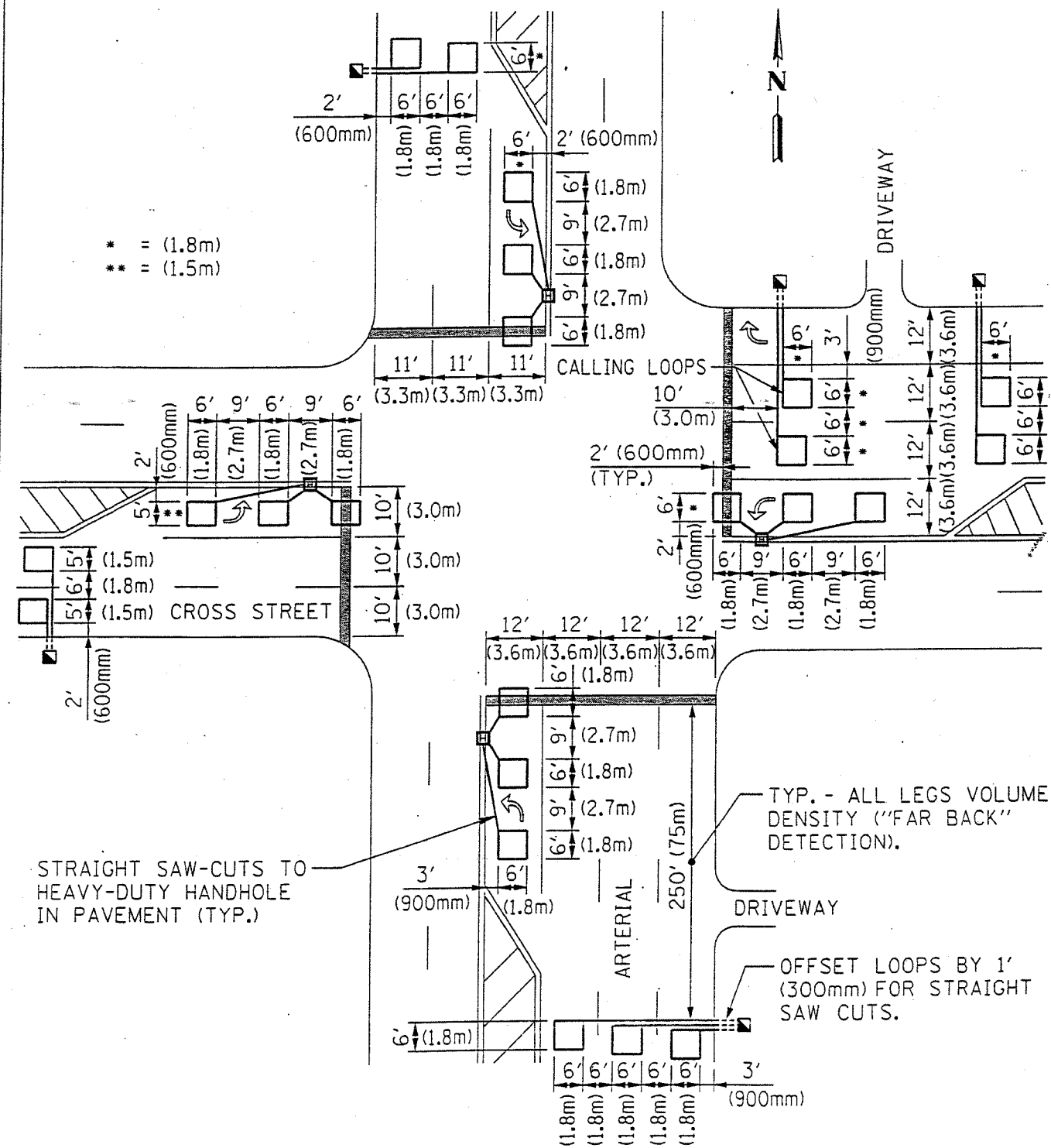

* = (1.8m)
** = (1.5m)

LOOPS ARE SAW-CUT TO THE EDGE OF PAVEMENT. 1" (25mm) UNIT DUCT IS RUN BETWEEN EDGE OF PAVEMENT AND HANDHOLE, (TYP. FOR LOOPS THAT TERMINATE IN HANDHOLES OUTSIDE PAVEMENT).

N.T.S.

ARTERIAL-VOLUME DENSITY ("FAR BACK" DETECTION)
CROSS STREET-NON VOLUME DENSITY ("UPTIGHT" PRESENCE DETECTION)

CONTRACT 60930

F.A.U. RTE.	SECTION	COUNTY	TOTAL SHEETS	SHEET NO.
1332	2000-037RS	COOK	58	34
STA. 238+19	TO STA. 299+14			
FED. ROAD DIST. NO.	ILLINOIS	FED. AID PROJECT		

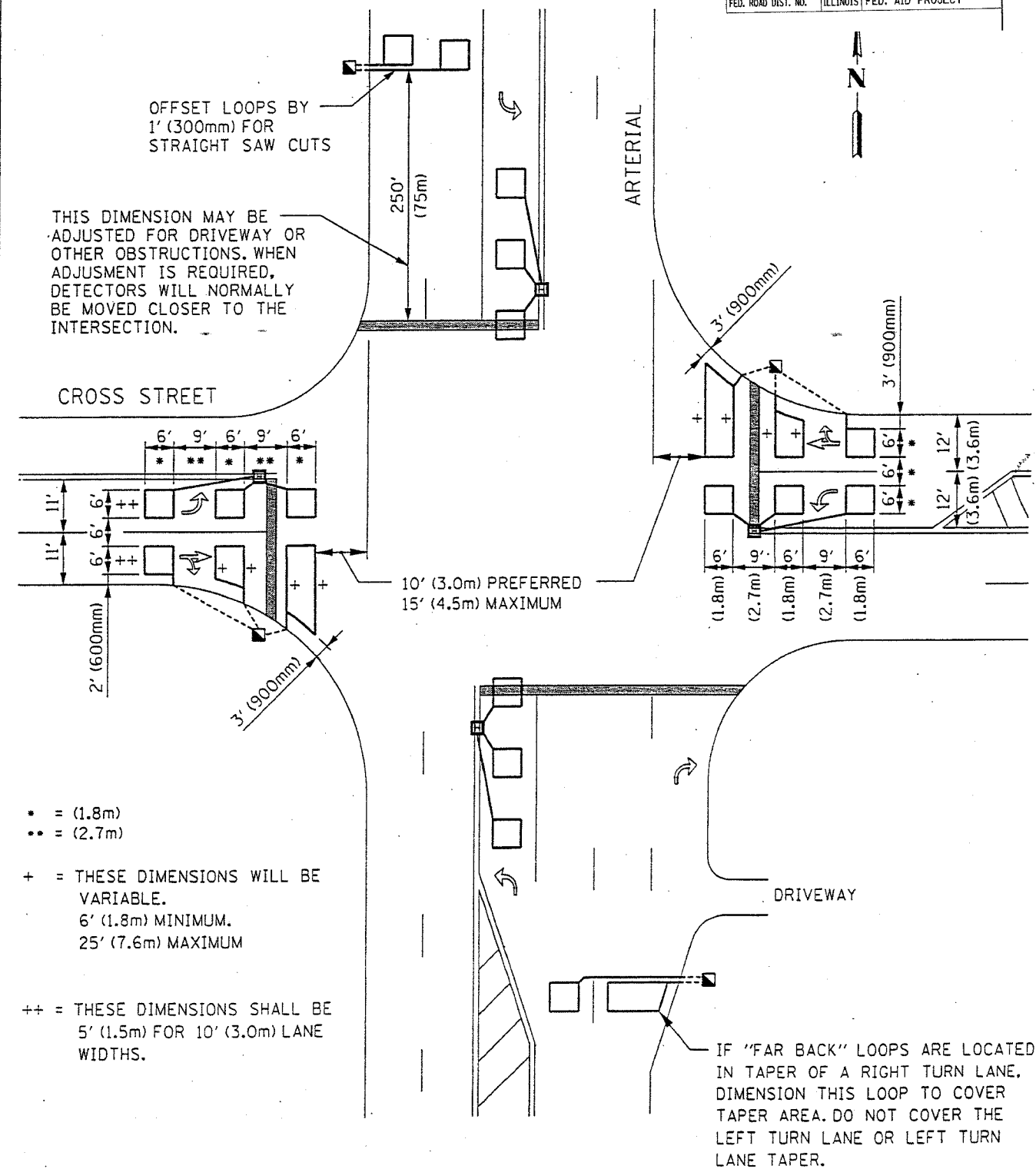

- = (1.8m)
- = (2.7m)
- + = THESE DIMENSIONS WILL BE VARIABLE.
6' (1.8m) MINIMUM.
25' (7.6m) MAXIMUM
- ++ = THESE DIMENSIONS SHALL BE 5' (1.5m) FOR 10' (3.0m) LANE WIDTHS.

N.T.S.