

F. A. L. NO.	SECTION	COUNTY	TOTAL SHEETS	SHEET NO.
94	**	COOK	19	5
STA.	TO STA.			
FED. ROAD DIST. NO. 1		ILLINOIS	FED. AID PROJECT	
62747		** 2005-087CRC-PP CONTRACT NO. 60808		

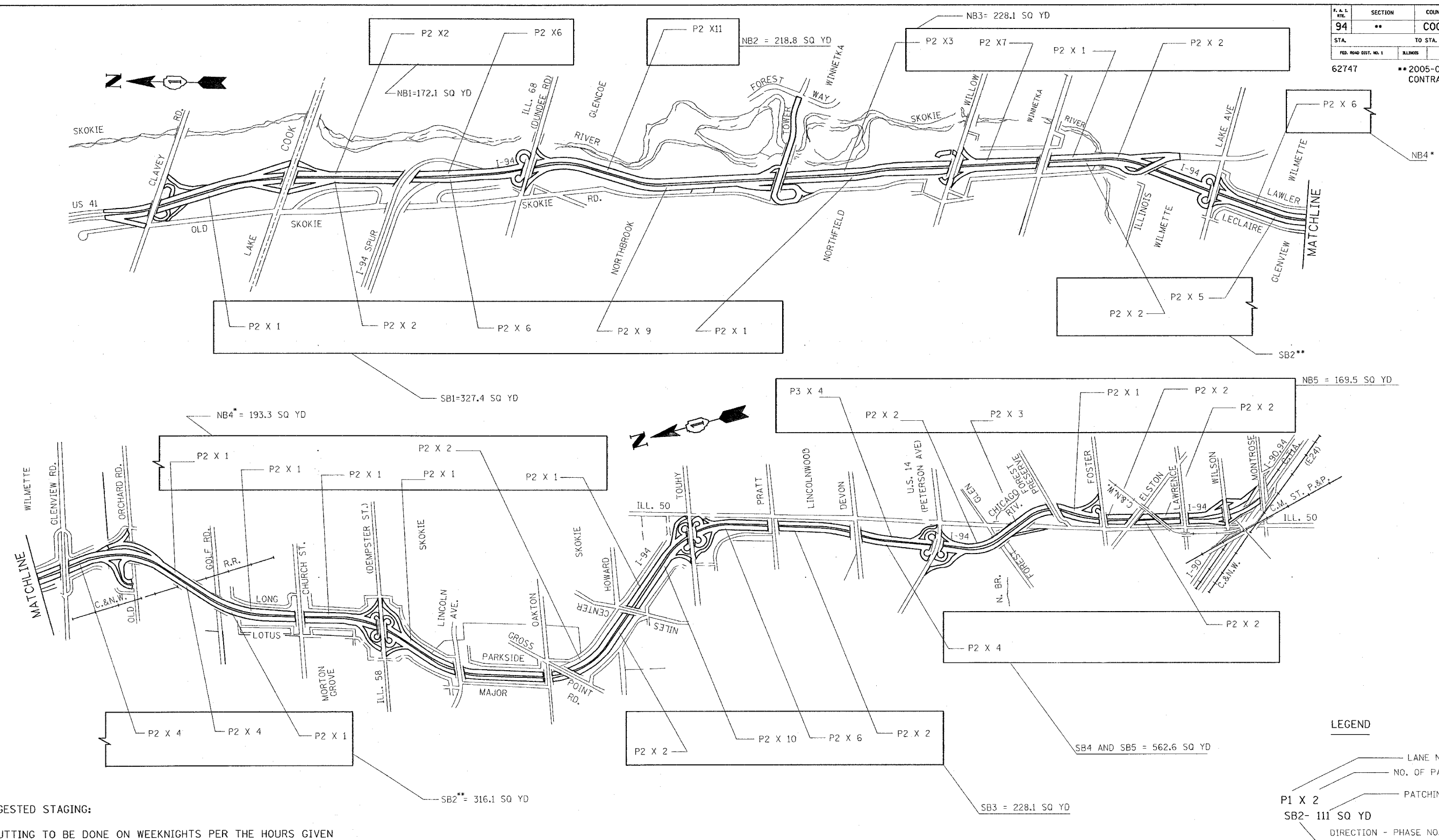

LEGEND

- LANE NO.
- NO. OF PATCHES
- PATCHING AREA
- DIRECTION - PHASE NO.

SUGGESTED STAGING:

SAW CUTTING TO BE DONE ON WEEKNIGHTS PER THE HOURS GIVEN IN THE SPECIAL PROVISION "KEEPING THE EXPRESSWAY OPEN TO TRAFFIC". PATCHING SHALL BE DONE PER THE RESTRICTED WEEKEND CLOSURE HOURS CLOSE LANE 1 PER HWY STDS 701400 & 701401 AND CLOSE LANE 1 & 2 PER HWY STDS 701400 & 701446 MAXIMUM LENGTH OF ANY CLOSURE IS 4 MILES. MINIMUM GAP BETWEEN CONSECUTIVE CLOSURES IS 4 MILES. PATCHING IN NB & SB LANES MAY BE DONE SIMULTANEOUSLY. CURING OF LANE 2 PATCHES MAY USE CENTER LANE CLOSURE DETAIL ON DISTRICT DETAIL TC-25 PER FULL WEEKEND CLOSURE HOURS.

SUGGESTED SB LANE CLOSURES:

SB1 - PATCHES BETWEEN CLAYEY RD AND WILLOW RD.
 SB2 - PATCHES BETWEEN WILLOW RD. AND CHURCH ST.
 SB3 - PATCHES BETWEEN GROSS POINT RD. AND DEVON AVE.
 SB4 AND SB5 - DIVIDE UP PATCHES IN HALF BETWEEN DEVON AND LAWRENCE AVE.

SUGGESTED NB LANE CLOSURES:

NB1 - PATCHES BETWEEN LAKE COOK & IL 68 (DUNDEE RD)
 NB2 - PATCHES BETWEEN IL 68 (DUNDEE RD) & TOWER RD
 NB3 - PATCHES BETWEEN TOWER RD AND LAKE AVE
 NB4 - PATCHES BETWEEN LAKE AVE AND TOUHY AVE
 NB5 - PATCHES BETWEEN DEVON AND LAWRENCE

REVISIONS	
NAME	DATE
A.A	5-18-06

ILLINOIS DEPARTMENT OF TRANSPORTATION
 INTERSTATE 94 (EDENS EXPRESSWAY)
 FROM LAWRENCE AVE. TO LAKE-COOK ROAD
 TRAFFIC CONTROL PLAN
 STAGE II - LANES 2

SCALE: NONE
 DATE: 5/22/2006
 DRAWN BY: C.A.D.D.
 CHECKED BY:

5/22/2006
 c:\prj\olects\i250606\sh_r_cwv.dgn