

F.A.I.	SECTION	COUNTY	TOTAL SHEETS	SHEET NO.
94/90	2003-0295	COOK	344	154
STA.		TO STA.		
FED. ROAD DIST. NO.	ILLINOIS	FED. AID PROJECT		
62581				

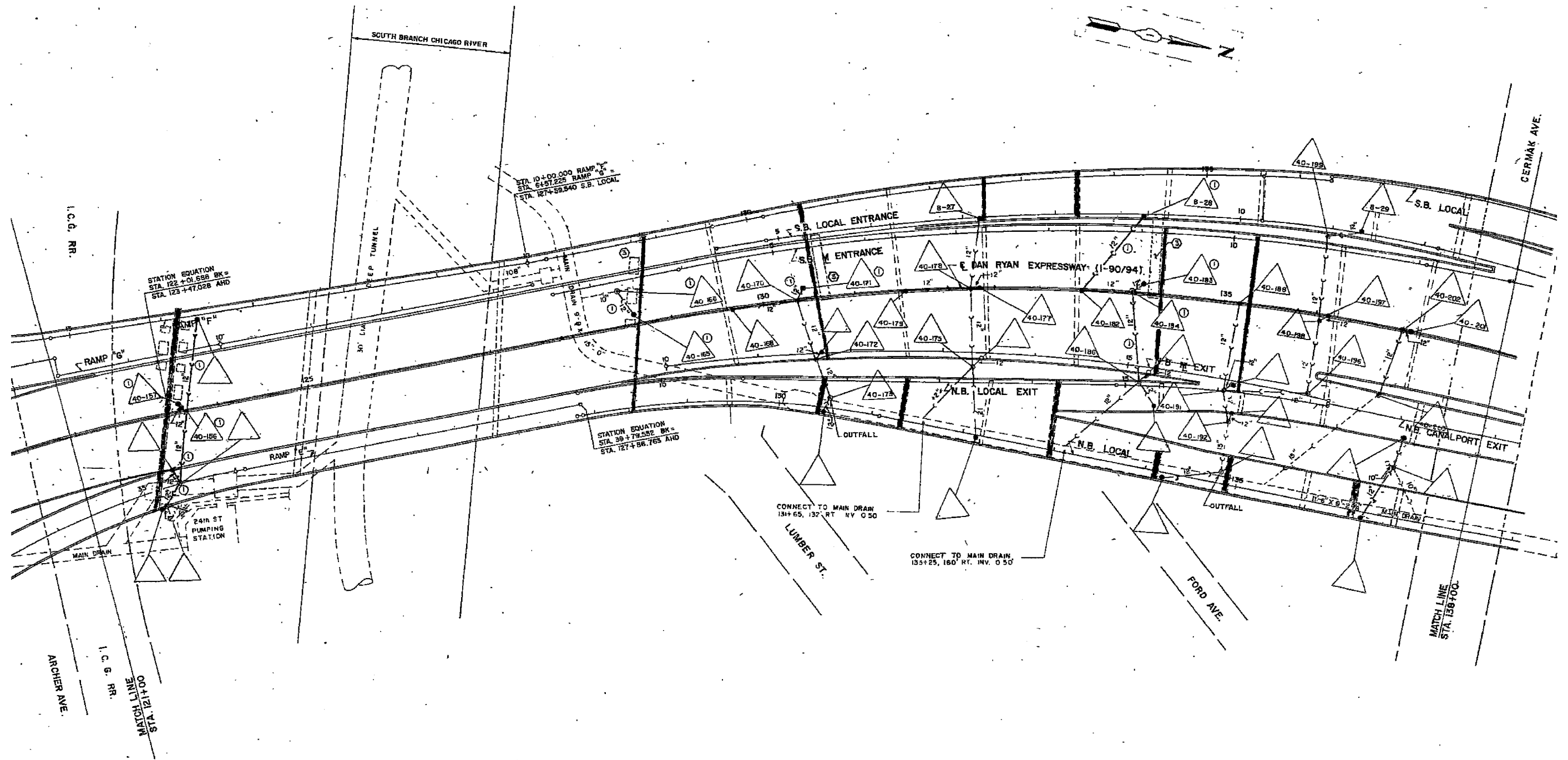

FOR INFORMATION ONLY

NOTE:

Information from 1988-89 As-Builts to show probable location of existing catch basins collecting bridge drainage. Field verify location with Engineer. Clean all catch basins receiving drainage from SB viaduct.

REVISIONS	
NAME	DATE

ILLINOIS DEPARTMENT OF TRANSPORTATION
 F.A.I. 94/90 (DAN RYAN EXPRESSWAY)
 SB DAN RYAN ELEVATED BRIDGE
 REPAIR FROM 15TH TO 28TH STREETS
 EXISTING DRAINAGE SYSTEM
 DETAILS

SCALE: NTS
 DATE: 4/14/2006

DRAWN BY: BDC
 CHECKED BY: BLU

BOWMAN, BARRETT & ASSOCIATES INC.
 CONSULTING ENGINEERS
 Chicago, Illinois
 312.228.0100
 www.bbainc.com



4/14/2006 10:25:48 AM