

F.A.U. RTE.	SECTION	COUNTY	TOTAL SHEETS	SHEET NO.
3578	1327B	COOK	108	10
STA. 1503+19.73		TO STA. 1528+17.76		
FED. ROAD DIST. NO. 1 ILLINOIS FED. AID PROJECT				

- BM1 RAILROAD SPIKE SET IN THE FIRST POWER POLE NORTH OF THE AMERITECH CELLULAR TOWER ON THE SOUTH SIDE OF ROUTE 7
ELEVATION = 678.92
- BM2 RAILROAD SPIKE SET IN GUARDRAIL POST AT THE NORTH END OF GUARDRAIL ALONG THE SOUTH SIDE OF ROUTE 7
ELEVATION = 703.46
- BM3 CUT CROSS ON TOP OF CURB AT NORTHEAST ENTRANCE TO LANDSCAPING NURSERY ON THE NORTH SIDE OF ROUTE 7 (STA. 1524+32, 43' LEFT)
ELEVATION = 678.78
- BM4 SQUARE CUT ON TOP OF THE EASTERLY CONCRETE WALL OF THE OUTFALL STRUCTURE TO MCGINNIS SLOUGH, 0.7' NORTH OF THE SOUTHWEST INSIDE CORNER OF THE WALL, ON THE WEST SIDE OF LAGRANGE ROAD (ROUTE 45), APPROXIMATELY 150' NORTH OF THE ROUTE 7 BRIDGE OVER ROUTE 45.
ELEVATION = 678.43

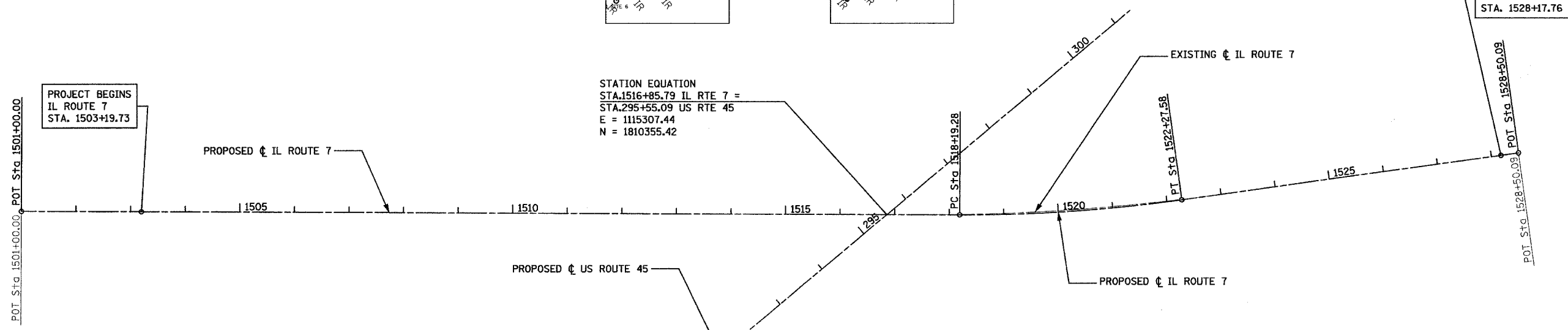
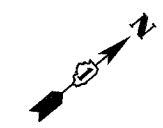
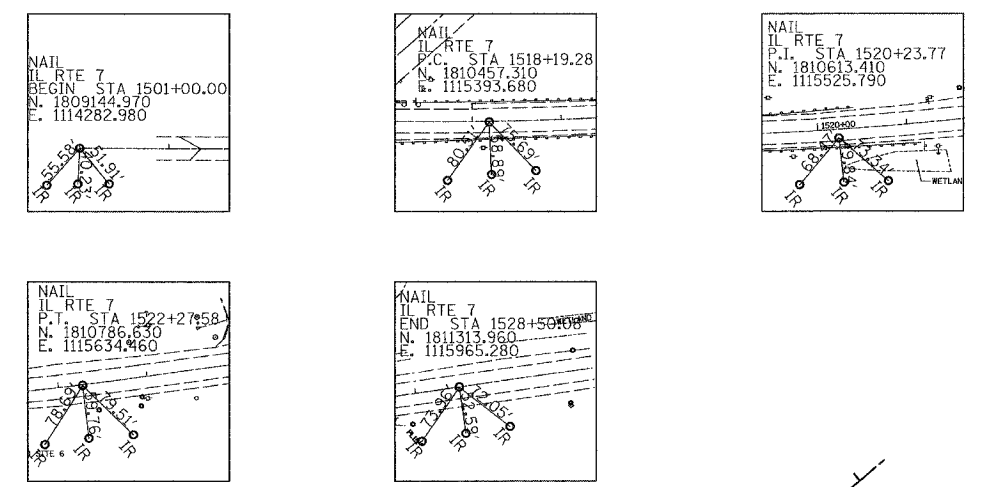

PROP. CURVE SSWHWY-1 PI STA. = 1520+23.77 $\Delta = 8^\circ 08' 26''$ (LT) D = $1^\circ 59' 38''$ R = 2,873.70' T = 204.49' L = 408.30' E = 7.27' e = 2.46% T.R. = 48.00' S.E. RUN = 59.00' P.C. STA = 1518+19.28 P.T. STA = 1522+27.58	EXIST. CURVE XSWHWY-1 PI STA. = 1520+23.77 $\Delta = 8^\circ 08' 26''$ (LT) D = $1^\circ 27' 20''$ R = 3,936.58' T = 280.13' L = 559.31' E = 9.95' e = ----- T.R. = ----- S.E. RUN = ----- P.C. STA. = 1517+43.64 P.T. STA. = 1523+02.95
---	--

PROP. CURVE SSWHWY-1	NORTH COORDINATE	EAST COORDINATE
PI STA. = 1520+23.77	1,810,613.41	1,115,525.79
$\Delta = 8^\circ 08' 26''$ (LT)		
D = $1^\circ 59' 38''$		
R = 2,873.70'		
T = 204.49'		
L = 408.30'		
E = 7.27'		
e = 2.46%		
T.R. = 48.00'		
S.E. RUN = 59.00'		
P.C. STA = 1518+19.28	1,810,457.31	1,115,393.68
P.T. STA = 1522+27.58	1,810,786.63	1,115,634.46

REVISIONS	
NAME	DATE

ILLINOIS DEPARTMENT OF TRANSPORTATION
 F.A.U. ROUTE 3576 (IL. ROUTE 7)

IL ROUTE 7
 ALIGNMENT, TIES AND BENCHMARKS
 STA. 1503+19.73 TO STA. 28+17.76

SCALE: VERT. 1" = 100'
 DATE: MAR. 10, 2006

DRAWN BY BCD
 CHECKED BY SLR

PLOT DATE = 3/8/2006
 FILE NAME = N:\IL 7\Proposed.Plans\Cover-VLL.G.dgn
 PLOT SCALE = 1" = 100'
 REFERENCE = AREFA