

F.A.U. RTE.	SECTION	COUNTY	TOTAL SHEETS	SHEET NO.
3578	1327B	COOK	108	19
STA. 1503+19.73 TO STA. 1511+00.00				
FED. ROAD DIST. NO. 1 ILLINOIS FED. AID PROJECT				

PLAN	DATE
BY	
CHECKED	
NO. OF WAY CHECKED	
DATE	
NO.	

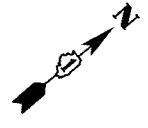
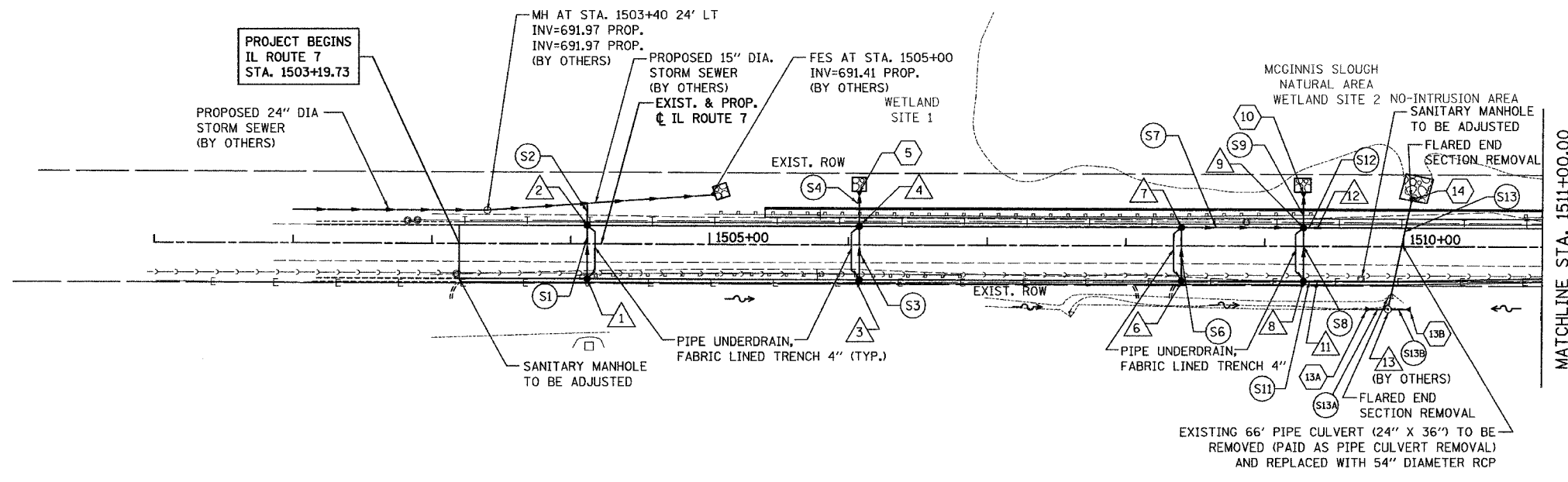

LEGEND:

- △ PROPOSED STRUCTURE
- Sx PROPOSED PIPE
- X PROPOSED FLARED END SECTION

NOTE:

1. FOR STRUCTURE AND PIPE TABLES SEE DRAINAGE TABLE SHEET
2. IF THE STORM SEWER SYSTEM BETWEEN STA. 1508+00 AND STA. 1515+00 WILL BE INSTALLED PRIOR TO THE FILL PLACEMENT, THEN THE SEWER LATERALS ARE TO BE INSTALLED AFTER THE SETTLEMENT WAITING PERIOD IS COMPLETED, AS DIRECTED BY THE ENGINEER.
3. DRAINAGE STRUCTURES CROSSING THE NORTHWEST RETAINING WALL SHALL BE INSTALLED AFTER STONE COLUMN INSTALLATION IS COMPLETED. (SEE RETAINING WALL PLANS)
4. IN AREAS WHERE STONE COLUMNS ARE DISTURBED BY SEWER INSTALLATION, PROVIDE 12" OF TRENCH BACKFILL BELOW THE SEWER, SEE DRAINAGE TABLES.

PROFILE	DATE
BY	
CHECKED	
NO. OF WAY CHECKED	
DATE	
NO.	

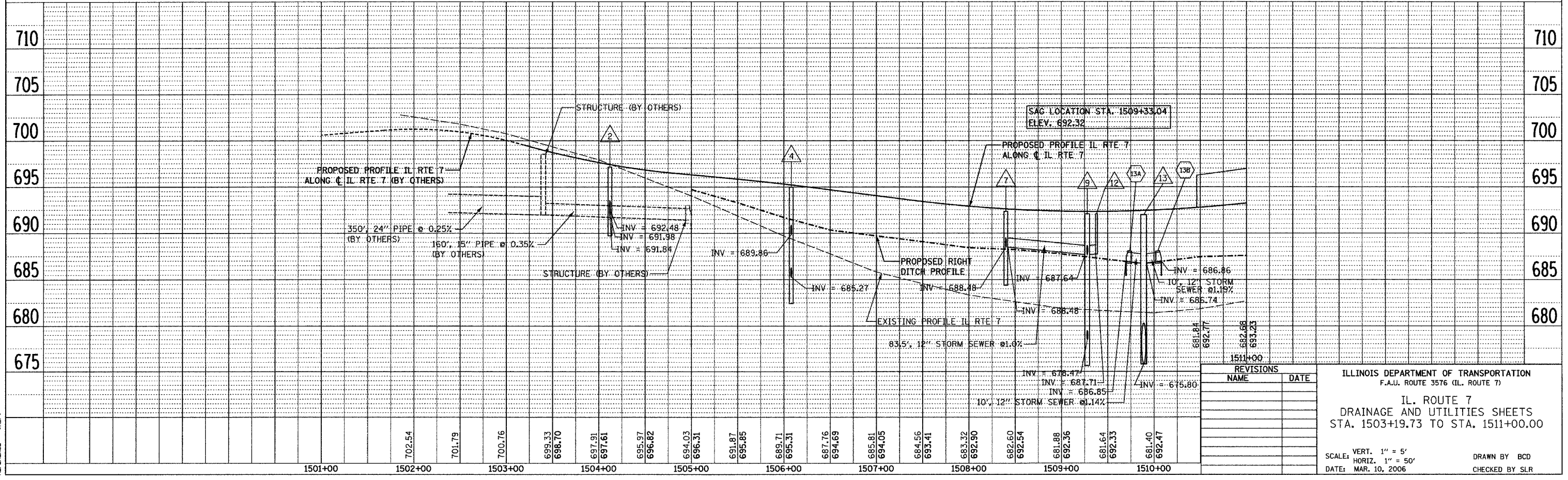

REVISIONS	
NAME	DATE

ILLINOIS DEPARTMENT OF TRANSPORTATION
 F.A.U. ROUTE 3576 (IL. ROUTE 7)

**IL. ROUTE 7
 DRAINAGE AND UTILITIES SHEETS
 STA. 1503+19.73 TO STA. 1511+00.00**

SCALE: VERT. 1" = 5'
 HORIZ. 1" = 50'
 DATE: MAR. 10, 2006

DRAWN BY BCD
 CHECKED BY SLR

DATE: 2/6/2006
 FILE NAME: \\NVL\apps\road\plans\Profile\UR.dgn
 PLOT SCALE: #SCALE#
 REFERENCE: #REF#