

STATE OF ILLINOIS
DEPARTMENT OF TRANSPORTATION

ROUTE NO. FAU 3578	SECTION 1327 B	COUNTY COOK	JETS 108	SHEET 32	SHEET NO. 4 35 SHEETS
FED. ROAD DIST. NO. 7		ELLIPSES		FED. AID PROJECT	

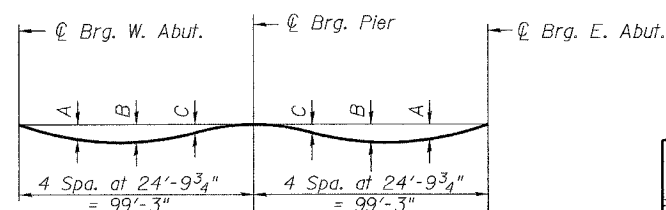

DEAD LOAD DEFLECTION DIAGRAM

(Includes weight of concrete only.)

Note:

The above deflections are not to be used in the field if the engineer is working from the grade elevations adjusted for dead load deflections as shown on sheets 5 and 6 of 35.

GIRDER NO.	DEFLECTION (in)		
	A	B	C
1	1 1/4	1 1/2	5/8
2 thru 7	3/4	7/8	3/8

TABLE OF DEAD LOAD DEFLECTIONS

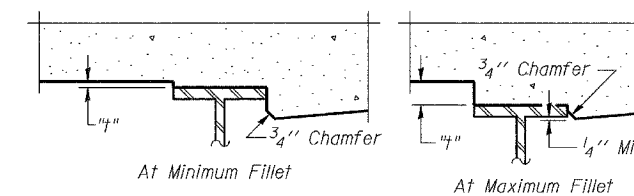
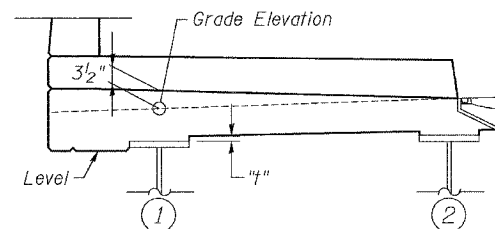

To determine "t": After all structural steel has been erected, elevations of the top flanges of the girders shall be taken at intervals shown below. These elevations subtracted from the "Theoretical Grade Elevations Adjusted for Dead Load Deflection" shown on sheets 5 and 6 of 35, minus slab thickness, equals the fillet heights "t" above top flange of girders.

FILLET HEIGHTS

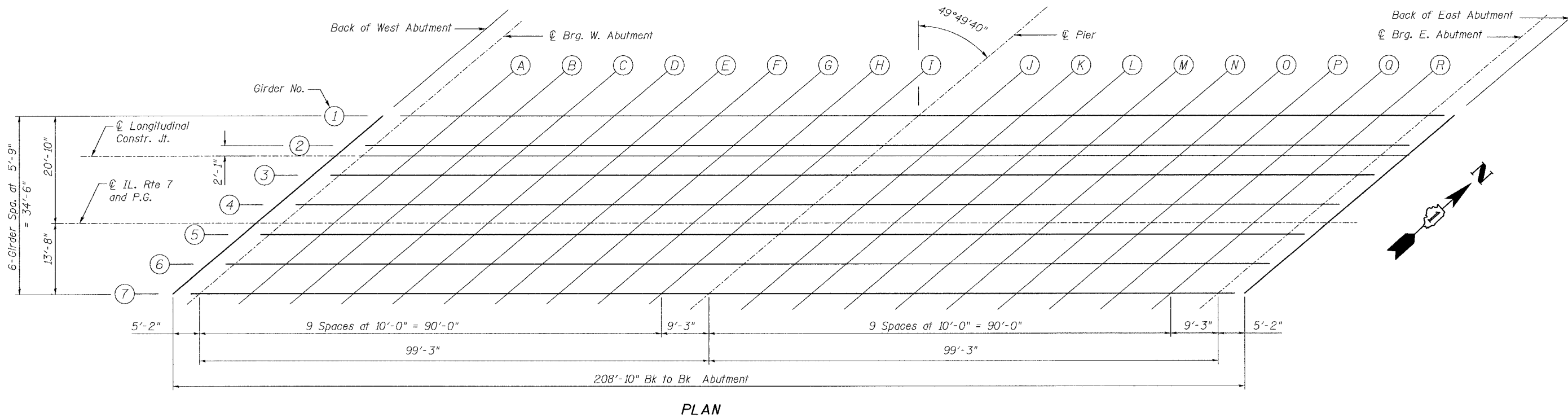

PLAN

DESIGNED	JJI
CHECKED	SRT
DRAWN	GM
CHECKED	SRT

E-S 10-22-04

B Bollinger, Lach & Associates, Inc.

TOP OF SLAB ELEVATIONS
IL 7 (SOUTHWEST HIGHWAY) OVER
US 45 (LA GRANGE ROAD)
F.A.U. ROUTE 3578 SECTION 1327B
COOK COUNTY
STA. 1516+85.79
STRUCTURE NUMBER 016-2847